

4-01-08-08-10-100, SCALE: 1"=100', LOCATED LINE, UMATILLA COUNTY, UMATILLA RIVER (RIVERSIDE) BR. & U.P.R.R.-O'XING SEC.

5133E 151
BOX 111
APR 11

T. 2 N., R. 32 E., W.M.
DRG. NO. 9B-19-4

SEE 5B-11-3 FOR PRIOR RW

UMATILLA RIVER (RIVERSIDE) BR. & U.P.R.R.-O'XING SEC.

OREGON STATE HIGHWAY DIVISION
Located Line
OREGON-WASHINGTON HIGHWAY
UMATILLA COUNTY
Scale: 1 inch = 100 feet
Traced by A.F.D. June, 1981
GRID BEARINGS - NORTH ZONE
COORDINATES - ASSUMED
DRG. NO. 9B-19-4

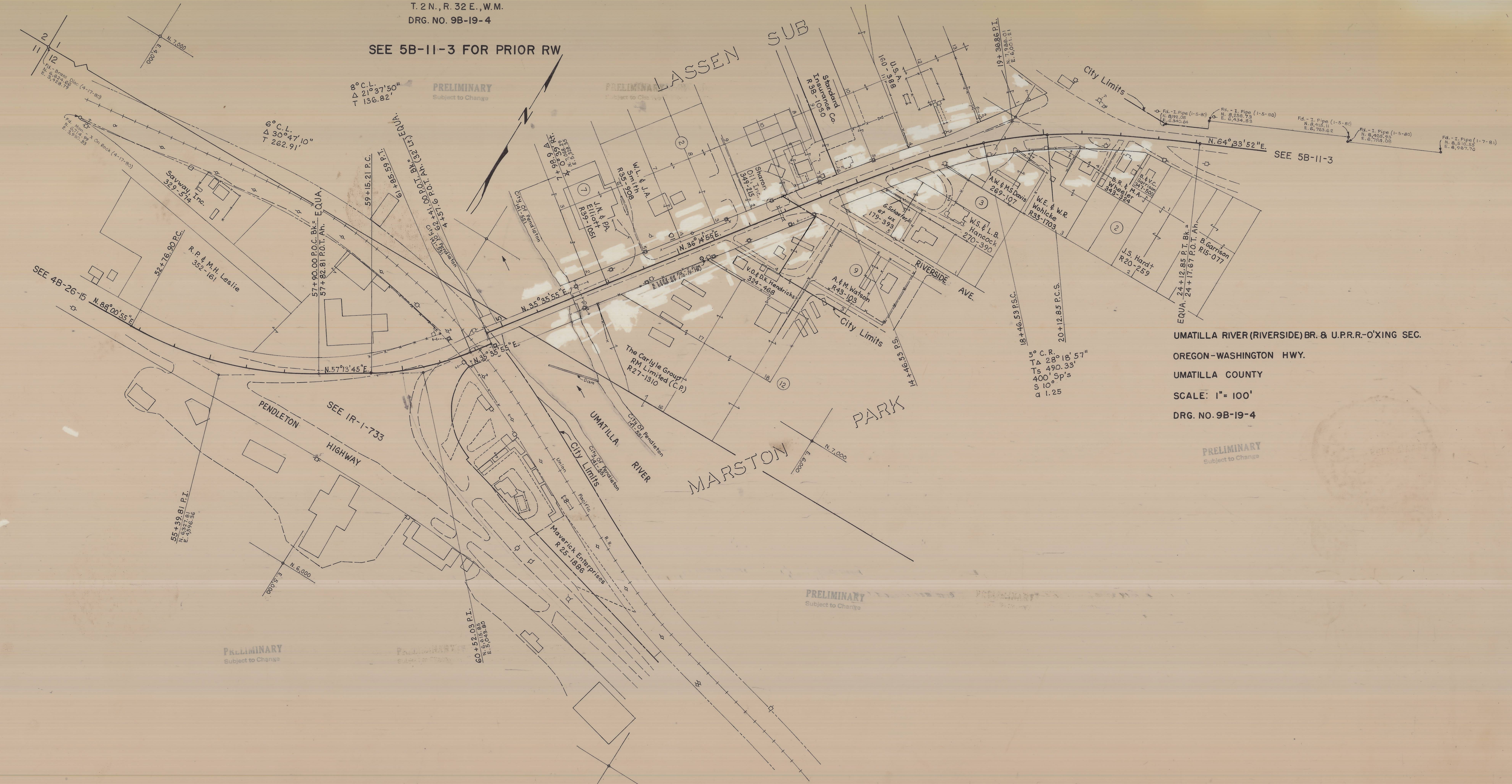

UMATILLA RIVER (RIVERSIDE) BR. & U.P.R.R.-O'XING SEC.
OREGON-WASHINGTON HWY.
UMATILLA COUNTY
SCALE: 1"= 100'
DRG. NO. 9B-19-4

RECEIVED BY
Umatilla County Surveyor
Date 7/21
Rec'd By BLS
No. S-100-2

UMATILLA RIVER (RIVERSIDE) BR. & U.P.R.R.-O'XING SEC. OREGON-WASHINGTON HWY. UMATILLA COUNTY LOCATED LINE SCALE: 1"=100' DRG. NO. 9B-19-4