

38
 Sec. 10 T. 3 N R. 36 E

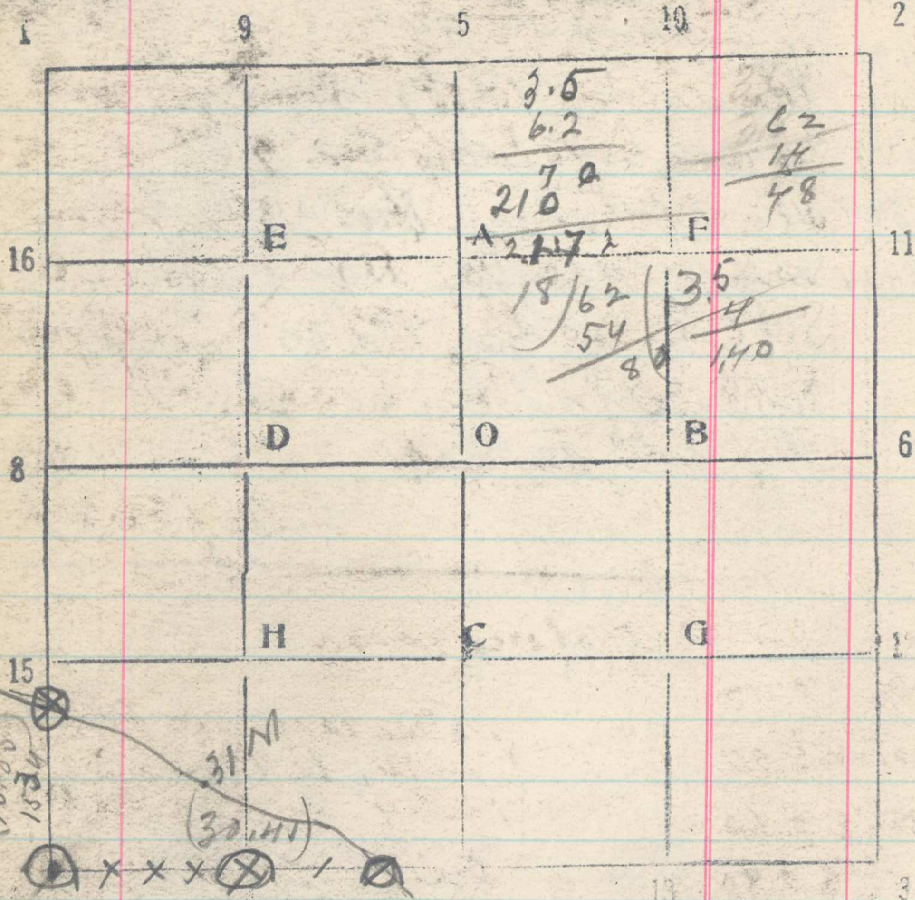

8/20/19 N 86° E bet sec. 10 + 15
 20 Set cor 9-5.15
 24.50 wildhorse creek, day. N 75° W
 30.41 Pt. for MC of sec 10 + 15 bears S 12
 lks. locate this point from stump of
 old bearing tree described in old field
 notes on Blom

Fin 18 N 30° E 53, stump greatly decayed, no marks
 Fin 8, S 85° E 53 lks, stump greatly decayed, no
 mark discernible but signs of old blaze. 273
 Set cor point for MC.
 Aug. 20/19

15.44
 (15.85)
 North bet sec 9 + 10 by day
 (Ruddy Dirt, 15.85) Point for MC
 bet sec 9 + 10 bears East 9 lks dist.
 I locate this pt. from old bearing
 tree in sec. 10, a fir 10" beam
 N 78° E, 23 lks. Mt. T 3 N R 36 E
 S 10 BT. This tree is fallen down
 & greatly decayed.
 Aug 21, 1919

From MC of sec. 9 + 10 run

S 59 3/4° E 3.42
 S 22 3/4° E 5.90
 S 39 1/2° E 2.60
 S 74 1/2° E 2.80
 S 83 1/2° E 3.71 to 31 M cr.

Stone 10x10x10 inches 31M
 on W., U. P. on S. } gone
 Fin 4 S. 34 lks }
 Fin 14 N 15° W 54 lks } OK
 marked 31 M. U. R. BT }
 make BURBT

Thence on 32nd mile

S 73° 30' E 7.70 31 M on sec S 22° W 62 lks
 (350)
 S 62° 20' E 3.80 (215)
 S 86° E 6.24* to MC to sec 10 + 15

Thence in sec. 10
 S 69° 30' E 1.61 ch. to Mt. T 3 N R 36 E Cor.