

Sec. 32 T. 3 N R. 36 E

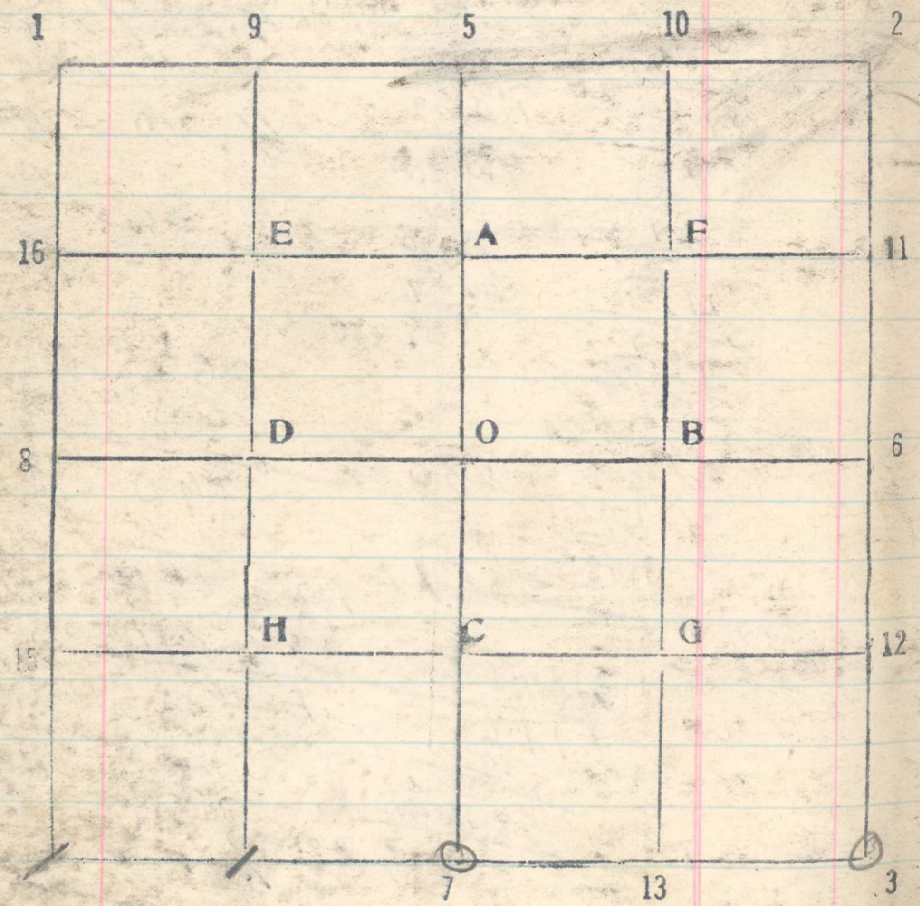

6/126
21

May 17, 1918

5.26	7.97	2.33	7.97	3.00
2.63	30		20	
7.91	4.66			148

From cor of 32 + 33 on S. line of 35 a stone
properly marked in end stone, Offset North
5.00 ch. thence run West
6.65 Set stake on line with bridge
7.67 Set stake
20. Set stakes - 5 ch. N of line
40.02 Offset South 5.06 to 1/4 cor. a pine
stump 10 ins from which Pine 12 N 36° E 15 ch.
marked 1/4 S of T
60.00 Set 1/16 cor
80.00 No trace of cor of 56.31 + 32. Fall on basin
continues West on same line.

20.
40.
60.
79.94 cor of T 3 N R. 34 + 35 E bears S. 12.6 lb

Elevation of bridge	82	131	5.26
Height at S. end	8.9	39.3	5.06
Height on log	4.4	4	2.53

FS	Grade	Cut
4.4	0.	
6.0	6.4	0.4
4.3	8.4	4.
4.6	10.4	6.
4.7	12.4	8.
4.7	14.4	10.
5.	16.4	11.
6.6	18.4	12.
8.7	20.4	12.
26.	24	26

39.7	7.59	
15.5	12-10.7	1.02
10.7	1.2	6.65
26.7	12.9.5	11.35
6.2		1.15
20.	12.11.4	10.20
	23.4	9.5
	2.4	
140	21.0	49.7
180	4.	4.
32.0	17.6	15.7
	1.6	
	15.5	