

Sec. 3 T. 2N R. 35E

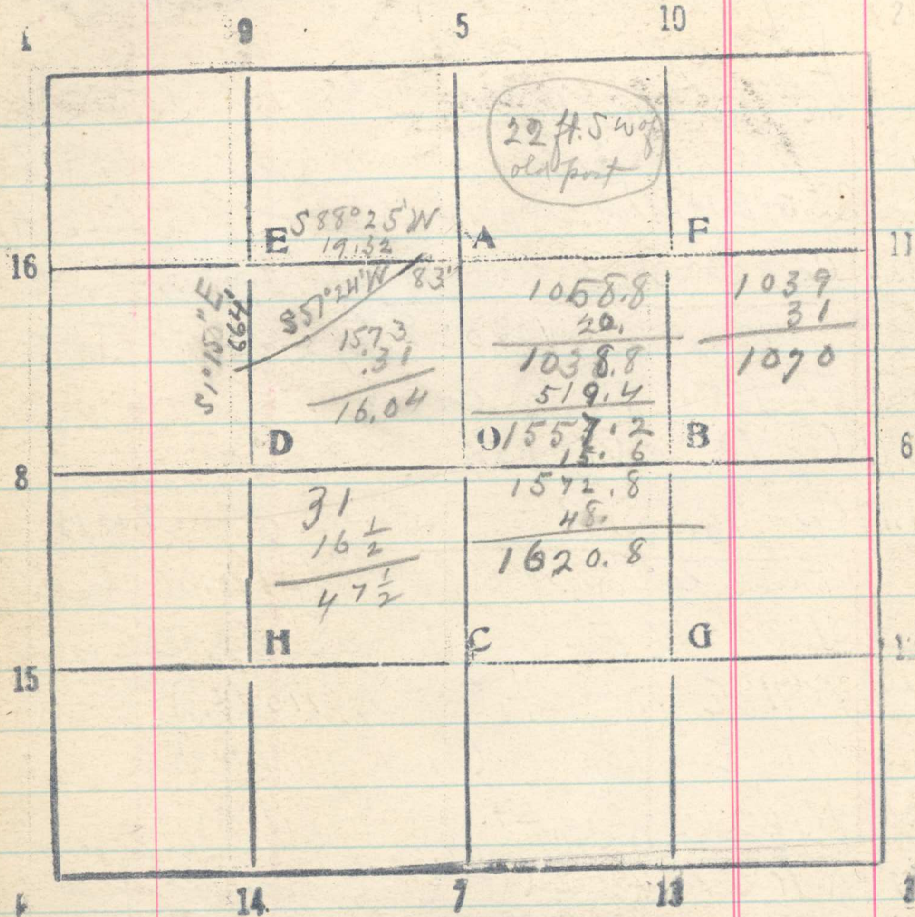

Commence 83 ft. West of A-S. 3 + running
 S57°24'W 1070 ft.
 S 60°24'W 100 ft.
 S 68°24'W 100 ft.
 S 72°24'W 100 ft to intersection of center of
 pipeline with west bdy. of SE¹ NW⁴

of sec. 3, at a point 664 feet
 south of NW corner of said 234
 S² E⁴ NW⁴ of sec. 3,
 52/100 of an acre,
 Junell 11/1974

Said strip of land containing an area
 of acres, more or less,

1/2 ft. on N side + 15 1/2 ft. on S side
 will be satisfactory.