

N.P.R.

Wallula to Pendleton Right of Way Plat

State of Oregon County of Umatilla

Sec. 13 & 18 Township 3 N. Range 32 & 33 of Willamette Meridian

Scale 400 ft. = 1 Inch

Note: Boundary of Right of Way denoted thus.....

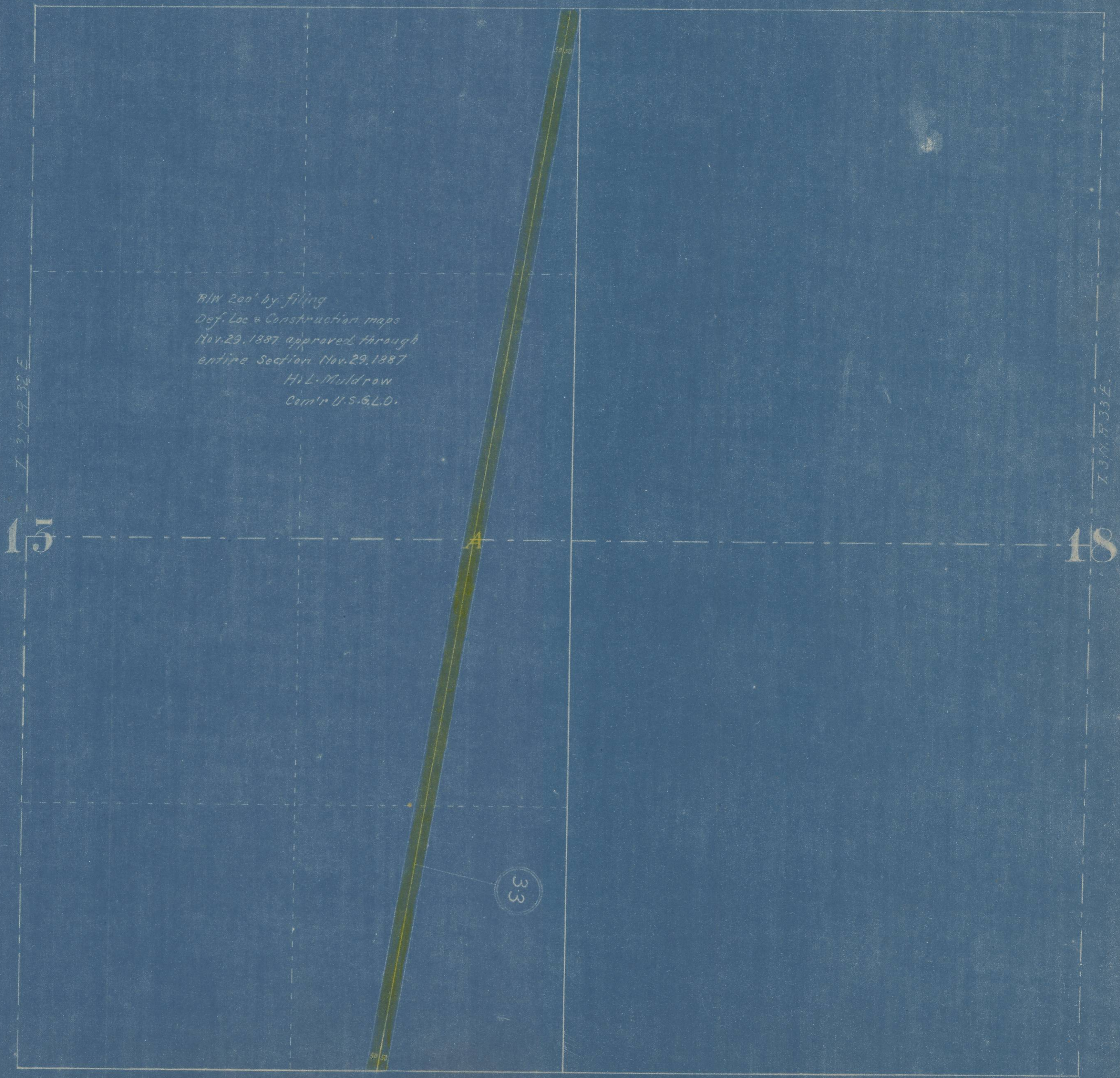

R/W 200' by filing
 Def. Loc. & Construction maps
 Nov. 29, 1887 approved through
 entire Section Nov. 29, 1887
 H. L. Muldrow
 Com'r U.S.G.L.O.