

N.P.R.

Wallula to Pendleton Right of Way Plat

State of Oregon County of Umatilla

Sec. 32 Township 4 N. Range 33 E. of Willamette Meridian

Scale 400 ft. 1 Inch

Note: Boundary of Right of Way denoted thus.....

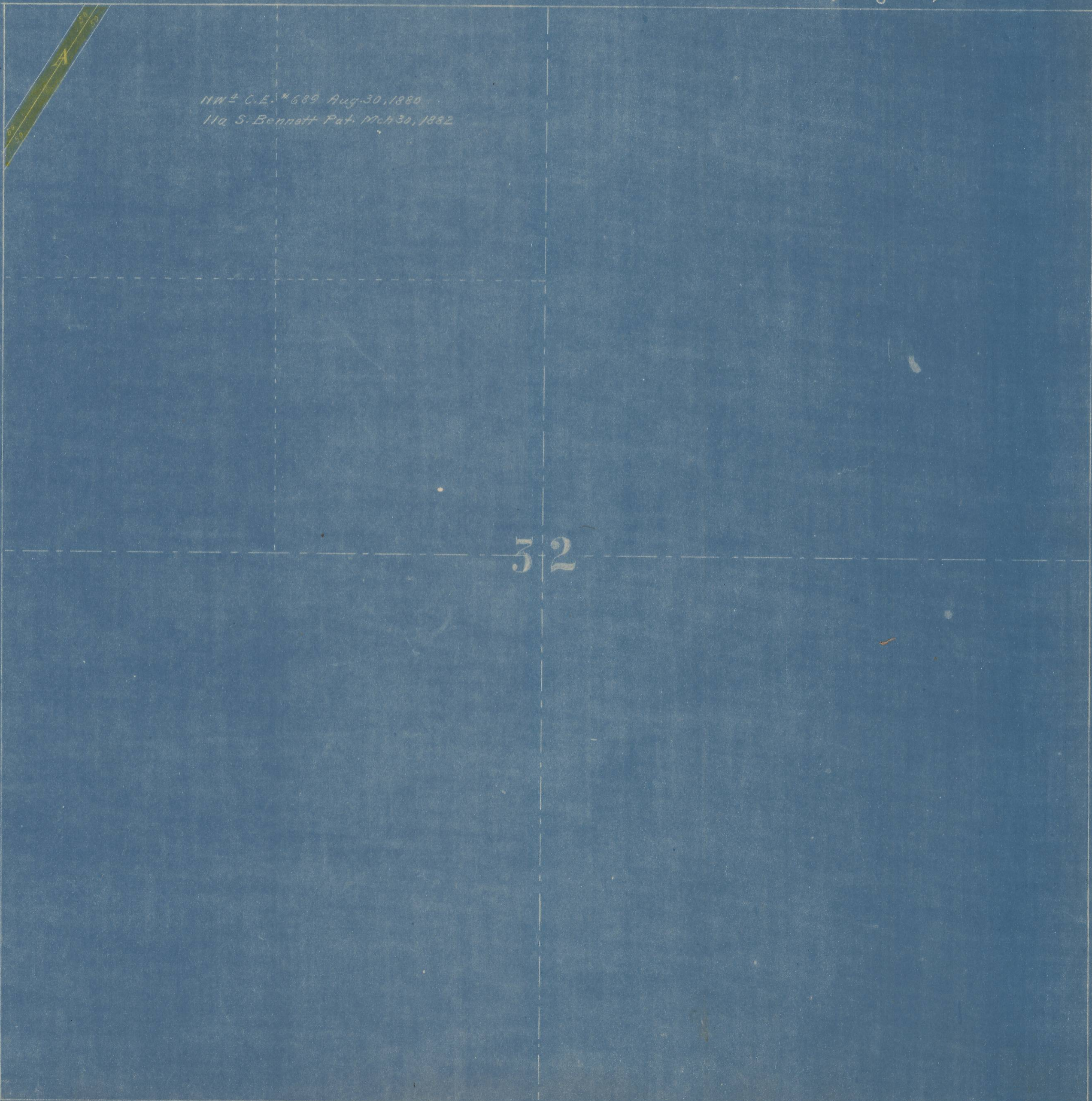

NW 1/4 C.E. #689 Aug. 30, 1880
11a S. Bennett Pat. Mch 30, 1882

32