

N. P. R.

Killian Jr. to Athena Right of Way Plat
State of Oregon County of Umatilla
Sec. 15 Township 5 N. Range 34 E. of Willamette Meridian

Scale 400 ft. = 1 Inch

Note: Boundary of Right of Way denoted thus.....

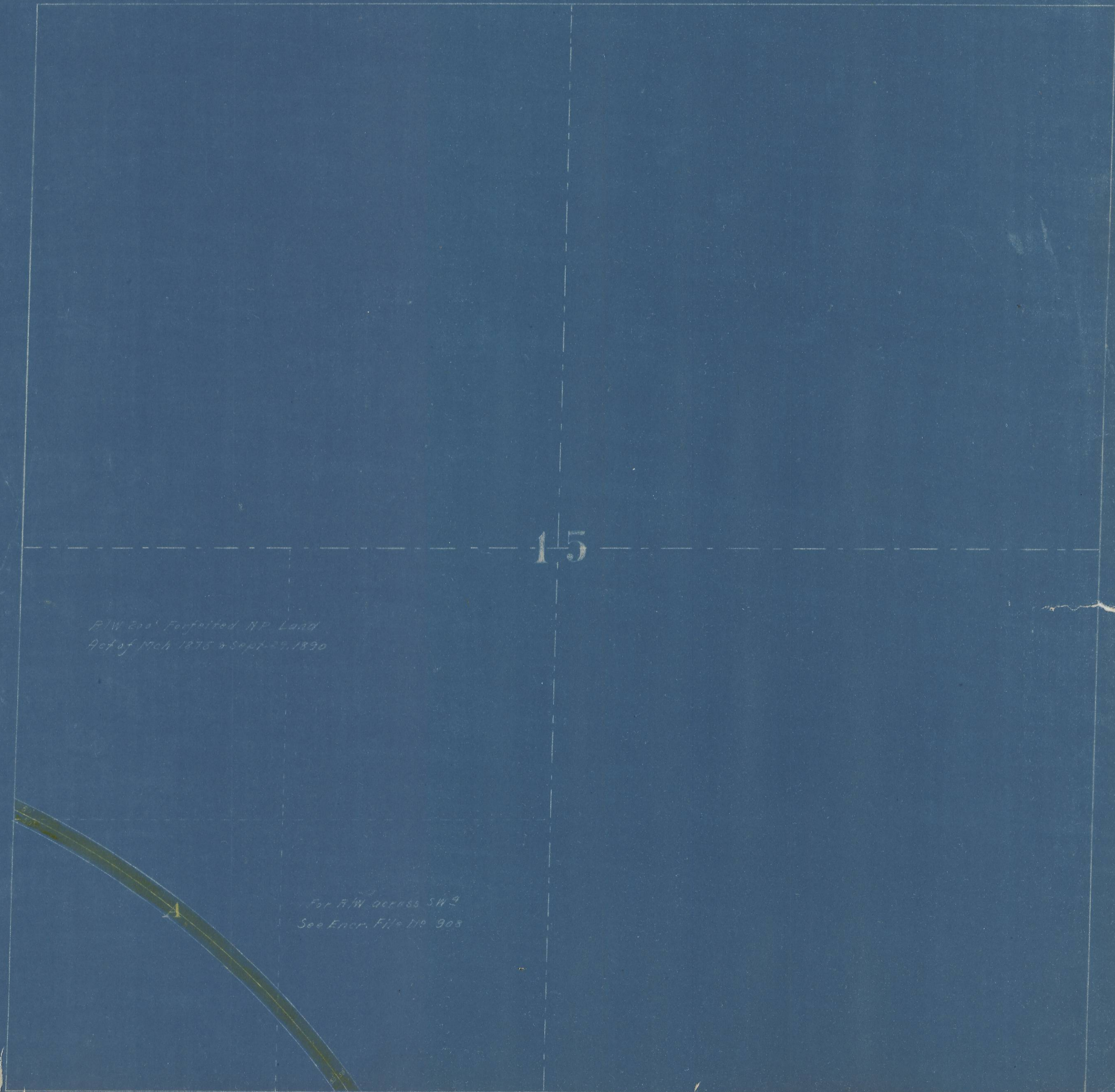

15

R/W 200' Forfeited N.P. Land
Act of Mch 1875 & Sept 25, 1890

For R/W across SW 4
See Encl. File 119 903