

WALLA WALLA VALLEY RAILWAY CO.

N.P.R.

Main Line, Walla Walla to Milton

Right of Way Plat

State of Oregon

County of Umatilla

SE<sup>1</sup>/<sub>4</sub> of Section 2 Township 5 North Range 35 East of Willamette Meridian

NOV 1 1960

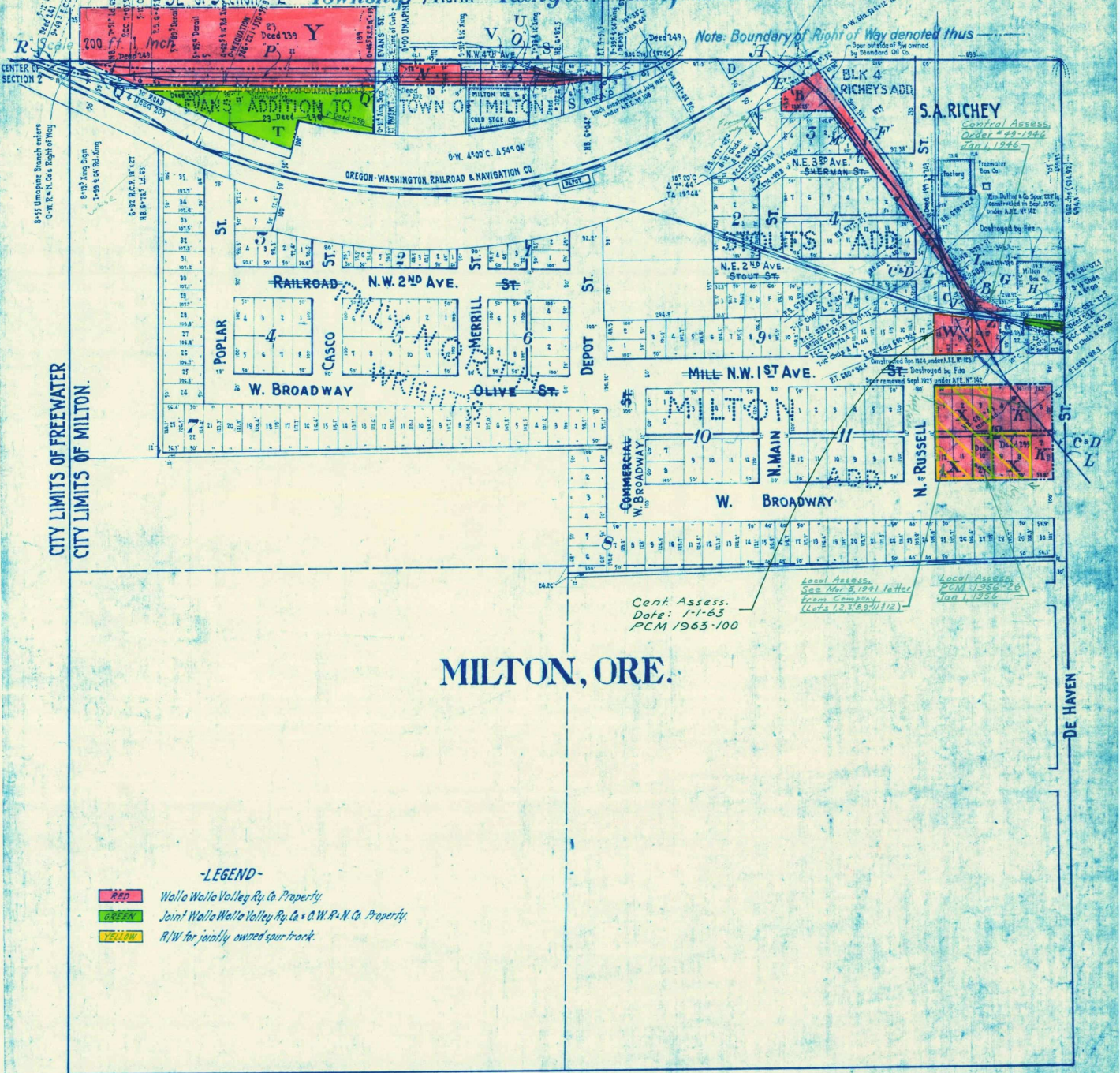

CITY LIMITS OF FREEWATER  
CITY LIMITS OF MILTON.

-LEGEND-

- Walla Walla Valley Ry. Co. Property
- Joint Walla Walla Valley Ry. Co. & O.W.R.&N. Co. Property
- R/W for jointly owned spur track.

MILTON, ORE.

Cent. Assess.  
Date: 1-1-63  
PCM 1963-100

Local Assess.  
See Map 5, 1961 in the  
Town Company  
(Lots 1, 2, 3, 4, 5, 11, 12)

Local Assess.  
PCM 1956-26  
Jan. 1, 1956

Deed No.	Grantor	Grantee	Title	Aces	Date	When and Where recorded	Brief Description	Cor. File & Memo
A 2	The O.R.R. & Nav. Co.	Walla Walla Valley Traction Co.	Contract		Oct. 10, 1906		Right to cross O-W R.R. & N. Cos track at grade at O-W Sta 534+17	
B 2A	do.	do.	do		Jan. 15, 1908		Right to cross O-W R.R. & N. Cos spur at grade in NE <sup>1</sup> / <sub>4</sub> of SE <sup>1</sup> / <sub>4</sub> of Section 2	
C 80	City of Milton	do.	Ord. No 183		Aug. 20, 1906	Records of City Recorder	Right to construct and operate electric Ry. across Russell and DeHaven Sts. for a term of 25 years	
D 80B	do.	do.	Ord. No 201		Mar. 28, 1910	do.	Amending Sec. 1 of Ord. No 183, Adds other streets	
E 84	His R. Arnold, et al.	do.	Q. C. Deed		June 24, 1908	June 26, 1908, Bk 57 Deeds, P. 142	Block 'B', Stouts Addition	
F 85	James Richey, et al.	do.	Q. C. Deed.	0.295	Nov. 13, 1906	Mar. 2, 1907, Bk 52 Deeds, P. 579.	Strip off Wly Side of S.A. Richey Tract.	
G 86	William Russell & wf	do.	Q. C. Deed		Dec. 22, 1906	Mar. 7, 1907, Bk 54 Deeds, P. 14	30' strip in NE <sup>1</sup> / <sub>4</sub> of NE <sup>1</sup> / <sub>4</sub> of SE <sup>1</sup> / <sub>4</sub> of Section 2	
H 87	Walla Walla Valley Traction Co	Higby Harris & Joseph West	do		Feb. 28, 1907	Mar. 9, 1907, Bk 54 Deeds, P. 27	Portion of above 30' strip	
I 88	Joseph West & wf	Walla Walla Valley Traction Co.	B. & S. Deed		Nov. 30, 1906	Mar. 7, 1907, Bk 54 Deeds, P. 15	Irreg. Tract in S. 150' of NE <sup>1</sup> / <sub>4</sub> of NE <sup>1</sup> / <sub>4</sub> of SE <sup>1</sup> / <sub>4</sub> of Section 2	
J 89	Matt Mesgrove & wf.	do.	Q. C. Deed		Nov. 15, 1906	Nov. 30, 1906, Bk 52 Deeds, P. 334	Triangular Tract in Block 'C' of Stouts Add.	
K 90	Laura Childers & husb.	do.	War. Deed		Oct. 24, 1906	Nov. 1, 1906, Bk 52 Deeds, P. 180	Lots 4, 5, 6 & 7, Block 12, North Milton	
L 102	City of Milton	Walla Walla Valley Ry. Co.	Ord. No 214		Dec. 28, 1911.	Records of City Recorder.	Right to construct & operate Electric Ry. across Russell & DeHaven Sts. Term, until Jan. 1, 1962	
M 110	The Lamb Fruit Co.	do.	Easement		May 1, 1916.		Portion of Lots 1 & 2, Bk 3, Stouts Add. lying Ely of a line distant 8 Wly from E of Spur Track.	

\*Note for Continuation of Deed Record, See Sheet No 30A.