

- I run East on Base line bet Sec 2 & 35-
- 4018 Let Stone 8 x 16 x 19 for  $\frac{1}{4}$  sec corner var 21° 30' E
- 6027 Let Stake in mound of Stone for  $\frac{1}{4}$  corner
- 8086 The corner to Sec 1 = 2 = 35 & 36 The Post decayed and I Reputed a Stone 6 x 9 x 25 inches  
Thence South bet Sec 1 & 2 var 19° 45' E
- 2000 Let Temporary  $\frac{1}{8}$  corner
- 8075 The corner to Sec 1 = 2 = 11 & 12 from which I run North var 20° E
- 6056 Let Stone 7 x 10 x 22 for  $\frac{1}{8}$  corner
- 8075 The corner to Sec 1 = 2 = 35 & 36  
The  $\frac{1}{8}$  corner on west Boundary N  $\frac{1}{4}$  Sec 2  
Thence East var 21° E
- 6000 Let Temporary  $\frac{1}{16}$  corner
- 8018 The  $\frac{1}{8}$  corner on East Boundary N  $\frac{1}{4}$  Sec 2 from which I run West
- 2004  $\frac{1}{2}$  Let Stone 12 x 18 x 26  
The corner Sec 1 = 2 = 11 & 12  
Thence West var 19° E
- 2000 Let Temporary  $\frac{1}{8}$  corner
- 4026 The  $\frac{1}{4}$  Sec corner bet Sec 1 & 12 from which I run East-
- 2018 Let Stone 9 x 9 x 31 for  $\frac{1}{8}$  corner  
Thence North var 21° E
- 6040 The  $\frac{1}{16}$  corner in center N  $\frac{1}{4}$  Sec. 2 above 12 x 18 x 26

JW Kimbrell County Surveyor

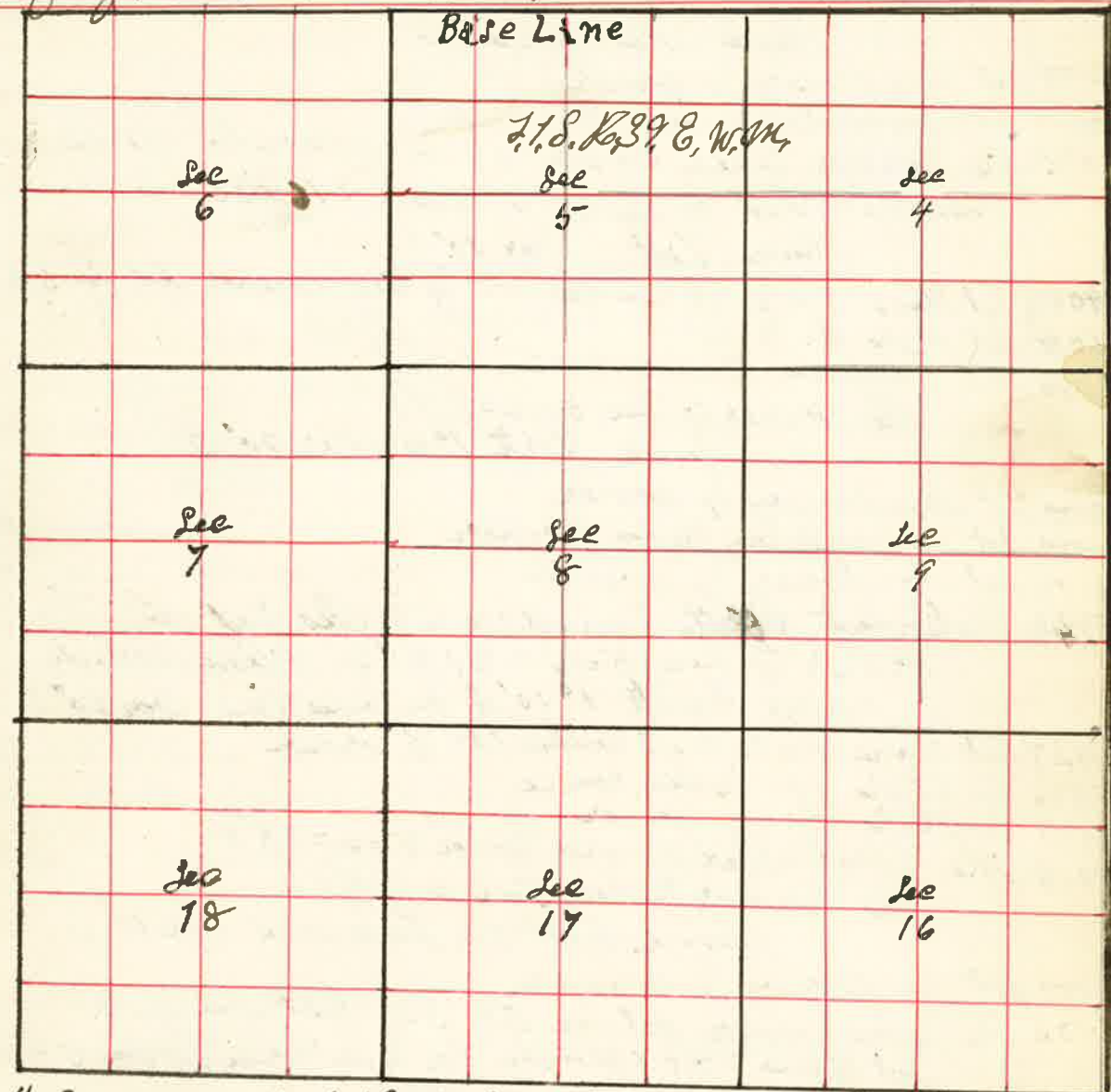

- I Commenced at the to Sec 4 = 5 = 32 & 33 on Base line between T. 1. N. & 1. S. Range 39. E. W. M.,  
Thence South between Sec 4 & 5 var. 21° 30' E
- 1964 Let Temporary  $\frac{1}{8}$  corner
- 3964 Let Temporary  $\frac{1}{4}$  Sec corner
- 5964 Let Temporary  $\frac{1}{8}$  corner
- 7964 Intersect E & W line 9 fms West of corner to Sec 4 = 5 = 32  
Post decayed and I Reputed a Stone 6 x 10 x 26 inches  
Thence North 2° W var 20° E
- 2000 Let Stone 6 x 9 x 28 for  $\frac{1}{8}$  corner
- 4000 Let Stone 6 x 9 x 22 for  $\frac{1}{4}$  Sec corner between Sec 4 & 5-
- 6000 Let Stone 6 x 8 x 36 for  $\frac{1}{8}$  corner
- 7964 The corner to Sec 4 = 5 = 32 & 33 on Base line

The Corner to Sec. 4=5=8 & 9  
Thence West var 20° E

2000 Let Temporary 1/8 corner

4000 Let Temporary 1/4 Sec corner

8095 The Corner to Sec 5=6=7 & 8 in marshes Post-decayed

Re-established by planting a stone 6x16x20 inches

Thence East var 20° E

4047 1/2 Let Stone 8x16x25 inches for 1/4 Sec corner bet Sec 5 & 8

6070 Let Stake for 1/8 cor

8095 The Corner to Sec 4=5=8 & 9

The Corner to Sec 5=6=7 & 8

Thence North 1°40' var 20° E

2000 Let Temporary 1/8 corner

4000 Let Temporary 1/4 Sec corner

6000 Let Temporary 1/8 corner

7948 Intersect North Boundary 25 lks East of the corner to Sec 5=6=31 & 32 from which I run South 1°10' E on true line var 20° E

1927 Let Stone 4x12x27 inches for 1/8 corner

3934 Let Stake for 1/4 Sec corne

5941 Let Stake for 1/8 corner

7948 The Established corner to Sec 5=6=7 & 8

The Corner to Sec. 5=6=31 & 32

Thence East on base line var 19° E

2000 Let Temporary 1/8 corner

4006 The 1/4 Sec corner bet Sec 5 & 32 Post-decayed

Let Stone 7x9x30 inches for 1/4 Sec corner bet Sec 5 & 32

Thence West var 19° E

2003 Let Stone 5x7x30 inches for 1/8 corner

4006 The corner to Sec 5=6=31 & 32

The 1/4 Sec corner bet Sec 5 & 32

Thence East var 19° E

2000 Let Temporary 1/8 corner

4009 The corner to Sec 4=5=32 & 33 from which

I run West var 20° E

2004 1/2 Let Stone in mound of Stone in bed of Dry Branch for 1/8 corner

4009 The 1/4 Sec corner bet Sec 5 & 32

The 1/4 Sec corner bet Sec 5 & 6  
Thence East through center Sec. 5 var 20° E

4000 Let Temporary Stake for center Sec 5-

6000 Let Temporary " " Center E 1/2 Sec 5-

8060 The 1/4 Sec corner bet Sec 4 & 5 - from which I run West var 20° E

2015 Let Stone 5x12x24 inches for 1/8 corner in Center E 1/2 Sec 5-

4030 Let Stone 6x7x24 " for 1/8 corner in Center Sec 5-

8060 The 1/4 Sec corner bet Sec 5 & 6

The 1/4 Sec corner on South Boundary Sec. 1/4 Sec 5-

Thence North through center Sec. 5-  
var 20° E

2000 Let Temporary 1/8 corner

4007 Intersect E & W line 24 lks E of center from which I run South 2° E var 20° E

2003 1/2 Let Stone 6x7x25 for center of 1/2 Sec 5-

The center Sec 5 - Thence North 2° W var 20° E

2000 Let Temporary center N 1/2 Sec 5-

7947 Intersect North Boundary 20 lks East of 1/4 Sec cor from which I run South

1940 Let Stone 11x13x32 inches for center N 1/2 Sec 5-

3940 The center Sec 5 - a stone 6x7x24

The 1/8 corner on East Boundary of E 1/4 Sec 5 -

Thence West through center Sec 5 -  
var 20° E

2000 Let Stake to temporary 1/8 corne

4036 The center of 1/2 Sec 5 - from which I run East var 20° E

2018 Let Stone 4x6x24 for 1/8 corner in Center E 1/2 Sec 5-

4036 The 1/8 corne on East Boundary of E 1/4 Sec 5-

The 1/8 corner on East Boundary N E 1/4 Sec 5 -

Thence West var 20° 15' E

2000 Let Temporary 1/8 corner

4000 Let Temporary center N 1/2 Sec 5 -

8030 The 1/8 corner on West Boundary N W 1/4 Sec 5 -  
from which I run East

4034 Let Stone 16x13x32 inches for center N 1/2

6021 Let Stone 3 1/2 x 10 x 23 for 1/8 corner in center N E 1/4 Sec 5 -

8030 The 1/8 corner on E Boundary N E 1/4 Sec 5 -

Surveyed for Jacob Aug John McKinnis & J.W. Koval Oct 19 1889

1/8 corner on South Boundary S E 1/4 Sec 5 -  
Thence North 2° W var. 20° E  
1/16 in center S E 1/4 sec 5 -  
1/16 center E 1/4 S E 1/4  
1/8 corner on N boundary N E 1/4 Sec 5 in old Big Bend of Prairie

The 1/4 Sec corner between Sec 4 & 5 -  
Thence East through center Sec 4 var. 20° E  
Temporary 1/16 corner in west 1/2 Sec 4  
Temporary 1/16 corner in center Sec 4  
Intersect East Boundary 30 lbs South of 1/4 sec corner  
between Sec 3 & 4 from which I run  
I run west var. 20° E

Post in mound of Stone to center E 1/2 Sec 4  
1/16 center Sec 4  
1/16 center NW 1/4 Sec 4  
1/4 Sec corner on west boundary Sec 4  
1/4 Sec corner bet Sec 4 & 33 on base line  
Thence S 2° E var. 20° E

reciprocal or Rocky Bluff Telescope measurement  
638 lbs to flag on line  
Intersect E & W line 5 lbs East of first Stake at this point  
Intersect South Boundary 20 lbs East of 1/4 Sec on bet Sec 4 & 5  
The 1/8 corner on South Boundary S W 1/4 Sec 4  
Thence North var. 20° N 2° W  
Intersect E & W line 9 1/2 lbs East of first Stake  
Set Temporary 1/16 corner  
Intersect North Boundary at 1/8 corner from which

Surveyed for John McKinnis P.E. Wade S. Brooks & J.S. Clark Oct 22 1889

By J.W. Kimball County Surveyor Plat No. 93 & 94 <sup>See Plat</sup> <sub>See Page 125</sub>

I commenced at the corner to Sec 5=6=7 & 8 a stone in willow marsh  
Thence west var. 20° E

4000 Set Temporary 1/4 Sec corner  
7910 Intersect west Boundary 13 lbs South of  
corner to Sec 6=7=18 & 12 on Range line bet R 38 & 39 T 13  
making an excess of 100 lbs over U.S. Field Notes  
I therefore run East on true line

3860 Set Stone 4 x 16 x 22 marked 1/4 for 1/4 Sec corner bet Sec 6 & 7  
7910 The corner to Sec 5=6=7 & 8 a stone 6 x 16 x 20 inches  
The corner to Sec 6=7=18 & 12 on Range line bet R 38 & 39  
Thence South var. 20° E

4000 Set Temporary 1/4 Sec corner bet Sec 12 & 7  
8010 The corner to Sec 7 & 12 = 13 & 18 from which  
Post degraded Set Stone 5 x 16 x 30 inches  
I run North

4005 Set Stake for 1/4 Sec corner bet Sec 7 & 12  
8010 The corner to Sec 6=7=18 & 12  
The corner to Sec 7=18=12 & 13 on Range line  
Thence East var. 20° E

3852 Set Temporary 1/4 Sec Post  
5138 Willow creek 75 lbs across Course N. 50° E  
5852 Set Temporary 1/8 Post  
7852 Set Temporary corner to Sec 7=8=17 & 18  
Thence East var. 20° E

4000 Set Temporary 1/4 Sec Post  
8580 Set Temporary corner to Sec 8=9=16 & 17  
Thence East var. 20° E  
1000 Set Temporary 1/4 corner

Surveyed for John McKinis P. E. Wells & Brooks & J. S. Clark Oct 22 1889

Thence west var 20° E

4031 1/2 Let Stone 6 x 10 x 15 for 1/4 Sec corner bet Sec 8 & 17 <sup>4031 1/2</sup> <sub>8063</sub>

8063 Let Stone 5 x 14 x 28 inches for corner to Sec, 7=8=17 & 18

Thence west var 20° E

2015 Let Stone 3 x 10 x 16 for 1/8 Corne

4031 1/2 Let Stake for 1/4 Sec corne bet Sec 7 & 18

7915 The corner to Sec 7=18=12 & 13

The corner to Sec 4=5=8 & 9

Thence South var 21° 30' E

4000 Let Temporary 1/4 Sec corner

8000 Let temporary corner to Sec 8=9=16 & 17

Thence South var 20° E

4000 Let temporary 1/4 Sec cor

8076 Intersect E & W line 29 lks west of corner to Sec 16=17=20 & 21

From which

I run North on True line N 15° W var 20° E

4019 1/2 Let Stone 6 x 12 x 19 for 1/4 Sec corner bet Sec 16 & 17

8039 The corner to Sec 8=9=16 & 17 a Stone 6 x 15 x 22 inches

Thence North var 0° E

4019 1/2 Let Stone 6 x 15 x 25 for 1/4 Sec corner bet Sec 8 & 9

8039 The corner to Sec 4=5=8 & 9

The 1/4 Sec corner bet Sec 6 & 7

Thence South var 20° E

2000 Let Temporary 1/16 corner

4000 Let Temporary 1/16 corner

8010 Intersect E & W line 26 lks East of 1/4 Sec corne bet Sec 7 & 18

From which

I run North on True line var 20° 5' E

4005 Let Stake for center Sec 7

2 600 1/2 Let Stone 6 x 7 x 32 for 1/16 corner in center N 1/2 Sec 7

4 8010 The 1/4 Sec corne bet Sec 6 & 7

The 1/4 Sec corner bet Sec 8 & 9

Thence west var 20° E

2 4000 Let tempo of Stake off center Sec 8

4 8092 The 1/4 Sec corner bet Sec 7 & 8 from which

I run East var 0° E

4046 Let Stone 5 x 8 x 15 for center Sec 8

8092 The 1/4 Sec corne bet Sec 8 & 9

Surveyed for John McKinis P. E. Wells & Brooks & J. S. Clark Oct 22 1889

The corner to Sec 7=8=17 & 18

Thence North var 20° 15' E

4000 Let Stake for temporary 1/4 Sec cor

5800 Bluff on East side of Willow creek 329 lks cor

225 lks to North Bank

6025 to North Bank of Willow creek

8012 The corner to Sec 5=6=7 & 8 from which

I run South var 20° E

1978 Let Stone 10 x 10 x 25 inches on North or left Bank

of Willow creek for witness to 1/8 corner 25 lks North

of true corner which is in Willow creek

4006 Let Stone 5 x 14 x 28 inches bet Sec 7 & 8

8012 The corne to Sec 7=8=17 & 18

The 1/4 Sec corne bet Sec 8 & 17

Thence North var 20° 30' E

4013 The center stone 5 x 8 x 15 for center Sec 8

6912 Bluff on South or right Bank of Willow creek

8023 The 1/4 Sec corner bet Sec 5 & 8

The corner to Sec 16=17=20 & 21

Thence East var 20° 15' E

3957 Let Temporary 1/4 Sec corner

4657 Intersect Grand Pound Pipe left Bank

Offset 150 lks North thence East on Offset

Let back South 150 lks to line thence East on line

6000 Let temporary Stake for corner to Sec 15=16=21 & 22

7914 Thence East var 20° E

1140 Grand Pound Pound Pipe 168 lks across course N 10° W

4026 The 1/4 Sec corner bet Sec 15 & 22 from which I

I run West on True line

4008 Let Stake for corner to Sec 15=16=21 & 22

Thence west var 20° E

3965 Let Stone 5 x 12 x 22 for 1/4 Sec corner bet Sec 16 & 21

7922 The corner to Sec 16=17 & 20 & 21

The corner to Sec 9=10=15 & 16

Thence South on Offset of 10 Chains west var 19° 50' E

4000 Let Stake for temporary 1/4 Sec cor 10 chains East on line

8000 Let 10 Chains East on line and let temporary cor to Sec 15=16=21 & 22

Thence South var 20° E

Surveyed for John McKinis, E. Wade Brooks & J.S. Clark Oct 22 1889

Thence South var 0° E  
 around Round River 238 lks across runs East-  
 around no 1/4 sec corner  
 and no 1/4 sec corner

Thence South  
 and no 1/4 sec corner  
 to corner to Sec 27-28 = 33 & 34 making an Excess  
 of 92 lks over U.S. Field Notes I therefore run  
North var 20° E allowing 30 lks to the mile  
 to stake for corner to Sec 15-16 = 21 & 22

Thence North var 20° E  
 to stone 5x12x28 for 1/4 corner  
 to stone 5x16x22 for 1/4 sec corner bet Sec 15 & 16  
 to corner to Sec 4-10 = 15 & 16

1/4 sec corner bet Sec 15 & 16  
Thence west through center Sec 16 var 20° E

Temporary cut Sec 16  
 intersect west boundary 7 lks North of 1/4 sec corner bet Sec 16 & 17  
 from which

run East  
 center Sec 16  
 to boundary at 1/4 sec corner  
 the 1/4 sec corner bet Sec 9 & 16  
Thence South var 20° E

intersect E & W line at center  
 intersect South boundary at 1/4 sec corner bet Sec 16 & 21

Surveyed for Steel Bros. A. Tarter C. Gaylord & J. Morgan Nov 7<sup>th</sup> 1889  
 By J.W. Kernell County Surveyor Plat No. 95.

I commenced at the 1/4<sup>th</sup> corner bet Sec 25 & 26  
 1 stone in Pine creek  
 from which  
 a willow 3 in to 358° & 32 lks  
 " " " 31° W 27 "  
Thence East through the  
 center Sec 25 var 20° E  
 leave Pine creek  
 200 Pine creek 60 lks wide S E  
 2000 let temporary 1/16 corner  
 4000 " temporary 1/16 corner  
 for center Sec 25 -  
 6000 let temporary 1/16 corner  
 for center E 1/2 Sec 25 -  
 8022 intersect East boundary  
 86 lks North of 1/4 sec corner  
 bet Sec 25 & 30 on temporary  
 from which  
run west var 19° 30' E

2021 center E 1/2 Sec 25 - 9 stones 8x10x18  
 4042 center Sec 25 - a stone 8x9x18 from which an apple 4 in to 340° W 105 lks  
 6032 let stone 7x9x16 from which a pine 16 in dia. bro 817° & 28 lks  
 8022 the 1/4 sec corner bet Sec 25 & 26 " 22 " " N 11° & 41 "

the 1/4 sec corner bet Sec 25 & 36  
Thence North var 20° E cottonwood 8 in to 350° W 73 lks  
 " " " N 8° & 5 "  
 725 Pine creek 50 lks wide runs East -  
 2000 let temporary 1/16 corner in center E 1/2 Sec 25 -  
 4000 let temporary State for center Sec 25 -  
 6000 let temporary 1/16 corner in center N 1/2 Sec 25 -  
 8020 intersect North boundary 30 lks west of 1/4 sec corner bet Sec 24 & 25 -  
 from which

run South on true line 20° E  
 to stone 5x12x28 for 1/4 sec corner

