

By J. W. Kimbrell County Surveyor Plat No. 92.

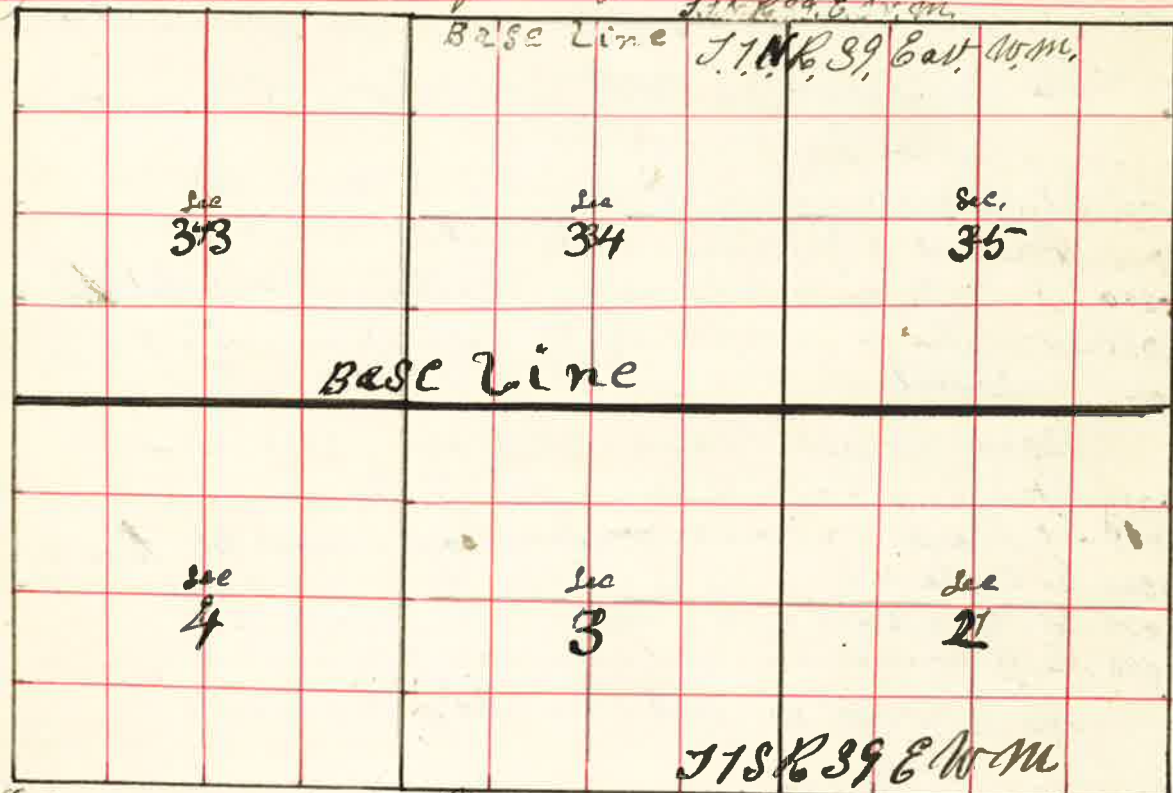

I Commenced at the Corner to Sec 3=4=33 & 34 on the Base Line between T. 1. N. 39. East. W. M., thence South bet Sec 3 & 4 var $24^{\circ}30' E$

- 1934 Set Temporary $\frac{1}{8}$ corner
- 3934 found no $\frac{1}{4}$ Sec corner and Set Temporary corner
- 5934 Set Temporary $\frac{1}{8}$ corner
- 7934 found no Sec corner and Set Temporary corner to Sec 3=4=9 & 10

thence South bet Sec 9 & 10 var $20^{\circ} E$

- 1189 Grand Bound River 200 Lks wide Course East
- 4000 found no $\frac{1}{4}$ Sec corner and proceeded on South
- 4376 Grand Bound River 460 Lks across Course $N20^{\circ}W$
- 8108 South Boundary Sec. 9 77 Lks west of corner to Sec 9=10=15 & 16 making an excess of 108 Lks over U.S. Field Notes I therefore run North var $19^{\circ}30' E$

- 8054 Set Stone $4 \times 13 \times 24$ inches for corner to Sec 3=4=9 & 10 thence North var $20^{\circ}30' E$

- 2018 1/2 Set Stone $4 \times 17 \times 34$ inches for $\frac{1}{8}$ corner
- 4027 Set Stone $8 \times 14 \times 32$ inches for $\frac{1}{4}$ Sec corner between Sec 3 & 4 in mound
- 6041 Set Stone $6 \times 22 \times 26$ inches for $\frac{1}{8}$ corner
- 7988 the corner to Sec 3=4=33 & 34 on Base line

The corner to Sec 4=5=8 & 9 thence East var $21^{\circ} E$

- 500 Spring Branch runs South
- 900 Foot of Hill ascend
- 3972 Set Temporary $\frac{1}{4}$ Sec corner bet Sec. 4 & 9
- 5958 " Temporary $\frac{1}{8}$ corner
- 7945 the corner to Sec 3=4=9 & 10 thence East var $21^{\circ} E$
- 1987 1/2 Set Temporary $\frac{1}{8}$ corner
- 2629 Grand Bound River 215 Lks across runs North
- 4015 the $\frac{1}{4}$ Sec corner bet Sec 4 & 10 making an excess of 41 Lks over U.S. Field Notes I therefore run west on true line

- 1945 Set Stone for $\frac{1}{8}$ corner
- 3990 the corner to Sec 3=4=9 & 10 a stone $4 \times 13 \times 24$ inches thence west var $20^{\circ} E$

- 1990 Set Stone $6 \times 12 \times 30$ inches for $\frac{1}{8}$ corner
- 3980 Set Stone _____ for $\frac{1}{4}$ Sec corner between Sec 4 & 9
- 7965 the corner to Sec 4=5=8 & 9

the corner to Sec 3=4=33 & 34 thence west var $24^{\circ}30' E$

- 2000 Set Temporary $\frac{1}{8}$ corner
- 4028 the $\frac{1}{4}$ Sec corner bet Sec 4 & 33 from which run East

- 2011 1/2 Set Stone $4 \times 12 \times 36$ inches for $\frac{1}{8}$ corner thence South var $21^{\circ}30' E$
- 6000 Set Temporary $\frac{1}{8}$ corner
- 8009 Intersect South Boundary 42 Lks East of $\frac{1}{8}$ corner
- 2 thence North
- 2010 Set Stone $8 \times 12 \times 24$ inches for $\frac{1}{8}$ corner in center of $\frac{1}{4}$ Sec 4
- 8009 the $\frac{1}{8}$ corner on Base line on North Side to $\frac{1}{4}$ Sec 4

the $\frac{1}{4}$ Sec corner bet Sec 3 & 4 thence East var $21^{\circ} E$

- 2000 Set Temporary $\frac{1}{8}$ corner in center of Sec 3
- 3130 Grand Bound River 587 Lks across Course $N80^{\circ} E$

the corner to Sec 3=4=33 & 34 on Base line thence East on Base line var $24^{\circ}30' E$

- 900 Road runs N & South

Surveyed for Harris Leffers Eaton & Bennett Oct 14 1889

- 1350 Bluff on west side of Grand Round River
- 1590 Grand Round River 125 lks across
Take telescopic measurement from Bluff 240 lks west of bank to a point 138 lks East of River a distance of 603 lks from Point on Bluff where Transit is set up
- 2000 Set Temporary 1/8 corner
- 4000 Set Temporary 1/4 Sec corner
- 8078 The corner to Sec 2 = 3 = 34 & 35 - Post decayed
I re-established by planting a stone 8 x 2 1/2 x 2 1/2 inches
Hence west var 20° E
- 4039 Set Stone 6 x 11 x 31 for 1/4 Sec corner bet Sec 3 & 34
- 6058 1/2 Set Stone 6 x 17 x 27 for 1/8 corner
- 8078 The corner to Sec 3 = 4 = 33 & 34
The corner to Sec 2 = 3 = 34 & 35 on Base line
Hence South var 19° E bet Sec 2 & 3
- 1920 Set Temporary 1/8 corner
- 3920 Set Temporary 1/4 Sec corner
- 7920 The corner to Sec 2 = 3 = 10 & 11 from which
I run North
- 4000 Set Stone 6 x 6 x 20 inches for 1/4 Sec corner bet Sec 2 & 3
- 6070 Set Stone 6 x 8 x 37 " for 1/8 corner
- 7920 The corner to Sec 2 = 3 = 34 & 35 on Base line
The 1/8 corner on East Boundary N. E. 1/4 Sec 3
Hence west through center N 1/2 Sec 3 var 21° E
- 4250 Rocky Point from this point west I take a telescopic measurement 690 links to Rock cliff
- 5635 Grand Round River 327 lks across Course N 25° W
- 6000 Set Stake for Temporary 1/16 corner
- 8080 The 1/8 corner on west Boundary N. W. 1/4 Sec 3
The 1/8 corner on North Boundary N. W. 1/4 Sec 3
Hence South var 22° 30' E
- 1400 Grand Round River 455 lks across Course N 20° W
- 1933 Set Stake 14 lks west of first stake
- 3933 Set Temporary 1/16 corner in center SW 1/2 Sec 33

- 5938 Set Temporary 1/16 corner in center S. W. 1/4 Sec 3
- 7964 Intersect South Boundary 155 lks East of 1/8 corner from which I run North var 21° E
- 2010 Set Willow Post 4 inch diameter 4 feet long for 1/16 corner in center S. W. 1/4 Sec 3
- 4027 Set Stone 7 x 12 x 24 for 1/16 corner in center W. 1/2 Sec 3
- 6027 Set Stone 4 x 18 x 32 for 1/16 corner in center N. W. 1/4 Sec 3
- 7964 The 1/8 corner on N. Body N. W. 1/4 Sec 3,
The corner to Sec 3 = 4 = 33 & 34
Hence North bet Sec 33 & 34
- 2000 Set Temporary 1/8 corner
- 4096 The 1/4 Sec corner bet Sec 33 & 34 from which
I run South var 20° E
- 2048 Set 1/8 corner Post
- 4096 The corner to Sec 3 = 4 = 33 & 34
The corner to Sec 2 = 3 = 34 & 35
Hence North bet Sec 34 & 35 var 23° 20' E
- 2000 Set Temporary 1/8 corner
- 4062 The 1/4 Sec corner bet Sec 34 & 35 - from which
I run South var 21° E
- 2031 Set Stone 6 x 16 x 44 inches for 1/8 corner
- 4062 Hence west var 20° E
- 2988 Top of Rocky Bluff East of Grand Round River
204 links telescopic measurement to East Bank
- 3182 Grand Round River 254 lks across Course North
- 4000 Set Temporary 1/4 Sec corner
- 6000 Set Temporary 1/16 corner
- 8096 The 1/8 corner on west Boundary S. W. 1/4 Sec 34
from which
I run East
- 2023 Set Post in mound of Stone for 1/16 corner in center S. W. 1/4 Sec 34
- 4046 Set Stone in mound of Stone for center S. 1/2 Sec 34
The corner to Sec 1 = 2 = 35 & 36 on Base line
Hence west var 21° E
- 2000 Set Stake for Temporary 1/8 corner
- 4000 Set Stake for Temporary 1/4 Sec corner
- 8036 The corner to Sec 2 = 3 = 34 & 35 - from which

- I run East on Base line bet Sec 2 & 35-
- 4018 Let Stone 8 x 16 x 19 for $\frac{1}{4}$ sec corner var 21° 30' E
- 6027 Let Stake in mound of Stone for $\frac{1}{4}$ corner
- 8086 The corner to Sec 1 = 2 = 35 & 36 The Post decayed and I Reputed a Stone 6 x 9 x 25 inches
Thence South bet Sec 1 & 2 var 19° 45' E
- 2000 Let Temporary $\frac{1}{8}$ corner
- 8075 The corner to Sec 1 = 2 = 11 & 12 from which I run North var 20° E
- 6056 Let Stone 7 x 10 x 22 for $\frac{1}{8}$ corner
- 8075 The corner to Sec 1 = 2 = 35 & 36
The $\frac{1}{8}$ corner on west Boundary N $\frac{1}{4}$ Sec 2
Thence East var 21° E
- 6000 Let Temporary $\frac{1}{16}$ corner
- 8018 The $\frac{1}{8}$ corner on East Boundary N $\frac{1}{4}$ Sec 2 from which I run West
- 2004 $\frac{1}{2}$ Let Stone 12 x 18 x 26
The corner Sec 1 = 2 = 11 & 12
Thence West var 19° E
- 2000 Let Temporary $\frac{1}{8}$ corner
- 4026 The $\frac{1}{4}$ Sec corner bet Sec 1 & 12 from which I run East-
- 2018 Let Stone 9 x 9 x 31 for $\frac{1}{8}$ corner
Thence North var 21° E
- 6040 The $\frac{1}{16}$ corner in center N $\frac{1}{4}$ Sec. 2 above 12 x 18 x 26

JW Kimbrell County Surveyor

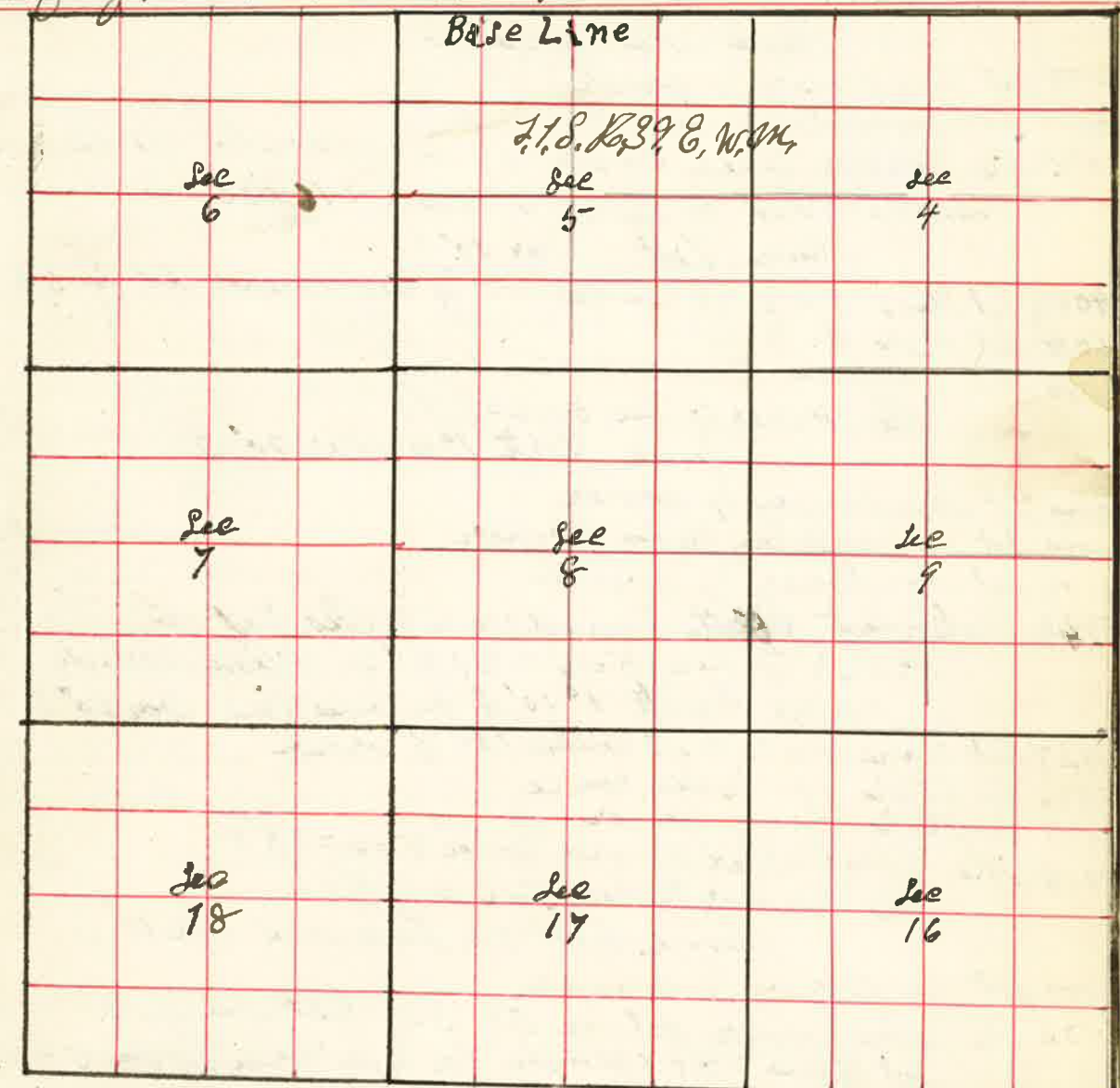

- I Commenced at the to Sec 4 = 5 = 32 & 33 on Base line between T. 1 N. & T. 2 S. Range 39 E. W. 34
- Thence South between Sec 4 & 5 var. 21° 30' E
- 1964 Let Temporary $\frac{1}{8}$ corner
- 3964 Let Temporary $\frac{1}{4}$ Sec corner
- 5964 Let Temporary $\frac{1}{8}$ corner
- 7964 Intersect E & W line 9 fms West of corner to Sec 4 = 5 = 32 & 33 Post decayed and I Reputed a stone 6 x 10 x 26 inches
Thence North 2° W var 20° E
- 2000 Let Stone 6 x 9 x 28 for $\frac{1}{8}$ corner
- 4000 Let Stone 6 x 9 x 22 for $\frac{1}{4}$ Sec corner between Sec 4 & 5-
- 6000 Let Stone 6 x 8 x 36 for $\frac{1}{8}$ corner
- 7964 The corner to Sec 4 = 5 = 32 & 33 on Base line