

Fractional
Township N^o 6 North Range N^o 30 East of the Willamette Meridian, Oregon

G F E D C B A

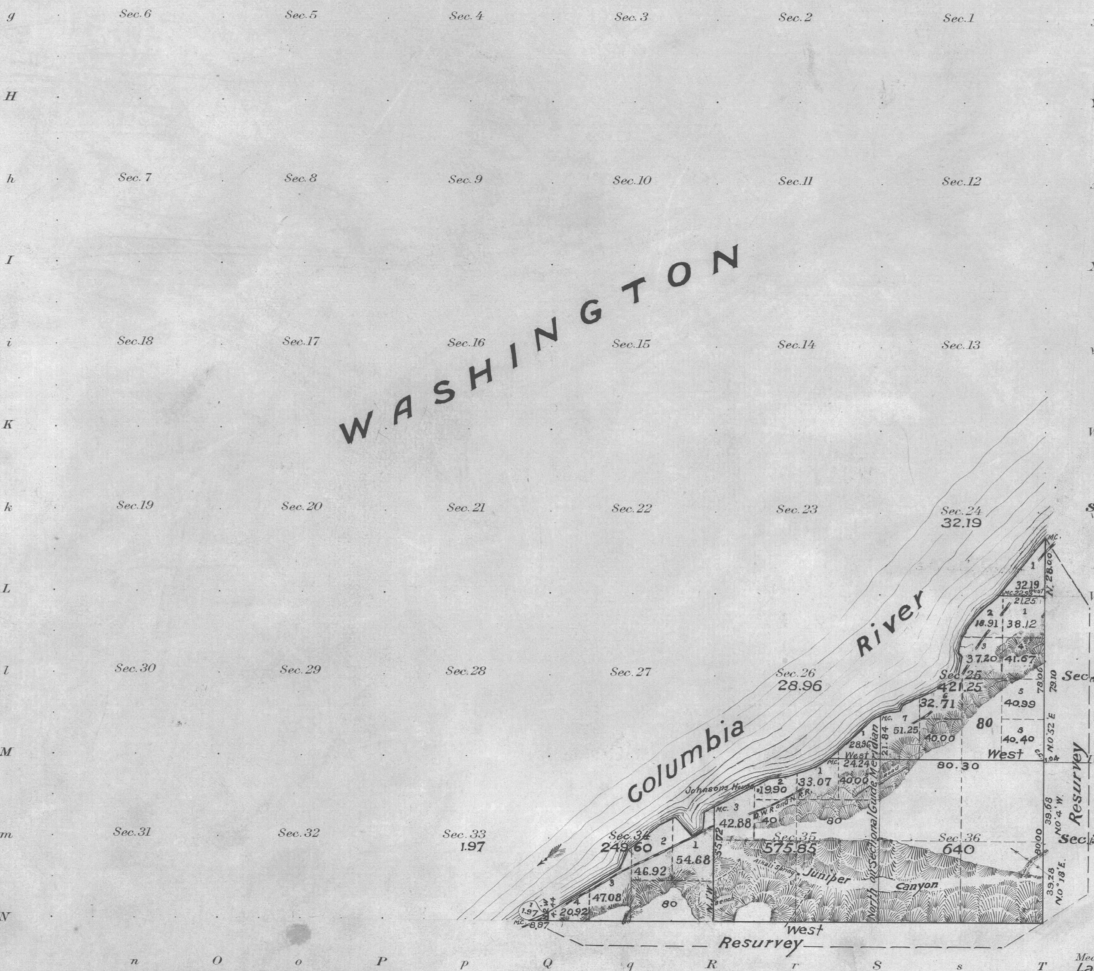

Meanders of Columbia River.	
Left bank, down stream	Left bank, down stream
Sec. 24.	Sec. 35.
S. 39° 23' W. 36.23	S. 55° 00' W. 6.80
Sec. 25.	Sec. 36.
S. 48° 30' W. 11.20	S. 83° 30' W. 9.60
S. 34° 00' W. 11.90	S. 65° 00' W. 10.20
S. 18° 00' W. 7.70	S. 60° 00' W. 19.30
S. 26° 30' E. 2.90	Sec. 34.
S. 8° 00' W. 7.50	S. 60° 00' W. 4.00
S. 47° 30' W. 4.70	S. 5° 00' W. 10.00
S. 63° 15' W. 27.80	S. 65° 45' W. 5.00
S. 37° 00' W. 5.00	N. 46° 30' W. 13.00
S. 80° 00' W. 10.00	S. 66° 00' W. 8.40
Sec. 26.	S. 30° 00' W. 20.00
S. 70° 00' W. 4.00	S. 23° 00' W. 3.50
S. 45° 00' W. 29.00	S. 57° 00' W. 41.00
	Sec. 33.
	S. 63° 25' W. 9.92

Areas in Acres	
Public Land	1949.82
Indian Reservation	
Indian Allotments	
Mineral Claims	
Water Surface	
Total Area	1949.82

Scale 40 Chains to an inch
Mean Magnetic Declination, 21° 45' E.
Latitude 43° 37' N.
Longitude 119° 00' W

Surveys Designated	By Whom Surveyed	Copy No.	Special Instructions	Date	Amount of Surveys		When Surveyed		
					Mts.	chs.	Begun	Completed	
Subdivisions	Charles M. Galver	7		August 2, 1911	3	49	53	August 15, 1911	August 17, 1911
Meanders	"	7		"	4	20	25	"	"
Eand S. Bdy's (Resurvey)	"	7		"	5	34	93	"	"
Connections	"	7		"	0	1	04	"	"

The above map of Township No. 6 North Range No. 30 East of the Willamette Meridian Oregon is strictly conformable to the field notes of the survey thereof on file in this office, which have been examined and approved

U. S. Surveyor General's Office.

Portland Oregon, March 7, 1914

Edmund Worth
Surveyor General for Oregon.