

Survey of small island & Meanders of Switzler & Meredith Islands
T 5 N R 30 E W M

Chains To determine the distance across the branch of the Columbia River, I set a flag on the island, on line, thence I run E., 20.00 chs. to a point "C".

From "C" flag brs. N.41°15' W.

From flag, "C" brs. S.41°15' E.

Distance from Meander Cor. to flag is cotangent 41° 15' X 20.00 chs. equals 1.14028 X 20 equals 22.80 chs., which added to 30.78 chs. makes

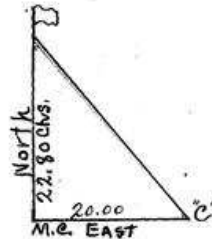

53.58 Intersect the mean high water line on the S. bank of the Island.

Set an iron rod, 30 ins. long, 1 in. diam., 41 ins. in the ground, mkd. MC on the top, and on this rod, set a basalt stone, 12 x 10 x 8 ins., 8 ins. in ground, for Meander Cor. of frac. Secs. 4 & 5, marked MC on S. face; with 4 grooves on E. face; dig a pit, 36 x 36 x 12 ins., 8 ft. N. of stone; and raise mound of earth, 4 ft. base, 2 ft. high, N. of Cor.

Thence I run N., over level land, across the island.

62.94 Intersect the mean high water line on N. bank of the island.

Set basalt stone, 16 x 12 x 8 ins., 11 ins. in ground, for Meander Cor. of frac. Secs. 4 & 5, marked MC on N. face; with 4 grooves on E. face; dig a pit, 36 x 36 x 12 ins., 8 ft. S. of stone; and raise mound of earth, 4 ft. base, 2 ft. high, S. of Cor.

Land; level.

Soil; rich, mellow sandy loam; 1st rate.

No timber.

Undergrowth, dense willow along the banks.

MEANDERS OF SMALL ISLAND IN SECS. 4 AND 5.

I commence at the Meander Cor. of frac. Secs. 4 & 5 on S. side of the island.

Thence I run, with meanders in Sec.5.

S. 67° 00' W. 3.20 chs.