

Township No. 6 South

Range No. 33 East

Willamette Meridian, Oregon.

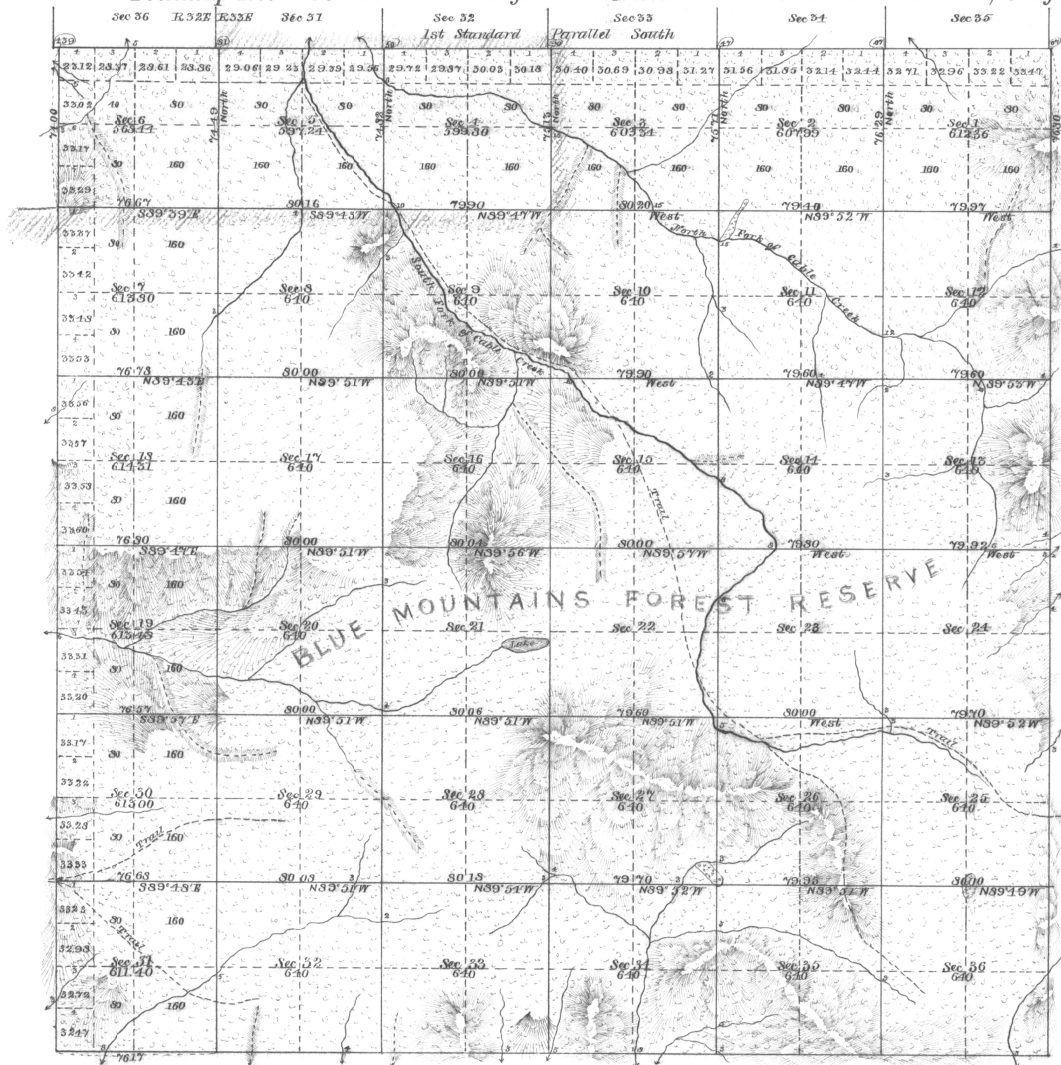

Total number of Acres 22,655.16

SURVEYS DESIGNATED.	BY WHOM SURVEYED.	NO.	DATE OF CONTRACT.	AMOUNT OF SURVEYS.			WHEN SURVEYED.	MEAN DECLINATION.
				Miles.	Chains.	Links.		
Township Lines	F. W. Campbell	468	April 12, 1883					
Subdivisions	do do do	do	do do do	59	37	70	June 24 to July 7, 1883	20° 15' E
Connections	do do do	do	do do do			2		

The above map of...the subdivisions...of Township No. 6 South...of Range No. 33 East...of the Willamette Meridian, Oregon, is strictly conformable to the Field Notes of the survey thereof on file in this office, which have been examined and approved.

U. S. Surveyor-General's Office,

Portland, Oregon,

January 17, 1884, James C. Tolman  
Surveyor-General of Oregon.

