

6-36-A+

Township No 6 North Range No 36 East Willamette Meridian.

Rec'd with Sur Gen's letter of Jan'y 30-1867

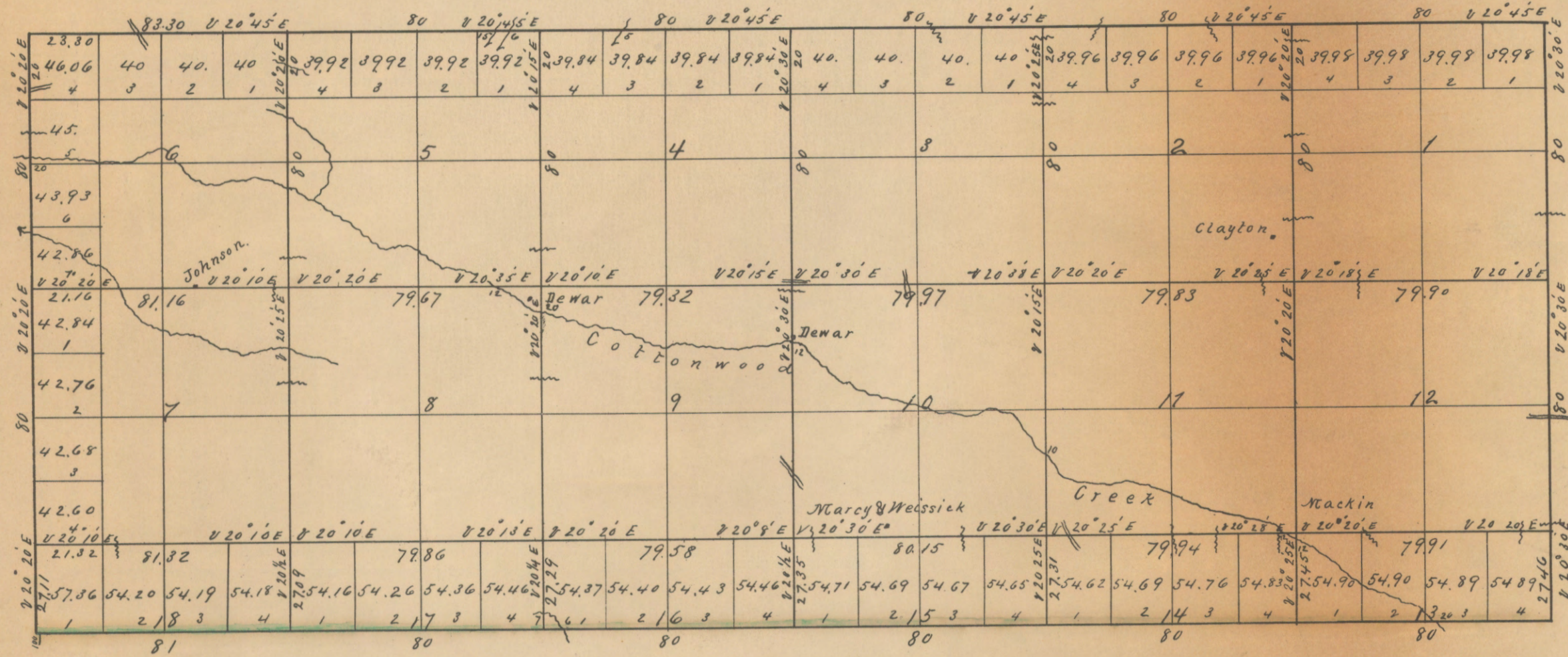

Department of the Interior
General Land Office
Mar 10-1867

I hereby certify that the above is a true photo-lithographic copy of the original on file in this Office.

[Signature]
Acting Commissioner

Surveys designated	By whom Surveyed	Contract		Acre of surveys		When Surveyed	When changed in the Surveyor's account
		No	Date	Miles	Chains		
Subdivisions	Daniel G. Major	72	5 th May 1863	23	57	10	Dec 10 th 1863 to March 22 nd 1864
Extensions N. Bdy.	"	2		2	27	11	March 15 th to May 1864
Total No of Acres		9019.56					

The above map of Township No 6 North of Range No 36 East of the Willamette Meridian in the Territory of Washington is strictly conformable to the field notes of the survey thereof on file in this office which have been examined and approved.
Surveyor General's Office
Olympia W.T. Jan'y 30th 1867

S. S. Field
Surveyor General W.T.