

Township No. 5 South Range No. 32 East Willamette Meridian, Oregon.

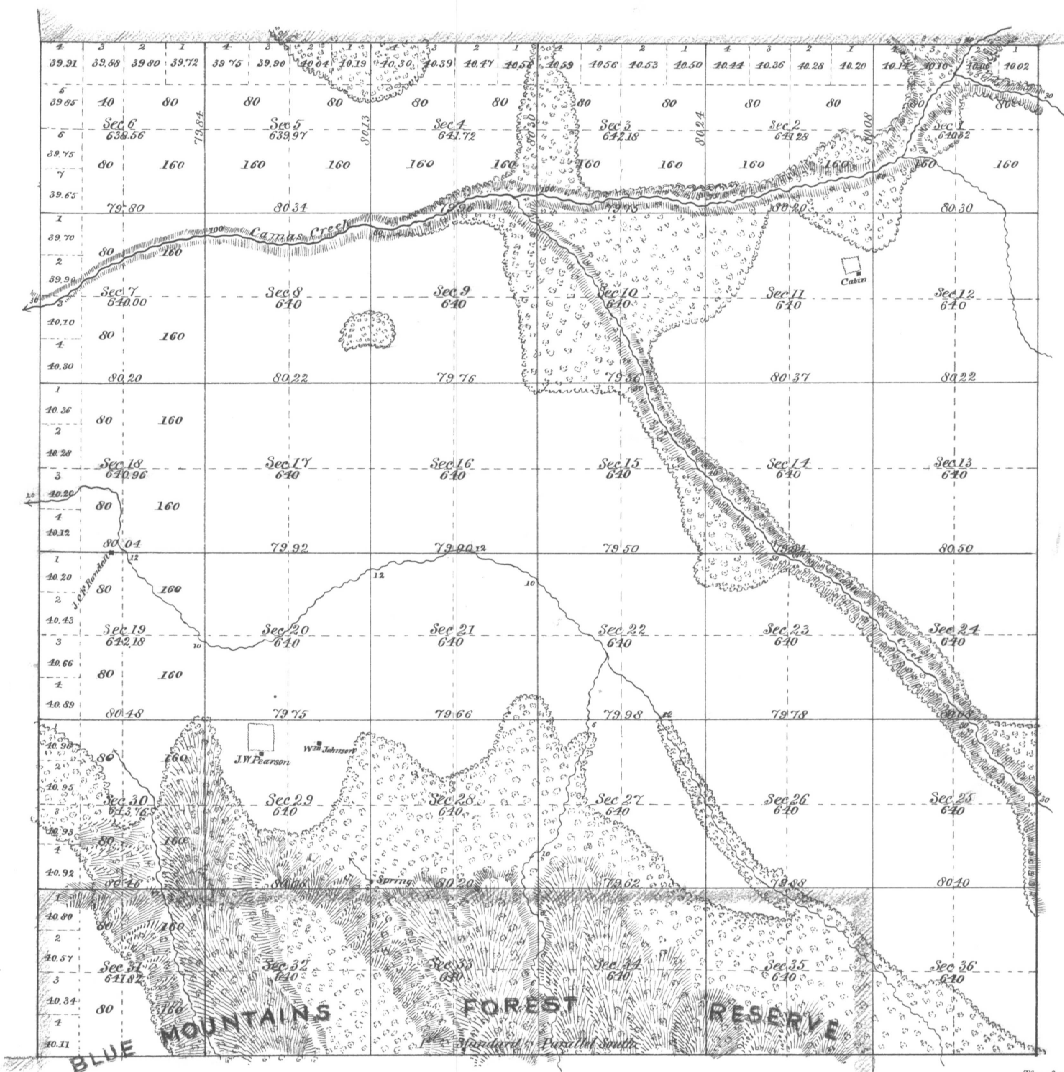

The above Map of the Subdivisions lines of Township No. 5 South Range No. 32 East Willamette Meridian, Oregon, is strictly conformable to the original Field Notes of the survey thereof on file in this Office, which have been examined and approved.  
 U. S. Surveyor-General's Office,  
 Portland, Oregon,

Total number of Acres, 23,052.75  
 SCALE OF CHAINS.  
 0 10 20 30 40 50 60 70 80  
 Contract No. 590

Surveys Designated.	By Whom Surveyed.	Date of Contract.	Amount of Surveys.			When Surveyed.	Magnetic Declination.
			Miles.	Chains.	Links.		
Township Lines Subdivisions	George S. Perahiv do do do	May 12, 1881 do do do	60.	0.1	44	From 1 <sup>st</sup> to 11 1881	Mag. 19° 42' 50"

August 22, 1881 James H. DeLanoy  
 Surveyor-General of Oregon.