

241

Index

Referring the lines to the pages in the field notes.

Town 4 N. Range 35 E. Will. Mer-

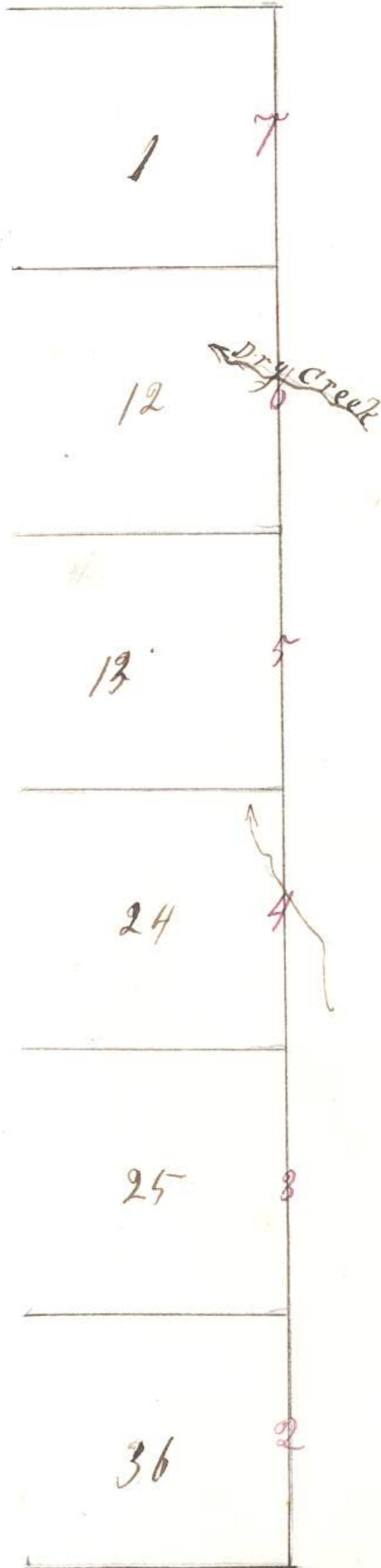

Field notes of the  
survey of the exterior lines  
of Township number  
4 North of Base line of Range  
35 East of Willamette  
Meridian, in the State of  
Oregon, by William H.  
Ozell Deputy surveyor,  
under his contract No. 114  
bearing date July 2<sup>nd</sup>  
1866.

Commenced and  
Completed August 17<sup>th</sup>  
1866.

North on East boundary  
of section 36,

\$ 40.00

Set Post corner for 1/4 section  
above charred stake dug  
pit and raised mound as  
per instructions,

+  
40

Township 4 North Range 35 East

1<sup>st</sup> Rate on hill sides

2<sup>d</sup> rate -

North on East boundary  
of section 1

Bar 20° East,

4,000 Set post corner for <sup>70</sup> 1/4 sections <sup>70</sup>  
on land sloping to the East -  
drove charred stake, dug pit,  
and raised mound as per  
instructions

67.25 Intersected the first <sup>40</sup> Standard <sup>40</sup>  
Parallel North 4.88 chs west of  
post corner for Townships 5  
North Ranges 35 & 36 East,  
Set closing corner for Townships  
4 North Ranges 35 & 36 sections  
1 & 6, drove charred stake,  
dug pit and raised mound  
as per instructions.

Land broken, grass  
excellent, Soil good 2<sup>nd</sup> rate,

Township 40 North Range 35 East

The lands in this Township are well adapted to stock raising, along the water courses the lands are very rich, yielding abundant harvest whenever brought under cultivation.

The up lands are thickly covered with buck grass. Valuable Clinias have been located along the streams and in many places on the up lands. Therefore the Township should be subdivided.

August 17<sup>th</sup> 1866.

A list of the names of the individuals employed to assist in running measuring or marking the lines and corners described in the foregoing field notes of Township number 4 North of the base line of Range 35 East of Willamette Meridian, showing the respective capacities in which they acted:

J. J. Henderson }  
 John A. Bigg } Chairman  
 T. M. Denny Assessor

Return for approval

I William H. Odell, Deputy  
 Surveyor, do solemnly swear that  
 in pursuance of a contract with  
 E. L. Applegate Surveyor of the public lands  
 of the United States in the State of Oregon,  
 bearing date July 2<sup>d</sup> 1866, and in strict  
 conformity to the laws of the United States  
 and the instructions furnished by said  
 Surveyor General, I have faithfully  
 surveyed the exterior boundaries of  
 Township number 4 North of the Base Line  
 of Range 35 East of Willamette Meridian  
 in the State aforesaid, and do further  
 solemnly swear that the foregoing are  
 the true and original field notes of  
 such survey.

William H. Odell

State of Oregon

County of Lane } S.S.

Subscribed and  
 sworn to before me this 23<sup>rd</sup> day of  
 September 1866

Joel Ware  
 Notary Public

250 1/2

250 A

Surveyor General's Office  
Eugene City January 17, 1867

The foregoing field notes of the  
Survey of the Exterior boundaries  
of Township No 4 North Range No  
35 East Will. Mer. Oregon, executed  
by William H. Odell, Deputy Surveyor  
under his contract No 114 bearing date  
July 2nd. 1866 having been critically  
examined, the necessary corrections and  
explanations made the field notes and  
the surveys they describe are hereby  
approved

E. I. Applegate  
Surveyor General of Oregon