

100

Rec'd in Office

137

Nov 4th 1861

137A

Field notes of the exterior bound-
ary lines of Township No 3 N R 31

and of Township No 5 N R 30 East
of the Willamette Meridian sur-
veyed by Dolphus S. Payne, ^{deputy surveyor} under
his Contract No 100 dated August
1st 1861

Town 3 N R 31

Commenced August 20th 1861

Completed August 23rd 1861

Town 5 N R 30

Commenced September 17th 1861

Completed September 17, 1861

80

5-90

74-10

138

138A

Index

Exterior boundaries, T3NR30E and T5NR30E

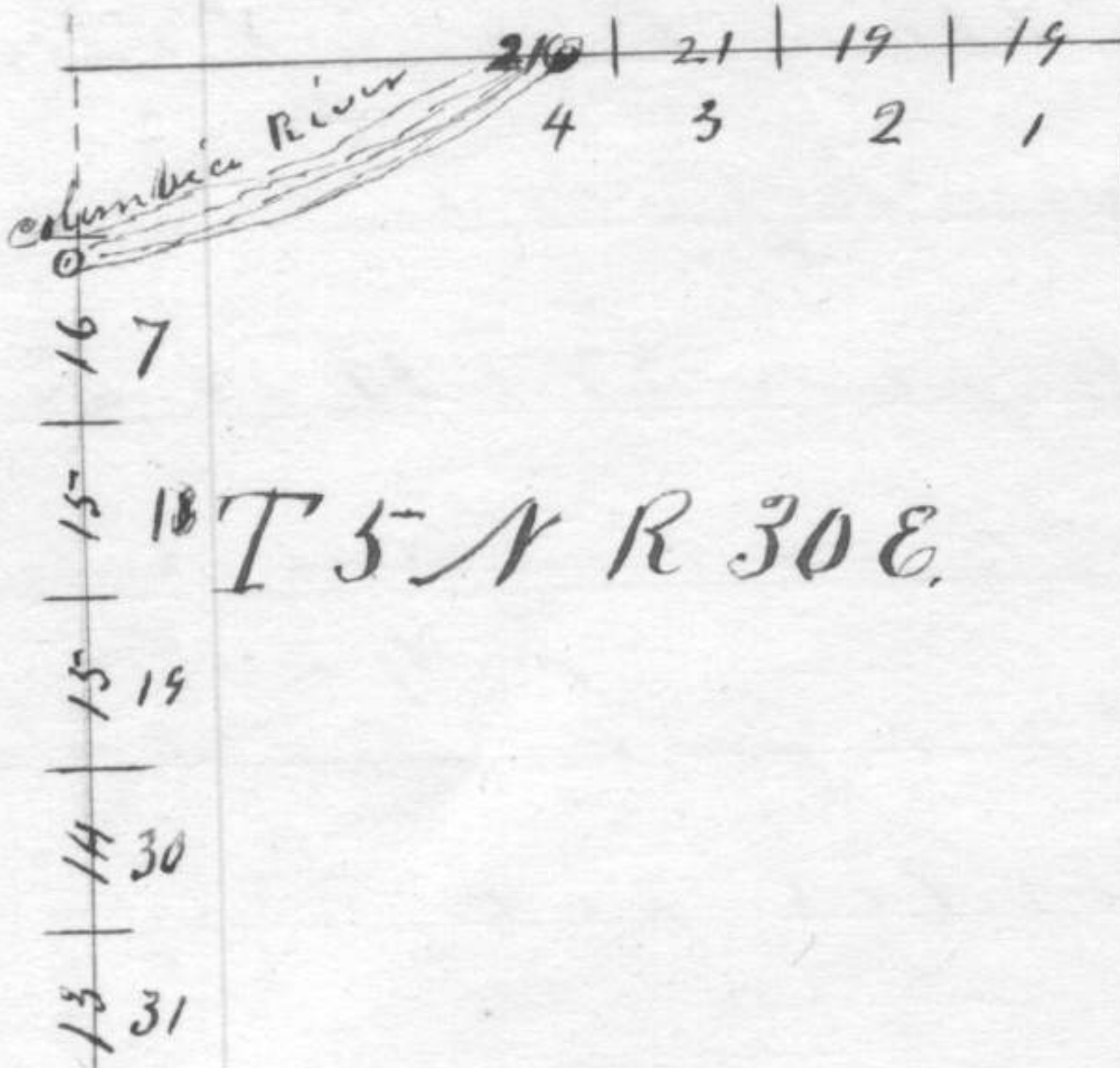

T4NR30E.

4N31E

3NR30E

T3NR31E

4N29

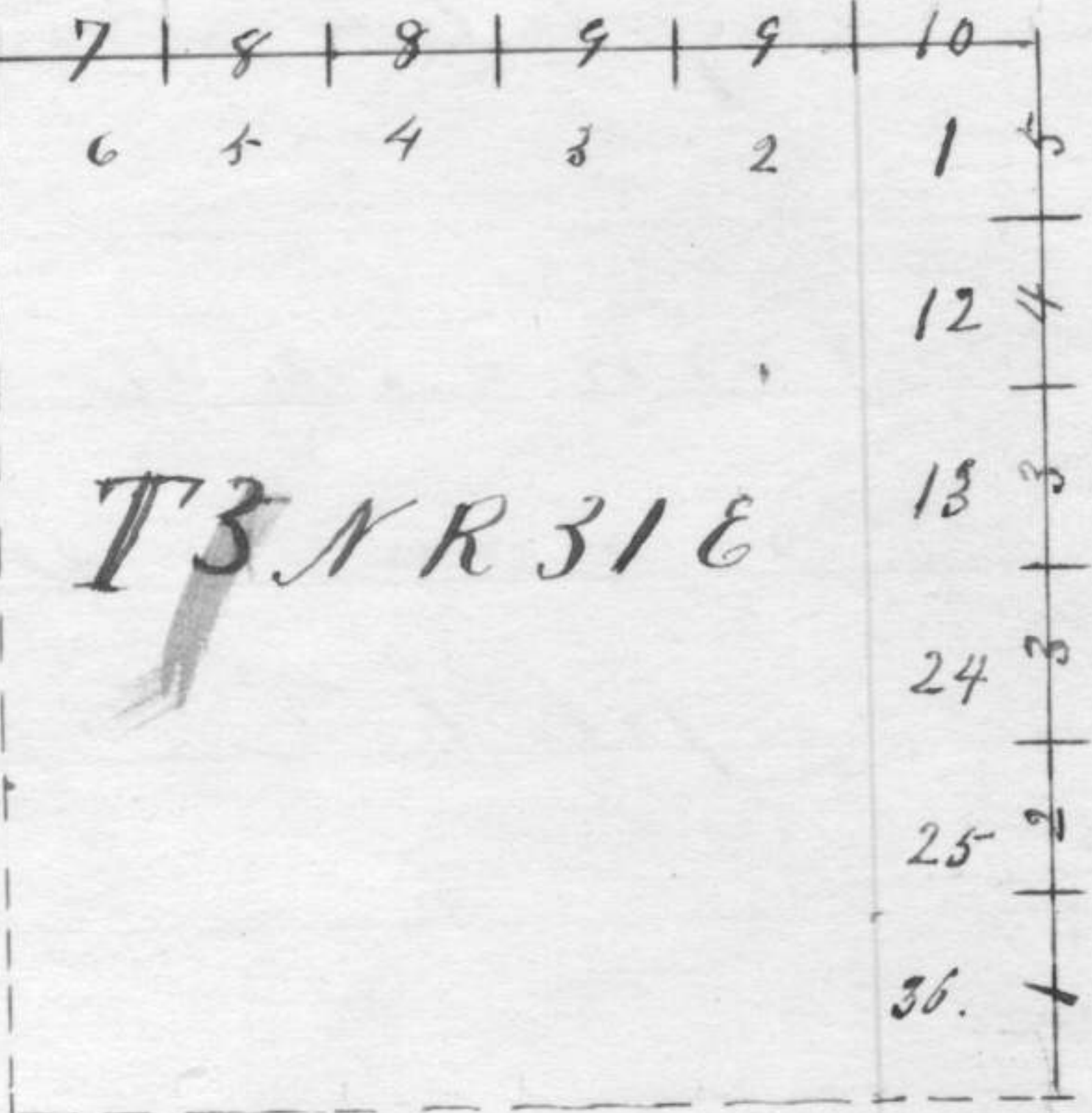

State of Oregon }
 County of Wasco } ss: We, John Brattain

William B. Pengra, having been
 appointed Chairman in the service
 of A. S. Payne, deputy surveyor of the
 lands of the United States in Oregon
 do solemnly swear that we will
 faithfully execute the duties of
 Chain Carriers; - that we will
 level the chain upon uneven
 ground and plumb the tally
 pins whether by sticking or drop-
 ping the same; that we will
 report the true distance to all
 notable objects and the true
 length of all lines that we
 assist in measuring to the
 best of our skill and ability.

Subscribed & sworn }
 before me this 12th }
 day of August 1861 }
 W. C. Murray }
 County Clerk }

John Brattain
 W. B. Pengra

140

140A

State of Oregon }
County of Wasco } ss:

The John L.
Luc Key, & Benjamin F. Crow having
been appointed axemen in the
service of A. S. Payne, deputy surveyor
of the lands of the United States in
Oregon do solemnly swear that
we will perform the duties of
axemen or flagmen according
to instructions given us and to
the best of our skill and ability.

Subscribed & sworn to }
before me this 12th }
day of August 1861 }

Jno L. Lenokey
B. F. Crow,

W. C. Murray
County Clerk

Township 5 N R 30 E 153A

Field notes of the exterior
boundary lines of Township
No 5 North of range No 30 East
of the Willamette Meridian,

Chonis

September 17th

West boundary T 5 N R 30 E
Beginning at the S.E. corner
of T 3 R 29, S.W. corner of
T 5, R 30 on the 1st Standard
Parallel North,

Nov 19th 31 E

North on the west boundary of
Section 31, T 5 R 30

40.00 Set Charred Stake with
round trench and pits
as per instructions for
Section Corner,

80.00 Set Charred Stake with
round trench and pits
as per instructions for corner

154 154A¹⁴

West-Boundary

Chamis

to Secs 30 & 31, T5, R30
and Secs 25 & 26 T3 R
29E - Var 19°30'E -
Sand rolling. Soil 2^o rate

North on line between Secs 30 R. 31
& 25 R 29.

40.00 Set charred stake with
mound trench and pits as
pr. instructions for gr. section
corner.

48.00 Top of hill descending towards
the Columbia river. Height
about 600 feet.

64.50 Indian trail (N 45° W)

80.00 Set charred stake with
mound trench and pits as
pr. instrs. for corner to Secs
19 & 20 R 30 E and 24 & 25
R 29 E. - Var 19°39'E
Soil sandy. Soil 3^o rate

Township 3rd N R 30 EChains

North on line between Secs 19 R
30 & 24, R 29 E -

40.00 Set Charred Stake with mound
trench and pits as per instrs,
for q.r. Sec. Corner.

80.00 Set Charred Stake with mound
trench and pits as per instrs,
for corner to Secs 18 & 19 R 30
and 13 & 24 R 29 E.

Var $19^{\circ} 39' E$

Soil 2^o rate.

North on line between Secs 18 R 30 & 13
R 29 E.

31.50 Ascend Rocky bluff, bank
about 25 feet in height, E & W.

40.00 Set Charred Stake with mound
trench and pits as per instrs,
for q.r. Sec. Corner.

80.00 Set Charred Stake with mound
trench and pits as per instrs,
for corner to Secs 7 & 18 R 30

156 156A 14

West- Boundary

Chains

and 12813 R29E -

(Var 19° E -

This mile sandy and rough.
Some Sage Brush.

North on line between Secs 7 R30
and 12 R29E.

8.00 Trail N 70° E.

8.18 Edge of Slough. Bluff bank
about 40 feet in height.

Set Charred Stake with mound
trench and pits for meander
corner.

Set up flag for object to tri-
angulate to from the north
side of Slough.

Regain the line on the North
bank of Slough, offset 2.00
chains due west, object on
South bank bears south
12° 24' East making the

157

17

Township 3^d N R 31 E 157

Chains

17.32 Width of the Slough 9.14 Chains
to North bank of Slough.

Set meander post with mound trench and pits as per instructions.

40.00 Set Charred Stake with mound trench & pits as per instrs. for gr. Sec corner.

67.00 South bank of the main channel of the Columbia river. Set Charred Stake with mound trench and pits as per instrs. for meander corner between fractional Secs 7 & 12 -
Var 19° 43' E.

On this line the land is rough broken and sandy to the south side of Slough. After crossing the Slough the land is level and produces a large crop of grass.

158

158

187

Chamis

- mild sun flowers and other
vegetation,

Soil sandy - apparently
not subject to inundation.

170

170

Soil generally good, Timber
scarcely - found only along
the Columbia River. But
for grazing purposes
it is unsurpassed &
should therefore be
subdivided

List of Names.

A list of the names of the
individuals employed in
re-surveying measuring or
marking the lines and
corners described in
the foregoing field notes
of the ~~of~~ Lewis & Clark
by lines of Township
N 3 North Range 31
East, and of township
N 5 North R. 30 East

of the Willamette Meridian
Showing the respective Ca-
pacities in which they
were

John Bratten Chairman
William B. Payne, Chairman
John L. Lueky, Assessor,

We hereby certify that we
assisted Joseph S. Payne
deputy Surveyor in Sur-
veying the exterior bound-
ary lines of Township
No 3 North Range 31 East
and of Township No 5
North Range 30 East of
the Willamette Meridian
and that said lines
have been in all respects

172

172

to the best of our knowledge
and belief well and
faithfully surveyed and
the boundary monuments
planted according to the
instructions furnished
by the Surveyor General.

John Brattain, Chairman
W. B. Pengra, Chairman
John L. Luekey Assessor

Subscribed and sworn by the
above named persons before me
a Justice of the Peace in & for
the County of Lane State of
Oregon, this 1st day of November
A.D. 1861

R. O. Parsons
Justice Peace

I Dolphus S. Payne, deputy
surveyor do solemnly swear
that, in pursuance of a contract
with B. J. Pungra Surveyor of the
public lands of the United States
in the State of Oregon bearing
date the First day of August
1861, and in strict conformity
to the laws of the United States
and the instructions furnished
by the said Surveyor General, I
have faithfully surveyed the
exterior boundaries of Townships
Numbers three and five north
of the base line of Range Number
thirty & thirty one East of the
Millomets Meridian in the State
aforesaid, and do further solemnly
swear that the foregoing are the true
and original field notes of such
survey.

Dolphus S. Payne

174
174

The foregoing affidavit was
subscribed and sworn before me
this 4th day of November A.D. 1861

B. P. Pringle
Surreal General
of Oregon

175
175

Surveyors Office at
Salem City Dec 5th 1861

The foregoing field notes of the
Survey of the exterior boundaries
of Townships 3 & 5 North of the
base line of Ranges Nos 30 & 31
East of the Willamette Meri-
dian in the State of Oregon
executed by Dolphus Payne
under his Contract No 105 da-
ted August 1st 1861 having
been critically examined the
necessary corrections & explanations
made the said field notes
and the Surveys they de-
scribe are hereby approved

J. P. Sibley
Surveyor General