

241

Index

Referring the lines to the pages in the field notes.

Town 4 N. Range 35 E. Will. Mer-

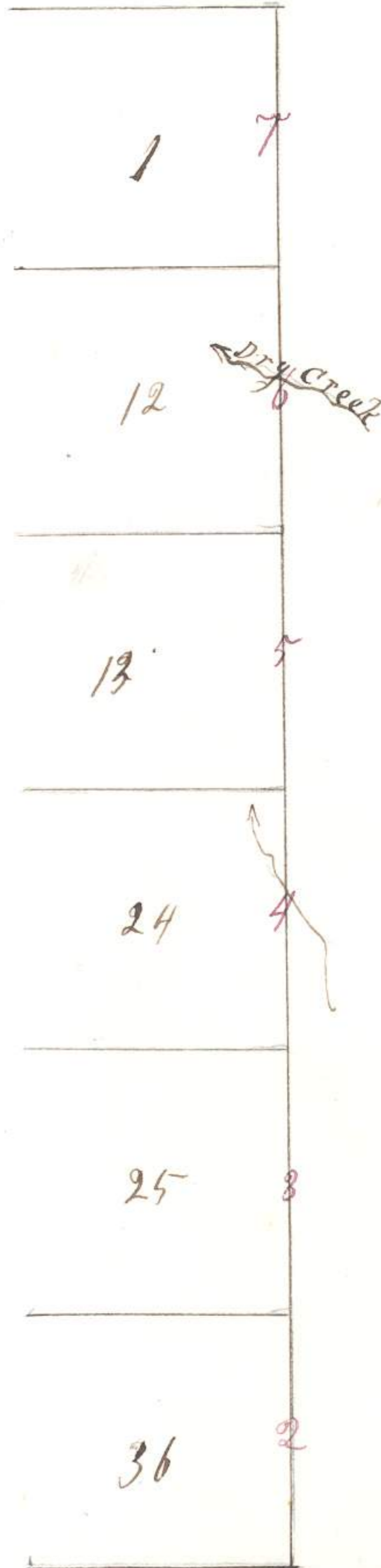

Field notes of the
survey of the exterior lines
of Township number
4 North of Base line of Range
35 East of Willamette
Meridian, in the State of
Oregon, by William H.
Ozell Deputy surveyor,
under his contract No. 114
bearing date July 2nd
1866.

Commenced and
Completed August 17th
1866.

North on East boundary
of section 36,

\$ 40.00

Set Post corner for 1/4 section
above charred stake dug
pit and raised mound as
per instructions,

+
40

3-243

Township 4 North Range 35 East

80,000 Set post corner for section 25, 30 & 31, on side hill facing the East, drove charred stake, dug pits, and raised mound as per instructions. 60

25. 30 & 31, on side hill facing the East, drove charred stake, dug pits, and raised mound as per instructions.

This line passes along the side of a ravine course south, Grass good, soil 2nd Rate, some Pine timber in the ravine a short distance the East.

North on East boundary of section 35,

Var, 20° 30' East 75

40,000 Set post corner for 1/4 section on level, on summit of divide between Pine Creek and Dry Creek, drove charred stake, dug pits, 75

on level, on summit of divide between Pine Creek and Dry Creek, drove charred stake, dug pits,

Township 4 North Range 35 East - ⁴ 244

and raised mound as
per instructions,

80.00 Set post corner for sections +
100

24, 25, 26 & 30, on land
sloping to N. E. drove
churched stake, dug pit,
and raised mound as
per instructions,

Land broken,
grass good, soil 2nd Rate,

North on East boundary
of section 24,

Bar 21° East -

40.00 Set post corner for 1/4 section 100

on hill side facing the N. E.,
dug pit and raised mound
as per instructions,

48.10 Small bunch 3 lbs wide 60

70.00 Summit of ridge +
100

80.00 Set post corner for sections 60

25

245

Township 4 North Range 35 East

13. 24. 1878, in a curve
course North West, drove
charred stake, dug pits,
and raised mound as per
instructions,
Land broken, grass good,
Soil 2^d Rate,

North on East boundary
of section 13.

bar 21° East

40.00 Set post corner for 1/4 section ⁺50
on West side of hill,
drove charred stake dug pits
and raised mound as per
instructions.

80.00 Set post corner for sections, 12, 13 ⁺30
7 & 18, on land sloping to the
North, drove charred stake,
dug pits and raised mound
as per instructions -

Township 4 North Range 35 East

Land broken, grass excellent, Soil 2^d Rate

North on East boundary of section 12.

Var. 21° East

32.80 Enter field course of fence N. W. & S. E. 150

40.00 Set post corner for 1/4 section from which

A Balon 5 in. dia. bears S 50° E. 65 the do, do - 20 do - do - do - N 80° W 431 do -

45.00 Dry Creek channel dry course N W

47.00 Leave field

80.00 Set post corner for sections 1. 150

12. 5 & 7. hill sloping to the west - drove charred stakes, dug pits, and raised mound as per instructions.

Land broken, grass excellent, soil in field

Township 4 North Range 35 East

1st Rate on hill sides

2^d rate -

North on East boundary
of section 1

Bar 20° East,

4,000

Set post corner for 1/4 sections

70

on land sloping to the East -
drove charred stake, dug pit,
and raised mound as per
instructions

67.25

Intersected the first Standard

40

Parallel North 4.88 chs west of

post corner for Townships 5

North Ranges 35 & 36 East,

Set closing corner for Townships

4 North Ranges 35 & 36 sections

1 & 6, drove charred stake,

dug pit and raised mound

as per instructions.

Land broken, grass

excellent, Soil good 2^d rate,

Township 40 North Range 35 East

The lands in this Township are well adapted to stock raising, along the water courses the lands are very rich, yielding abundant harvest whenever brought under cultivation.

The up lands are thickly covered with buck grass. Valuable Clinias have been located along the streams and in many places on the up lands. Therefore the Township should be subdivided.

August 17th 1866.

A list of the names of the individuals employed to assist in running measuring or marking the lines and corners described in the foregoing field notes of Township number 4 North of the base line of Range 35 East of Willamette Meridian, showing the respective capacities in which they acted:

J. J. Henderson	} Chairman
John A. Bigg	
T. M. Denny Assessor	

None for assessor

250

I William H. Odell, Deputy
surveyor, do solemnly swear that
in pursuance of a contract with
E. L. Applegate surveyor of the public lands
of the United States in the State of Oregon,
bearing date July 2^d 1866, and in strict
conformity to the laws of the United States
and the instructions furnished by said
Surveyor General, I have faithfully
surveyed the exterior boundaries of
Township number 4 North of the Base Line
of Range 35 East of Willamette Meridian
in the State aforesaid, and do further
solemnly swear that the foregoing are
the true and original field notes of
such survey.

William H. Odell

State of Oregon

County of Lane } ss. Subscribed and
sworn to before me this 23^d day of
September 1866

Joel Ware
Notary Public

250 1/2

250 A

Surveyor General's Office
Eugene City January 17, 1867

The foregoing field notes of the
Survey of the Exterior boundaries
of Township No 4 North Range No
35 East Will. Mer. Oregon, executed
by William H. Odell, Deputy Surveyor
under his contract No 114 bearing date
July 2nd. 1866 having been critically
examined, the necessary corrections and
explanations made the field notes and
the surveys they describe are hereby
approved

E. I. Applegate
Surveyor General of Oregon