

# Index

Referring the lines to the pages in the field notes

## Town 3 N. Range 35 E. Will-Mer-

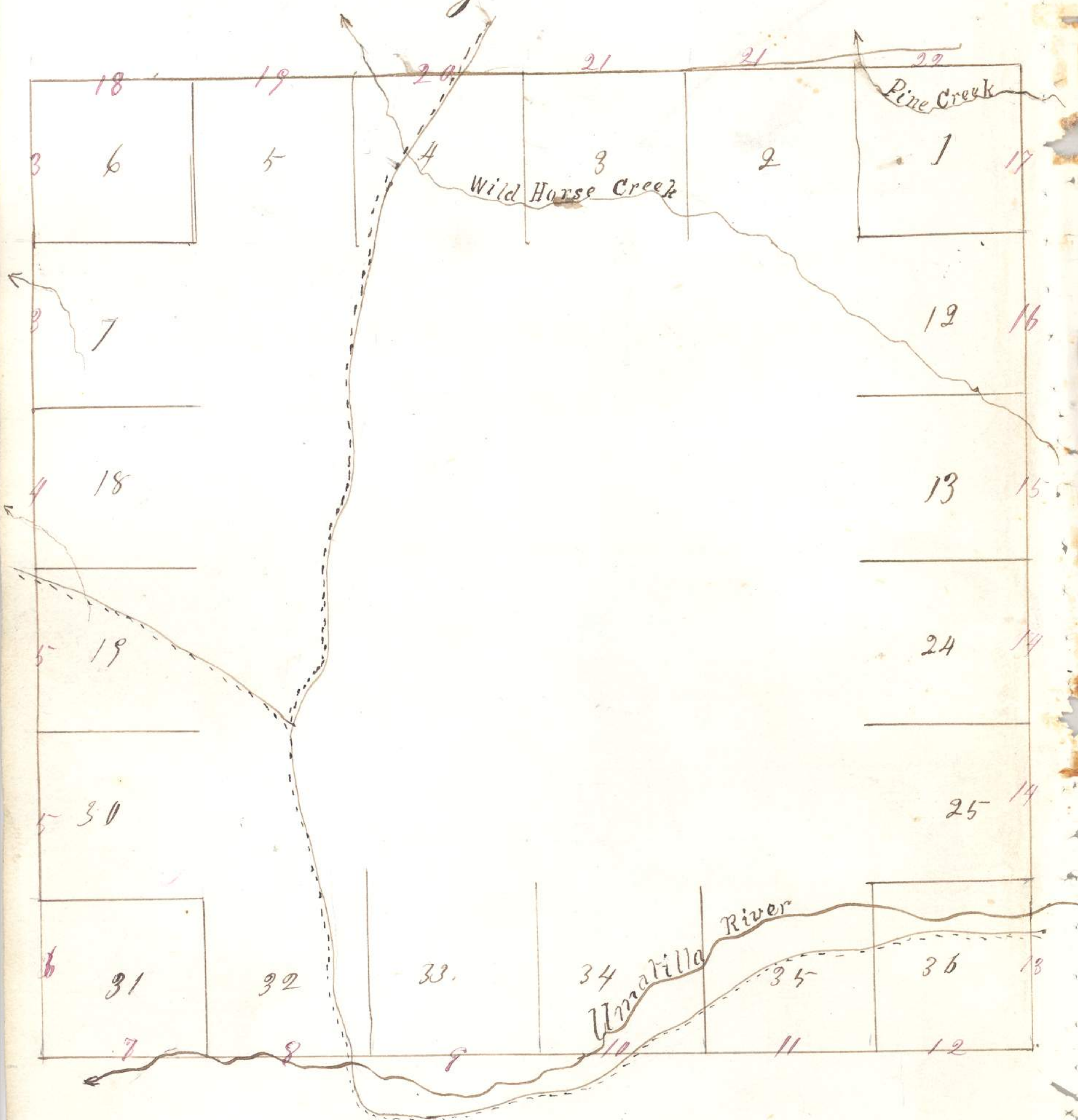



Field notes of the survey  
of the exterior lines of Township  
number 3 North of Range 35  
East of Willamette Meridian  
in the State of Oregon, by  
William H. Odell Deputy  
Surveyor, under his contract  
No. 114 bearing date July 2<sup>d</sup>  
1866.

Commenced July 26<sup>th</sup>  
and completed  
July 31<sup>st</sup> 1866.



227

Township 3 North Range 35 East

and raised mound as per instructions.

Land broken, good grass soil 2<sup>nd</sup> Rate,

North on East boundary of section 1.

Bar 20° East.

40.00 Set post corner for 1/4 section 50-50

on side hill facing the West dug pits and raised mound as per instructions

66.00 Pine Creek 8 lbs wide course <sup>200</sup> 200

West

80.00 Set post corner for Township <sup>75</sup> 75

344 North Ranges 35 & 36 East,

sections 1, 6, 31 & 36. Muck Stone

Mound as per instructions

Land broken, good

grass, some timber on south

side of pine Creek



A list of the names of the individuals employed to assist in running, measuring or marking the lines and corners described in the foregoing field notes of Township number 3 North of the base line of Range 35 East of Willamette Meridian, - showing the respective capacities in which they acted:

J. J. Henderson  
 John A. Bigg } Chairman  
 P. M. Denney Axeman

Room for affidavit -



I William H. Bell Deputy  
 Surveyor, do solemnly swear  
 that in pursuance of a contract  
 with E. L. Applegate surveyor  
 of the public lands of the  
 United States in the State of  
 Oregon; bearing date July 2<sup>d</sup> 1866., and in  
 strict conformity to the laws of the United  
 States and the instructions furnished by the  
 said Surveyor General, I have faithfully  
 surveyed the exterior boundaries of  
 Township number 3 North of the Base Line  
 of Range 35 East of Willamette Meridian  
 in the State aforesaid, and do further  
 solemnly swear that the foregoing are  
 the true and original field notes of  
 such survey.

William H. Bell

State of Oregon }  
 County of Lane } ss. Subscribed and  
 sworn to before me this 23<sup>d</sup> day  
 of December 1866.

Joel Mare P  
 Notary Public



237

Surveyor General's Office

Eugene City January 17, 1867

The foregoing field notes of the survey of the exterior boundaries of Township N<sup>o</sup> 3 North Range 35 East Will. Mer Oregon. Executed by William H. Odell Deputy Surveyor under his contract N<sup>o</sup> 114 bearing date July 2nd. 1866 having been critically examined the necessary corrections and explanations made the field notes and the surveys they describe are hereby accepted and approved.

E. L. Applegate

Surveyor General of Oregon