

241

Index

Referring the lines to the pages in the field notes.

Town 4 N. Range 35 E. Will. Mer-

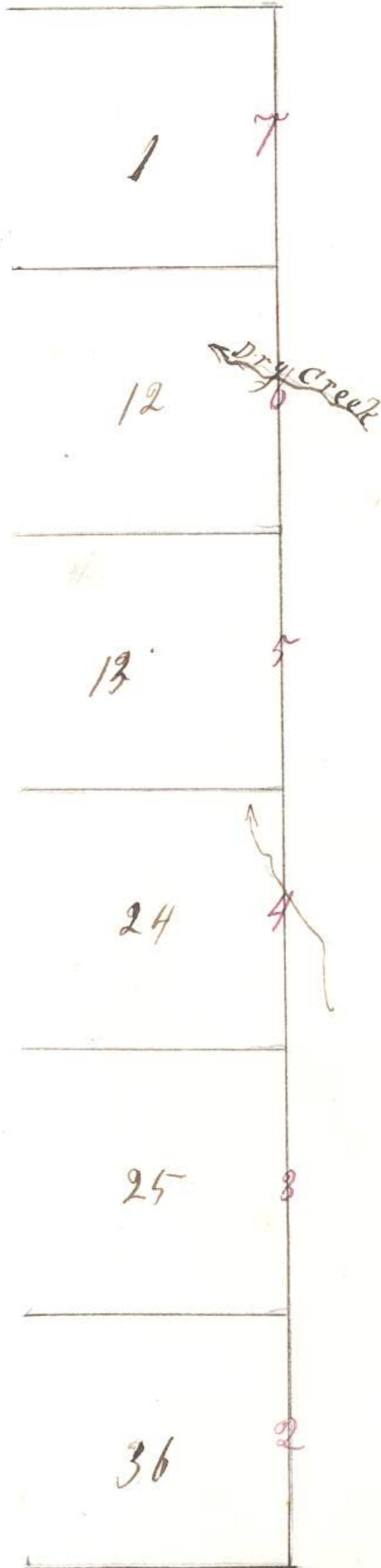

Field notes of the
survey of the exterior lines
of Township number
4 North of Base line of Range
35 East of Willamette
Meridian, in the State of
Oregon, by William H.
Ozell Deputy surveyor,
under his contract No. 114
bearing date July 2nd
1866.

Commenced and
Completed August 17th
1866.

North on East boundary
of section 36,

\$40.00

Set Post corner for 1/4 section
above charred stake dug
pit and raised mound as
per instructions,

+
40

Township 4 North Range 35 East

1st Rate on hill sides

2^d rate -

North on East boundary
of section 1

Bar 20° East,

4,000 Set post corner for 1/4 sections ⁷⁰ 70
on land sloping to the East -
drove charred stake, dug pit,
and raised mound as per
instructions

67.25 Intersected the first Standard ⁴⁰ 40
Parallel North 8.88 chs west of
post corner for Townships 5
North Ranges 35 & 36 East,
Set closing corner for Townships
4 North Ranges 35 & 36 sections
1 & 6, drove charred stake,
dug pit and raised mound
as per instructions.

Land broken, grass
excellent, Soil good 2^d rate,

Township 4 North Range 35 East

The lands in this Township are well adapted to stock raising, along the water courses the lands are very rich, yielding abundant harvest whenever brought under cultivation.

The up lands are thickly covered with buck grass. Valuable Clinias have been located along the streams and in many places on the up lands. Therefore the Township should be subdivided.

August 17th 1866.

A list of the names of the individuals employed to assist in running measuring or marking the lines and corners described in the foregoing field notes of Township number 4 North of the base line of Range 35 East of Willamette Meridian, showing the respective capacities in which they acted:

J. J. Henderson	} Chairman
John A. Bigg	
T. M. Denny	Assessor

None for assessor

I William H. Odell, Deputy
 Surveyor, do solemnly swear that
 in pursuance of a contract with
 E. L. Applegate surveyor of the public lands
 of the United States in the State of Oregon,
 bearing date July 2^d 1866, and in strict
 conformity to the laws of the United States
 and the instructions furnished by said
 Surveyor General, I have faithfully
 surveyed the exterior boundaries of
 Township number 4 North of the Base Line
 of Range 35 East of Willamette Meridian
 in the State aforesaid, and do further
 solemnly swear that the foregoing are
 the true and original field notes of
 such survey.

William H. Odell

State of Oregon

County of Lane } S.S.

Subscribed and
 sworn to before me this 23^d day of
 September 1866

Joel Ware
 Notary Public

250 1/2

250 A

Surveyor General's Office
Eugene City January 17, 1867

The foregoing field notes of the
Survey of the Exterior boundaries
of Township No 4 North Range No
35 East Will. Mer. Oregon, executed
by William H. Odell, Deputy Surveyor
under his contract No 114 bearing date
July 2nd. 1866 having been critically
examined, the necessary corrections and
explanations made the field notes and
the surveys they describe are hereby
approved

E. I. Applegate
Surveyor General of Oregon