

100

Rec'd in Office

137

Nov 4<sup>th</sup> 1861

137A

Field notes of the exterior boundary lines of Township No 3 N R 31

and of Township No 5 N R 30 East of the Willamette Meridian surveyed by Dolphus S. Payne, <sup>deputy surveyor</sup> under his Contract No 100 dated August 1<sup>st</sup> 1861

Town 3 N R 31

Commenced August 20<sup>th</sup> 1861

Completed August 23<sup>rd</sup> 1861

Town 5 N R 30

Commenced September 17<sup>th</sup> 1861

Completed September 17, 1861

80  
5-90  
74-10

138

138A

Index

Exterior boundaries, T3NR30E and T5NR30E

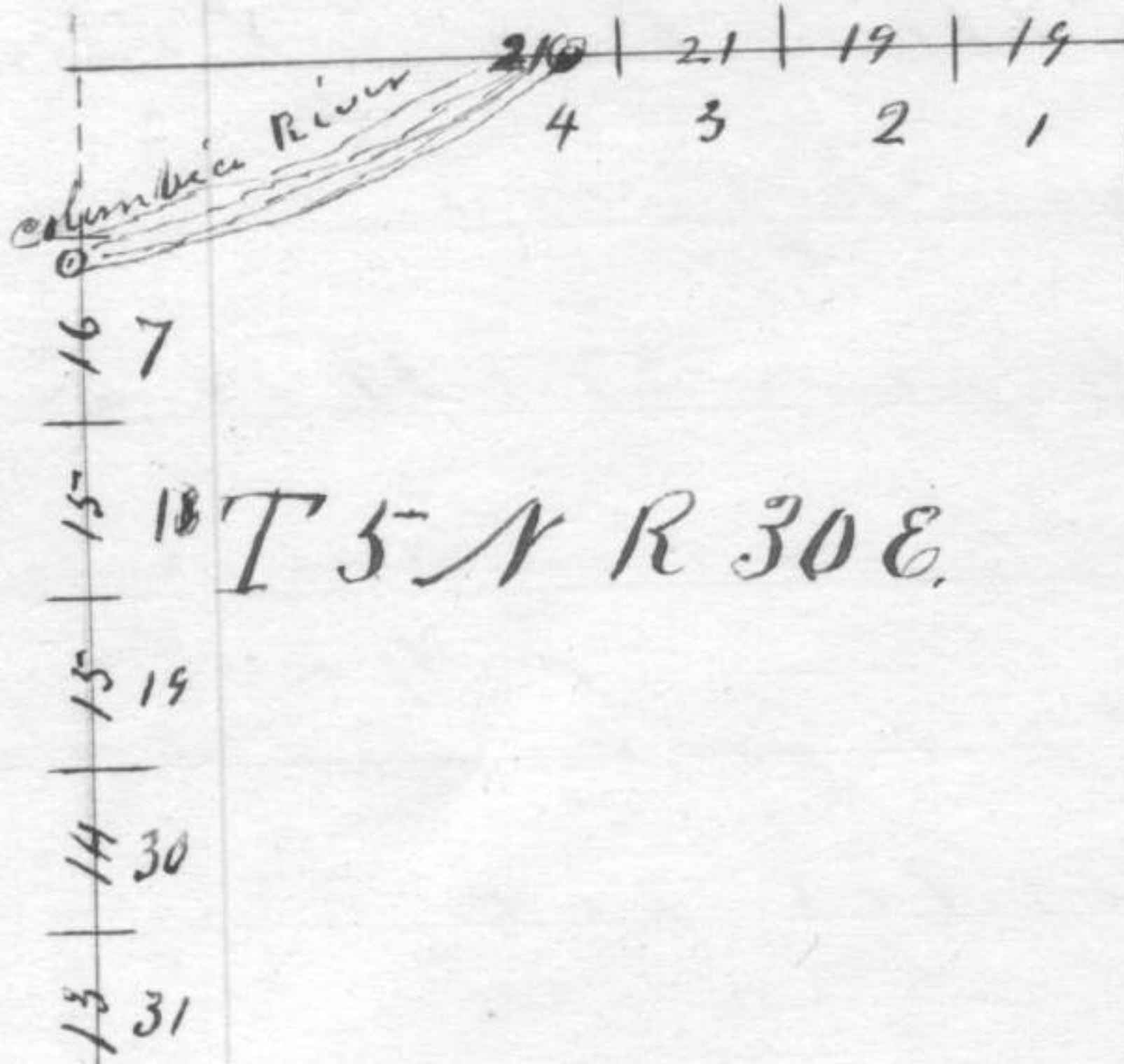

4N 29

T4NR30E

4N 31E

3N R 30E

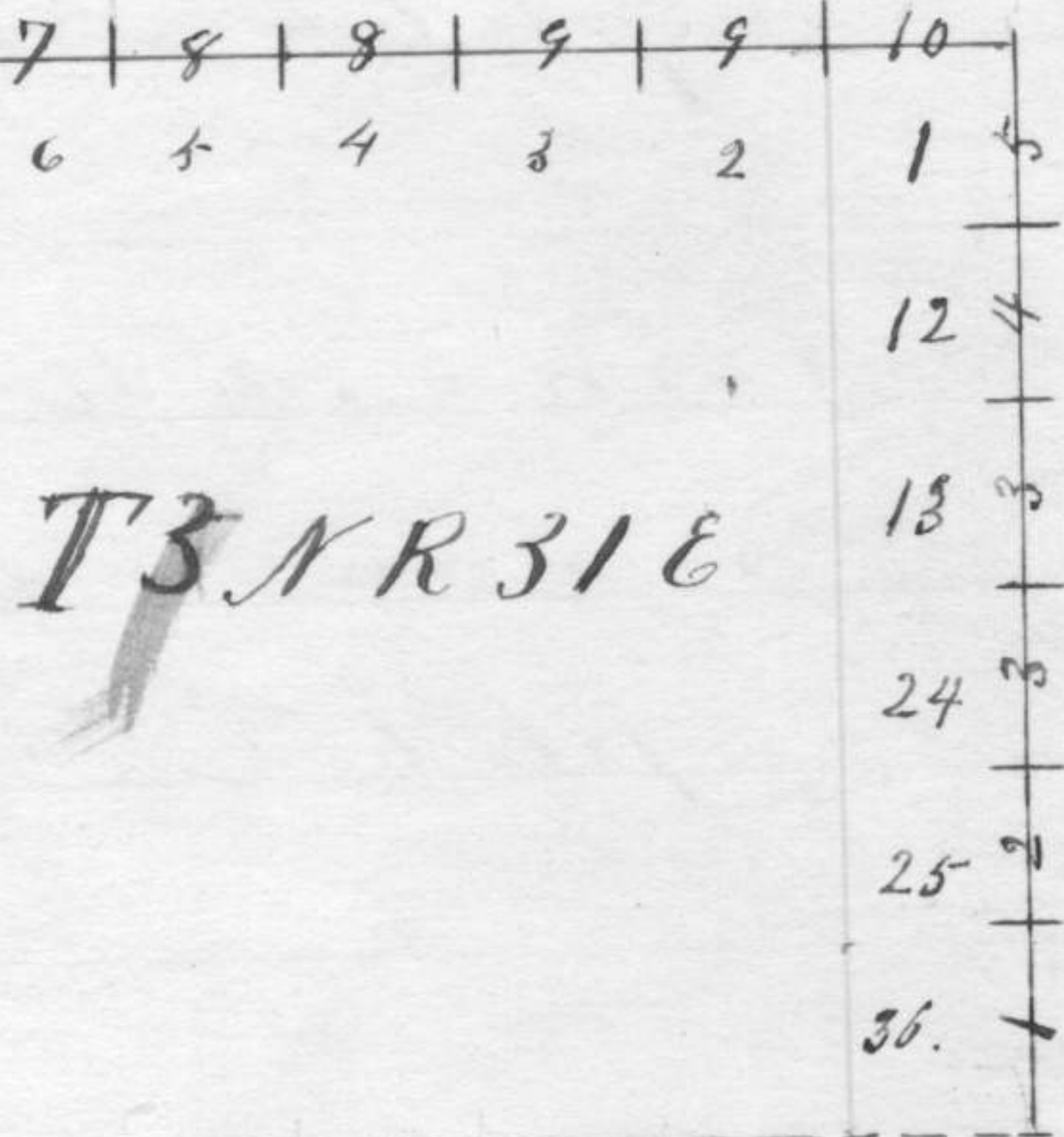

State of Oregon }  
 County of Wasco } So: We, John Brattain

William B. Pengra, having been  
 appointed Chairman in the service  
 of A. S. Payne, deputy surveyor of the  
 lands of the United States in Oregon  
 do solemnly swear that we will  
 faithfully execute the duties of  
 Chain Carriers; - that we will  
 level the chain upon uneven  
 ground and plumb the tally  
 pins whether by sticking or drop-  
 ping the same; that we will  
 report the true distance to all  
 notable objects and the true  
 length of all lines that we  
 assist in measuring to the  
 best of our skill and ability.

Subscribed & sworn }  
 before me this 12<sup>th</sup> }  
 day of August 1861 }  
 W. C. Murray }  
 County Clerk }

John Brattain  
 W. B. Pengra

140

140A

State of Oregon }  
County of Wasco } ss:

The John L.  
Luc Key & Benjamin F. Crow having  
been appointed axemen in the  
service of A. S. Payne, deputy surveyor  
of the lands of the United States in  
Oregon do solemnly swear that  
we will perform the duties of  
axemen or flagmen according  
to instructions given us and to  
the best of our skill and ability.

Subscribed & sworn to }  
before me this 12<sup>th</sup> }  
day of August 1861 }

Jno L. Lenokey  
B. F. Crow,

W. C. Murray  
County Clerk

Chains

Field notes of the exterior  
 boundary lines of Township No.  
 3 North of Range No 31 East  
 of the Willamette Meridian  
 in the State of Oregon, sur-  
 veyed by L. S. Payne, Deputy  
 Surveyor, under his Contract  
 No. 100, dated August 1st  
 1861.

Chains

August 20<sup>th</sup> 1861

Having previously adjusted  
 my compass to the course of  
 the Guide Meridian by  
 actual tracing of the West  
 boundary of Township 3  
 North Range 31 East.

Began at the South East  
 corner of Section 30, T. 3, N. R.  
 31 E. - (Var 19° 30' E. run thence  
 North on East boundary of

Charno Township 3 N R 31 E

North, on line between sections 1  
R 31. & 6 R 32 -

40.00 Set-Charged Stake with  
mound trench and pits  
as per instrs, for 1/4 Sec. Corner.

50.50 Bottom of Dry Ravine (West)

80.00 Set-Charged Stake with  
mound trench and pits  
as per instrs, for Corner to  
Townships 3 & 4 N, Ranges  
31 & 32 East, Var 20° 31' E -

Soil 2° rate

August 22<sup>o</sup>

N. 89° 18' W on random North line  
of Town. 3 N. R 31 E

40.00 Set-Temp. 1/4 Sec. post -

80.00 Set-Temp post for Corner  
to Secs 1 & 2, T 3 N & Secs  
35 & 36 T. 4 N.

North, 89° 18' W on random North

170

170

Soil generally good, Timber  
scarcely - found only along  
the Columbia River. But  
for grazing purposes  
it is unsurpassed &  
should therefore be  
subdivided

## List of Names.

A list of the names of the  
individuals employed in  
re-surveying measuring or  
marking the lines and  
corners described in  
the foregoing field notes  
of the ~~of~~ Lewis & Clark boundary  
lines of Township  
N 3 North Range 31  
East, and of township  
N 5 North R. 30 East

of the Willamette Meridian  
Showing the respective Ca-  
pacities in which they  
were

John Bratten Chairman  
William B. Payne, Chairman  
John L. Lueky, Assessor,

---

We hereby certify that we  
assisted Joseph S. Payne  
deputy Surveyor in Sur-  
veying the exterior bound-  
ary lines of Township  
No 3 North Range 31 East  
and of Township No 5  
North Range 30 East of  
the Willamette Meridian  
and that said lines  
have been in all respects



172

172

to the best of our knowledge  
and belief well and  
faithfully surveyed and  
the boundary monuments  
planted according to the  
instructions furnished  
by the Surveyor General.

John Brattain, Chairman  
W. B. Pengra, Chairman  
John L. Luekey Assessor

Subscribed and sworn by the  
above named persons before me  
a Justice of the Peace in & for  
the County of Lane State of  
Oregon, this 1<sup>st</sup> day of November  
A.D. 1861

R. O. Parsons  
Justice Peace

I Dolphus S. Payne, deputy  
surveyor do solemnly swear  
that, in pursuance of a contract  
with B. J. Pengra Surveyor of the  
public lands of the United States  
in the State of Oregon bearing  
date the First day of August  
1861, and in strict conformity  
to the laws of the United States  
and the instructions furnished  
by the said Surveyor General, I  
have faithfully surveyed the  
exterior boundaries of Townships  
Numbers three and five north  
of the base line of Range Number  
thirty & thirty one East of the  
Millomets Meridian in the State  
aforesaid, and do further solemnly  
swear that the foregoing are the true  
and original field notes of such  
survey.

Dolphus S. Payne

174  
174

The foregoing affidavit was  
subscribed and sworn before me  
this 4<sup>th</sup> day of November A.D. 1861

B. P. Pringle  
Surreal General  
of Oregon

175  
175

Surveyors Office at  
C Eugene City Dec 5<sup>th</sup> 1861

The foregoing field notes of the  
Survey of the exterior boundaries  
of Townships 3 & 5 North of the  
base line of Ranges Nos 30 & 31  
East of the Willamette Meri-  
dian in the State of Oregon  
executed by Dolphus Payne  
under his Contract No 105 da-  
ted August 1<sup>st</sup> 1861 having  
been critically examined the  
necessary corrections & explanations  
made the said field notes  
and the surveys they de-  
scribe are hereby approved

J. P. Sargent  
Surveyor General