

Form 9600-9
(December 1979)
(formerly 9180-6)

UNITED STATES
DEPARTMENT OF THE INTERIOR
BUREAU OF LAND MANAGEMENT

R622

FIELD NOTES

818 217

OF THE

DEPENDENT RESURVEY OF

A PORTION OF THE WEST AND NORTH BOUNDARIES

AND

SUBDIVISIONAL LINES,

AND

SUBDIVISION OF SECTIONS 2, 3, 4, 6, 7, AND 8,

TOWNSHIP 5 NORTH, RANGE 31 EAST,

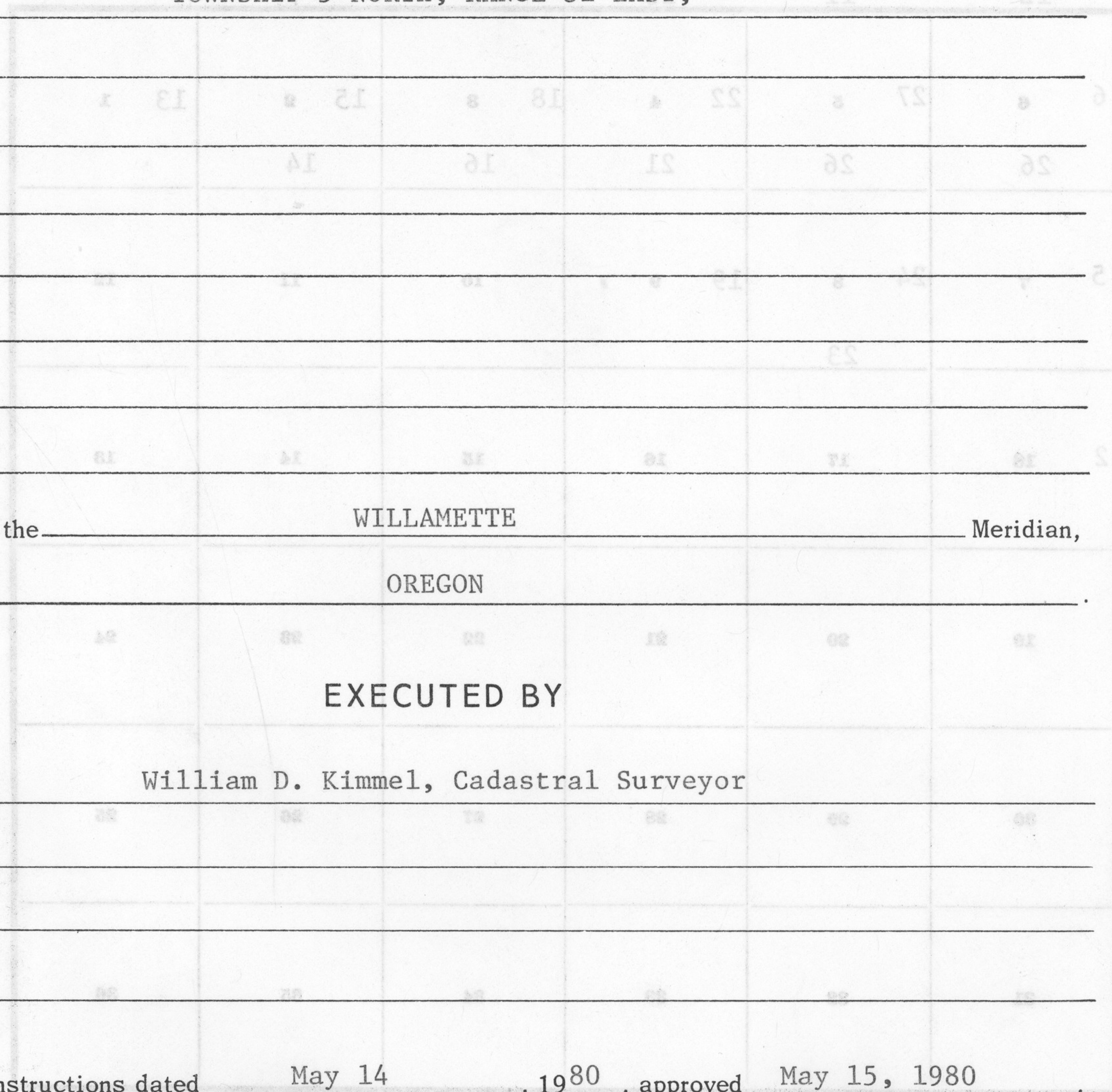

Of the WILLAMETTE Meridian,

In the State of OREGON

EXECUTED BY

William D. Kimmel, Cadastral Surveyor

Under special instructions dated May 14, 1980, approved May 15, 1980

Number 1015, which provided for the surveys included under U.S. Survey/Group
and assignment instructions dated May 20, 1980

Survey commenced June 9, 1980

Survey completed April 23, 1981

R055
218

FIELD NOTES

OF THE
DEPENDENT RESURVEY OF
A PORTION OF THE WEST AND NORTH BOUNDARIES
AND
SUBDIVISIONAL LINES.

INDEX DIAGRAM

Township 5 North, Range 31 East,
12 11 10 9 7

6	6	27	5	22	4	18	3	15	2	13	1
	26		26		21		16		14		
5	7	24	8	19	9		10		11		12
			23								
2	18		17		16		15		14		13
	19		20		21		22		23		24
	30		29		28		27		26		25
	31		32		33		34		35		36

Subdivision of section 2 pgs. 28 - 31
 Subdivision of section 3 pgs. 31 - 33
 Subdivision of section 4 pgs. 33 - 36
 Subdivision of section 6 pgs. 36 - 37
 Subdivision of section 7 pgs. 37 - 40
 Subdivision of section 8 pgs. 40 - 43

Survey commenced June 9, 1980
 Survey completed April 23, 1981

T. 5 N., R. 31 E., Willamette Meridian, Oregon

CHAINS

The following field notes are those of the dependent resurvey of a portion of the west and north boundaries and subdivisional lines and subdivision of sections 2, 3, 4, 6, 7, and 8, Township 5 North, Range 31 East, Willamette Meridian, Oregon.

The history of surveys pertaining to this resurvey, is as follows:

The west boundaries of T. 4 N., R. 31 E., and T. 5 N., R. 31 E., were surveyed by David P. Thompson in 1859.

The south boundary (First Standard Parallel North) of T. 5 N., R. 30 E., was surveyed by H. J. G. Maxon and Jared S. Hurd in 1860.

The subdivisional lines of T. 4 N., R. 30 E., and the north boundary and subdivisional lines of T. 5 N., R. 30 E., were surveyed by Dolphus S. Payne in 1861. During the course of these surveys, Payne retraced the line between sections 19 and 24 on the east boundary of T. 5 N., R. 30 E., and the lines between sections 19 and 24, and sections 7 and 12, on the east boundary of T. 4 N., R. 30 E. Payne established new section corners along the north 3 miles of the east boundary of T. 4 N., R. 30 E., and tied in the old Thompson corners.

The south (First Standard Parallel North), east, and north boundaries of T. 5 N., R. 31 E., were surveyed by William H. Odell and William S. Lewis in 1865.

The south (First Standard Parallel North), east, and north boundaries were retraced and the subdivisional lines of T. 5 N., R. 31 E., were surveyed by Nicholas O. Walden in 1874.

The north boundary of T. 5 N., R. 30 E., was resurveyed by Charles M. Collier in 1911.

The survey was executed in accordance with the specifications as set forth in the Manual of Surveying Instructions, 1973, and the Special Instructions dated May 14, 1980, under Group No. 1015, Oregon.

The directions of the lines were determined by deflections from azimuths obtained by direct solar observations.

Preliminary to the resurvey, the lines of the original survey were retraced and search was made for all corners and other calls of the record. Identified corners were remonumented in their original positions. Lost corners were reestablished and remonumented at proportionate positions based on the official record. The retracement data were thoroughly verified and only the true line field notes are given herein. All lines not forming a closure were measured twice.

Detectable Electronically Energized Particles (DEEP-1 TM) were used to reference certain corner monuments buried under the surface of cultivated land. The Deep-1 is composed of strontium encased in a color coded plastic container. The units are 1 inch in diameter, 2½ inches long, weigh 2½ ounces, and are magnetically detectable to an average buried depth of 8 feet.

The geographic position of the corner of sections 8, 9, 16, and 17, as computed from a direct tie made to the United States Coast and Geodetic Survey triangulation station "JINGLE 1956", is as follows:

T. 5 N., R. 31 E., Willamette Meridian, Oregon

CHAINS

Latitude $45^{\circ} 55' 16.8''$ N. Longitude $118^{\circ} 57' 10.7''$ W.

The mean magnetic declination is 20° E.

Dependent Resurvey of a Portion of the West Boundary,
T. 5 N., R. 31 E., Willamette Meridian, Oregon

(Restoring the survey by David P. Thompson, U.S. Deputy Surveyor, in 1859, the survey by H. J. G. Maxon and Jared S. Hurd, U.S. Deputy Surveyors, in 1860, the survey and retracement by Dolphus S. Payne, U.S. Deputy Surveyor, in 1861, the survey by William H. Odell and William S. Lewis, U.S. Deputy Surveyors, in 1865, the retracement by Nicholas O. Walden, U.S. Deputy Surveyor, in 1874, and the resurvey by Charles M. Collier, U.S. Surveyor, in 1911)

Beginning at the point for the cor. of secs. 13, 18, 19, and 24, determined by the irregular boundary method; there is no remaining evidence of the original corner.

Set an iron post, 28 ins. long, $2\frac{1}{2}$ ins. diam., 43 ins. in the ground, the top 15 ins. below the surface of cultivated field, with brass cap mkd.

T 5 N	
R 30 E	R 31 E
S 13	S 18
S 24	S 19

1980

from which

An iron post, 28 ins. long, $2\frac{1}{2}$ ins. diam., set 22 ins. in the ground, for a reference monument, bears N. 35° W., 689 lks. dist., with brass cap mkd. T5N R30E S13 RM 455 FT 1980 with an arrow pointing to the corner.

An iron post, 28 ins. long, $2\frac{1}{2}$ ins. diam., set 22 ins. in the ground, for a reference monument, bears N. 68° W., 682 lks. dist., with brass cap mkd. T5N R30E S13 RM 450 FT 1980 with an arrow pointing to the corner.

The corner of fences, extending N. 40° E. and W., bears N. 68° W., 974 lks. dist.

A yellow "Deep 1" magnetic marker, buried 2 ft. in the ground, bears N. 45° E., 25 lks. dist.

A red "Deep 1" magnetic marker, buried 2 ft. in the ground, bears S. 45° E., 25 lks. dist.

A blue "Deep 1" magnetic marker, buried 2 ft. in the ground, bears S. 45° W., 25 lks. dist.

An orange "Deep 1" magnetic marker, buried 2 ft. in the ground, bears N. 45° W., 25 lks. dist.

From this point, the point for the standard cor. of Tps. 4 and 5 N., Rs. 30 and 31 E., bears S. $0^{\circ} 08' E.$, 240.77 chs. dist., at proportionate distance; there is no remaining evidence of the original corner.

Dependent Resurvey, Portion of the W. Bdy.,
T. 5 N., R. 31 E., Willamette Mer., Oregon

CHAINS

Set an aluminum post, 28 ins. long, 2½ ins. diam., 46 ins. in the ground, the top 18 ins. below the surface of a cultivated field, with aluminum cap mkd.

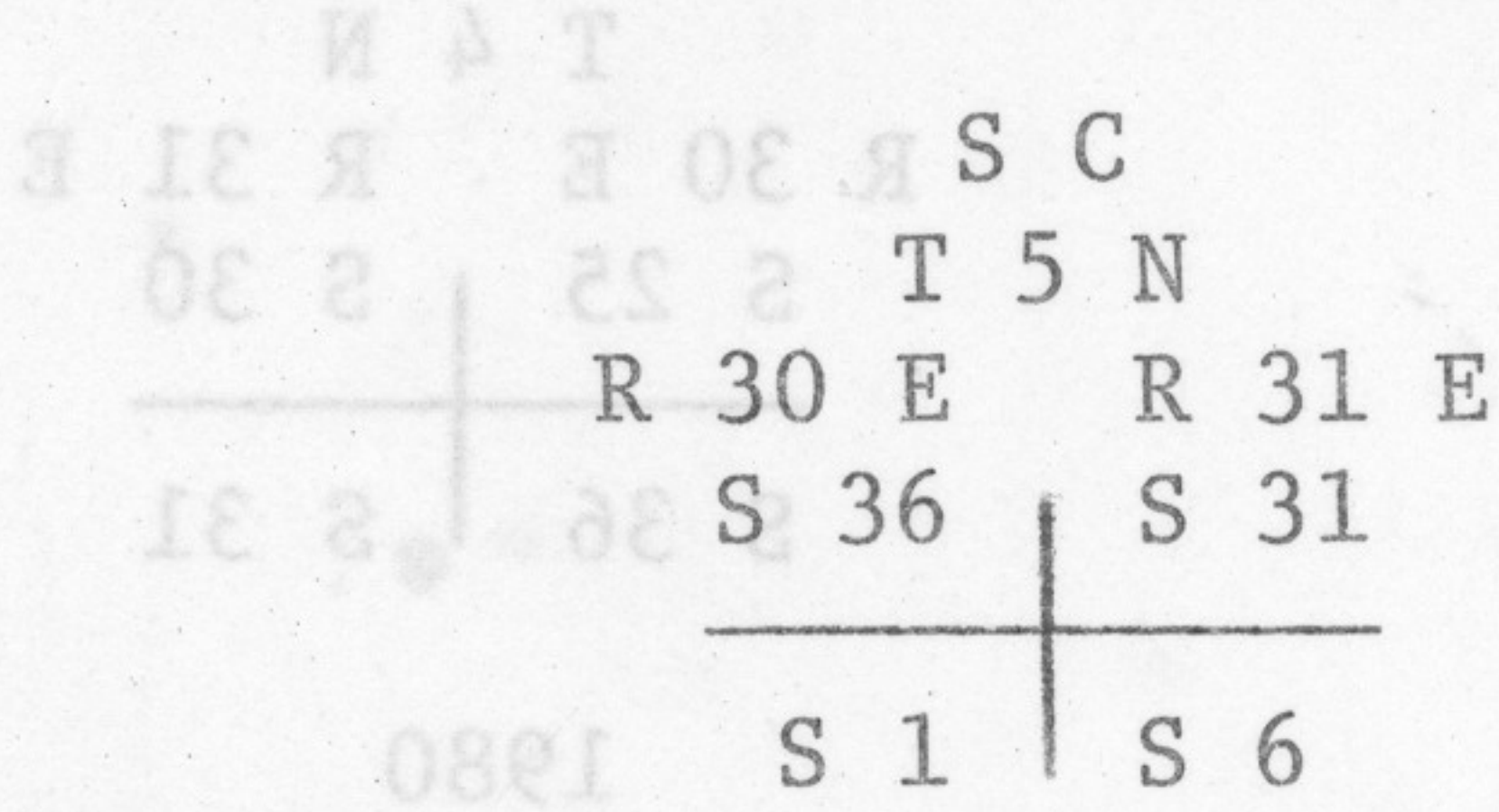

From this same point the standard cor. of secs. 31 and 32, on the S. bdy. of the Tp. bears S. 88° 39' E., 80.39 chs. dist., perpetuated and recorded by the County Surveyors Office in 1974, from original evidence no longer in existence, monumented with an iron post, 2 ins. diam., firmly set, projecting 6 ins. above ground, with brass cap mkd.

A yellow "Deep 1" magnetic marker, buried 2 ft. in the ground, bears N. 45° E., 25 lks. dist.

A red "Deep 1" magnetic marker, buried 2 ft. in the ground, bears S. 45° E., 25 lks. dist.

A blue "Deep 1" magnetic marker, buried 2 ft. in the ground, bears S. 45° W., 25 lks. dist.

An orange "Deep 1" magnetic marker, buried 2 ft. in the ground, bears N. 45° W., 25 lks. dist.

The corner of fences, extending S. and E., bears S. 86° 55' E., 21.14 chs. dist.

Corner is located on E. slope, 55 lks. W. of draw, drains N. 25° W.

From this point, the standard cor. of secs. 31 and 32, on the S. bdy. of the Tp. bears S. 88° 39' E., 80.39 chs. dist., perpetuated and recorded by the County Surveyors Office in 1974, from original evidence no longer in existence, monumented with an iron post, 2 ins. diam., firmly set, projecting 6 ins. above ground, with brass cap mkd.

1974 RLS 625
UMATILLA COUNTY SURVEYOR

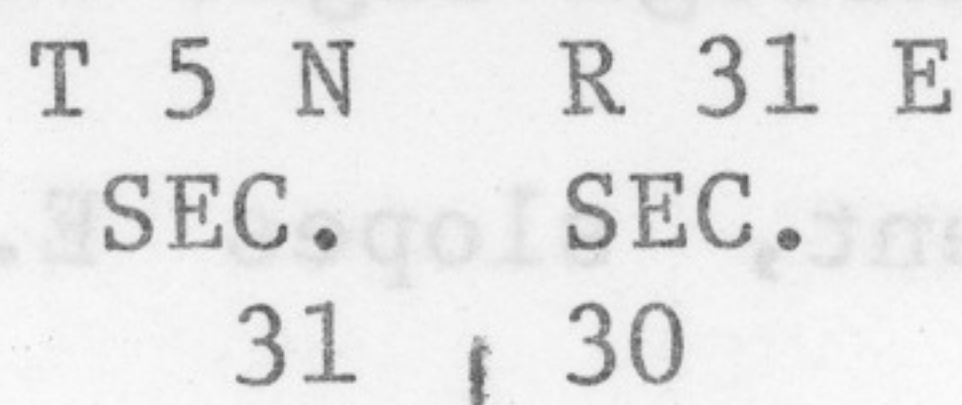

T 4 N R 31 E

Set a 6 ft. steel fence post alongside the iron post.

From this same point, the cor. of secs. 25, 30, 31, and 36, on the W. bdy. of T. 4 N., R. 31 E., bears S. 0° 10' W., 395.42 chs. dist., determined at intersection of barbed wire fences, extending S. and W. and remains of fence extending N. This position is harmoniously related with identified existing corners in the area, has long been recognized by owners of the adjacent lands as the corner, and is accepted as the best available evidence of the position of the original corner.

At the corner point

Subdivision of Section 8,
T. 5 N., R. 31 E., Willamette Mer., Oregon

CHAINS

- 20.10 Draw, drains S. 65° W.; asc. 40 ft. over rolling land.
- 39.87 The center S 1/16 sec. cor. of sec. 8.
-
- From the center W 1/16 sec. cor. of sec. 8.
- N. 0° 03' W., on the N. and S. center line of the NW $\frac{1}{4}$ of sec. 8.
- Descend 95 ft. over general N. slope, through scattering sagebrush.
- 0.60 Downed woven wire fence, bears E. and W.
- 19.97 Point for the NW 1/16 sec. cor. of sec. 8 at intersection with the E. and W. center line of the NW $\frac{1}{4}$.
- Set an aluminum post, 28 ins. long, 2 $\frac{1}{2}$ ins. diam., 20 ins. in the ground, with aluminum cap mkd.
- NW 1/16 S 8
- 1980
- Set a 5 $\frac{1}{2}$ ft. steel fence post alongside the aluminum post.
- Descend 10 ft. over N. slope.
- 22.30 Draw, drains NE.; asc. 60 ft. over SE. slope.
- 29.25 Top of ascent, slopes E.; desc. 80 ft. over N. slope.
- 38.30 Downed barbed wire fence, bears N. 80° E. and S. 80° W.
- 39.94 The W 1/16 sec. cor. of secs. 5 and 8.
-
- From the center N 1/16 sec. cor. of sec. 8.
- N. 88° 25' W., on the E. and W. center line of the NW $\frac{1}{4}$ of sec. 8.
- Ascend 10 ft. over NE. slope, through scattering sagebrush.
- 1.00 Barbed wire fence, bears N. and S.
- 3.40 Top of ascent, slopes N.; desc. 40 ft. over NW. slope.
- 10.95 Draw, drains N. 55° E.; asc. 10 ft. over NE. slope.
- 13.45 Top of ascent, slopes N.; desc. 35 ft. over NW. slope.
- 19.925 The NW 1/16 sec. cor. of sec. 8.
- Corner is located at bottom of descent, slopes N.; asc. 85 ft. over rolling land.
- 39.85 The N 1/16 sec. cor. of secs. 7 and 8.

GENERAL DESCRIPTION

The portion of Township 5 North, Range 31 East, which was resurveyed, is located approximately 4 $\frac{1}{2}$ miles north of the town of Holdman, Oregon. The area is

182
262

Subdivision of Section 8,
T. 5 N., R. 31 E., Willamette Meridian, Oregon

CHAINS

rolling terrain with elevations ranging from about 540 feet above sea level in Juniper Canyon on the north boundary of section 6 to about 1,580 feet above sea level on the line between sections 2 and 11.

The area is drained to the north by draws draining into Juniper Canyon and to the south by draws draining into Cold Springs Canyon. Water is scarce at most times of the year.

Access is gained by county and private roads which enter the area from Cold Spring Canyon and from Juniper Canyon.

The soil is sandy and subject to wind erosion. Portions of sections 2, 3, and 8 support dry land wheat farming. Sections 4, 5, 6, and 7 have areas of drifting sand, sagebrush, bunch grass, and cheat grass. Scattered Junipers are found on the slopes of Juniper Canyon. The area has a high range fire risk during dry periods.

There were no mineral deposits noted within the area.

The average of several readings throughout the area gives a value of 20° E. for the mean magnetic declination.

There is a range of 0° 30' due to local attraction.

22.30	Draw, drains NW; asc. 60 ft. over SE slope.
28.25	Top of ascent, slopes E; desc. 80 ft. over N. slope.
38.30	Downed barbed wire fence, bears N. 80° E. and S. 80° W.
39.94	The W 1/16 sec. cor. of secs. 2 and 8.

	From the center N 1/16 sec. cor. of sec. 8.
	N. 88° 25' W., on the E. and W. center line of the NW 1/4 of sec. 8.
	Ascend 10 ft. over NE slope, through sagebrush.
1.00	Barbed wire fence, bears N. and S.
3.40	Top of ascent, slopes N; desc. 40 ft. over NW slope.
10.95	Draw, drains N. 25° E.; asc. 10 ft. over NE slope.
13.45	Top of ascent, slopes N; desc. 35 ft. over NW slope.
19.925	The NW 1/16 sec. cor. of sec. 8.
	Corner is located at bottom of descent, slopes N; asc. 85 ft. over rolling land.
39.85	The N 1/16 sec. cor. of secs. 7 and 8.

GENERAL DESCRIPTION

The portion of Township 5 North, Range 31 East which was surveyed, is located approximately 4 1/2 miles north of the town of Holdman, Oregon. The area is

Form 9600-11
(August 1979)

UNITED STATES
DEPARTMENT OF THE INTERIOR
BUREAU OF LAND MANAGEMENT

FIELD ASSISTANTS

NAMES	CAPACITY
Richard S. Tandlich	Surveying Technician
Timothy J. Ingraham	Land Surveyor (Student Trainee)
Richard W. Gardner	Surveying Aid

CERTIFICATE OF APPROVAL

The foregoing field notes of the dependent survey of a portion of the west and north boundaries and subdivision lines, and the subdivision of sections 2, 3, 4, 6, 7, and 8, Township 5 North, Range 31 East, Willamette Meridian, Oregon, executed by William D. Kimmel, Cadastral Surveyor, having been critically examined and found correct, are hereby approved.

William W. Blum
 Chief Cadastral Surveyor and Approval Staff
 October 14, 1983
 (Date)

CERTIFICATE OF TRANSCRIPT

I certify that the foregoing transcript of the field notes of the above described survey is a true copy of the original field notes.

William W. Blum
 Chief Cadastral Surveyor of Oregon
 (Date)

CERTIFICATE OF SURVEY

(I) ~~XXX~~, William D. Kimmel, Cadastral Surveyor, HEREBY

CERTIFY upon honor that, in pursuance of special instructions bearing date of the 14th day of May, 19 80, (I) ~~XXX~~ have dependently resurveyed a portion of the west and north boundaries and subdivisional lines, and subdivided sections 2, 3, 4, 6, 7, and 8, Township 5 North, Range 31 East,

of the Willamette Meridian, in the State of Oregon, which are represented in the foregoing field notes as having been executed by (me), ~~XXX~~ and under (my) ~~XXX~~ direction; and that said survey has been made in strict conformity with said special instructions, the Manual of Instructions for the Survey of the Public Lands of the United States, and in specific manner described in the foregoing field notes.

January 7, 1982

(Date)

William D. Kimmel

(Cadastral Surveyor)

(Date)

(Cadastral Surveyor)

CERTIFICATE OF APPROVAL

BUREAU OF LAND MANAGEMENT
Denver, Colorado
Portland, Oregon

The foregoing field notes of the dependent resurvey of a portion of the west and north boundaries and subdivisional lines, and the subdivision of sections 2, 3, 4, 6, 7, and 8, Township 5 North, Range 31 East, Willamette Meridian, Oregon,

executed by William D. Kimmel, Cadastral Surveyor,

having been critically examined and found correct, are hereby approved.

October 14, 1983

(Date)

William W. Glenn

(Chief, Cadastral Survey Examination and Approval Staff)
Chief Cadastral Surveyor of Oregon

CERTIFICATE OF TRANSCRIPT

I CERTIFY That the foregoing transcript of the field notes of the above described surveys in _____, is a true copy of the original field notes.

(Date)

(Chief, Cadastral Survey Examination and Approval Staff)
Chief Cadastral Surveyor of Oregon