

100

Rec'd in Office

137

Nov 4th 1861

137A

Field notes of the western boundary lines of Township No 3 N R 31

and of Township No 5 N R 30 East of the Willamette Meridian surveyed by Dolphus S. Payne, ^{deputy surveyor} under his Contract No 100 dated August 1st 1861

Town 3 N R 31

Commenced August 20th 1861

Completed August 23rd 1861

Town 5 N R 30

Commenced September 17th 1861

Completed September 17, 1861

80
5-90
74-10

138

138A

Index

Exterior boundaries, T3NR30E and T5NR30E

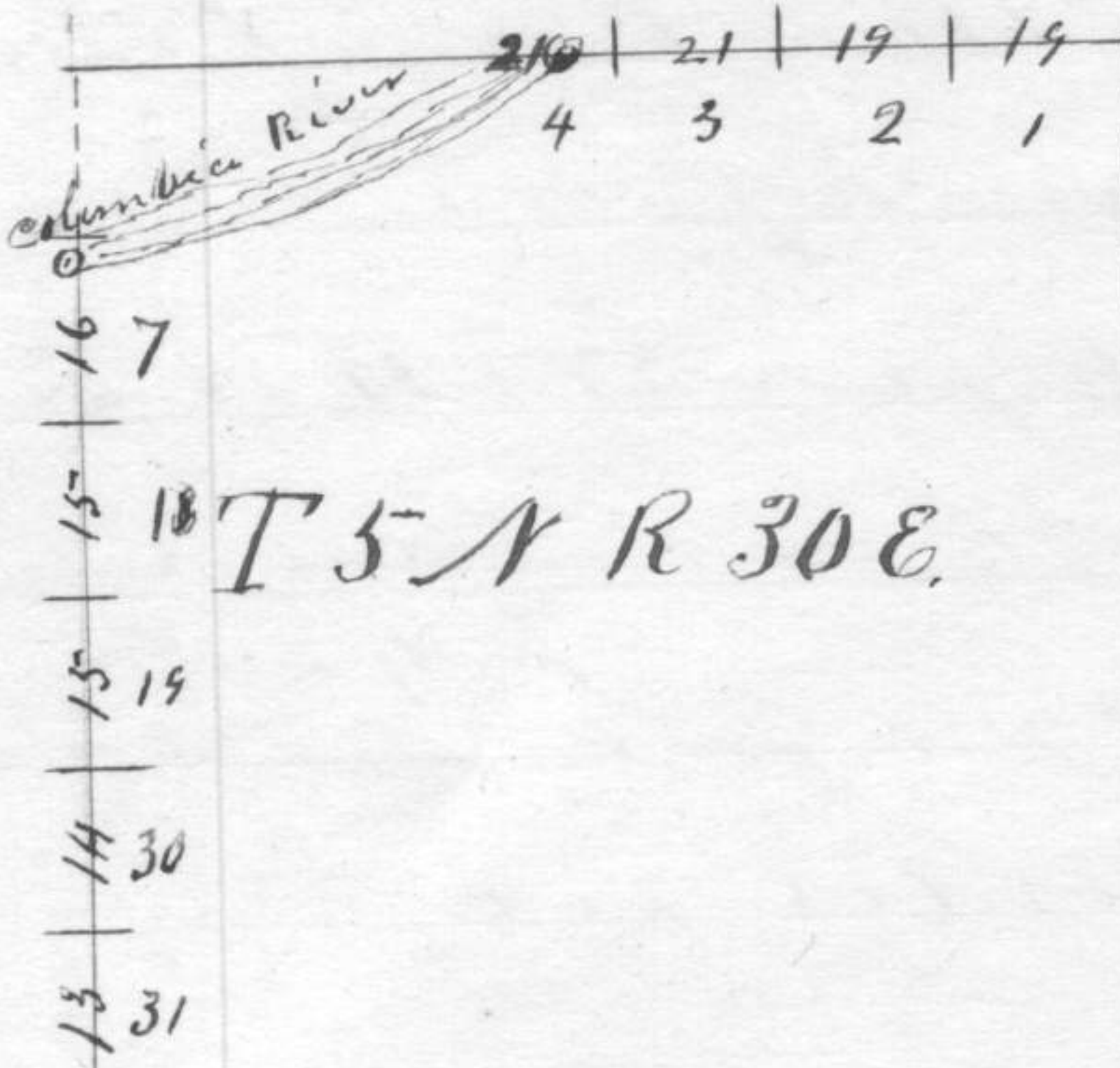

Columbia River

20 | 21 | 19 | 19
4 | 3 | 2 | 1

16 7

15 18 T5NR30E

15 19

14 30

13 31

4N 29

T4NR30E

4N 31E

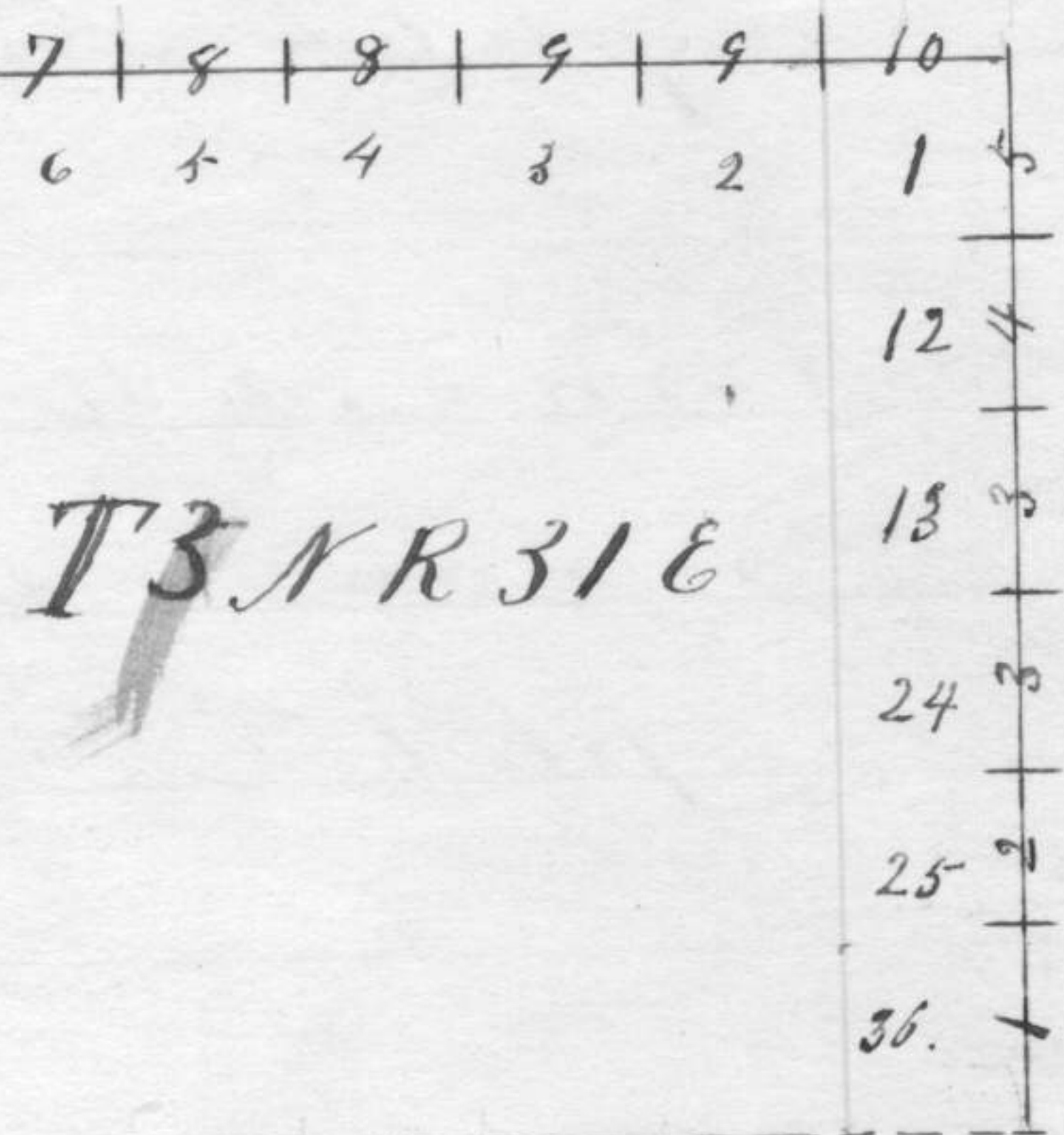

3NR30E

T3NR31E

7 | 8 | 8 | 9 | 9 | 10
6 | 5 | 4 | 3 | 2 | 1 6
12 4
13 3
24 3
25 2
36 1

State of Oregon }
 County of Wasco } ss: We, John Brattain

William B. Pengra, having been
 appointed Chairman in the service
 of A. S. Payne, deputy surveyor of the
 lands of the United States in Oregon
 do solemnly swear that we will
 faithfully execute the duties of
 Chain Carriers; - that we will
 level the chain upon uneven
 ground and plumb the tally
 pins whether by sticking or drop-
 ping the same; that we will
 report the true distance to all
 notable objects and the true
 length of all lines that we
 assist in measuring to the
 best of our skill and ability.

Subscribed & sworn }
 before me this 12th }
 day of August 1861 }
 W. C. Murray }
 County Clerk }

John Brattain
 W. B. Pengra

140

140A

State of Oregon }
County of Wasco } ss:

The John L.
Luc Key, & Benjamin F. Crow having
been appointed axemen in the
service of A. S. Payne, deputy surveyor
of the lands of the United States in
Oregon do solemnly swear that
we will perform the duties of
axemen or flagmen according
to instructions given us and to
the best of our skill and ability.

Subscribed & sworn to }
before me this 12th }
day of August 1861 }

Jno L. Lenokey
B. F. Crow,

W. C. Murray
County Clerk

Chains

Field notes of the exterior
 boundary lines of Township No.
 3 North of Range No 31 East
 of the Willamette Meridian
 in the State of Oregon, sur-
 veyed by L. S. Payne, Deputy
 Surveyor, under his Contract
 No. 100, dated August 1st
 1861.

August, 20th 1861

Having previously adjusted
 my compass to the course of
 the Guide Meridian by
 actual tracing of the West
 boundary of Township 3
 North Range 31 East.

Began at the South East
 corner of Section 30, T. 3, N. R.
 31 E. - (var 19° 30' E. run thence
 North on East boundary of

Charno Township 3 N R 31 E

North, on line between sections 1
R 31. & 6 R 32 -

40.00 Set-Charged Stake with
mound trench and pits
as per instrs, for 1/4 Sec. Corner.

50.50 Bottom of Dry Ravine (West)

80.00 Set-Charged Stake with
mound trench and pits
as per instrs, for corner to
Townships 3 & 4 N, Ranges
31 & 32 East, Nor 20° 31' E -

Soil 2^o rate

August 22^o

N. 89° 18' W on random North line
of Town. 3 N. R 31 E

40.00 Set-Temp. 1/4 Sec. post -

80.00 Set-Temp post for corner
to Secs 1 & 2, T 3 N & Secs
35 & 36 T. 4 N.

North, 89° 18' W on random North

146

65

146A

North Boundary

Chairs

line Sec 2,

40.00

Set Temp 1/4 sec post.

80.00

Set Temp post for corner
to Secs 2 & 3. 34 & 35

N89°18'W on random North line

Sec 3.

40.00

Temp. 1/4 sec post

80.00

Temp. corner to Secs 3 &
4. 33 & 34

N89°18'W on random North line of

Sec 4.

40.00

Temp. 1/4 sec post

80.00

Temp corner to Secs 4 &
5. 32 & 33.

N89°18'W on random N. line Sec 5

40.00

Temp 1/4 sec post

Township 3 N R 31 E 47A

Chains

80.00 Temp Corner ^{post} to Sec 6
31 & 32

N 89° 18' 17" on random North line
Sec 6

40.00 Temp 1/4 sec post

83.10 Intersect Town line 1.18
chains South of the N. W.
Corner of Township No 3 N and
S. W. Corner of Township No 4 N
R 31 E

August 23rd

Returning on true line North
Boundary of Town, No 3 N, R
31 E - Var. 21° 27' E -

S 89° 09' E on true North line of section
6 T 3 N, R 31 E.

43.10 Set-charged stake with
mound trench and pits
as per instrs, for 1/4 sec corner

148

148A

North Boundary

Chains

83.10 Set-charged stake with mound trench and pits as per instrs. for corner to Secs 5 & 6 - 31 & 32 - Var. $19^{\circ}40'E$ - Soil 3rd rate

$S. 89^{\circ}09'E$ on true North line
Sec 5 -

40.00 Set-charged stake with mound trench and pits as per instrs. for $1/4$ sec post;

80.00 Set-charged stake with mound trench and pits as per instrs. for corner to Secs 4 & 5 - 32 & 33 -
Var $19^{\circ}50'E$ -
Soil 2nd rate

$S. 89^{\circ}09'E$ on true N line Sec 4

40.00 Set-charged stake with mound trench and pits as per instrs. for $1/4$ sec. corner

Township 3 N R 31 E T. 11.

chains

80,00 Set-charged stake with mound
trench and pits as per notes
for corner to sections

3, 4, 33, 34

over $19^{\circ}50' E$

Land mostly level, soil 2nd rate

$889^{\circ}09' E$ on true North line Sec 3.

44,00 Set-charged stake with
mound trench and pits
as per notes for $\frac{1}{4}$ sec
corner.

80,00 Set-charged stake with
mound trench & pits as per
notes for corner to
secs 2, 3, - 34, 33

over $19^{\circ}40' E$

soil 2nd rate

$889^{\circ}09' E$ on true North line Sec 2.

40,00 Set-charged stake with mound
trench and pits as per notes

150

150 A

North Boundary

ChernisFor $\frac{1}{4}$ Sec corner.

80,00

Set-chained stake with
mound trench and pits
as per instrs for corner
to Secs 1, 2, 33, 36Var $20^{\circ} 21' E$ Soil 1st rate $89^{\circ} 09' E$ on true North line Sec 1,40,00 Set chained stake with
mound trench and pits
as per instructions for
 $\frac{1}{4}$ Sec corner.80,00 Corner to Township 344 -
North Range 318 32 East.
Soil 2nd rate

General Description.

An abundance of ex-
cellent grass is found

170

170

Soil generally good, Timber
scarcely - found only along
the Columbia River. But
for grazing purposes
it is unsurpassed &
should therefore be
subdivided

List of Names.

A list of the names of the
individuals employed in
re-surveying measuring or
marking the lines and
corners described in
the foregoing field notes
of the ~~of~~ Lewis & Clark
by lines of Township
N 3 North Range 31
East, and of township
N 5 North R. 30 East

of the Willamette Meridian
Showing the respective Ca-
pacities in which they
were

John Bratten Chairman
William B. Payne, Chairman
John L. Lueky, Assessor,

We hereby certify that we
assisted Joseph S. Payne
deputy Surveyor in Sur-
veying the exterior bound-
ary lines of Township
No 3 North Range 31 East
and of Township No 5
North Range 30 East of
the Willamette Meridian
and that said lines
have been in all respects

172

172

to the best of our knowledge
and belief well and
faithfully surveyed and
the boundary monuments
planted according to the
instructions furnished
by the Surveyor General.

John Brattain, Chairman
W. B. Penner, Chairman
John L. Luekey Assessor

Subscribed and sworn by the
above named persons before me
a Justice of the Peace in & for
the County of Lane State of
Oregon, this 1st day of November
A.D. 1861

R. O. Parsons
Justice Peace

I Dolphus S. Payne, deputy
surveyor do solemnly swear
that, in pursuance of a contract
with B. J. Pungra Surveyor of the
public lands of the United States
in the State of Oregon bearing
date the First day of August
1861, and in strict conformity
to the laws of the United States
and the instructions furnished
by the said Surveyor General, I
have faithfully surveyed the
exterior boundaries of Townships
Numbers three and five north
of the base line of Range Number
thirty & thirty one East of the
Millomata Meridian in the State
aforesaid, and do further solemnly
swear that the foregoing are the true
and original field notes of such
survey.

Dolphus S. Payne

174
174

The foregoing affidavit was
subscribed and sworn before me
this 4th day of November A.D. 1861

B. P. Pringle
Surreal General
of Oregon

175
175

Surveyors Office at
C Eugene City Dec 5th 1861

The foregoing field notes of the
Survey of the exterior boundaries
of Townships 3 & 5 North of the
base line of Ranges Nos 30 & 31
East of the Willamette Meri-
dian in the State of Oregon
executed by Dolphus Payne
under his Contract No 100 da-
ted August 1st 1861 having
been critically examined the
necessary corrections & explanations
made the said field notes
and the Surveys they de-
scribe are hereby approved

J. P. Sargent
Surveyor General