

100

Rec'd in Office

137

Nov 4th 1861

137A

Field notes of the western boundary line of Township No 3 N R 31

and of Township No 5 N R 30 East of the Willamette Meridian surveyed by Dolphus S. Payne, ^{deputy surveyor} under his contract No 100 dated August 1st 1861

Town 3 N R 31

Commenced August 20th 1861

Completed August 23rd 1861

Town 5 N R 30

Commenced September 17th 1861

Completed September 17, 1861

80

5-90

74-10

138

138A

Index

Exterior boundaries, T3NR30E and T5NR30E

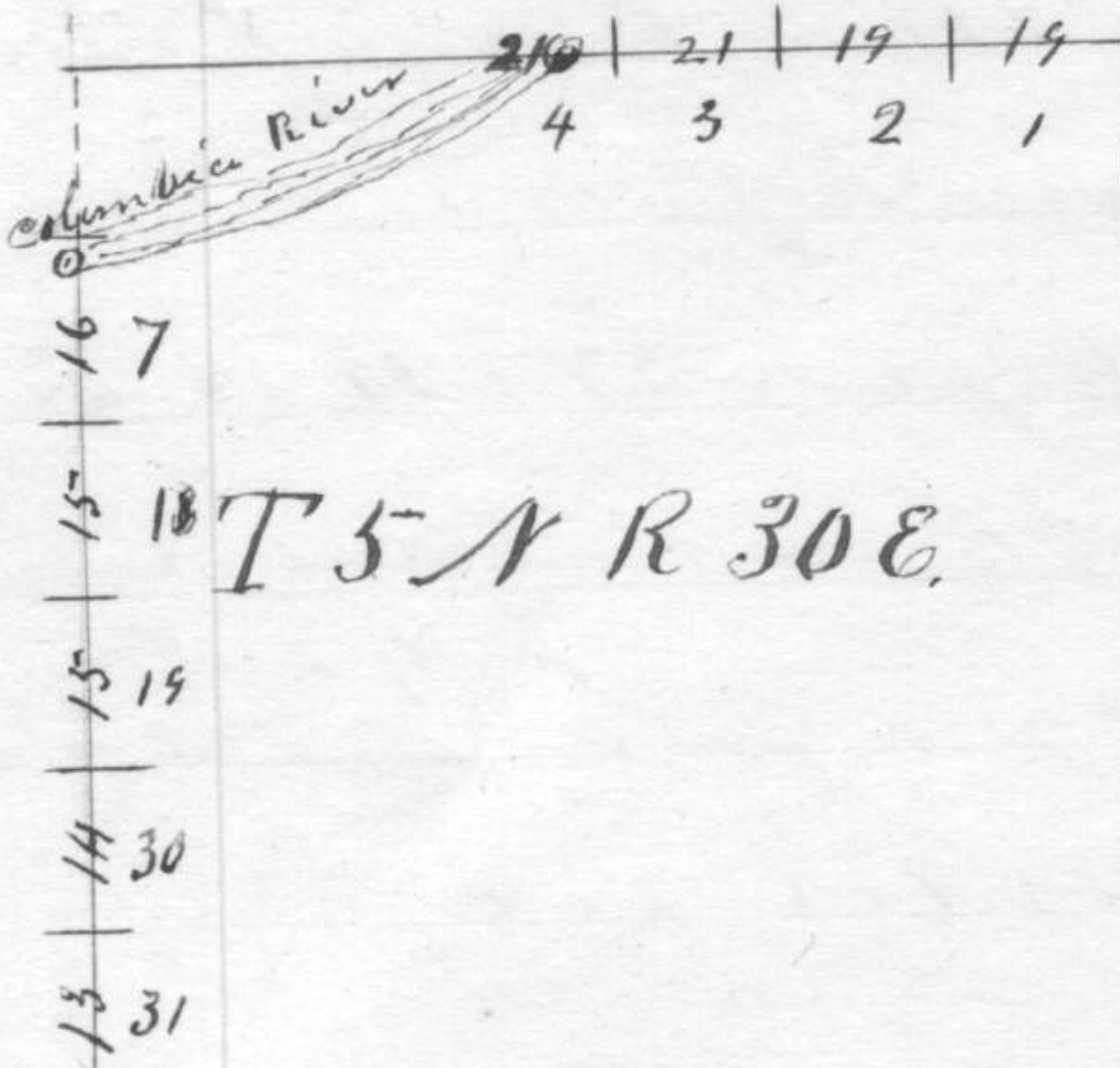

T4NR30E.

4N31E

3NR30E

T3NR31E

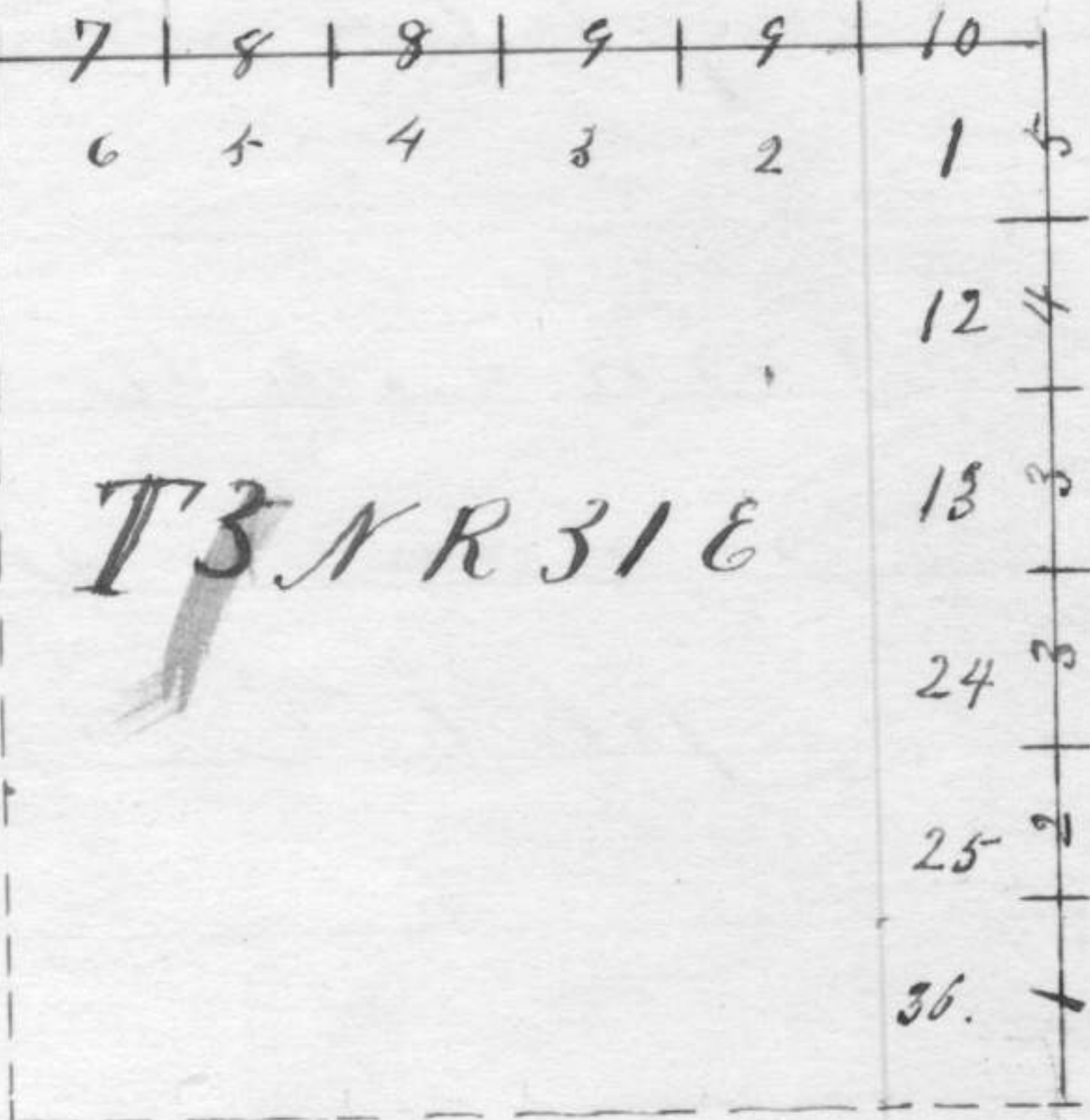

4N29

State of Oregon }
 County of Wasco } ss: We, John Brattain

William B. Pengra, having been
 appointed Chairman in the service
 of A. S. Payne, deputy surveyor of the
 lands of the United States in Oregon
 do solemnly swear that we will
 faithfully execute the duties of
 Chain Carriers; - that we will
 level the chain upon uneven
 ground and plumb the tally
 pins whether by sticking or drop-
 ping the same; that we will
 report the true distance to all
 notable objects and the true
 length of all lines that we
 assist in measuring to the
 best of our skill and ability.

Subscribed & sworn }
 before me this 12th }
 day of August 1861 }
 W. C. Murray }
 County Clerk }

John Brattain
 Wm B Pengra

140

140A

State of Oregon }
County of Wasco } ss:

The John L.
Luc Key, & Benjamin F. Crow having
been appointed axemen in the
service of A. S. Payne, deputy surveyor
of the lands of the United States in
Oregon do solemnly swear that
we will perform the duties of
axemen or flagmen according
to instructions given us and to
the best of our skill and ability.

Subscribed & sworn to }
before me this 12th }
day of August 1861 }

Jno L. Lenokey
B. F. Crow,

W. C. Murray
County Clerk

Chains

Field notes of the exterior
 boundary lines of Township No.
 3 North of Range No 31 East
 of the Willamette Meridian
 in the State of Oregon, sur-
 veyed by A. S. Payne, Deputy
 Surveyor, under his Contract
 No. 100, dated August 1st
 1861.

August, 20th 1861

Having previously adjusted
 my compass to the course of
 the Guide Meridian by
 actual tracing of the West
 boundary of Township 3
 North Range 31 East.

Began at the South East
 corner of Section 30, T. 3, N. R.
 31 E. - (Var 19° 30' E. run thence
 North on East boundary of

Charno Township 3 N R 31 E

North, on line between sections 1
R 31. & 6 R 32 -

40.00 Set-Charged Stake with
mound trench and pits
as per instrs, for $\frac{1}{4}$ sec. corner.

50.50 Bottom of dry Ravine (West)

80.00 Set-Charged Stake with
mound trench and pits
as per instrs, for corner to
Townships 3 & 4 N, Ranges
31 & 32 East, Var $20^{\circ} 31' E$ -

Soil 2^o rate

August 22^o

N. $89^{\circ} 18' N$ on random North line
of Town. 3 N. R 31 E

40.00 Set-Temp. $\frac{1}{4}$ sec. post -

80.00 Set-Temp post for corner
to Secs 1 & 2, T 3 N & Secs
35 & 36 T. 4 N.

North, $89^{\circ} 18' N$ on random North

170

170

Soil generally good, Timber
 scarce - found only along
 the Columbia River. But
 for grazing purposes
 it is unsurpassed &
 should therefore be
 subdivided

List of Names.

A list of the names of the
 individuals employed in
 running measuring or
 marking the lines and
 corners described in
 the foregoing field notes
 of the ~~of~~ Lewis' Bounda-
 ry lines of Township
 N 3 North Range 31
 East, and of township
 N 5 North R. 30 East

171

171

of the Willamette Meridian
Showing the respective Ca-
pacities in which they
were

John Bratten Chairman
William B. Payne, Chairman
John L. Lueck, Assessor,

We hereby certify that we
assisted Joseph S. Payne
deputy Surveyor in Sur-
veying the exterior bound-
ary lines of Township
No 3 North Range 31 East
and of Township No 5
North Range 30 East of
the Willamette Meridian
and that said lines
have been in all respects

172

172

to the best of our knowledge
and belief well and
faithfully surveyed and
the boundary monuments
planted according to the
instructions furnished
by the Surveyor General.

John Brattain, Chairman
W. B. Penner, Chairman
John L. Luekey Assessor

Subscribed and sworn by the
above named persons before me
a Justice of the Peace in & for
the County of Lane State of
Oregon, this 1st day of November
A.D. 1861

R. O. Parsons
Justice Peace

I Dolphus S. Payne, deputy
surveyor do solemnly swear
that, in pursuance of a contract
with B. J. Pungra Surveyor of the
public lands of the United States
in the State of Oregon bearing
date the First day of August
1861, and in strict conformity
to the laws of the United States
and the instructions furnished
by the said Surveyor General, I
have faithfully surveyed the
exterior boundaries of Townships
Numbers three and five north
of the base line of Range Numbers
thirty & thirty one East of the
Millomets Meridian in the State
aforesaid, and do further solemnly
swear that the foregoing are the true
and original field notes of such
survey.

Dolphus S. Payne

174
174

The foregoing affidavit was
subscribed and sworn before me
this 4th day of November A.D. 1861

B. P. Pringle
Surreal General
of Oregon

175
175

Surveyors Office at
Salem City Dec 5th 1861

The foregoing field notes of the
Survey of the exterior boundaries
of Townships 3 & 5 North of the
base line of Ranges Nos 30 & 31
East of the Willamette Meri-
dian in the State of Oregon
executed by Dolphus Payne
under his Contract No 105 da-
ted August 1st 1861 having
been critically examined the
necessary corrections & explanations
made the said field notes
and the Surveys they de-
scribe are hereby approved

J. P. Sibley
Surveyor General