

Index

Referring the lines to the pages in the field notes

Town 3 N. Range 35 E. Will-Mer-

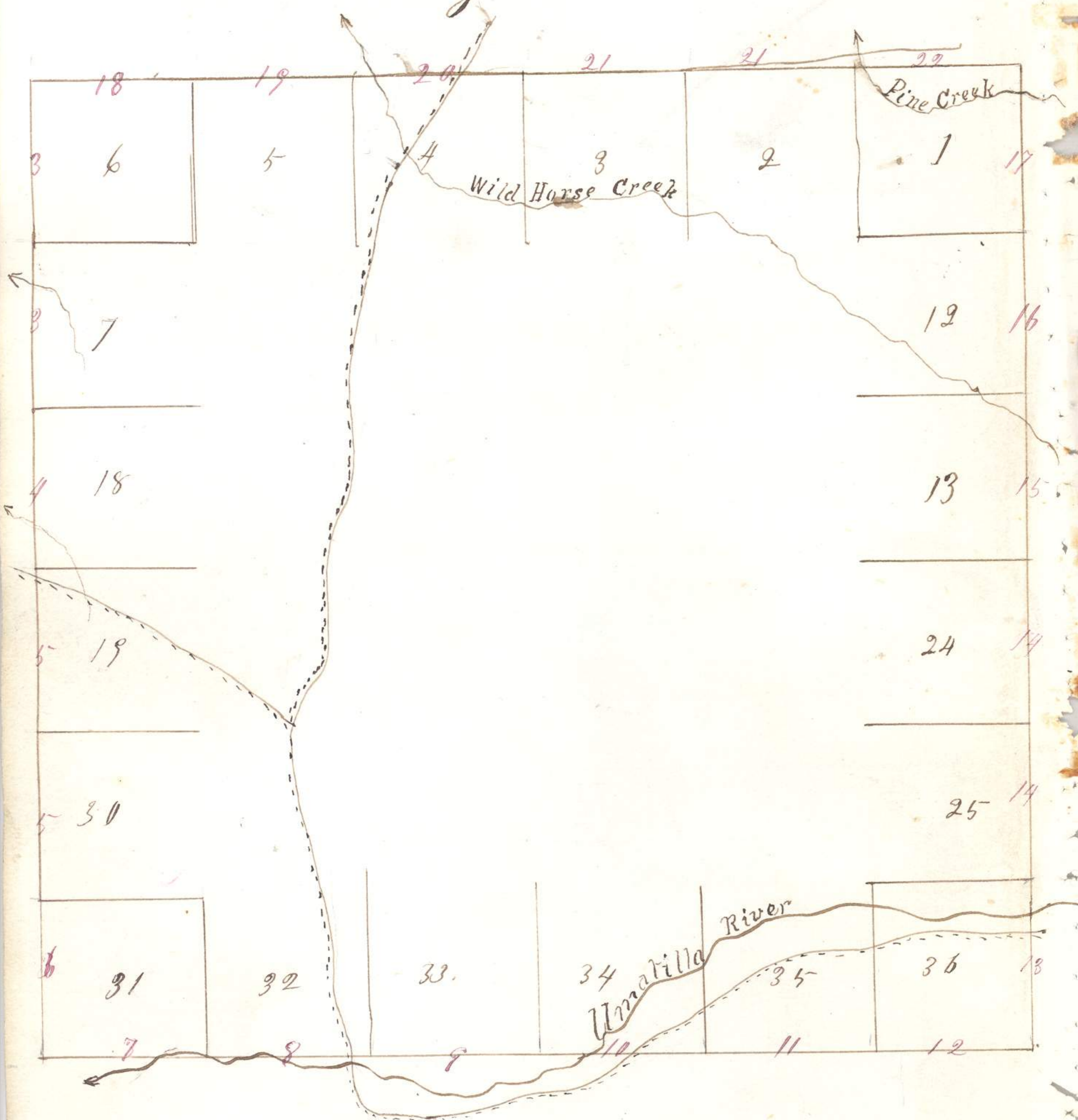

Field notes of the survey
of the exterior lines of Township
number 3 North of Range 35
East of Willamette Meridian
in the State of Oregon, by
William H. Odell Deputy
Surveyor, under his contract
No. 114 bearing date July 2^d
1866.

Commenced July 26th
and completed
July 31st 1866.

Township 3 North Range 35 East ⁷² ~~22~~

Bar 20°30' East

80.00 Set Bassalt Stone 6x10x16 for 100
80.00 corner to sections 35.36
172.

Land broken, good grass,
Soil 2nd Rate

East on south boundary
of section 36,

Bar 21° East

15.00 Small Creek, 15 lbs wide course 75
North, narrow belt of Balsm
and Pine timber along
banks &

40.00 Set post corner for 1/4 section, 150
deposited marked stone,
clay pit, and raised mound
as per instructions.

80.00 Set post corner for sections
Townships 2 & 3 North Ranges
35 & 36, East sections 1. 6. 31.
936. Drove charred stake.

1873

Township 3 North Range 35 East

dug pits, and raised mound
 as per instructions.

Corner on hillside facing the
 North West,

Land broken and
 rocky, good grass.

North on East boundary
 of section 36,

Bar 21° East,

40.00 Set post corner for 1/4 section 125, 125
 from which

A Pine 10 in-dia - bears S 12° E 250 chs

do - do - 10 do - do - do - N 2° W 175 do -

57.15 Boise City Stage Road course 50

East and West,

69.50 Armatilla River 100 chs wide 15

course West -

80.00 Set a Bassalt Stone 7 X 9 X 15 80

Corner for sections 25, 36, 30 & 31

on hillside facing the South,

Township 3 North Range 35 East

Land broken and rocky
grass good, Balsam and
pine timber along the
margin of the River.

North on East boundary
of section 25,

Bar 21° E -

40.00
40.00

Set Basalt Stone 7x5x12.

for 1/4 section corner

+
200

80.00

Set post corner for sections

+
250

24, 25, 19430, drove charred

Stake dug pit and raised

mound as per instructions

This line passes up hill side

Land stony grass good.

North on East boundary of
section 24,

Bar 21° East,

40.00
40.00

Set Basalt Stone 9x16x18.

for 1/4 section corner,

Township 3 North Range 35 East

80,00

Set post corner for sections 24,
13. 1871⁷, from which
A Pine 8 in dia bears S40° W. 28 lbs
do do - 12 do do - do - N42° W. 35 do -
do do - 6 do do - do - N60° E. 8 do -
do do - 7 do do - do - S70° E. 9 do -
Land somewhat broken,
good grass, Soil 2nd rate
some scattering pine timber
this corner -

North on East boundary
of section 13 -

bar 21° E -

40,00

Set post for 14 section corner
from which
A Pine 7 in dia bears N40° W. 75 lbs
no other tree near -
dry pit and raised mound
as per instructions

70,00

Wild Horse Creek channel
dry course North West

Crownship 3 North Range 35 East

76
226

8000 Set post corner for sections

75

12. 13. 7 & 18, from which

A Pine 20 in dia - bears S, 55° W, 28 chs

do - do - 20 do - do - do - N, 75° W, 68 do,

do - do - 24 do - do - do - N, 40° E, 42 do -

do - do - 24 do - do - do - South, 40 do -

Land broken, good grass,
soil 2^d rate, some good timber
on the hill side to the south of
wild horse creek,

July 28th 1866

North on East boundary of
section 42

bar 21° East -

4000 Set post corner for 1/4 section

75

above charred stakes, dug pits,
and raised mound as per
instructions,

7600 Road to timber course E & W,

50

8000 Set post corner for sections

1. 12. 6 & 7, above charred stakes,

227

Township 3 North Range 35 East

and raised mound as per instructions.

Land broken, good grass soil 2nd Rate,

North on East boundary of section 1.

Bar 20° East.

40.00 Set post corner for 14 sections 50-50

on side hill facing the West dug pits and raised mound as per instructions

66.00 Pine Creek 8ths wide course ²⁰⁰ 200

West

80.00 Set post corner for Township ⁷⁵ 75

344 North Ranges 35 & 36 East,

sections 1, 6, 31 & 36. Muck Stone

Mound as per instructions

Land broken, good

grass, some timber on south

side of pine Creek

A list of the names of the individuals employed to assist in running, measuring or marking the lines and corners described in the foregoing field notes of Township number 3 North of the base line of Range 35 East of Willamette Meridian, - showing the respective capacities in which they acted:

J. J. Henderson
 John A. Bigg } Chairman
 P. M. Denney Axeman

Room for affidavit -

I William H. Bell Deputy
 Surveyor, do solemnly swear
 that in pursuance of a contract
 with E. L. Applegate surveyor
 of the public lands of the
 United States in the State of
 Oregon; bearing date July 2^d 1866., and in
 strict conformity to the laws of the United
 States and the instructions furnished by the
 said Surveyor General, I have faithfully
 surveyed the exterior boundaries of
 Township number 3 North of the Base Line
 of Range 35 East of Willamette Meridian
 in the State aforesaid, and do further
 solemnly swear that the foregoing are
 the true and original field notes of
 such survey.

William H. Bell

State of Oregon }
 County of Lane } ss. Subscribed and
 sworn to before me this 23^d day
 of December 1866.

Joel Marey
 Notary Public

237

Surveyor General's Office

Eugene City January 17, 1867

The foregoing field notes of the survey of the exterior boundaries of Township N° 3 North Range 35 East Will. Mer Oregon. Executed by William H. Odell Deputy Surveyor under his contract N° 114 bearing date July 2nd. 1866 having been critically examined the necessary corrections and explanations made the field notes and the surveys they describe are hereby accepted and approved.

E. L. Applegate

Surveyor General of Oregon