

# Index

Referring the lines to the pages in the field notes

## Town 3 N. Range 35 E. Will-Mer-

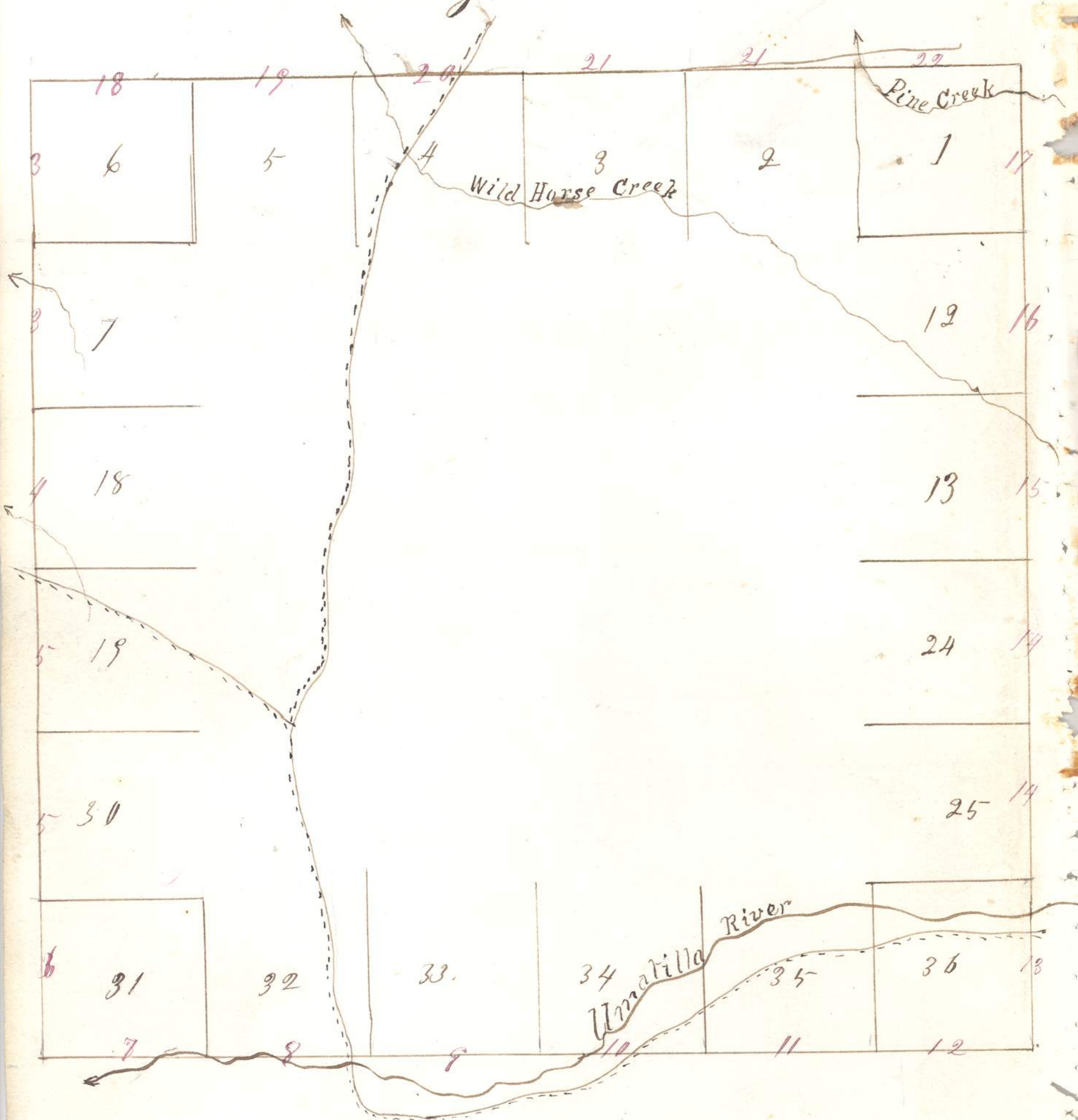

Field notes of the survey  
of the exterior lines of Township  
number 3 North of Range 35  
East of Willamette Meridian  
in the State of Oregon, by  
William H. Odell Deputy  
Surveyor, under his contract  
No. 114 bearing date July 2<sup>d</sup>  
1866.

Commenced July 26<sup>th</sup>  
and completed  
July 31<sup>st</sup> 1866.

Township 3 North Range 35 East - <sup>72</sup> 22

Bar 20°30' East -

80.00 Set Bassalt Stone 6 X 10 X 16 for 100

80.00

Corner to sections 35.36

172.

Land broken, good grass,  
Soil 2<sup>nd</sup> Rate

East on south boundary  
of section 36,

Bar 21° East -

15.00 Small Creek, 15 lbs wide course 75

North, narrow belt of Balsam  
and Pine timber along  
banks &

40.00 Set post corner for 1/4 section, 150

deposited marked stone,  
clay pit, and raised mound  
as per instructions.

80.00 Set post corner for sections

Townships 2 & 3 North Ranges

35 & 36, East sections 1.6.31.

136. Drove charred stake.

1873

Township 3 North Range 35 East

dug pits, and raised mound  
 as per instructions.

Corner on hillside facing the  
 North West,

Land broken and  
 rocky, good grass.

North on East boundary  
 of section 36,

Bar 21° East,

40.00 Set post corner for 1/4 section 125, 125  
 from which

A Pine 10 in-dia - bears S 12° E 250 chs

do - do - 10 do - do - do - N 2° W 175 do -

57.15 Boise City Stage Road course 50

East and West,

69.50 Armatilla River 100 chs wide 15

course West -

80.00 Set a Basalt Stone 7 X 9 X 15 80

Corner for sections 25, 36, 30 & 31

on hillside facing the South,

A list of the names of the individuals employed to assist in running, measuring or marking the lines and corners described in the foregoing field notes of Township number 3 North of the base line of Range 35 East of Willamette Meridian, - showing the respective capacities in which they acted:

J. J. Henderson  
 John A. Bigg } Chairman  
 P. M. Denney Axeman

Room for affidavit -

I William H. Bell Deputy  
 Surveyor, do solemnly swear  
 that in pursuance of a contract  
 with E. L. Applegate surveyor  
 of the public lands of the  
 United States in the State of  
 Oregon; bearing date July 2<sup>d</sup> 1866., and in  
 strict conformity to the laws of the United  
 States and the instructions furnished by the  
 said Surveyor General, I have faithfully  
 surveyed the exterior boundaries of  
 Township number 3 North of the Base Line  
 of Range 35 East of Willamette Meridian  
 in the State aforesaid, and do further  
 solemnly swear that the foregoing are  
 the true and original field notes of  
 such survey.

William H. Bell

State of Oregon }  
 County of Lane } ss. Subscribed and  
 sworn to before me this 23<sup>d</sup> day  
 of December 1866. Joel Mare P  
 Notary Public

237

Surveyor General's Office

Eugene City January 17, 1867

The foregoing field notes of the survey of the exterior boundaries of Township N<sup>o</sup> 3 North Range 35 East Will. Mer Oregon. Executed by William H. Odell Deputy Surveyor under his contract N<sup>o</sup> 114 bearing date July 2nd. 1866 having been critically examined the necessary corrections and explanations made the field notes and the surveys they describe are hereby accepted and approved.

E. L. Applegate

Surveyor General of Oregon