

# Index

Referring the lines to the pages in the field notes

## Town 3 N. Range 35 E. Will-Mer-

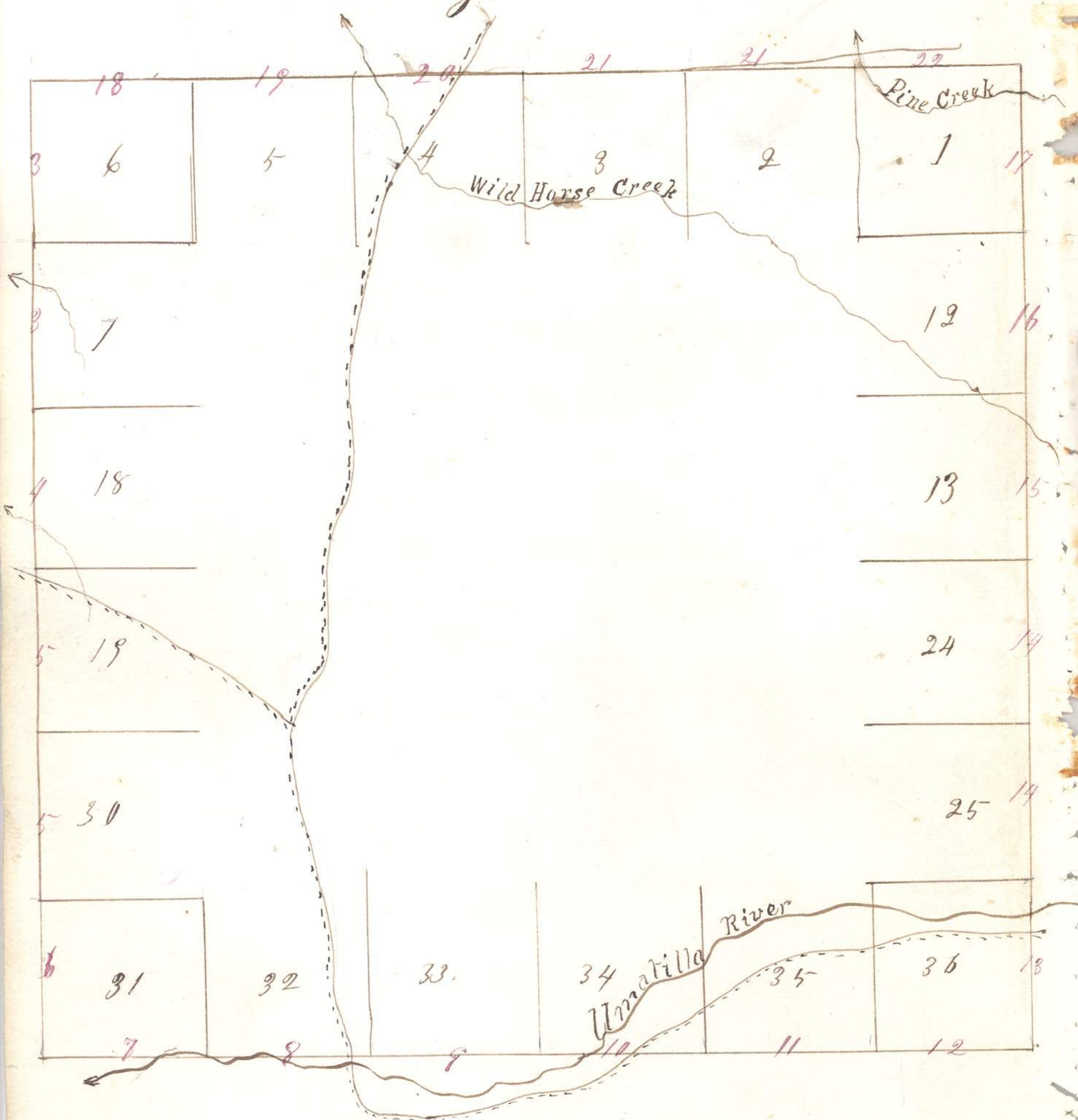

Field notes of the survey  
of the exterior lines of Township  
number 3 North of Range 35  
East of Willamette Meridian  
in the State of Oregon, by  
William H. Odell Deputy  
Surveyor, under his contract  
No. 114 bearing date July 2<sup>d</sup>  
1866.

Commenced July 26<sup>th</sup>  
and completed  
July 31<sup>st</sup> 1866.

34 243

Township 3 North Range 35 East

2  
— 4

South on west boundary of section 6,

40.00 Set  $\frac{1}{4}$  section post corner, <sup>10</sup> 10  
drove charred stake, dug pits, and raised mound as per instructions,

80.00 Set post corner for sections 6. <sup>15</sup> 15  
7. 14 12. Drove charred stake, dug pits, and raised mound as per instructions.  
Land rolling prairie, good grass soil 2<sup>d</sup> rate.

South on West boundary of section 7.

Bar 20° East.

21.50 Small branch 4ths wide course N, W. <sup>15</sup> 15

40.00 Set  $\frac{1}{4}$  section post corner, drove <sup>20</sup> 20  
charred stake, dug pits, and raised mound as per instructions

80.00 Set post corner for sections 7. 18. 12 & 13. drove charred

Township 3 North Range 25 East.

Stake dug pits and raised mound  
as per instructions.

Land gently rolling prairie  
Soil good 2<sup>nd</sup> rate.

South on West boundary of  
section 18.

Bar 20° 30' East.

40.00 Set 4 section post corner,  
drove charred stake, dug  
pits and raised mound as  
per instructions

60.00 Spruce branch 3<sup>rd</sup> wide course  
60.00 North West.

80.00 Set post corner for sections  
80.00 18, 19, 13 & 24. Drove charred  
stake, dug pits, and raised mound  
as per instructions.

Land gently rolling prairie,  
good grass, soil 1<sup>st</sup> Rate.

July 26<sup>th</sup> 1866.

Township 3 North Range 35 East

South on west boundary  
of section 19.

Bar 20° 30' East

1.00 Stage Road from Boise City  
to Amatilla course North  
West and South East.

40.00 Set 1/4 section post corner,  
Drove charred stake, dug pits  
and raised mound as per  
instructions

15

80.00 Set post corner for sections  
19, 30, 24 & 25, drove charred  
stake, dug pits, and raised  
mound as per instructions.  
Land gently rolling  
prairie, good grass soil 2<sup>nd</sup> rate,

5

South on west boundary  
of section 30.

Bar 21° East

40.00 Set 1/4 section post corner, drove  
charred stake, dug pits.

## Township 3 North Range 35 East

and raised mound as per instructions.

80.00 Set post corner for sections 10  
30, 31, 25 & 26, drove charred  
stake, dug pits, and raised  
mound as per instructions.  
Land rolling prairie,  
good grass, Soil 2<sup>nd</sup> Kale,

North on West boundary  
of section 31.

20.00 Bar 22° East,

20.00 Begin to descend toward  
the Armatilla River.

40.00 Set 1/4 section post corner,  
drove charred stake, dug  
pits and raised mound  
as per instructions, 30

80.00 Set post corner for sections 150  
31, 6, 1 & 36 Is 2 & 3 N, W 34 & 35  
East, on steep hillside 4

217

Township 3 North Range 35 East,

facing the south, drove  
churned Stake, and raised  
Stone mound as per  
instructions

Level broken,

Good grass soil  
2<sup>d</sup> Kate,

\*

East on south boundary  
of section 31.

Bear 21°30' East.

40.00 Set 1/4 section post corner,  
on hill side facing West  
drove churned Stake, and  
made Stone Mound as  
per instructions

30

45.00 Right bank of Amatilla  
River 150 wide course S, W,

150

67.00 Enter timber

80.00 To corner for sections 31, 32,

5 & 6, in edge of Amatilla

River course N, W, from which

A list of the names of the individuals employed to assist in running, measuring or marking the lines and corners described in the foregoing field notes of Township number 3 North of the base line of Range 35 East of Willamette Meridian, - showing the respective capacities in which they acted:

J. J. Henderson  
 John A. Bigg } Chairman  
 P. M. Denney Axeman

Room for affidavit -



I William H. Bell Deputy  
 Surveyor, do solemnly swear  
 that in pursuance of a contract  
 with E. L. Applegate surveyor  
 of the public lands of the  
 United States in the State of  
 Oregon; bearing date July 2<sup>d</sup> 1866., and in  
 strict conformity to the laws of the United  
 States and the instructions furnished by the  
 said Surveyor General, I have faithfully  
 surveyed the exterior boundaries of  
 Township number 3 North of the Base Line  
 of Range 35 East of Willamette Meridian  
 in the State aforesaid, and do further  
 solemnly swear that the foregoing are  
 the true and original field notes of  
 such survey.

William H. Bell

State of Oregon }  
 County of Lane } ss. Subscribed and  
 sworn to before me this 23<sup>d</sup> day  
 of December 1866. Joel Marey  
 Notary Public

237

Surveyor General's Office

Eugene City January 17, 1867

The foregoing field notes of the survey of the exterior boundaries of Township N<sup>o</sup> 3 North Range 35 East Will. Mer Oregon. Executed by William H. Odell Deputy Surveyor under his contract N<sup>o</sup> 114 bearing date July 2nd. 1866 having been critically examined the necessary corrections and explanations made the field notes and the surveys they describe are hereby accepted and approved.

E. L. Applegate

Surveyor General of Oregon