

Index

Referring the lines to the pages in the field notes

Town 3 N. Range 35 E. Will-Mer-

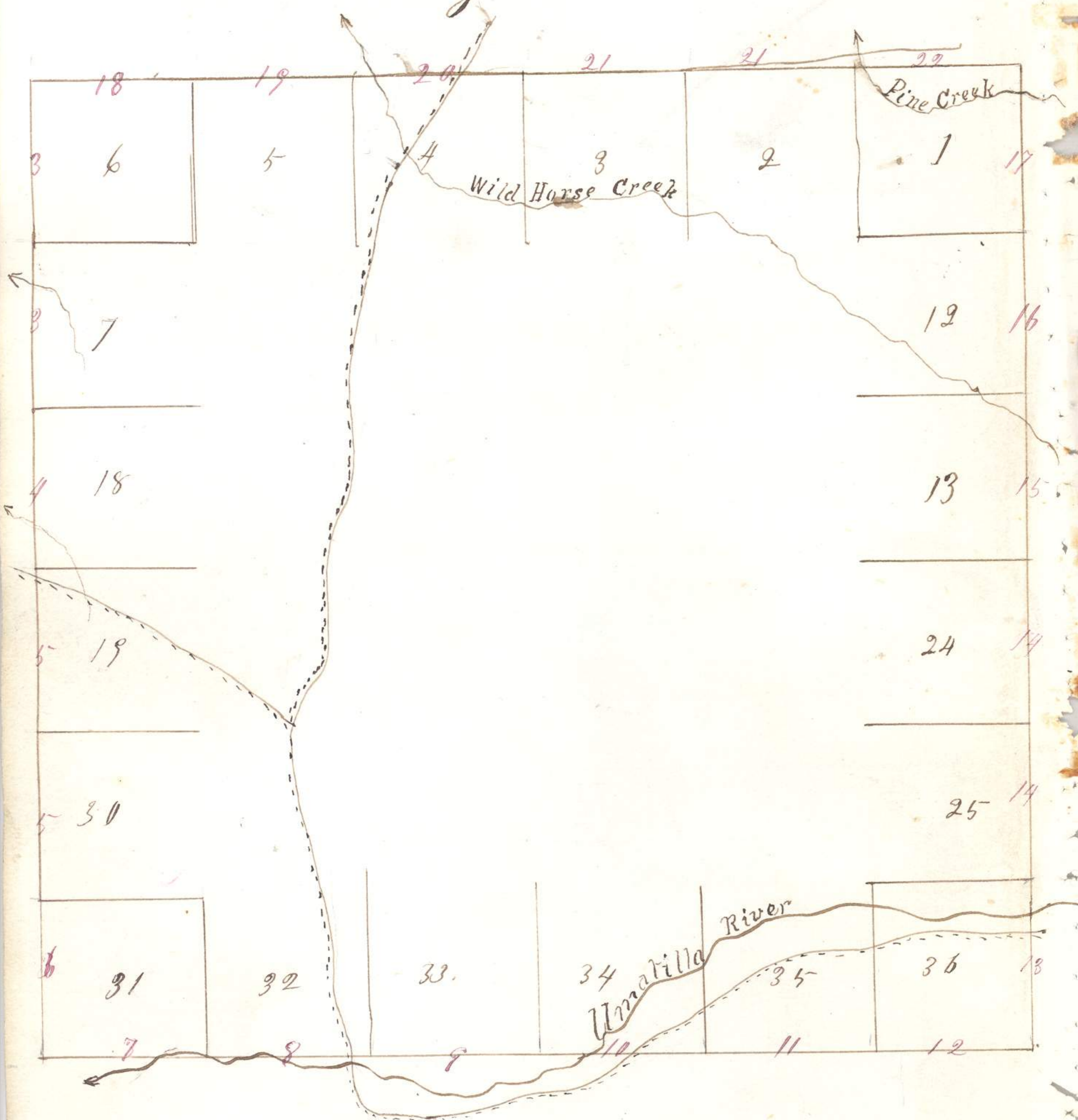

Field notes of the survey
of the exterior lines of Township
number 3 North of Range 35
East of Willamette Meridian
in the State of Oregon, by
William H. Odell Deputy
Surveyor, under his contract
No. 114 bearing date July 2^d
1866.

Commenced July 26th
and completed
July 31st 1866.

Township 3 North Range 35 East

and raised mound as per instructions.

80.00 Set post corner for sections 10
30, 31, 25 & 26, drove charred
stake, dug pits, and raised
mound as per instructions.
Land rolling prairie,
good grass, Soil 2nd Kale,

North on West boundary
of section 31.

20.00 Bar 22° East,

20.00 Begin to descend toward
the Armatilla River.

40.00 Set 1/4 section post corner,
drove charred stake, dug
pits and raised mound
as per instructions, 30

80.00 Set post corner for sections 150
31, 6, 1 & 36 Is 2 & 3 N, W 34 & 35
East, on steep hillside 4

217

Township 3 North Range 35 East,

facing the south, drove
churned Stake, and raised
Stone mound as per
instructions

Level broken,

Good grass soil
2^d Kate,

*

East on south boundary
of section 31.

Bear 21°30' East.

40.00 Set 1/4 section post corner,
on hill side facing West
drove churned Stake, and
made Stone Mound as
per instructions

45.00 Right bank of Amatilla
River 150 wide course S, W,

67.00 Enter timber

80.00 To corner for sections 31, 32,
5 & 6, in edge of Amatilla
River course N, W, from which

30

150

Township 3 North Range 35 East.

At Pine 20 in. dia, bears East
 1.15 Chs. on right bank
 of River, also Pine 8 in
 diameter bears N 45° E, 75 lbs
 Land broken on this
 line hill sides stony,
 Timber along the banks
 of the river consist of
 Balsam Alder & a few
 Pines, Undergrowth the
 same, the land along
 Rivers bottoma rich but
 gravelly.

East on south boundary
 of section 32

Bear 20° East,

23.50

Edge of Amatilla River
 Hence along the Channel
 of the river,

30.00

Leave River to the right

40.00

Made corner for 1/4 section

Township 3 North Range 35 East.

on Pine 3 in-dia- from which
 a Pine 30 in-dia-bears $S78^{\circ}W$ 150 ft
 do, do, 6 do-do- do- $N56^{\circ}W$, 50 do-

15.00 Leave timber, and pass
 over point of hill,

13.00 Stage Road from Boise
 City to Amatilla River

Course $N4S$.

Stage Station bears
 South about 3.00

20.00 Set post corner for sections
 32, 33, 4 & 5, drove charred
 stake, dug pits as per
 instructions.

Land broken & rocky
 Timber Balm Pine and
 Alder, Remder growth
 the same.

East on South boundary
 of section 33.

Bar 20° East,

220/0

3

Township 3 North Range 35 East.

38.00 Bar 18° 30' East 150

40.00 Set 1/4 section post corner, 70

40.00 set Stone 6 x 10 x 14 Bassalt
on hill side facing the
South -

80.00 Set Bassalt Stone 6 x 12 x 15.
Corner for sections 33.

34. 3 x 4.

Land broken & Stony

East on south boundary
of section 34.

Bar 19° East,

25.00 Enter timber in River bottom 130

31.50 Amatilla River 3,000 ft. wide
course south west,

40.00 Set post corner for 1/4 section
from which

A Balin bin-dia-bars N, 15° E, 75 ft.

do, do - 24, do - do - do - S, 87° E, 37 "

63.50 Stage Road course N. E. & S. W.

70.00 Leave timber & River bottom

Township 3 North Range 35 East.

80.00 Set post corner for sections, + 80 80

34, 35, 243, from which
 a Pine 5 in-dia-bears N46°E, 156 lbs
 do-do-6 do-do-do N87°E 100"
 no other tree near, dug pits
 and raised mound as per
 instructions

Land broken except in
 river bottom, all stony,
 Timber Balm Pine &
 Alder, Undergrowth the
 same,

July 27th

East on south boundary
 of section 35,

Bar 21° East -

40.00 Set post corner for 1/4 section + 30

above charred stake, dug
 pits and raised mound
 as per instructions,

62.00 A Pine tree 18 in-dia + 120

Township 3 North Range 35 East - ⁷² 22

Bar 20°30' East -

80.00 Set Bassalt Stone 6 X 10 X 16 for 100

80.00 Corner to sections 35.36

172.

Land broken, good grass,
Soil 2nd Rate

East on south boundary
of section 36,

Bar 21° East -

15.00 Small Creek, 15 lbs wide course 75

North, narrow belt of Balsm
and Pine timber along
banks &

40.00 Set post corner for 1/4 section, 150

deposited marked stone,
clay pit, and raised mound
as per instructions.

80.00 Set post corner for sections

Townships 2 & 3 North Ranges

35 & 36, East sections 1. 6. 31.

936. Drove charred stake.

1873

Township 3 North Range 35 East

dug pits, and raised mound
 as per instructions.

Corner on hillside facing the
 North West,

Land broken and
 rocky, good grass.

North on East boundary
 of section 36,

Bar 21° East,

40.00 Set post corner for 1/4 section 125, 125
 from which

A Pine 10 in-dia - bears S 12° E 250 chs

do - do - 10 do - do - do - N 2° W 175 do -

57.15 Boise City Stage Road course 50

East and West,

69.50 Armatilla River 100 chs wide 15

course West -

80.00 Set a Basalt Stone 7 X 9 X 15 80

Corner for sections 25, 36, 30 & 31

on hillside facing the South,

A list of the names of the individuals employed to assist in running, measuring or marking the lines and corners described in the foregoing field notes of Township number 3 North of the base line of Range 35 East of Willamette Meridian, - showing the respective capacities in which they acted:

J. J. Henderson
 John A. Bigg } Chairman
 P. M. Denney Axeman

Room for affidavit -

I William H. Bell Deputy
 Surveyor, do solemnly swear
 that in pursuance of a contract
 with E. L. Applegate surveyor
 of the public lands of the
 United States in the State of
 Oregon; bearing date July 2^d 1866., and in
 strict conformity to the laws of the United
 States and the instructions furnished by the
 said Surveyor General, I have faithfully
 surveyed the exterior boundaries of
 Township number 3 North of the Base Line
 of Range 35 East of Willamette Meridian
 in the State aforesaid, and do further
 solemnly swear that the foregoing are
 the true and original field notes of
 such survey.

William H. Bell

State of Oregon }
 County of Lane } ss. Subscribed and
 sworn to before me this 23^d day
 of December 1866. Joel Marey
 Notary Public

237

Surveyor General's Office

Eugene City January 17, 1867

The foregoing field notes of the survey of the exterior boundaries of Township N^o 3 North Range 35 East Will. Mer Oregon. Executed by William H. Odell Deputy Surveyor under his contract N^o 114 bearing date July 2nd. 1866 having been critically examined the necessary corrections and explanations made the field notes and the surveys they describe are hereby accepted and approved.

E. L. Applegate

Surveyor General of Oregon