

# Index

Referring the lines to the pages in the field notes

## Town 3 N. Range 35 E. Will-Mer-

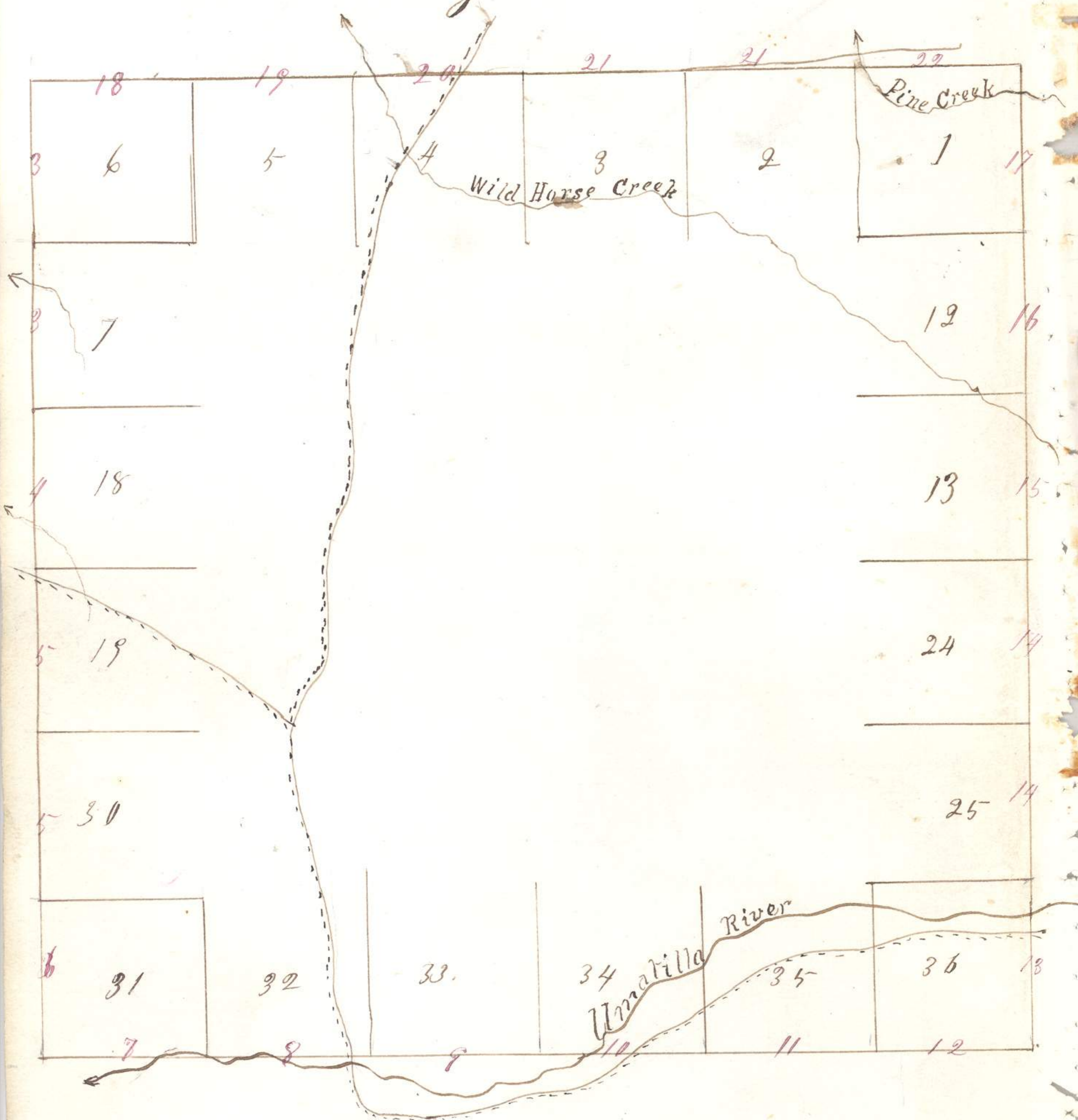



Field notes of the survey  
of the exterior lines of Township  
number 3 North of Range 35  
East of Willamette Meridian  
in the State of Oregon, by  
William H. Odell Deputy  
Surveyor, under his contract  
No. 114 bearing date July 2<sup>d</sup>  
1866.

Commenced July 26<sup>th</sup>  
and completed  
July 31<sup>st</sup> 1866.



227

Township 3 North Range 35 East

and raised mound as per instructions.

Land broken, good grass soil 2<sup>nd</sup> Rate,

North on East boundary of section 1.

Bar 20° East.

40.00 Set post corner for 1/4 section 50-50

on side hill facing the West dug pits and raised mound as per instructions

66.00 Pine Creek 8ths wide course <sup>200</sup> 200

West

80.00 Set post corner for Township <sup>75</sup> 75

344 North Ranges 35 & 36 East,

sections 1, 6, 31 & 36. Muck Stone

Mound as per instructions

Land broken, good

grass, some timber on south

side of pine Creek



15  
Township 3 North Range 35 East <sup>78</sup> 228

West on Random on north  
boundary of Township  
Bar 18° East,

On north boundaries of sections

1. 2. 3. 4. 5 & 6 set half mile

and mile post, and intersected

West boundary in 476.90.

Chains .57 lbs North of

of Post corner for

Townships 3 & 4 North

Ranges 34 & 35 East,

Therefore the correction will

be North 89° 56' East on

true line.

July 30<sup>th</sup> 1866.

N 89° 56' East on true line

North boundary of section 6

36.90 Set post corner for 1/4 section

above channel stake dug

pits, and raised mound

as per instructions,



Township 3 North Range 35 East.

16.90 Set post corner for sections  
5. 6. 31 & 32, drove charred stake  
dug pit and raised mound  
as per instructions.

Land gently rolling  
prairie grass good soil  
good 2<sup>nd</sup> rate -

N 89° 56' East on North  
boundary of section 5.

Bar 20' E -

40.00 Set post corner for  $\frac{1}{4}$  section  
drove charred stake, dug  
pit and raised mound  
as per instructions.

10

80.00 Set post corner for sections  
4. 5. 32 & 33, drove charred stake  
dug pit and raised mound  
as per instructions.

5

Land gently rolling  
good grass, soil good  
2<sup>nd</sup> rate -



Township 3 North Range 35 East <sup>20</sup> 230

N 89° 56' E, on north boundary  
of section 4,

bar 20° E

9.60	Wild Horse Creek 5 lbs wide	10
5.60	Course North West,	
17.10	Enter field	
17.10	Leave field	
27.10	Road Course North and South,	+ 20
40.00	Set post corner for 14 section	+ 5
40.00	Drove charred stake, dug pits, and raised mound	
51.50	as per instructions.	
51.50	Stage Road from Walla Walla to Boise City course N & S.	
80.00	Set post corner for sections	
80.00	3, 4, 33 & 34, Drove charred stake dug pits, and raised mound as per instructions.	
	Land broken, grass good, Soil on west side of Wild Horse creek and in field	
	1 <sup>st</sup> Rate balance 2 <sup>nd</sup> rate,	



Township 3 North Range 35 East,  
 N 89° 56' E on North boundary  
 of section 3.

Bar 20° E

40.00 Set post corner for  $\frac{1}{4}$  section  
 drove charred stake dug  
 pit and raised mound,  
 as per instructions.

+  
30

80.00 Set post corner for section  
 2, 3, 34 & 35. Drove charred  
 stake, dug pit and  
 raised mound as per  
 instructions.

+  
75

Land broken, good  
 grass Soil good 2<sup>d</sup> Rate

N 89° 56' E on North  
 boundary of section 2,

Bar 18° East

40.00 Set post corner for  $\frac{1}{4}$  section  
 on hillside facing the  
 West drove charred stake,



232 <sup>22</sup>

5

Township 3 North Range 35 East

80.00 dug pits, and raised mound as per instructions 700

Set post corner for sections 1, 2, 35 & 36, from which

A Pine 12 in dia bears N 15° W, 166 lbs

do- do- 28 do- do- do- N, 1° E, 90 do-

do- do- 30 do- do- do- S, 2° E, 102 do-

No tree near in section 2

Land broken, good grass,  
Soil good 2<sup>d</sup> rate,

N 89° 56' East on south boundary of section 36

Bar 20° 30' East-

460 Pine Creek 8 lbs wide course North 15

40.00 Set post corner for 4 section 350

drove charred stake, dug pits, and raised mound as instructions,

80.00 To post corner 150

Land broken and Rocky

Grass good - July 31<sup>st</sup> 1866



233  
Township 3 North Range 35 East

The greater part of  
this Township is included  
in the Amatilla Indian  
Reservation,

The lands are rich and  
very productive wherever  
there is sufficient moisture  
to prevent the long dry  
summers from parching  
up the lands,

On all the lands there  
is a heavy growth of rich  
bunch grass.

Upon considerable  
portion of land not  
included in the Reservation  
valuable claims have  
been located hence  
that portion should be  
subdivided,



A list of the names of the individuals employed to assist in running, measuring or marking the lines and corners described in the foregoing field notes of Township number 3 North of the base line of Range 35 East of Willamette Meridian, - showing the respective capacities in which they acted:

J. J. Henderson  
 John A. Bigg } Chairman  
 P. M. Denney Axeman

Room for affidavit -



I William H. Bell Deputy  
 Surveyor, do solemnly swear  
 that in pursuance of a contract  
 with E. L. Applegate surveyor  
 of the public lands of the  
 United States in the State of  
 Oregon; bearing date July 2<sup>d</sup> 1866., and in  
 strict conformity to the laws of the United  
 States and the instructions furnished by the  
 said Surveyor General, I have faithfully  
 surveyed the exterior boundaries of  
 Township number 3 North of the Base Line  
 of Range 35 East of Willamette Meridian  
 in the State aforesaid, and do further  
 solemnly swear that the foregoing are  
 the true and original field notes of  
 such survey.

William H. Bell

State of Oregon }  
 County of Lane } ss. Subscribed and  
 sworn to before me this 23<sup>d</sup> day  
 of December 1866. Joel Marey  
 Notary Public



237

Surveyor General's Office

Eugene City January 17, 1867

The foregoing field notes of the survey of the exterior boundaries of Township No 3 North Range 35 East Will. Mer Oregon. Executed by William H. Odell Deputy Surveyor under his contract No 114 bearing date July 2nd. 1866 having been critically examined the necessary corrections and explanations made the field notes and the surveys they describe are hereby accepted and approved.

E. L. Applegate

Surveyor General of Oregon