

I William H Odell, do solemnly swear that I will well and truly execute the surveys set forth in my Contract with E. S. Applegate Surveyor General of Oregon No. 114, bearing date July 2nd 1866, in conformity with the laws of the United States, and the instructions from the said Surveyor General, and the Commissioner of the General Land Office according to the best of my skill and ability

W. H. Odell

State of Oregon }
 County of Umatilla } ss. Subscribed and
 sworn to before me this 23rd
 Twenty third day of July 1866

Hawkins Shelton
 J P

183

~~184~~

W. J. Henderson and John
 A. Biggs do solemnly swear that
 we will well and faithfully perform
 the duties of Chain Carriers while
 assisting William H. Odell Deputy
 Surveyor in his contract No. 114
 bearing date July 2^d 1866; That
 we will level the Chain over uneven
 ground; that we will plumb the
 Tally Pins whether dropping or
 striking the same, and that
 we will report the true distance
 of all lines measured, and perform
 such other duties as are required in conform-
 -ity with the Instructions furnished
 according to the best of our ability

State of Oregon }
 County of Yamhill }
 sworn to before me this 23 day
 of July 1866

W. J. Henderson
 J. A. Biggs

Subscribed and
 Sworn to before me this 23 day
 of July 1866
 Hawkins Sherton
 20

J. P. M. Denny

186

do solemnly swear that I will well and faithfully perform the duties of a man while assisting William H. Cole Deputy Surveyor in his Contract No 144, bearing date July 2nd 1866. That I will mark the lines surveyed and plant the boundary monuments in conformity with the furnished instructions according to the best of my ability,

J. P. M. Denny

State of Oregon
County of Wmatilla } ss. Subscribed
and sworn to before me this
23rd day of July 1866
Hawkins Shilton

J. P.

194

Index

Referring the lines to the pages of the field notes

Town 4N. Range 34E. Will. Mer-

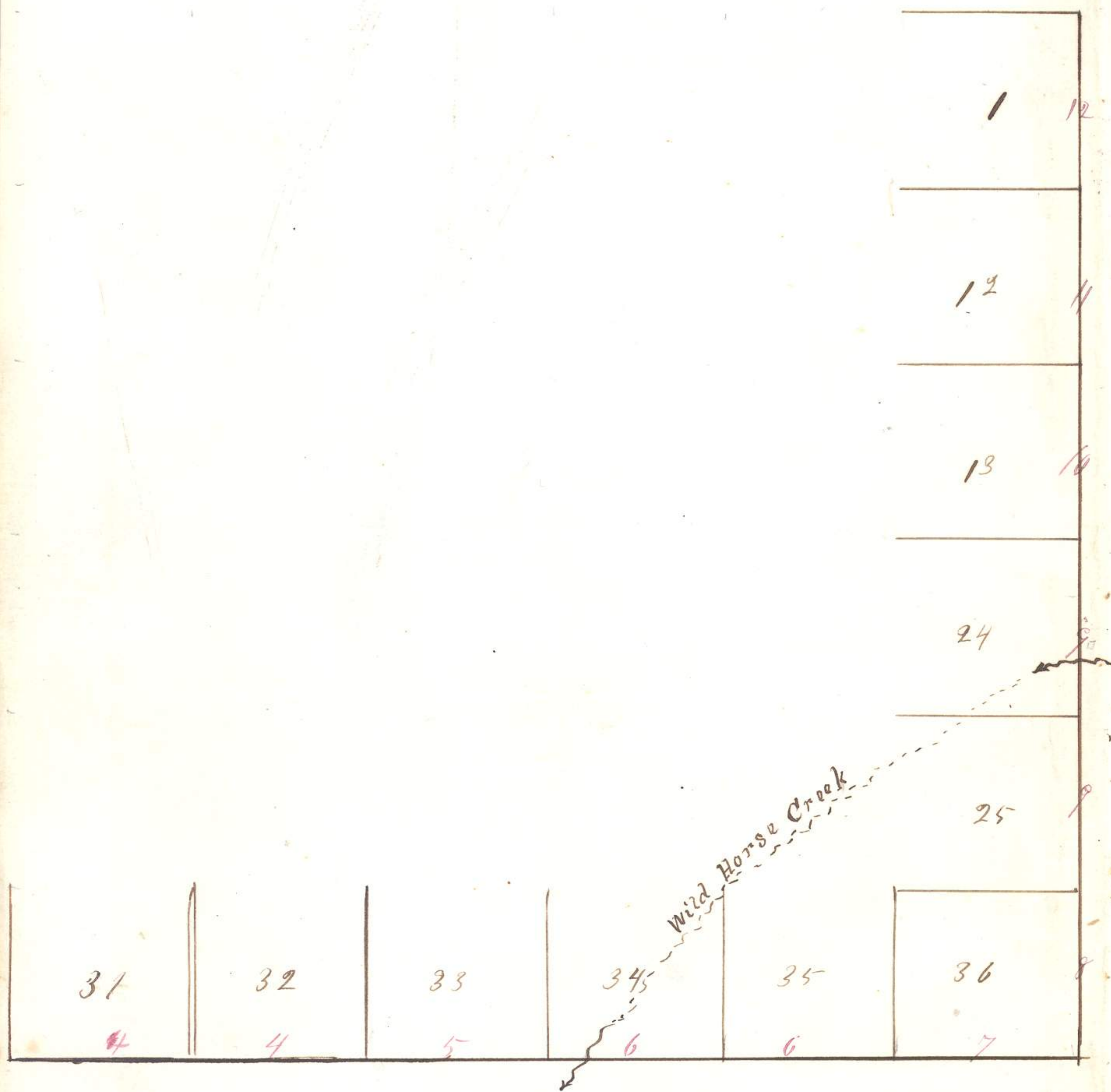

193³

Commenced the survey
of the exterior boundaries of
Township number 4 North
of Base Line of Range 34 East
of Willamette Meridian, begin-
ning at the North East corner
of Township number 3 North
of the Base Line, of Range 33
East of Willamette Meridian
July 25th 1866.

19
Township 4 North Range 34 East, 1977 7

40.00 Set $\frac{1}{4}$ Section post corner 15

40.00 Drove charred stake, dug pits,
and raised mound as per
instructions.

80.00 Set post corner for sections
35 & 36, also 142, T4N, R34E,
Drove charred stake, dug pit
and raised mound as per
instructions.

Land rolling prairie
good grass, soil good
2nd rate.

East on South boundary
of sections 36

Bar 21° East,

40.00 Set $\frac{1}{4}$ Section post corner 10

Drove charred stake, dug
pits, and raised mound
as per instructions,

80.00 Set post corner for Townships

8 194
Township 4 North Range 34 East

344 North of Ranges 34435,
East, Sections 1, 6, 31, 436,

Drove charred Stake dug
pits, and raised mound
as per instruction.

Land rolling good
grass, soil 2nd rate -

North on East boundary
of section 36.

Bar 20° East -

40.00 Set $\frac{1}{4}$ section post corner
Drove charred Stake, dug
pits, and raised mound
as per instructions

80.00 Set post corner for sections
25, 36, 30 & 31, Drove charred
Stake dug pits and raised
mound as per instructions.
Land gently rolling, good
grass, Soil 2nd rate,

A list of the names of the persons employed in assisting in running, measuring, or marking the lines and corners described in the foregoing field Notes of Township No. 4 North of the base line of Range No. 34 East of Willamette Meridian, showing the respective capacities in which they acted:

J. J. Henderson }
 John A. Bigg } Chairman
 P. M. Denney } Axeman

Affidavit

205

I William H. Odell, deputy
Surveyor, do solemnly swear that,
in pursuance of a contract with
E. L. Applegate surveyor of the
public lands of the United
States in the State of Oregon, bearing
date the 2^d day of July 1866,
and in strict conformity to the laws
of the United States and the instructions
furnished by said Surveyor General,
I have faithfully surveyed the exterior
boundaries of Township number 4
North of Base Line of Range 34 East
of Willamette Meridian in the State
aforesaid, and do further solemnly
swear that the foregoing are the true and
original field notes of such survey.

William H. Odell

State of Oregon }

County of Lane } ss

Subscribed and sworn to
before me this 23rd day of December 1866

Joel Ware

Notary Public

Surveyor General's Office
Eugene City January 17th 1867

The foregoing field notes of the survey
of the Exterior boundaries of Township
N^o 4 North Range N^o 34 East Will.

Meer. Oregon, executed by William
H. Odell, Deputy Surveyor under
his contract N^o 114 bearing date July
2nd. 1866 having been critically exam-
ined, the necessary corrections and
explanations made, the field notes
and the surveys they describe are hereby
approved.

E. L. Applegate
Surveyor General of Oregon