

Index

Referring the lines to the pages in the field notes

Town 3 N. Range 35 E. Will-Mer-

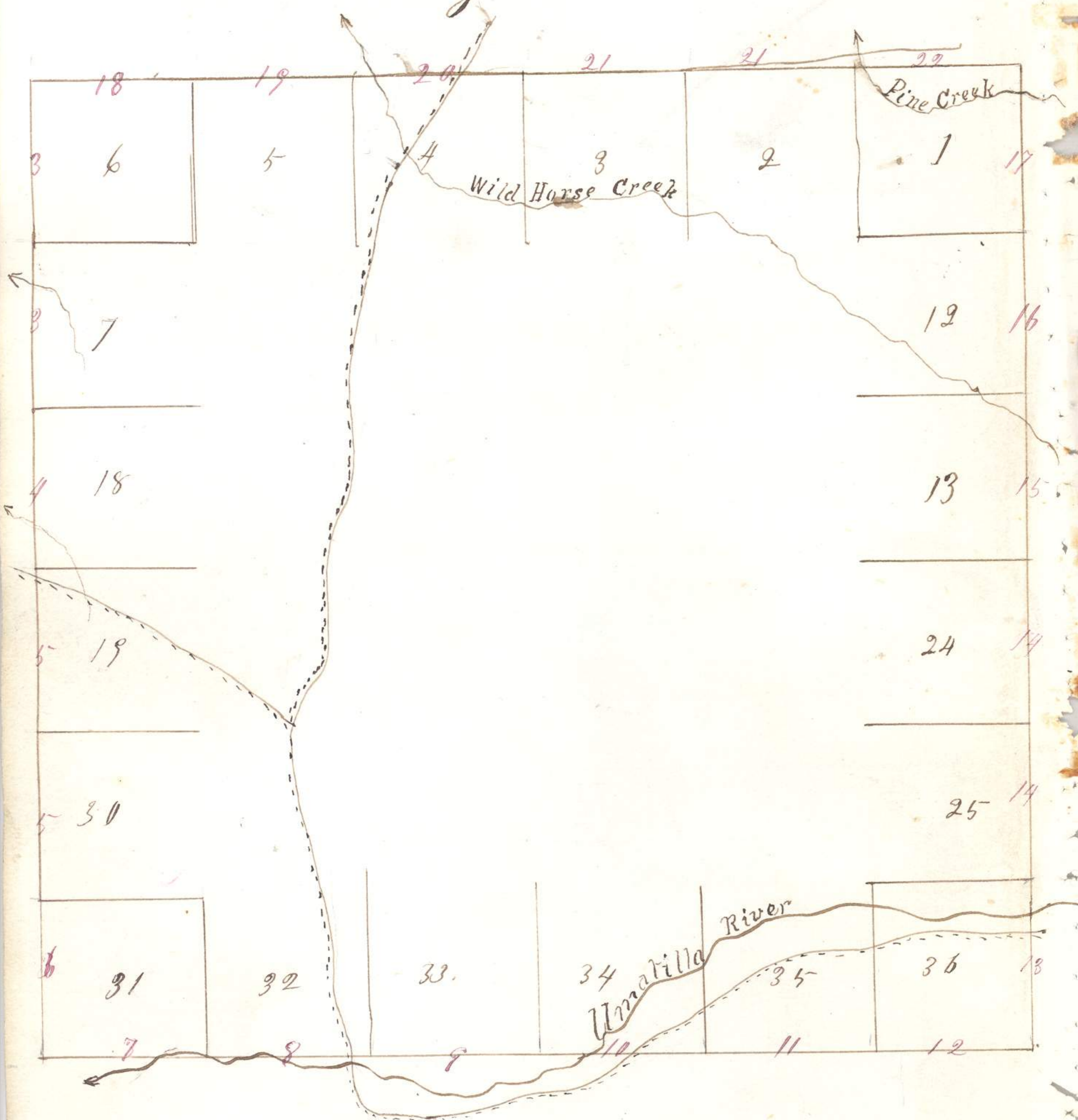

Field notes of the survey
of the exterior lines of Township
number 3 North of Range 35
East of Willamette Meridian
in the State of Oregon, by
William H. Odell Deputy
Surveyor, under his contract
No. 114 bearing date July 2^d
1866.

Commenced July 26th
and completed
July 31st 1866.

Township 3 North Range 35 East

and raised mound as per instructions.

80.00 Set post corner for sections 10
30, 31, 25 & 26, drove charred
stake, dug pits, and raised
mound as per instructions.
Land rolling prairie,
good grass, Soil 2nd Kale,

North on West boundary
of section 31.

20.00 Bar 22° East,

20.00 Begin to descend toward
the Armatilla River.

40.00 Set 1/4 section post corner,
drove charred stake, dug
pits and raised mound
as per instructions, 30

80.00 Set post corner for sections 150
31, 6, 1 & 36 Is 2 & 3 N, W 34 & 35
East, on steep hillside 4

217

Township 3 North Range 35 East,

facing the south, drove
churned Stake, and raised
Stone mound as per
instructions

Level broken,

Good grass soil
2^d Kate,

*

East on south boundary
of section 31.

Bear 21°30' East.

40.00 Set 1/4 section post corner,
on hill side facing West
drove churned Stake, and
made Stone Mound as
per instructions

45.00 Right bank of Amatilla
River 150 wide course S, W,

67.00 Enter timber

80.00 To corner for sections 31, 32,
5 & 6, in edge of Amatilla
River course N, W, from which

30

150

A list of the names of the individuals employed to assist in running, measuring or marking the lines and corners described in the foregoing field notes of Township number 3 North of the base line of Range 35 East of Willamette Meridian, - showing the respective capacities in which they acted:

J. J. Henderson
 John A. Bigg } Chairman
 P. M. Denney Axeman

Room for affidavit -

I William H. Orell Deputy
 Surveyor, do solemnly swear
 that in pursuance of a contract
 with E. L. Applegate surveyor
 of the public lands of the
 United States in the State of
 Oregon; bearing date July 2^d 1866., and in
 strict conformity to the laws of the United
 States and the instructions furnished by the
 said Surveyor General, I have faithfully
 surveyed the exterior boundaries of
 Township number 3 North of the Base Line
 of Range 35 East of Willamette Meridian
 in the State aforesaid, and do further
 solemnly swear that the foregoing are
 the true and original field notes of
 such survey.

William H. Orell

State of Oregon }
 County of Lane } ss. Subscribed and
 sworn to before me this 23^d day
 of December 1866. Joel Mare
 Notary Public

237

Surveyor General's Office

Eugene City January 17, 1867

The foregoing field notes of the survey of the exterior boundaries of Township N° 3 North Range 35 East Will. Mer Oregon. Executed by William H. Odell Deputy Surveyor under his contract N° 114 bearing date July 2nd. 1866 having been critically examined the necessary corrections and explanations made the field notes and the surveys they describe are hereby accepted and approved.

E. L. Applegate

Surveyor General of Oregon