

100

Rec'd in Office

137

Nov 4th 1861

137A

Field notes of the exterior boundary lines of Township No 3 N R 31

and of Township No 5 N R 30 East of the Willamette Meridian surveyed by Dolphus S. Payne, ^{deputy surveyor} under his Contract No 100 dated August 1st 1861

Town 3 N R 31

Commenced August 20th 1861

Completed August 23rd 1861

Town 5 N R 30

Commenced September 17th 1861

Completed September 17, 1861

80
5-90
74-10

Chains Township 3 N. Range 26 East

East On a random line bet sec^s 28 & 33
 Cal $20^{\circ}15' E$

- 40.00 Set a post for Temp gr sec corner
 80.14 Intuseer N & S line 35-lks North
 of the corner to sec^s 27, 28, 33 & 34
 from which corner I run
 $N 89^{\circ}45' W$. On a true line bet sec^s 28 & 33
 40.07 The point for gr sec corner. Drove a
 Charred Stake, & raised a mound
 with trenches, as per instructions
 80.14 The corner to sec^s 32, 33, 28 & 29
 Soil Light & Sandy, producing good grass

North bet sec^s 28 & 29

- 40.00 The point for gr sec corner. Drove
 Charred Stake, and raised mound
 with trenches, as per instructions
 80.00 The point for corner to sec^s 20, 21, 28 & 29
 Drove Charred Stake & raised a mound
 with trenches as per instructions
 Soil Sandy. Sand rolling

138

138A

Index

Exterior boundaries, T3NR30E and T5NR30E

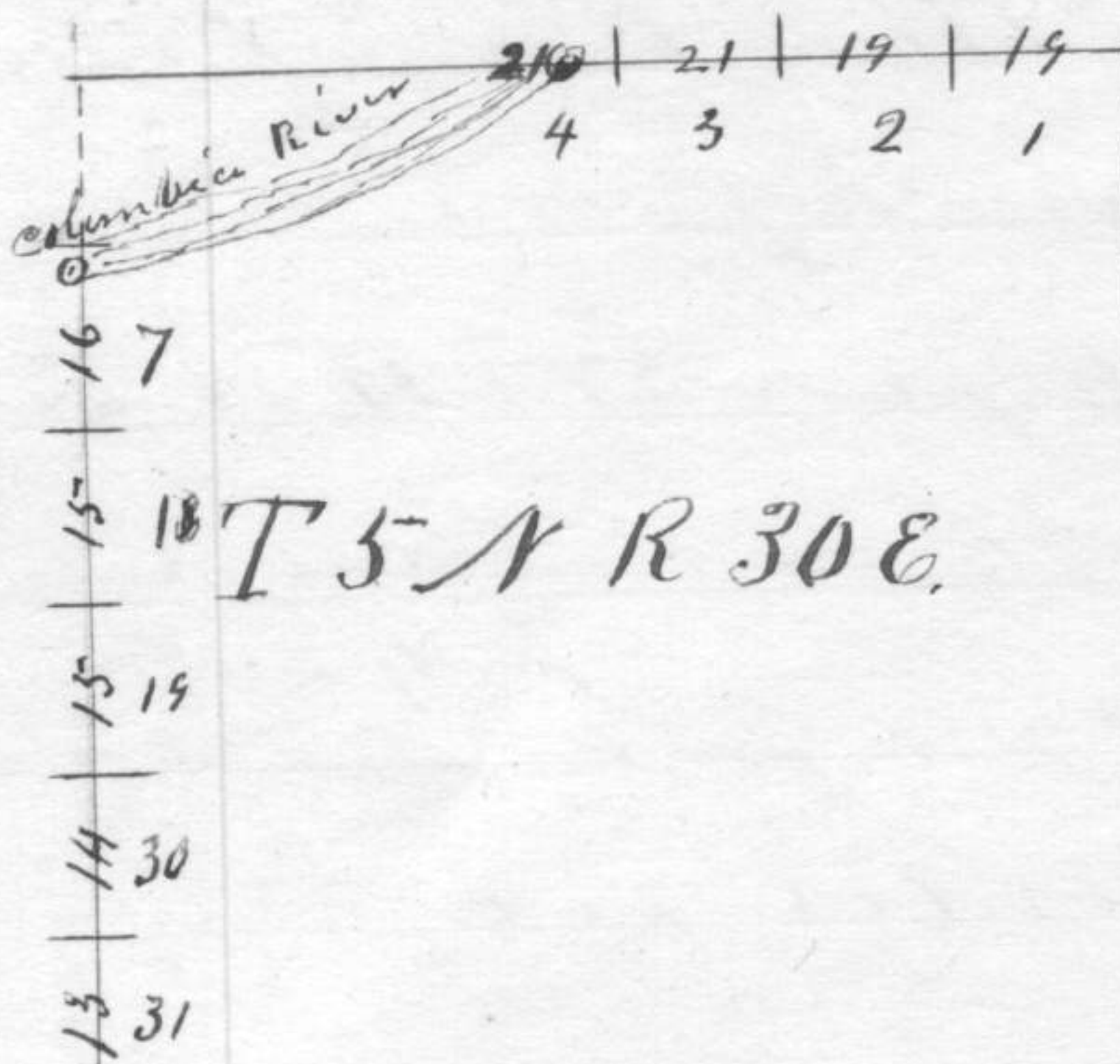

Columbia River

16 7

15 18 T5NR30E

15 19

14 30

13 31

T4NR30E

4N31E

4N29

7 8 8 9 9 10

6 5 4 3 2 1 6

3NR30E

T3NR31E

12 4

13 3

24 3

25 2

36 1

139

(19)

139

Chains

Township 3 N Range 26 East

- Cast on a random line bet sec 21 & 28
 var $29^{\circ} E$
- 40.00 Set a post for temp gr see corner
- 79.70 Intersect N & S line, 40 lks north
 of the corner to sec 21. 22. 27 & 28
 from which corner I run
 $N 89^{\circ} 43' W$ on a true line bet sec 21 & 28
- 39.85 The point for gr see corner. Grove
 chassed stake & raised mound with
 trenches, as per instructions
- 79.70 The corner to sec 20. 21. 28 & 29
 Soil sandy. Sand high & rolling

North bet sec 20 & 21

- 40.00 The point for gr see corner. Grove
 Chassed stake, & raised mound with
 trenches, as per instructions
- 70.00 The foot of descent - 100 ft
 Enter Columbia river bottom
- 80.00 The point for corner to sec 16. 17. 20 & 21
 Grove Chassed stakes raised a mound
 with trenches, as per instructions
 Soil sandy. 3rd rate

State of Oregon }
 County of Wasco } ss: We, John Brattain

William B. Pengra, having been
 appointed Chairman in the service
 of A. S. Payne, deputy surveyor of the
 lands of the United States in Oregon
 do solemnly swear that we will
 faithfully execute the duties of
 Chain Carriers; - that we will
 level the chain upon uneven
 ground and plumb the tally
 pins whether by sticking or drop-
 ping the same; that we will
 report the true distance to all
 notable objects and the true
 length of all lines that we
 assist in measuring to the
 best of our skill and ability.

Subscribed & sworn }
 before me this 12th }
 day of August 1861 }
 W. C. Murray }
 County Clerk }

John Brattain
 Wm B Pengra

Chains Township 3rd N Range 26th East

East on a random line bet sec 16 & 21

40.00

Set post for temp gr see corner
^{bear 20° 5' E}

79.90

Intersect N 8 S line 7 2 lks north
of the corner to sec 15. 16 21 & 22

from which corner I run
N 89° 29' W on a true line bet sec 16 & 21

39.95

The point for gr see corner. Groove
chased stake & raised mound
with trenches, as per instructions

79.90

The corner to sec 16. 17. 20 & 21
Soil sandy Sand rolling

North bet sec 16 & 17

40.00

The point for gr see corner. Groove
chased stake, & raised mound, with
trenches, as per instructions

80.00

The point for corner to sec 8. 9. 16 &
17 Groove chased stake, & raised a
mound with trenches, as per
instructions

Soil sandy 3rd rate Sand rolling

140

140A

State of Oregon }
County of Wasco } ss:

The John L.
Luc Key & Benjamin F. Crow having
been appointed axemen in the
service of A. S. Payne, deputy surveyor
of the lands of the United States in
Oregon do solemnly swear that
we will perform the duties of
axemen or flagmen according
to instructions given us and to
the best of our skill and ability.

Subscribed & sworn to }
before me this 12th }
day of August 1861 }

Jno L. Lenokey
B. F. Crow,

W. C. Murray
County Clerk

141

(211)

141

Chains Township 3 N Range 26 East

East on a random line bet sec 9 & 16
Bal 20° 10' E

- 40.00 Set a post for temp gr see corner
- 79.65 Intersect N & S line 38 links North
of the corner to sec 9, 10, 15 & 16
from which corner I run
N 89° 44' W on a true line bet sec 9 & 16
- 39,82 1/2 The point for gr see corner. Iron
chased stake & raised a mound
with trenches, as per instructions
Sand rolling, soil heavy sand

North bet sec 8 & 9

- 40.00 The point for gr see corner. Iron
chased stake & raised a mound with
trenches
as per instructions
- 80.00 The point for corner to sec 8, 9, 4 & 5
Iron chased stake & raised mound
with trenches, as per instructions
Soil heavy sand. Sand rolling

Chains

Field notes of the exterior
 boundary lines of Township No.
 3 North of Range No 31 East
 of the Willamette Meridian
 in the State of Oregon, sur-
 veyed by A. S. Payne, Deputy
 Surveyor, under his Contract
 No. 100, dated August 1st
 1861.

August 20th 1861

Having previously adjusted
 my compass to the course of
 the Guide Meridian by
 actual tracing of the West
 boundary of Township 3
 North Range 31 East.

Began at the South East
 corner of Section 30, T. 3, N. R.
 31 E. - (Var 19° 30' E. run thence
 North on East boundary of

Chains Townships 3 N. Range 26 E

- East on a random line bet sec 4 & 9
 40.00 Set post for temp gr sec corner
 was 20° E
 79.77 In intersect N 4 S line 59 lks North
 of the corner to sec 3, 4, 9 & 10
 from which corner I run
 N $89^{\circ} 35'$ W on a true line bet sec 4 & 9
 39.88 $\frac{1}{2}$ The point for gr sec corner. I set
 charred stake & raised a mound
 with trenches, as per instructions
 79.77 The corner to sec 4, 5, 8 & 9
 Soil sandy 3rd rate. Sand rolling
-
- North on a random line bet sec 4 & 5
 40.00 Set a post for temp gr sec corner
 80.92 In intersect North boundary of township
 40 lks West of the corner to sec 4, 5, 32
 & 33 from which corner I run
 S $0^{\circ} 17'$ W on a true line bet sec 4 & 5
 40.92 The point for gr sec corner, I set
 a charred stake & raised a mound
 with trenches, as per instruction
 80.92 The corner to sec 4, 5, 8 & 9
 Soil heavy sand, producing vegetation

142

2

142A

North East Boundary

Chk

Range 31.

31.40 Road to Nalla Nalla.

N.E. & S.W.

40.00 Set charred stake with mound, trench & pits as per instrs for 1/4 section corner.

80.00 Set charred stake with mound trench and pits as per instrs. for corner to secs 23 & 36, T. 3 N. R 31 E, and secs, 30 & 31 T. 3 N R 32 E, Var. 20° 15' E. Land level, soil first rate.

North on East Boundary section

23 T. 3 N. R 31 E,

40.00 Set charred stake with mound, trench and pits as per instrs. for 1/4 sec. corner.

80.00 Set charred stake with

143

(231)

143

Chains Township 3N Range 26 East

North bet sec's 31432

Pass over edge of irregular hills

40.00 The point for gr see corner, Grove
Charred stake & raised a mound
with trenches, as per instructions

80.00 The point for corner D sec's 29, 30, 31, 43, 2
Grove Charred stake, & raised a mound
with trenches, as per instructions
Soil 3rd rate, Producing good grass

August 2nd 1861

East on a random line bet sec's 29 & 32

at 90° 10' E corner

pass over broken ground

40.00 Set post for temp gr see corner

80.30 Intersect N & S line 22 lks north
of the corner to sec's 28, 29, 32 & 33

from which corner I run
N 89° 51' W Quatric line bet sec's 29 & 32

40.15 The point for gr see corner, Grove
Charred stake & raised a mound with
trenches, as per instructions

80.13 The corner to sec's 31, 32, 29 & 30. Soil sandy

Township 3 N R 31 E

Chains around trench and pits
as per, notes, for corner
to sections 24 & 25, T 3 N
R 31 E, & sections 19 & 20
T 3 N R 32 E, - Var. $19^{\circ}30'E$,
Aris' ground

North on East line Section 24
40.00 Set-Charged Stake with
around trench and pits
as per, notes, for $\frac{1}{4}$
corner,

80.00 Set-Charged Stake with
around trench and pits
as per, notes, for corner
to sections 13 & 24, T 3 N, R
31 E and Secs 18 & 19, T 3 N, R
32 E, - Var $20^{\circ}15'E$, -
Land mostly Lubbock soil 1st class.

North on East line Section 13
T 3 N R 31 E -

(241

144
144

Chains Township 3 N Range 26 East

West on a random line bet sec's 30 & 31

40.00 Set post for temp gr see corner

83.38 Intersect West boundary of Township

52 lks South of the corner to sec's 30 & 31

25 & 36 from which corner I run

S 89° 39' E on a true line bet sec's 30 & 31

43.38 The point for gr see corner. Groove

Charred stake & raised a mound
with trenches, as per instructions

83.38 The corner to sec's 29, 30, 31 & 32

soil Brd rate Sand rolling

North bet sec's 29 & 30

Pass over edge of hills bearing E.

40.00 The point for gr see corner Groove

Charred stake, & raised a mound
with trenches, as per instructions

70.00 Enter Columbia river bottom

80.00 The point for corner to sec's 19, 20, 29

& 30 Groove Charred stake & raised a mound
with trenches, as per instructions
soil 2nd & 3rd rate; producing grass

144

4²

144A

Chains East Boundary

- 40.00 Set-charred Stake with mound trench and pits as per, notes, for $\frac{1}{4}$ sec. corner
- 80.00 Dry Ravine, (N 80° W)
Set-charred Stake with mound trench and pits as per, notes, for corner to sections 12 & 13 R 31, and 7 & 18, R 32, Town 3 North.
Var. 19° 30' E -
Land rolling, soil 2' rate
-

North, on line between sections 12 R 31 E & 7 R 32 E. T 3 N.

- 40.00 Set-charred Stake with mound trench and pits as per, notes, for $\frac{1}{4}$ sec. corner,
- 80.00 Set-charred Stake with mound trench and pits as per, notes, for corner to sections 1 & 12 R 31 & 6 & 7 R 32. - Var 20° E -

145 (251
145

Chains Township 3rd Range 2.6 East

East on a random line bet sec^s 20 & 29
N 20° 15' E

40.00 Set post for temp gr see corner
80.42 Intersect N & S line 48 lks north
of the corner to sec^s 20, 21, 28 & 29
from which corner I run
N 89° 39' W on a true line bet sec^s 20 & 29

40.21 The point for gr see corner, I have
chased stake & raised mound, with
trenches, as per instructions

80.42 The corner to sec^s 19, 20, 29 & 30
Some rolling soil sandy, 3rd rate
West on a random line bet sec^s 19 & 30

40.00 Set post for temp gr see corner
83.24 Intersect West boundary of township
53 lks south of the corner to sec^s 19, 30
24 & 25, from which corner I run
S 89° 38' E on a true line bet sec^s 19 & 30

43.24 The point for gr see corner, I have
a charred stake & raised mound
with trenches, as per instructions

83.24 The corner to sec^s 19, 20, 29 & 30, Soil sandy
Land rolling

Charno Township 3 N R 31 E

North, on line between sections 1
R 31. & 6 R 32 -

40.00 Set-Charged Stake with
mound trench and pits
as per instrs, for $\frac{1}{4}$ sec. corner.

50.50 Bottom of dry Ravine (West)

80.00 Set-Charged Stake with
mound trench and pits
as per instrs, for corner to
Townships 3 & 4 N, Ranges
31 & 32 East, Var $20^{\circ} 31' E$ -

Soil 2^o rate

August 22^o

N. $89^{\circ} 18' N$ on random North line
of Town. 3 N. R 31 E

40.00 Set-Temp. $\frac{1}{4}$ sec. post -

80.00 Set-Temp post for corner
to Secs 1 & 2, T 3 N & Secs
35 & 36 T. 4 N.

North, $89^{\circ} 18' N$ on random North

170

170

Soil generally good, Timber
scarcely - found only along
the Columbia River. But
for grazing purposes
it is unsurpassed &
should therefore be
subdivided

List of Names.

A list of the names of the
individuals employed in
renewing measuring or
marking the lines and
corners described in
the foregoing field notes
of the ~~of~~ Lewis' Bounda-
ry lines of Township
N 3 North Range 31
East, and of township
N 5 North R. 30 East

171

171

of the Willamette Meridian
Showing the respective ca-
pacities in which they
were

John Bratten Chairman
William B. Payne, Chairman
John L. Lueck, Assessor,

We hereby certify that we
assisted Joseph S. Payne
deputy Surveyor in sur-
veying the exterior bound-
ary lines of Township
No 3 North Range 31 East
and of Township No 5
North Range 30 East of
the Willamette Meridian
and that said lines
have been in all respects

172

172

to the best of our knowledge
and belief well and
faithfully surveyed and
the boundary monuments
planted according to the
instructions furnished
by the Surveyor General.

John Brattain, Chairman
W. B. Penner, Chairman
John L. Luekey Assessor

Subscribed and sworn by the
above named persons before me
a Justice of the Peace in & for
the County of Lane State of
Oregon, this 1st day of November
A.D. 1861

R. O. Parsons
Justice Peace

I Dolphus S. Payne, deputy
surveyor do solemnly swear
that, in pursuance of a contract
with B. J. Pungra Surveyor of the
public lands of the United States
in the State of Oregon bearing
date the First day of August
1861, and in strict conformity
to the laws of the United States
and the instructions furnished
by the said Surveyor General, I
have faithfully surveyed the
exterior boundaries of Townships
Numbers three and five north
of the base line of Range Numbers
thirty & thirty one East of the
Millomets Meridian in the State
aforesaid, and do further solemnly
swear that the foregoing are the true
and original field notes of such
survey.

Dolphus S. Payne

174
174

The foregoing affidavit was
subscribed and sworn before me
this 4th day of November A.D. 1861

B. P. Pringle
Surreal General
of Oregon

175
175

Surveyors Office at
C Eugene City Dec 5th 1861

The foregoing field notes of the
Survey of the exterior boundaries
of Townships 3 & 5 North of the
base line of Ranges Nos 30 & 31
East of the Willamette Meri-
dian in the State of Oregon
executed by Dolphus Payne
under his Contract No 100 da-
ted August 1st 1861 having
been critically examined the
necessary corrections & explanations
made the said field notes
and the Surveys they de-
scribe are hereby approved

J. P. Sargent
Surveyor General