

B

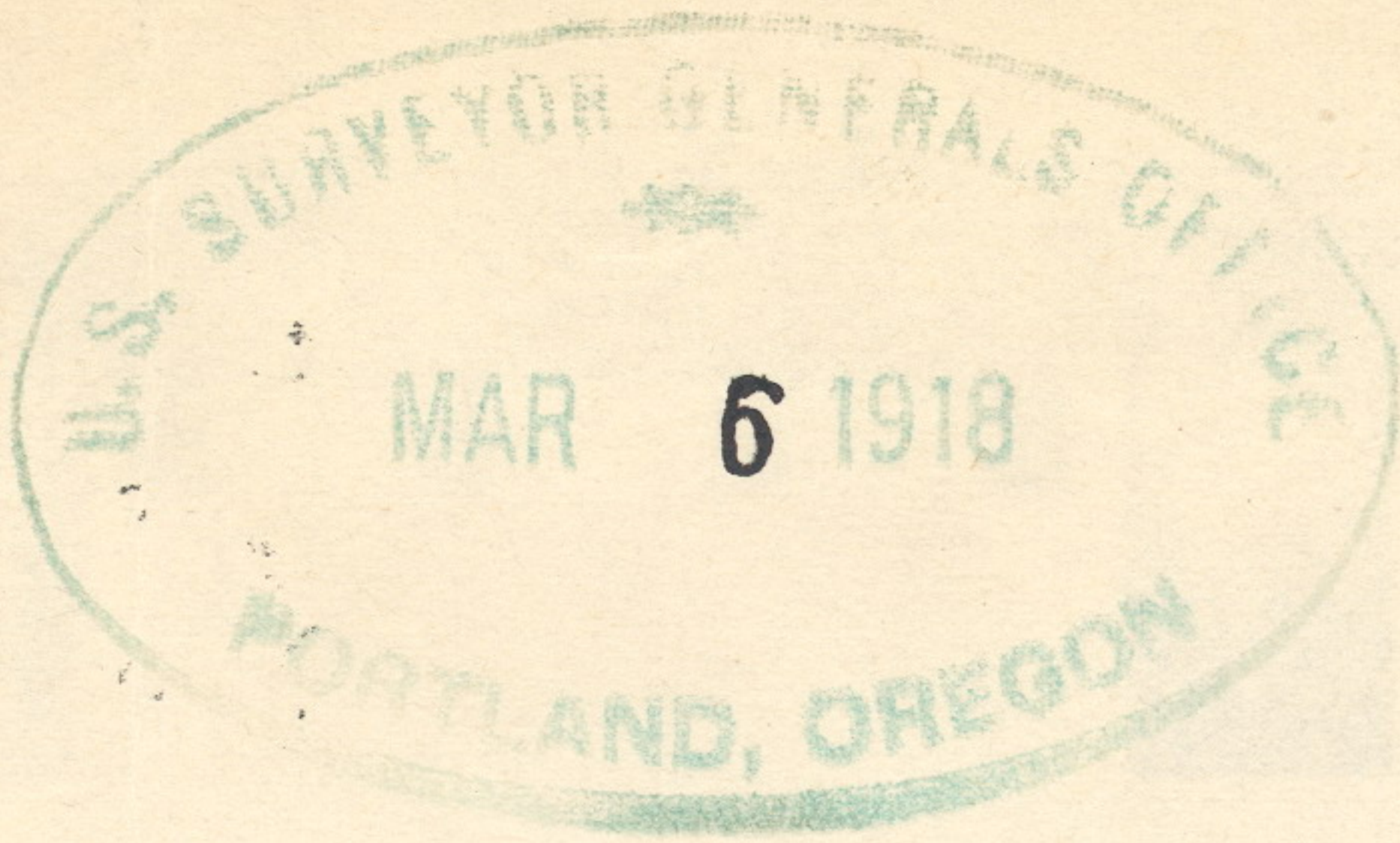

4-679

433

FIELD NOTES

of

RETRACEMENT PORTION EAST BOUNDARY,

RETRACEMENT AND RESURVEY PORTION SOUTH BOUNDARY,

RETRACEMENT PORTION WEST BOUNDARY

and

RETRACEMENT AND SURVEY PORTION SUBDIVISIONAL LINES

in

TOWNSHIP NO. 2 SOUTH, RANGE NO. 34 EAST

Of the Willamette Meridian,

In the State of Oregon

EXECUTED BY

L. E. Wilkes

In the capacity of U. S. Surveyor..., under Special Instructions dated April 18, 191 7
issued by the United States Surveyor General to govern surveys included in Group
No. 38, which were approved by the Commissioner of the General Land
Office, May 10, 191 7, and Assignment Instructions dated Sept. 13, 191 7

Survey commenced October 10, 191 7

Survey completed October 18, 191 7

6-151

ACCEPTED BY THE HON. COMMISSIONER G. L. O. May 2. 1919

FIELD NOTES

INDEX DIAGRAM.

Township 2 South, Range 34 East

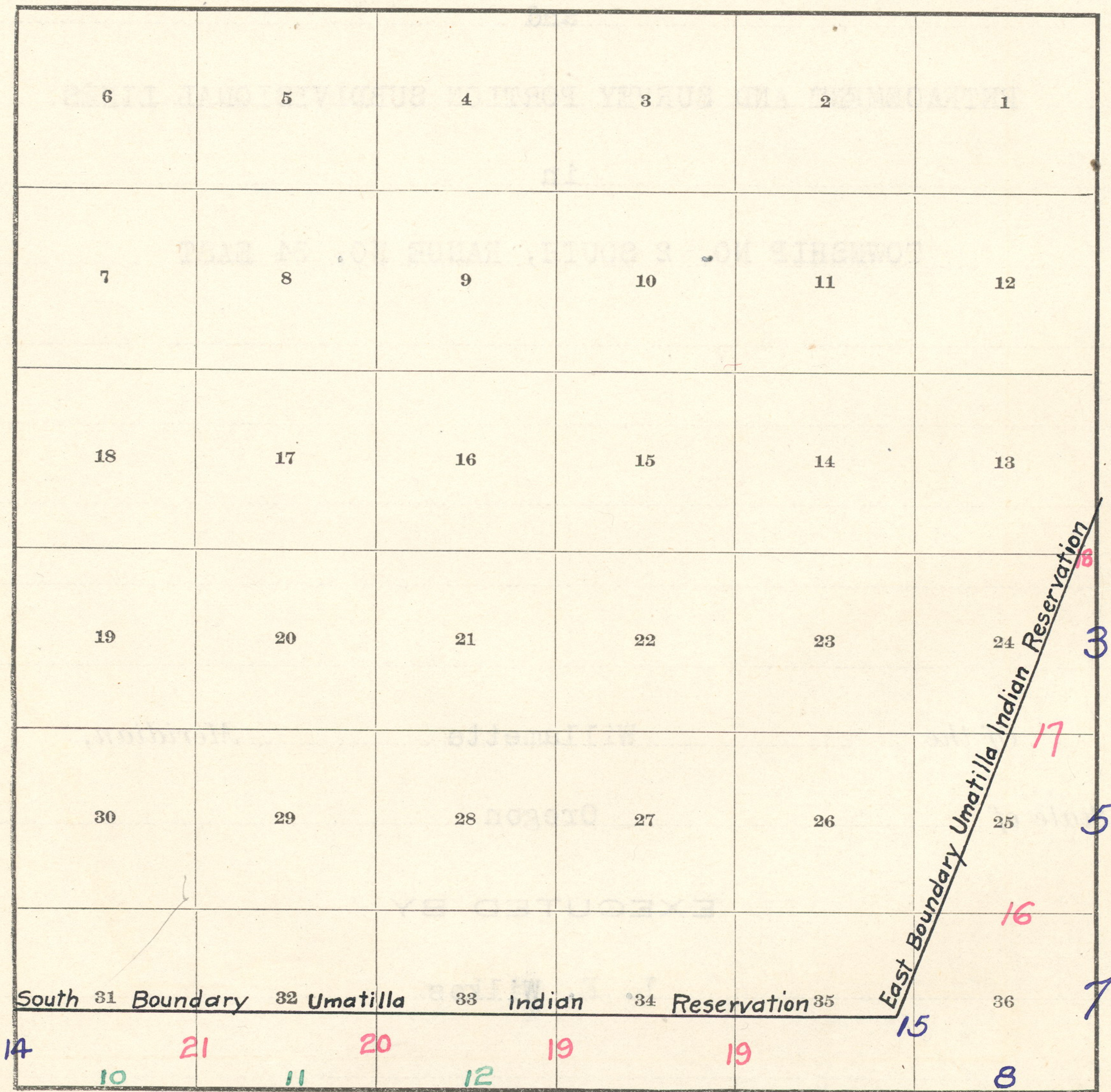

Red indicates original surveys.

Blue indicates retracements.

Green indicates resurveys.

Township No. 2 South, Range No. 34 East

DATE DIAGRAM

Retracements, Resurveys and Surveys for Year 1917

	6	5	4	3	2	1
	7	8	9	10	11	12
	18	17	16	15	14	13
	19	20	21	22	23	24
	30	29	28	27	26	25
	South ³¹ Boundary ³² Umatilla ³³ Indian ³⁴ Reservation ³⁵					36
Oct. 16	Oct. 16	Oct. 18	Oct. 11	Oct. 17	Oct. 12	Oct. 11

East Boundary Umatilla Indian Reservation

Sept. 6, 1917: At 4h 0m a.m., I lay off the corner of
 Solaris 1° 27' to the west and mark the meridian thus de-
 termined on a peg driven in the ground, 5.00 chs. N. of
 my station.

Sept. 6, 1917.

Oct. 9, 1917: At 4h 0m p.m., I set off 48° 24' N. on
 the lat. arc; 6° 17' E. on the decl. arc; and determine
 with the solar meridian, which falls 0° 0' 30" west of
 the meridian determined by Solaris observation, Sept. 6.

Chains

This survey was made simultaneously and in connection with the survey that portion of this township within the original boundaries of the Umatilla Indian Reservation. Survey commenced Oct. 10, 1917 and executed with a Young and Sons light mountain transit No. 8585, with Smith solar attachment. The horizontal limb is provided with two double verniers placed opposite to each other, reading to single minutes of arc, which is also the least count of the verniers of the latitude and declination arcs.

The instrument was examined and approved by the Assistant Supervisor of Surveys for Oregon, May 3, 1917, subject to a satisfactory field test.

I examine the adjustments of the transit and find them correct; then, to test the solar apparatus by comparing its indications resulting from solar observations made during a.m. and p.m. hours with a meridian determined by observations on Polaris, I proceed as follows:

Sept. 5, 1917: At my camp near the $\frac{1}{4}$ cor. of secs. 13 and 14, lat. $45^{\circ}24'N.$, long. $118^{\circ}29'W.$, at 8h 37m p.m., l.m.t., I observe Polaris at eastern elongation in accordance with the Manual of Instructions and mark a point in the line thus determined on a peg driven in the ground, 5.00 chs. N. of my station.

Sept. 5, 1917.

Sept. 6, 1917: At 7h 0m a.m., I lay off the azimuth of Polaris $1^{\circ}37'$ to the west and mark the meridian thus determined on a peg driven in the ground, 5.00 chs. N. of my station.

Sept. 6, 1917.

Oct. 9, 1917: At 4h 0m p.m., l.m.t, I set off $45^{\circ}24'N.$ on the lat. arc; $6^{\circ}17'S.$ on the decl. arc; and determine with the solar a meridian, which falls $0^{\circ}0'30''$ west of the meridian determined by Polaris observation, Sept. 5,

Township No. 2 South, Range No. 34 East

Chains

1917.

Oct. 9, 1917.

Oct. 10, 1917: At 8h 0m a.m., l.m.t., I set off $45^{\circ}24'N$. on the lat. arc; $6^{\circ}33'S$. on the decl. arc; and determine with the solar a meridian, which falls $0^{\circ}0'20''$ west of the meridian determined by Polaris observation, Sept. 5, 1917.

The solar apparatus by p.m. and a.m. observations defines positions for the meridian, which vary less than 1' of arc from the meridian determined by Polaris observation; therefore, I conclude that the adjustments of the instrument are satisfactory.

The instrument was maintained in good adjustment throughout the survey. Latitude and meridian observations were taken daily, weather permitting.

Measurements were made with a 5,00 ch. steel tape, compared with a Chesterman standard 66 ft. steel tape and found correct. All measurements were made on the slope; angles read with an Abney clinometer and all distances reduced to the horizontal, which alone appears in these notes.

Note: Several cors. herein are monumented by stones because more iron posts were required than had been anticipated, and to procure another shipment would have involved the loss of much time and materially increased the cost.

Retracement Portion East Bdy., T. 2 S., R. 34 E.

Commence at the cor. of secs. 13, 18, 19 and 24, on the E. bdy. of the Tp., which is a cross (X) on a volcanic stone in place, 5x3x1 ft. above ground, witnessed as described by the surveyor general.

From this cor. the closing cor. of secs. 13 and 18, on the E. bdy. of the original Umatilla Indian Reservation, bears $N.0^{\circ}11'E.$, 17.08 chs. dist.

Thence

South, retracing bet. secs. 19 and 24.

Over rolling land, through heavy timber and medium under-

438

Retracement Portion East Bdy., T. 2 S., R. 34 E.

Chains

growth, along fence.

40.24 Fall 16 lks. E. of the point for $\frac{1}{4}$ sec. cor., located by reference to the bearing trees as described by the surveyor general. I perpetuate this cor., as follows: at the exact cor. point

Set an iron post, 3 ft. long, 1 in. diam., 12 ins. in the ground to bedrock and 14 ins. in a mound of stone, for $\frac{1}{4}$ sec. cor., with brass cap marked

$\frac{1}{4}$
S24 | S19
1917

from which

A pine, 20 ins. diam., bears N.73°30'E., 83 lks. dist., marked $\frac{1}{4}$ S B T (Old B.T.)

A pine, 20 ins. diam., bears N.81°30'W., 164 lks. dist., marked $\frac{1}{4}$ S B T (Old B.T.)

The true course and distance of this line to the $\frac{1}{4}$ sec. cor. is S.0°14'W., 40.24 chs.

From the $\frac{1}{4}$ sec. cor.

South, continuing my measurements

43.50 Leave rolling land; descend steep S. slope.

Leave fence, course W.

54.20 Dry gulch, 310 ft. below top of ascent, course W.; ascend 50 ft. to

56.70 Top of low ridge, slopes W.; descend 200 ft. to

60.70 Dry gulch, course W.; ascend 100 ft. to

64.05 Top of spur, slopes W.; descend SW. slope, 210 ft. to

79.95 Fall 84 lks. E. of the cor. of secs. 19, 24, 25 and 30, which is an old post set in a mound of stone, marked and witnessed as described by the surveyor general, except that the tree in Sec. 19 is now dead and fallen. I perpetuate this cor., as follows: at the exact cor. point

Set an iron post, 3 ft. long, 2 ins. diam., 24 ins. in the ground, for cor. of secs. 19, 24, 25 and 30, with brass cap marked

T2S
R34E | R35E
S24 | S19
S25 | S30
1917

448

Retracement and Resurvey Portion South Bdy., T. 2 S., R. 34 E.

Chains

- 62.25 Top of spur, slopes N.; descend 75 ft. to
- 65.00 Dry gulch, course NE.; ascend 50 ft. to
- 70.00 Top of spur, slopes N.; descend 112 ft. to
- 80.00 Intersect the old cor. of secs. 3, 4, 33 and 34, which is a basalt stone, 8x8x7 ins. above ground, firmly set, marked and witnessed as described by the surveyor general, with the exception that the SW. bearing tree is now dead. I mark a new tree, as follows: from cor.
 - A tamarack, 8 ins. diam., bears S.37°30'W., 29 lks. dist., marked T 3 S R 34 E S 4 B T.

Land, mountainous and rolling bench.

Soil, light shallow loam, 2nd rate.

Timber, pine and fir.

Undergrowth, balsam, pine and willow.

Retracement Portion West Bdy., T. 2 S., R. 34 E.

From the cor. of Tps. 2 and 3 S., Rs. 33½ and 34 E., previously described

North, retracing bet. secs. 31 and 36.

Over high rolling land, through heavy timber and medium undergrowth.

17.00 Road, bears NE. and SW.

32.50 Intersect the closing cor. on the S. bdy. of the original Umatilla Indian Reservation, which is an iron post, 2 ins. diam., 12 ins. above ground, marked and witnessed as described by the surveyor general.

The true course and distance of this line to the closing cor. is North, 32.50 chs.

Land, mountainous.

Soil, light shallow loam, 2nd rate.

Timber, pine, fir and tamarack.

Undergrowth, pine, fir and tamarack.

This portion of the township lies on the summit of the Blue Mountains. The soil is light volcanic ash, very shallow over basalt and is good for grazing. It is nearly all timbered with scattering yellow pine, fir, tamarack and balsam, not of commercial value. The land is principally valuable for grazing. There are no settlers.

Oct. 18, 1917.

L. E. Wilkes.
U. S. Surveyor

For Final Certificate of U. S. Surveyor, see Book "C"

APPROVAL

Office of U. S. Surveyor General,
Portland, Oregon, August 26, 1918.

The foregoing field notes of the Retracement Portion East Bdy., Retracement and Resurvey Portion South Bdy., Retracement Portion West Bdy. and Retracement and Survey Portion Subdivisional Lines in Township No. 2 South, Range No. 34 East of the Willamette Meridian, Oregon, executed by L. E. Wilkes, U. S. Surveyor, under his special instructions dated April 18, 1917, having been critically examined, and the necessary corrections and explanations made, the said field notes, and the surveys they describe, are hereby approved.

Edward deWitt
U. S. Surveyor General