

FIELD NOTES

of

RETRACEMENT PORTION EAST BOUNDARY,

RETRACEMENT AND RESURVEY PORTION SOUTH BOUNDARY,

RETRACEMENT PORTION WEST BOUNDARY

and

RETRACEMENT AND SURVEY PORTION SUBDIVISIONAL LINES

in

TOWNSHIP NO. 2 SOUTH, RANGE NO. 34 EAST

Of the Willamette Meridian,

In the State of Oregon

EXECUTED BY

L. E. Wilkes

In the capacity of U. S. Surveyor..., under Special Instructions dated April 18, 191 7
issued by the United States Surveyor General to govern surveys included in Group
No. 38, which were approved by the Commissioner of the General Land
Office, May 10, 191 7, and Assignment Instructions dated Sept. 13, 191 7

Survey commenced October 10, 191 7

Survey completed October 18, 191 7

ACCEPTED BY THE HON. COMMISSIONER G. L. O. May 2. 1919

FIELD NOTES

INDEX DIAGRAM.

Township 2 South, Range 34 East

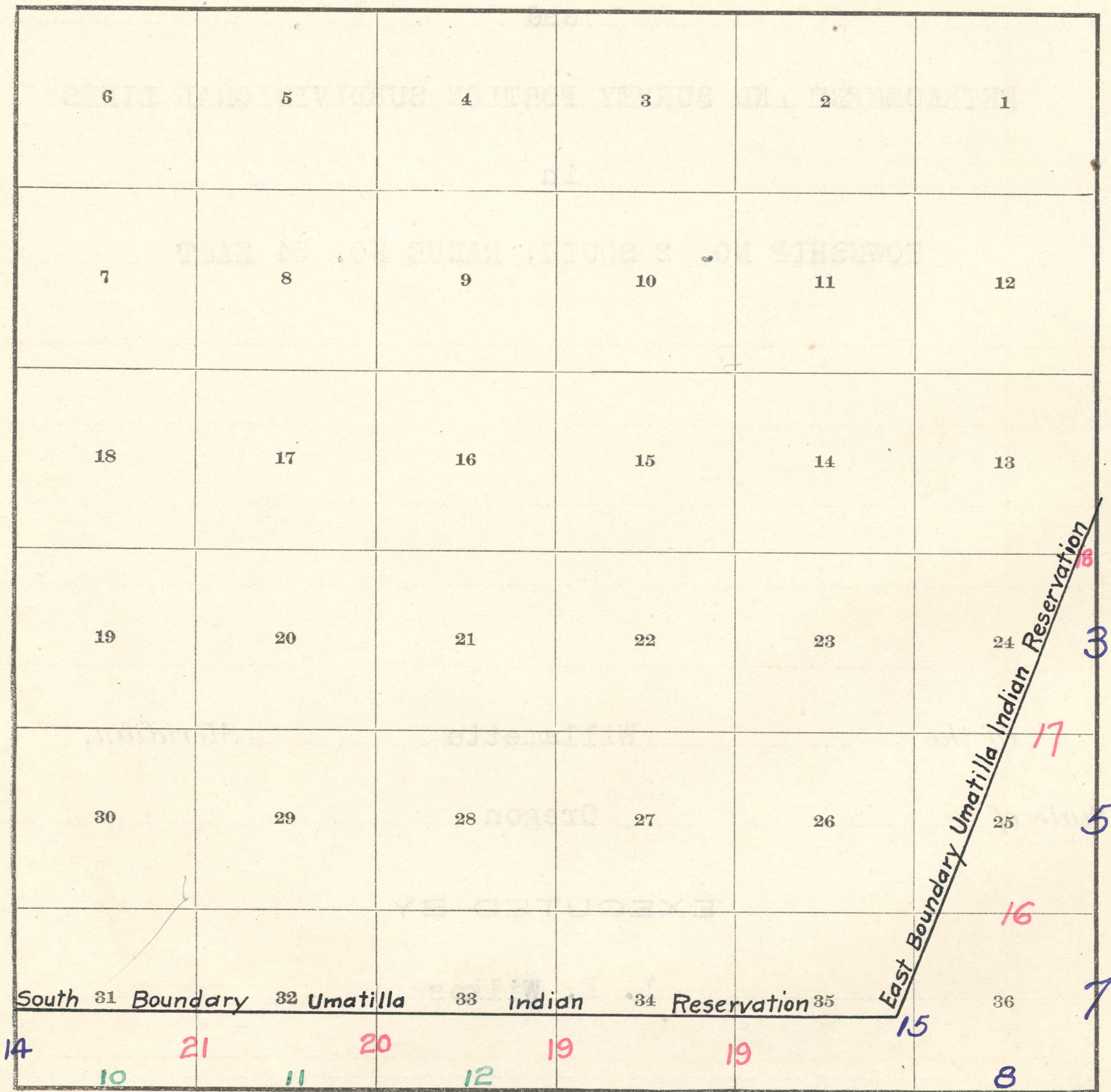

Red indicates original surveys.

Blue indicates retracements.

Green indicates resurveys.

Township No. 2 South, Range No. 34 East

DATE DIAGRAM

Retracements, Resurveys and Surveys for Year 1917

	6	5	4	3	2	1
	7	8	9	10	11	12
	18	17	16	15	14	13
	19	20	21	22	23	24
	30	29	28	27	26	25
	South ³¹ Boundary ³² Umatilla ³³ Indian ³⁴ Reservation ³⁵					36
Oct. 16	Oct. 16	Oct. 18	Oct. 11	Oct. 17	Oct. 12	Oct. 11
	Oct. 18					Oct. 10
						Oct. 10
						Oct. 10
						Oct. 11
						Oct. 11

East Boundary Umatilla Indian Reservation

Chains

This survey was made simultaneously and in connection with the survey that portion of this township within the original boundaries of the Umatilla Indian Reservation. Survey commenced Oct. 10, 1917 and executed with a Young and Sons light mountain transit No. 8585, with Smith solar attachment. The horizontal limb is provided with two double verniers placed opposite to each other, reading to single minutes of arc, which is also the least count of the verniers of the latitude and declination arcs.

The instrument was examined and approved by the Assistant Supervisor of Surveys for Oregon, May 3, 1917, subject to a satisfactory field test.

I examine the adjustments of the transit and find them correct; then, to test the solar apparatus by comparing its indications resulting from solar observations made during a.m. and p.m. hours with a meridian determined by observations on Polaris, I proceed as follows:

Sept. 5, 1917: At my camp near the $\frac{1}{4}$ cor. of secs. 13 and 14, lat. $45^{\circ}24'N.$, long. $118^{\circ}29'W.$, at 8h 37m p.m., l.m.t., I observe Polaris at eastern elongation in accordance with the Manual of Instructions and mark a point in the line thus determined on a peg driven in the ground, 5.00 chs. N. of my station.

Sept. 5, 1917.

Sept. 6, 1917: At 7h 0m a.m., I lay off the azimuth of Polaris $1^{\circ}37'$ to the west and mark the meridian thus determined on a peg driven in the ground, 5.00 chs. N. of my station.

Sept. 6, 1917.

Oct. 9, 1917: At 4h 0m p.m., l.m.t, I set off $45^{\circ}24'N.$ on the lat. arc; $6^{\circ}17'S.$ on the decl. arc; and determine with the solar a meridian, which falls $0^{\circ}0'30''$ west of the meridian determined by Polaris observation, Sept. 5,

Township No. 2 South, Range No. 34 East

Chains

1917.

Oct. 9, 1917.

Oct. 10, 1917: At 8h 0m a.m., l.m.t., I set off $45^{\circ}24'N$. on the lat. arc; $6^{\circ}33'S$. on the decl. arc; and determine with the solar a meridian, which falls $0^{\circ}0'20''$ west of the meridian determined by Polaris observation, Sept. 5, 1917.

The solar apparatus by p.m. and a.m. observations defines positions for the meridian, which vary less than 1' of arc from the meridian determined by Polaris observation; therefore, I conclude that the adjustments of the instrument are satisfactory.

The instrument was maintained in good adjustment throughout the survey. Latitude and meridian observations were taken daily, weather permitting.

Measurements were made with a 5,00 ch. steel tape, compared with a Chesterman standard 66 ft. steel tape and found correct. All measurements were made on the slope; angles read with an Abney clinometer and all distances reduced to the horizontal, which alone appears in these notes.

Note: Several cors. herein are monumented by stones because more iron posts were required than had been anticipated, and to procure another shipment would have involved the loss of much time and materially increased the cost.

Retracement Portion East Bdy., T. 2 S., R. 34 E.

Commence at the cor. of secs. 13, 18, 19 and 24, on the E. bdy. of the Tp., which is a cross (X) on a volcanic stone in place, 5x3x1 ft. above ground, witnessed as described by the surveyor general.

From this cor. the closing cor. of secs. 13 and 18, on the E. bdy. of the original Umatilla Indian Reservation, bears $N.0^{\circ}11'E.$, 17.08 chs. dist.

Thence

South, retracing bet. secs. 19 and 24.

Over rolling land, through heavy timber and medium under-

Retracement Portion Subdivisions, T. 2 S., R. 34 E.

Chains

Commence at the $\frac{1}{4}$ cor. of secs. 35 and 36, which is an old post, marked and witnessed as described by the surveyor general. To further perpetuate this cor. I mark

A fir, 10 ins. diam., bears N.80°E., 2 lks. dist., marked $\frac{1}{4}$ S 35 B T.

and raise a mound of stone, 3 ft. base, 1 ft. high, around post.

Thence

South, retracing bet. secs. 35 and 36.

3.92 Fall 15 lks. E. of the closing cor. of secs. 35 and 36, on the E. bdy. of the original Umatilla Indian Reservation, which is located by reference to the bearing trees as described by the surveyor general. I perpetuate this cor., as follows: at the exact cor. point, which is on the E. edge of the Umatilla Indian Reservation

Set an iron post, 3 ft. long, 2 ins. diam., 24 ins. in the ground, for closing cor. of secs. 35 and 36, with brass cap marked

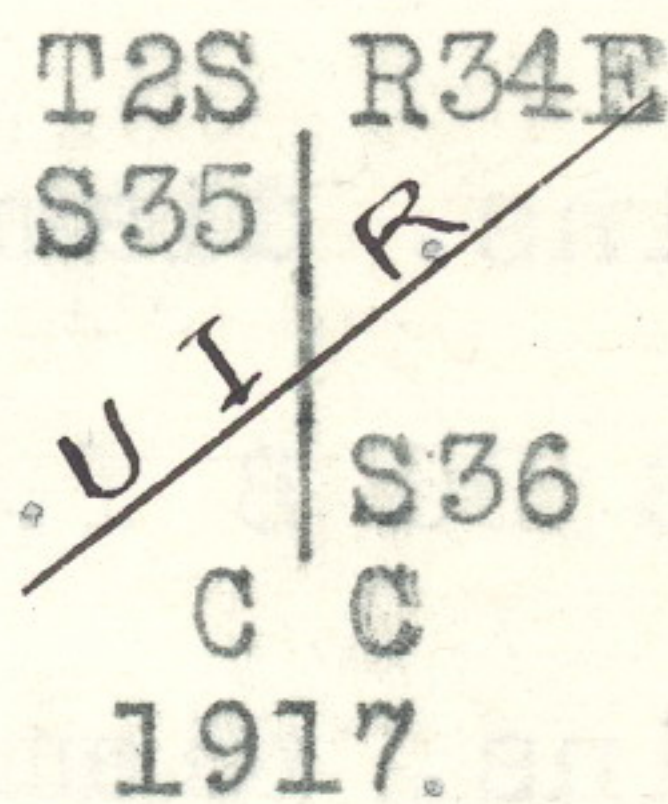

from which

A pine, 22 ins. diam., bears N.24°E., 101 lks. dist.,

marked C C S 36 B T.

A fir, 6 ins. diam., bears S.47°30'W., 23 lks. dist.,

marked C C S 35 B T.

The true course and distance of this line to the closing

cor. is S.2°10'W., 3.92 chs.
 This cor. is 1.20 chs. S.20°25'W. from the 62 $\frac{1}{2}$ Mile Cor. on the U.I.R. Bdy.
 From the closing cor.
 South, continuing my measurements

39.90 Fall 15 lks. W. of the cor. of secs. 1, 2, 35 and 36, previously described.

The true course and distance of this line from the closing cor. is S.0°14'E., 35.98 chs.

450

Retracement Portion Subdivisions, T. 2 S., R. 34 E.

Chains

Land, high rolling bench.
 Soil, shallow light loam on basalt rock, 2nd and 3rd rate.
 Timber, pine and balsam.
 Undergrowth, balsam, serviceberry, pine and willow.

Survey Portion Subdivisions, T. 2 S., R. 34 E.

From the cor. of secs. 25, 30, 31 and 36, on the E. bdy. of the Tp.

West, bet. secs. 25 and 36.

Over high rolling land, through heavy timber and medium undergrowth.

36.00 Enter open glade, bears N. and S.

40.00 Set an iron post, 3 ft. long, 1 in. diam., 12 ins. in the ground and 14 ins. in a mound of stone, for $\frac{1}{4}$ sec. cor., with brass cap marked

$\frac{1}{4}$ S25
 $\frac{1}{4}$ S36
 1917

from which

A pine, 16 ins. diam., bears S.6°45'W., 400 lks. dist., marked $\frac{1}{4}$ S 36 B T.

A pine, 12 ins. diam., bears N.88°45'E., 459 lks. dist., marked $\frac{1}{4}$ S 25 B T.

49.00 Leave bench land, bears NW. and SE.; descend 320 ft. to

63.09 Intersect the E. bdy. of the original Umatilla Indian

Reservation, N.20°20'E. 7.46 chs. from the 62 Mile Cor.

At the point of intersection

Set an iron post, 3 ft. long, 2 ins. diam., 24 ins. in the ground, for closing cor. of secs. 25 and 36, with brass cap marked

T2S R34E
 $\frac{1}{4}$ S25
 $\frac{1}{4}$ S36 CC
 1917

from which

A pine, 12 ins. diam., bears N.54°E., 246 lks. dist., marked C C T 2 S R 34 E S 25 B T.

66-451

Survey Portion Subdivisions, T. 2 S., R. 34 E.

Chains

A fir, 24 ins. diam., bears S.60°E., 29 lks. dist.,
marked C C T 2 S R 34 E S 36 B T.

The closing cor. of that portion of secs. 25 and 36 within
the original Umatilla Indian Reservation, bears S.20°20'W.,
140 lks. dist.

Land, rolling bench and mountainous.

Soil, light scant loam, 3rd rate.

Timber, pine and fir.

Undergrowth, balsam pine and willow.

From the cor. of secs. 19, 24, 25 and 30, on the E. bdy.
of the Tp.

West, bet. secs. 24 and 25.

Ascend NE. slope, through heavy timber and medium under-
growth, 560 ft. to

14.20 Top of ascent; over rolling bench land, bears NW. and SE.

34.36 Intersect the E. bdy. of the original Umatilla Indian
Reservation, N.19°14'E., 13.05 chs. from the 61 Mile Cor.

At the point of intersection

Set an iron post, 3 ft. long, 2 ins. diam., 14 ins. in the
ground and 10 ins. in a mound of stone, for closing cor.
of secs. 24 and 25, with brass cap marked

T2S R34E
S24 CC
S25
1917

from which

A pine, 28 ins. diam., bears N.70°E., 59 lks. dist.,
marked C C T 2 S R 34 E S 24 B T.

A pine, 8 ins. diam., bears S.57°E., 48 lks. dist.,
marked C C T 2 S R 34 E S 25 B T.

The closing cor. of that portion of secs. 24 and 25 within
the original Umatilla Indian Reservation, bears S.19°14'E.,
16 lks. dist.

Land, mountainous and rolling bench.

Soil, light shallow loam, 2nd rate.

Timber, pine and fir.

452

Survey Portion Subdivisions, T. 2 S., R. 34 E.

Chains

Undergrowth, arrowwood, willow, pine and fir.

From the cor. of secs. 13, 18, 19 and 24, on the E. bdy. of the Tp.

West, bet. secs. 13 and 24.

Over rolling land, through timber and undergrowth.

5.94 Intersect the E. bdy. of the original Umatilla Indian Reservation, at the closing cor. of that portion of secs. 13 and 24 within the original Umatilla Reservation, which is an iron post, firmly set, marked and witnessed as described by the surveyor general. I change the markings on the brass cap to read as follows:

T2S R34E
CC S13 S13 CC
S24 S24 CC
1917

and mark new bearing trees as follows:

A fir, 12 ins. diam., bears N.77°E., 59 lks. dist., marked C C T 2 S R 34 E S 13 B T.

A pine, 20 ins. diam., bears S.59°30'W., 54 lks. dist., marked C C T 2 S R 34 E U I R B T.

Land, rolling.

Soil, light scant loam, 2nd rate.

Timber, pine and fir.

Undergrowth, fir, pine and serviceberry.

Commence at the cor. of secs. 2, 3, 34 and 35, on the S. bdy. of the Tp., which is a volcanic stone, 12x8x12 ins. above ground, firmly set, marked with 2 notches on E. and 4 notches on W. edge; from which

A pine, 36 ins. diam., bears N.72°E., 142 lks. dist., marked T 2 S R 34 E S 35 B T.

A pine, 16 ins. diam., bears S.38°E., 161 lks. dist., marked T 3 S R 34 E S 2 B T.

A tamarack, 28 ins. diam., bears S.81°30'W., 85 lks. dist., marked T 3 S R 34 E S 3 B T.

A tamarack, 28 ins. diam., bears N.64°W., 100 lks.

SEP453

Survey Portion Subdivisions, T. 2 S., R. 34 E.

Chains

dist., marked T 2 S R 34 E S 34 B T.

Thence

North, bet. secs. 34 and 35.

Over rolling bench land, through heavy timber.

29.62 Intersect the S. bdy. of the original Umatilla Indian Reservation, N.89°49'W., 4.76 chs. from the 63½ Mile Cor.

At the point of intersection

Set an iron post, 3 ft. long, 2 ins. diam., 12 ins. in the ground and 12 ins. in a mound of stone, for closing cor. of secs. 34 and 35, with brass cap marked

T2S	R34E
UIR	

S34	S35
C C	
1917	

from which

A fir, 24 ins. diam., bears S.9°E., 38 lks. dist., marked C C T 2 S R 34 E S 35 B T.

A fir, 12 ins. diam., bears S.70°W., 72 lks. dist., marked C C T 2 S R 34 E S 34 B T.

From this cor. the old closing cor. of secs. 34 and 35 within the original Umatilla Indian Reservation, bears N.89°49'W., 50 lks. dist.

Land, rolling bench.

Soil, light shallow loam on basalt rock, 2nd rate.

Timber, lodgepole pine, yellow pine, fir and tamarack.

Undergrowth, none.

From the cor. of secs. 3, 4, 33 and 34, on the S. bdy. of the Tp., previously described North, bet. secs. 33 and 34.

Over mountainous land, through heavy timber.

Descend NE. slope, 50 ft. to

2.56 Jennings Creek, 50 lks. wide, course SE.; the creek is practically dry at the present time; ascend 350 ft. to

29.66 Intersect the S. bdy. of the original Umatilla Indian Reservation, N.89°27'W., 4.04 chs. from the 64½ Mile Cor.

Survey Portion Subdivisions, T. 2 S., R. 34 E.

Chains

At the point of intersection

Set an iron post, 3 ft. long, 2 ins. diam., 12 ins. in the ground and 12 ins. in a mound of stone, for closing cor. of secs. 33 and 34, with brass cap marked

T2S R34E
UIR
S33 | S34
C C
1917

from which

A pine, 6 ins. diam., bears S.62°45'E., 167 lks. dist., marked C C T 2 S R 34 E S 34 B T.

A pine, 8 ins. diam., bears S.56°30'W., 234 lks. dist., marked C C T 2 S R 34 E S 33 B T.

The closing cor. of that portion of secs. 33 and 34 within the original Umatilla Indian Reservation, bears N.89°27'W., 110 lks. dist.

Land, mountainous.

Soil, light shallow loam, 3rd rate.

Timber, yellow and lodgepole pine.

Undergrowth, none.

From the cor. of secs. 32 and 33, on the S. bdy. of the Tp., previously described North, bet. secs. 32 and 33.

Over bench, through heavy timber and medium undergrowth.

31.20 Intersect the old closing cor. of secs. 32 and 33, which is a tamarack tree, 8 ins. diam., marked and witnessed as described by the surveyor general.

31.29 Intersect the S. bdy. of the original Umatilla Indian Reservation at the new closing cor. of that portion of secs. 32 and 33 within the original reservation, which is a 2 in. iron post, firmly set in the ground, marked and witnessed as described by the surveyor general. I change the markings on the brass cap to read

C C
T2S R34E
UIR
S32 | S33
S32 | S33
C C
1917

Survey Portion Subdivisions, T. 2 S., R. 34 E.

Chains

Land, high rolling bench.
 Soil, shallow light loam, 2nd and 3rd rate.
 Timber, yellow pine, tamarack and lodgepole pine.
 Undergrowth, balsam, honey laurel, willow and lodgepole
 pine.

From the cor. of secs. 31 and 32, on the S. bdy. of the
 Tp., previously described

North, bet. secs. 31 and 32.
 Over high rolling land, through heavy timber and medium
 undergrowth.

32:67 Intersect the S. bdy. of the original Umatilla Indian
 Reservation, N.89°55'W., 4.32 chs. from the 66½ Mile Cor.

The soil at the point of intersection is so shallow that
 it is impracticable to set an iron post; therefore, at a
 point 25 lks. S. of true cor.

Set an iron post, 3 ft. long, 2 ins. diam., 12 ins. in the
 ground and 12 ins. in a mound of stone, for witness cor.
 to the closing cor. of secs. 31 and 32, with brass cap
 marked

W C
 T2S R34E
 UIR
 S31 | S32
 C C
 1917

From point for true closing cor. of secs. 31 and 32:

A fir, 8 ins. diam., bears S.45°30'E., 51 lks. dist.,
 marked C C T 2 S R 34 E S 32 B T.

A fir, 24 ins. diam., bears S.25°45'W., 119 lks. dist.,
 marked C C T 2 S R 34 E S 31 B T.

The closing cor. of that portion of secs. 31 and 32 within
 the original Umatilla Indian Reservation, bears N.89°55'W.,
 182 lks. dist.

Land, high rolling bench.
 Soil, light shallow loam, 3rd rate.
 Timber, yellow pine, lodgepole pine, balsam and fir.
 Undergrowth, willow, balsam and lodgepole pine.

456

Boundaries of T. 2 S., R. 34 E.
 Latitudes, departures and closing errors

Line designated	True bearing.	Dist. Chs.	Latitudes		Departures		
			N. Chs.	S. Chs.	E. Chs.	W. Chs.	
<u>E.Bdy.T2SR34E</u>							
E.bdy.sec.13	S.0°11'W.	17.08		17.08		.05	
E.bdy.sec.24	(S.0°14'W.	40.24		40.24		.16	
	(S.1°13'W.	39.75		39.75		.84	
E.bdy.sec.25	(S.0°05'E.	40.25		40.25		.06	
	(South	40.25		40.25			
E.bdy.sec.36	South	80.47		80.47			
<u>N.bdy.T3SR34E</u>							
N.bdy.sec.1	(S.89°43'W.	40.08		.20		40.08	
	(S.89°17'W.	40.01		.50		40.01	
N.bdy.sec.2	N.89°55'W.	80.00	.12			80.00	
N.bdy.sec.3	N.89°55'W.	80.00	.12			80.00	
N.bdy.sec.4	(S.89°43'W.	39.30		.20		39.30	
	(S.88°26'W.	39.95		1.09		39.95	
N.bdy.sec.5	(S.89°43'W.	39.54		.20		39.54	
	(S.88°52'W.	39.51		.78		39.50	
N.bdy.sec.6	(S.89°56'W.	40.10		.05		40.10	
	(N.89°57'W.	43.06	.04			43.06	
<u>W.bdy.T2SR34E</u>							
W.bdy.sec.31	North	32.50	32.50				
<u>Bdy.original Umatilla Indian Reservation</u>							
68th Mile	(N.89°25'E.	5.03	.05			5.03	
	(N.89°47'E.	40.37	.15			40.37	
67th Mile	(S.89°55'E.	40.27		.06		40.27	
	(S.89°52'E.	39.99		.09		39.99	
66th Mile	(S.89°34'E.	39.59		.30		39.59	
	(N.89°52'E.	39.86	.09			39.86	
65th Mile	(S.89°27'E.	40.01		.38		40.01	
	(N.89°51'E.	40.36	.10			40.36	
64th Mile	(S.89°49'E.	40.13		.13		40.13	
	(S.89°56'E.	40.26		.05		40.26	
63rd Mile	(N.89°42'E.	32.30	.17			32.30	
	(N.20°25'E.	8.05	7.54			2.81	
	(N.20°08'E.	39.81	37.38			13.70	
62nd Mile	(N.20°20'E.	39.86	37.38			13.85	
	(N.19°34'E.	40.19	37.87			13.46	
61st Mile	(N.19°14'E.	39.38	37.18			12.97	
	(N.20°45'E.	39.74	37.16			14.08	
60th Mile	N.19°31'E.	37.11	34.98			12.40	
Convergency.....						.07	
Totals.....			262.83	262.07	481.57	482.59	
			262.07			481.57	
Error in Lat.....			0.76	Error in Dep..		1.02	

This portion of the township lies on the summit of the Blue Mountains. The soil is light volcanic ash, very shallow over basalt and is good for grazing. It is nearly all timbered with scattering yellow pine, fir, tamarack and balsam, not of commercial value. The land is principally valuable for grazing. There are no settlers.

Oct. 18, 1917.

L. E. Wilkes.
U. S. Surveyor

For Final Certificate of U. S. Surveyor, see Book "C"

APPROVAL

Office of U. S. Surveyor General,
Portland, Oregon, August 26, 1918.

The foregoing field notes of the Retracement Portion East Bdy., Retracement and Resurvey Portion South Bdy., Retracement Portion West Bdy. and Retracement and Survey Portion Subdivisional Lines in Township No. 2 South, Range No. 34 East of the Willamette Meridian, Oregon, executed by L. E. Wilkes, U. S. Surveyor, under his special instructions dated April 18, 1917, having been critically examined, and the necessary corrections and explanations made, the said field notes, and the surveys they describe, are hereby approved.

Edward J. Wells
U. S. Surveyor General