



4-679

FIELD NOTES

of

RESURVEY OF THE ORIGINAL UMATILLA INDIAN RESERVATION

BOUNDARY FROM THE 56½ MILE COR. TO THE SW. COR. THEREOF;

also

RESURVEY PORTION OF NORTH AND EAST BOUNDARIES AND

RETRACEMENT, RESURVEY AND SURVEY OF SUBDIVISIONAL LINES

in

TOWNSHIP NO. 2 SOUTH, RANGE NO. 34 EAST

Of the Willamette Meridian,

In the State of Oregon

EXECUTED BY

L. E. Wilkes.

In the capacity of U. S. Surveyor, under Special Instructions dated Feb. 20, 1917, issued by the United States Surveyor General to govern surveys included in Group No. 29, which were approved by the Commissioner of the General Land Office, Apr. 11, 1917, and Assignment Instructions dated May 3, 1917

Survey commenced September 5, 1917

Survey completed October 31, 1917

ACCEPTED BY THE HON. COMMISSIONER G. L. O. May 10, 1919

INDEX DIAGRAM.

Township 2 South, Range 34 East

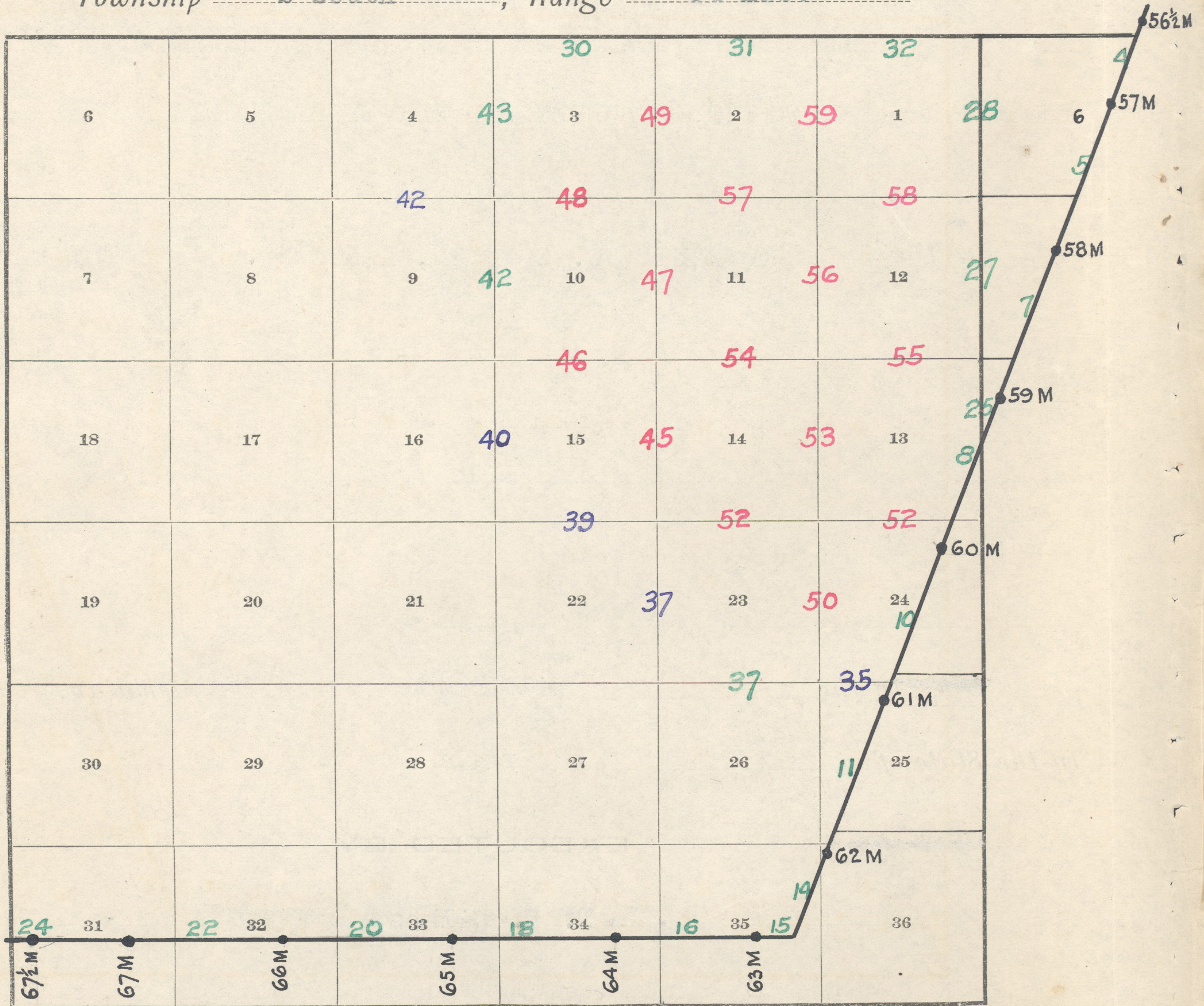

Red indicates original surveys.

Blue indicates retracements

Green indicates resurveys

Township No. 2 South, Range No. 34 East

DATE DIAGRAM

Retracements, Resurveys and Surveys for Year 1917

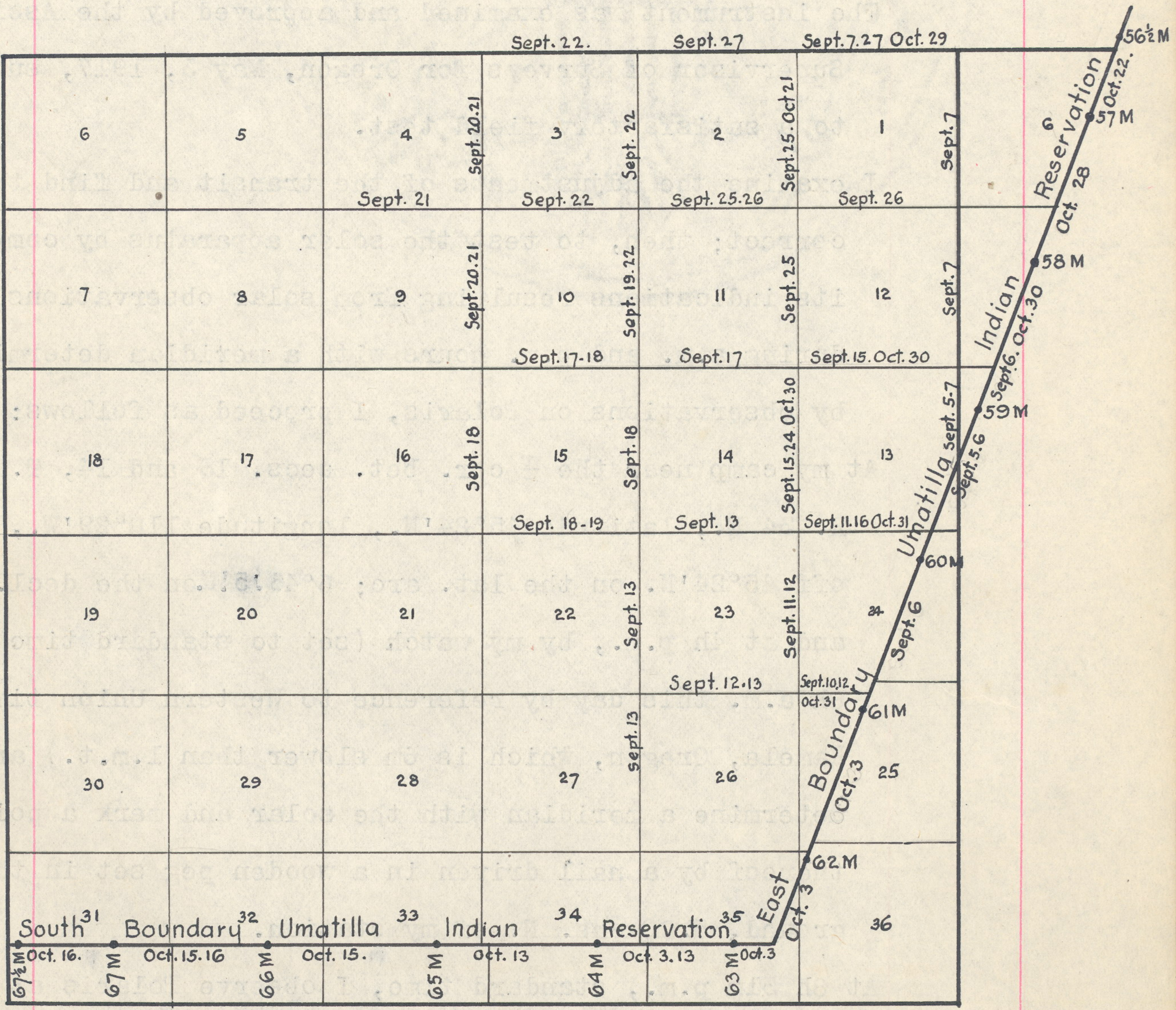

790

Resurvey Portion East Bdy., T. 2 S., R. 34 E.

Chains

A pine, 30 ins. diam., bears N.34°W., 69 lks. dist.,
marked T 2 S R 34 E S 1 B T.

The old cor. of secs. 1, 6, 7 and 12 bears North, 32 lks.
dist., which I destroy.

Land, rolling, bench and mountainous.

Soil, light loam on basalt bedrock, 2nd rate.

Timber, pine, tamarack and fir.

Undergrowth, pine, fir and willow.

North, resurveying the line bet. secs. 1 and 6.

Ascend gradually through scattering timber.

40.00 Set an iron post, 3 ft. long, 1 in. diam., 26 ins. in the
ground, for $\frac{1}{4}$ sec. cor., with brass cap marked

$\frac{1}{4}$
S1 | S6
1917

from which

A fir, 16 ins. diam., bears N.80°E., 6 lks. dist.,
marked $\frac{1}{4}$ S 6 B T.

A fir, 16 ins. diam., bears S.7°30'W., 43 lks. dist.,
marked $\frac{1}{4}$ S 1 B T.

The old $\frac{1}{4}$ sec. cor. bears N.39°45'E., 85 lks. dist., which
I destroy.

41.00 Leave timber; enter glade, bears NW. and SE.

50.00 Top of ascent, bears NW. and SE.; descend. 460 ft. through
scattering timber and dense undergrowth.

76.32 Ravine, course NE.; ascend SE. slope.

80.82 Intersect the point for cor. of Tps. 1 and 2 S., Rs. 34
and 35 E., as determined by reference to the NE. bearing
tree.

This point is on a steep E. slope, where it is impracticable
to set an iron post more than 6 ins. in the ground;
therefore, at a point 30 lks. W. of true cor. point

Set an iron post, 3 ft. long, 3 ins. diam., 24 ins. in
the ground, for witness cor. to the cor. of Tps. 1 and
2 S., Rs. 34 and 35 E., with brass cap marked

Resurvey Portion East Bdy., T. 2 S., R. 34 E.

Chains

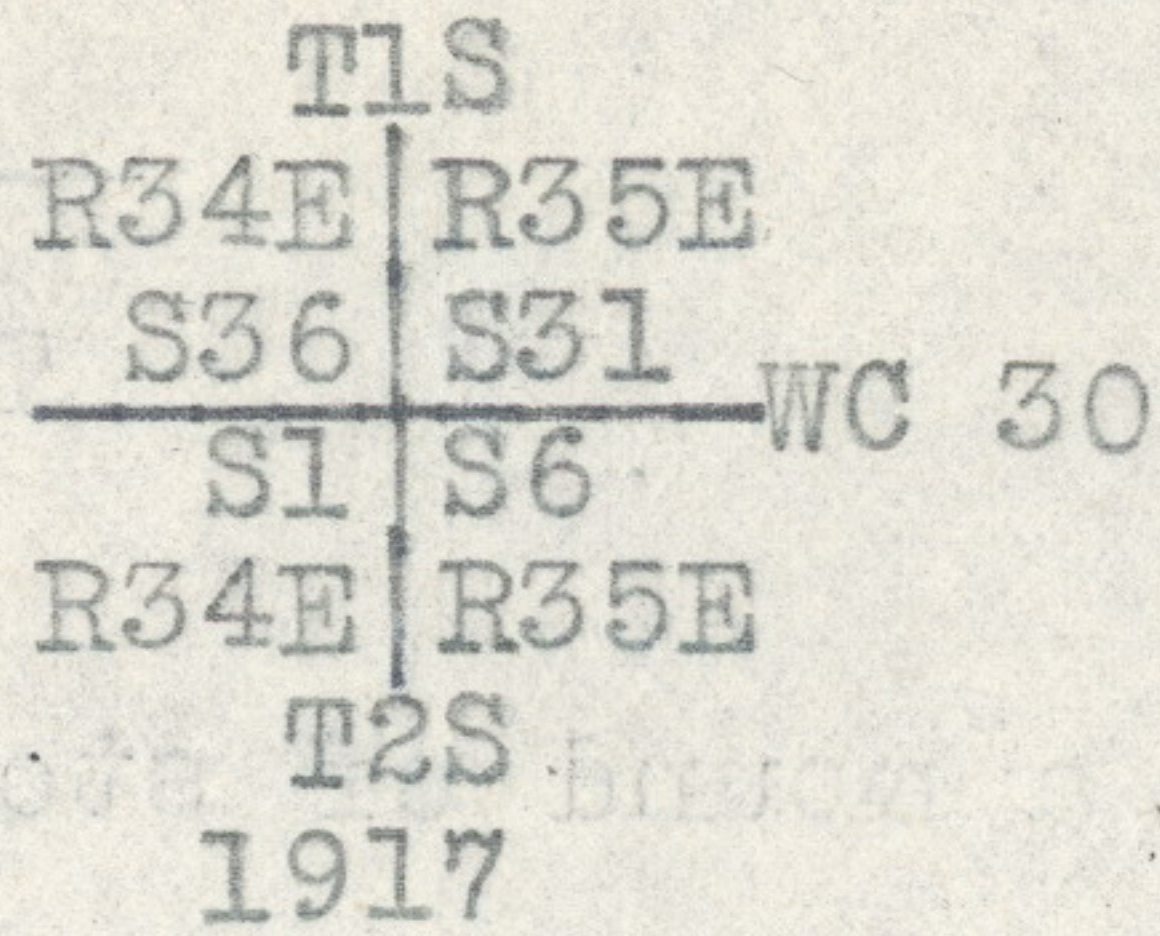

and raise a mound of stone, 2 ft. base, 1½ ft. high, S. of post.

From the true cor. point

A pine, 12 ins. diam., bears N.26°E., 112 lks. dist., marked T 1 S R 35 E S 31 B T (Old B.T.)

A fir, 12 ins. diam., bears S.17°45'W., 352 lks. dist., marked T 2 S R 34 E S 1 B T (New B.T.)

Land, mountainous, bench and rolling.

Soil, light shallow loam, on basalt bedrock, 2nd rate.

Timber, yellow pine, balsam, fir and tamarack.

Undergrowth, balsam, lodgepole pine and willow.

Resurvey Portion North Bdy., T. 2 S., R. 34 E.

Retracements

From the cor. of Tps. 1 and 2 S., Rs. 34 and 35 E., West retracing the line bet. secs. 1 and 36; at 42.28 chs. fall 495 lks. N. of the ¼ sec. cor., and at 80.27 chs. fall 112 lks. N. of the cor. of secs. 1, 2, 35 and 36.

West, retracing line bet. secs. 2 and 35; at 40.20 chs. fall 29 lks. N. of the ¼ sec. cor., and at 79.94 chs. fall 91 lks. N. of the cor. of secs. 2, 3, 34 and 35.

West, retracing the line bet. secs. 3 and 34; at 40.00 chs. find no trace of the ¼ sec. cor., and at 77.77 chs. fall 167 lks. N. of the cor. of secs. 3, 4, 33 and 34.

S.89°25'W., retracing the S. bdy. of sec. 33, T. 1 S., R. 34 E., and at 3.91 chs. fall 4 lks. S. of the closing cor. of secs. 3 and 4, T. 2 S., R. 34 E.

The closing cor. of secs. 3 and 4 is a basalt stone, 15x8x10 ins. above ground, firmly set, marked x on top, with 6 notches on S. face, witnessed as described by the surveyor general.

At a point 4 lks. S. of the old closing cor.

Set an iron post, 3 ft. long, 2 ins. diam., 24 ins. in the ground, for closing cor. of secs. 3 and 4, with brass cap marked

792

Resurvey Portion North Bdy., T. 2 S., E. 34 E.

Chains

T1S	
S4	S3
T2S	R34E
CC	
1917	

and raise a mound of stone, 2 ft. base, 1½ ft. high, S. of cor.

Thence

N.89°25'E., resurveying the N. bdy. of sec. 3.

Ascend 66 ft. over mountainous land to

3.91 Intersect the old cor. of secs. 33 and 34, which is a basalt stone, firmly set, marked as described by the surveyor general.

At a point 1 lk. N. of true cor.

Set a basalt stone, 15x10x8 ins., 10 ins. in the ground, for witness cor. to the cor. of secs. 33 and 34, marked with 3 notches on E. and W. edges, 33 on NW., 34 on NE. and W C on S. face; and raise a mound of stone, 4 ft. base, 2½ ft. high, N. of cor.

This cor. is on top of high ridge, bears N.20°E. and S.20°W.

Thence

N.88°46'E., continuing my measurements

Descend 950 ft. over broken E. slope, through scattering timber.

40.01 (40.00 chs. departure)

Set an iron post, 3 ft. long, 1 in. diam., 26 ins. in the ground, for ¼ cor. of sec. 3 only, with brass cap marked

¼S3
1917

from which

A fir, 9 ins. diam., bears S.32°E., 303 lks. dist., marked ¼ S 3 B T.

42.74 A pine, 30 ins. diam., on line, marked with 2 notches on E. and W. sides.

42.80½ Apportioned distance

Set a red lava stone, 16x8x6 ins., 11 ins. in the ground, for ¼ cor. of sec. 34 only, marked ¼ S 34 on N. face;

Resurvey Portion North Bdy., T. 2 S., R. 34 E.

Chains,

from which
A fir, 28 ins. diam., bears N.20°E., 59 lks. dist.,
marked $\frac{1}{4}$ S 34 B T.

44.00 Johnson Creek, 25 links. wide, course N.; thence over
bottom land.

45.60 Leave bottom, bears N. and S.; ascend 1050 ft. to

79.00 Top of ridge, bears N.30°W. and S.45°E.

80.02 (80.00 chs. departure)

Set an iron post, 3 ft. long, 2 ins. diam., 24 ins. in the
ground, for cor. of secs. 2 and 3, with brass cap marked

T1S	
S3	S2
T2S	R34E
1917	

from which

A pine, 24 ins. diam., bears S.80°E., 74 lks. dist.,
marked T 2 S R 34 E S 2 B T.

No other tree available; raise a mound of stone, 2
ft. base, $1\frac{1}{2}$ ft. high, S. of cor.

Land, mountainous.

Soil, rocky, 3rd rate.

Timber, scattering pine.

Undergrowth, small pine.

N.88°46'E., resurveying the N. bdy. of sec. 2.

Over mountainous land, through scattering timber.

1.68 Intersect the old cor. of secs. 2, 3, 34 and 35, which is
a basalt stone, firmly set, marked and witnessed as de-
scribed by the surveyor general. I change this cor. to
refer to secs. 34 and 35 only; from which

A pine, 24 ins. diam., bears N.42°30'E., 224 lks.
dist., marked T 1 S R 34 E S 35 B T (New B.T.)

A pine, 24 ins. diam., bears N.30°W., 263 lks. dist.,
marked T 1 S R 34 E S 34 B T (New B.T.)

Thence

S.89°07'E., continuing my measurements

Descend steep broken NE. slope, 1000 ft. to

794

Resurvey Portion North Bdy., T. 2 S., R. 34 E.

Chains

26.40 Little Johnson Creek, 5 lks. wide, course NW.; ascend 500 ft. to 1/4 cor.

31.70 Leave timber, bears NW. and SE.

40.00 Set an iron post, 3 ft. long, 1 in. diam., 26 ins. in the ground, for 1/4 cor. of sec. 2 only, with brass cap marked

1/4 S2
1917

and raise a mound of stone, 2 ft. base, 1 1/2 ft. high, S. of cor.

Ascend 42 ft. to

41.42 Intersect the old 1/4 sec. cor., as identified by an old mound of stone; at center of this mound

Set a basalt stone, 20x8x5 ins., 15 ins. in the ground, for 1/4 cor. of sec. 35 only, marked 1/4 S 35 on N. face; and raise a mound of stone, 3 ft. base, 2 ft. high, N. of cor.

Thence

N.89°35'E., continuing my measurements

Ascend 60 ft. to

45.20 Top of spur, slopes SW.; along steep S. slope.

55.70 Dry gulch, course SW.; ascend 775 ft. to

80.00 Set an iron post, 3 ft. long, 2 ins. diam., 24 ins. in the ground, for cor. of secs. 1 and 2, with brass cap marked

T1SR34E
S35
S2 | S1
T2S | R34E
1917

and raise a mound of stone, 4 ft. base, 2 ft. high, S. of cor.

Land, mountainous.

Soil, rocky, 3rd rate.

Timber, fir and pine.

Undergrowth, fir, ninebark and willow.

N.89°35'E., resurveying the N. bdy. of sec. 1.

Over mountainous land; ascend 25 ft. to

Resurvey Portion North Bdy., T. 2 S., R. 34 E.

Chains

1.62 Intersect the point for cor. of secs. 1, 2, 35 and 36, in a crib of rock, 4x4x4 ft., built as an anchor for fences extending N., E. and NW. This cor. point was pointed out by L. S. Kidd, who claims to have known its location ever since the original survey was made.

At a point 6 lks. N. of the cor., thus determined,

Set an iron post, 3 ft. long, 2 ins. diam., 24 ins. in the ground, for witness cor. to the cor. of secs. 35 and 36, with brass cap marked

T1S | R34E
S35 | S36

T2SR34E
WC
1917

A crib of rock, 4x4x4 ft., bears South of post, 6 ft. dist.

Thence

S.84°15'E., continuing my measurements

Along fence.

11.60 Top of ridge, bears NW. and SE.; descend 310 ft. to

22.90 Dry gulch, course NW.; ascend 200 ft. to

39.80 Intersect the old 1/4 sec. cor., which is a basalt stone, 10x8x7 ins., set in a small mound of stone, marked 1/4 on N. face.

At a point 1 lk. N. of the cor.

Set an iron post, 3 ft. long, 1 in. diam., 26 ins. in the ground, for witness cor. to the 1/4 cor. of sec. 36 only, with brass cap marked

1/4 S36

WC
1917

From true cor.

A pine, 48 ins. diam., bears N.8°15'E., 173 lks. dist., marked 1/4 S 36 B T.

Thence

N.83°19'E., continuing my measurements

40.19 (40.00 chs. departure)

Set an iron post, 3 ft. long, 1 in. diam., 26 ins. in the

796

Resurvey Portion North Bdy., T. 2 S., R. 34 E.

Chains

ground, for 1/4 cor. of sec. 1 only, with brass cap marked

1/4 S1
1917

from which

A pine, 10 ins. diam., bears N.88°30'E., 221 lks.

dist., marked 1/4 S 1 B T.

Enter scattering timber and undergrowth, bears NW. and SE.

52.35 Top of ridge, bears NW. and SE.; descend.

73.60 Draw, course S.60°E.

76.60 Descend steep E. slope, 170 ft. to

82.37 True point for cor. of Tps. 1 and 2 S., Rs. 34 and 35 E.

Land, mountainous.

Soil, shallow light loam, 2nd rate.

Timber, pine and fir.

Undergrowth, pine and willow.

Retracement-Resurvey of Subdivisional Lines, T. 2 S., R. 34 E.

I commence at the cor. of secs. 23, 24, 25 and 26, the position of which is determined by reference to the original bearing trees. At the exact cor. point

Set an iron post, 3 ft. long, 2 ins. diam., 24 ins. in the ground, for cor. of secs. 23, 24, 25 and 26, with brass cap marked

T2S | R34E
S23 | S24
S26 | S25
1917

from which

A pine, 24 ins. diam., bears N.20°W., 117 lks. dist.,

marked in the bark, marks illegible. I remark it

T 2 S R 34 E S 23 B T (Old B.T.)

A pine, 8 ins. diam., bears S.47°W., 133 lks. dist.,

blazes healed over, not opened (Old B.T.)

A fir stump, 24 ins. diam., bears N.83°E., 234 lks.

dist., marked in the bark, illegible (Old B.T.)

A fir, 30 ins. diam., bears N.42°E., 183 lks. dist.,

marked T 2 S R 34 E S 24 B T (New B.T.)

For Final Certificate of U. S. Surveyor, see Book "E"

Approval

Office of U. S. Surveyor General,
Portland, Oregon, August 26, 1918

The foregoing field notes of the Resurvey of the Original Umatilla Indian Reservation Boundary from the 56½ Mile Cor. to the SW. Cor. thereof; Resurvey Portion of N. and E. Bdrs. and Retracement, Resurvey and Survey of Subdivisional Lines in Township No. 2 South, Range No. 34 East of the Willamette Meridian, Oregon, executed by L. E. Wilkes, U. S. Surveyor, under his special instructions dated February 20, 1917, having been critically examined, and the necessary corrections and explanations made, the said field notes, and the surveys they describe, are hereby approved.

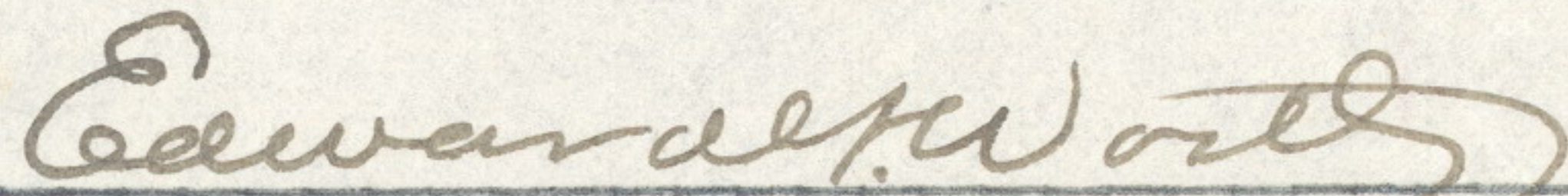
U. S. Surveyor General

