



4-679

FIELD NOTES

of

RESURVEY OF THE ORIGINAL UMATILLA INDIAN RESERVATION

BOUNDARY FROM THE 56½ MILE COR. TO THE SW. COR. THEREOF;

also

RESURVEY PORTION OF NORTH AND EAST BOUNDARIES AND

RETRACEMENT, RESURVEY AND SURVEY OF SUBDIVISIONAL LINES

in

TOWNSHIP NO. 2 SOUTH, RANGE NO. 34 EAST

Of the Willamette Meridian,

In the State of Oregon

EXECUTED BY

L. E. Wilkes.

In the capacity of U. S. Surveyor, under Special Instructions dated Feb. 20, 1917, issued by the United States Surveyor General to govern surveys included in Group No. 29, which were approved by the Commissioner of the General Land Office, Apr. 11, 1917, and Assignment Instructions dated May 3, 1917

Survey commenced September 5, 1917

Survey completed October 31, 1917

ACCEPTED BY THE HON. COMMISSIONER G. L. O. May 10, 1919

INDEX DIAGRAM.

Township 2 South, Range 34 East

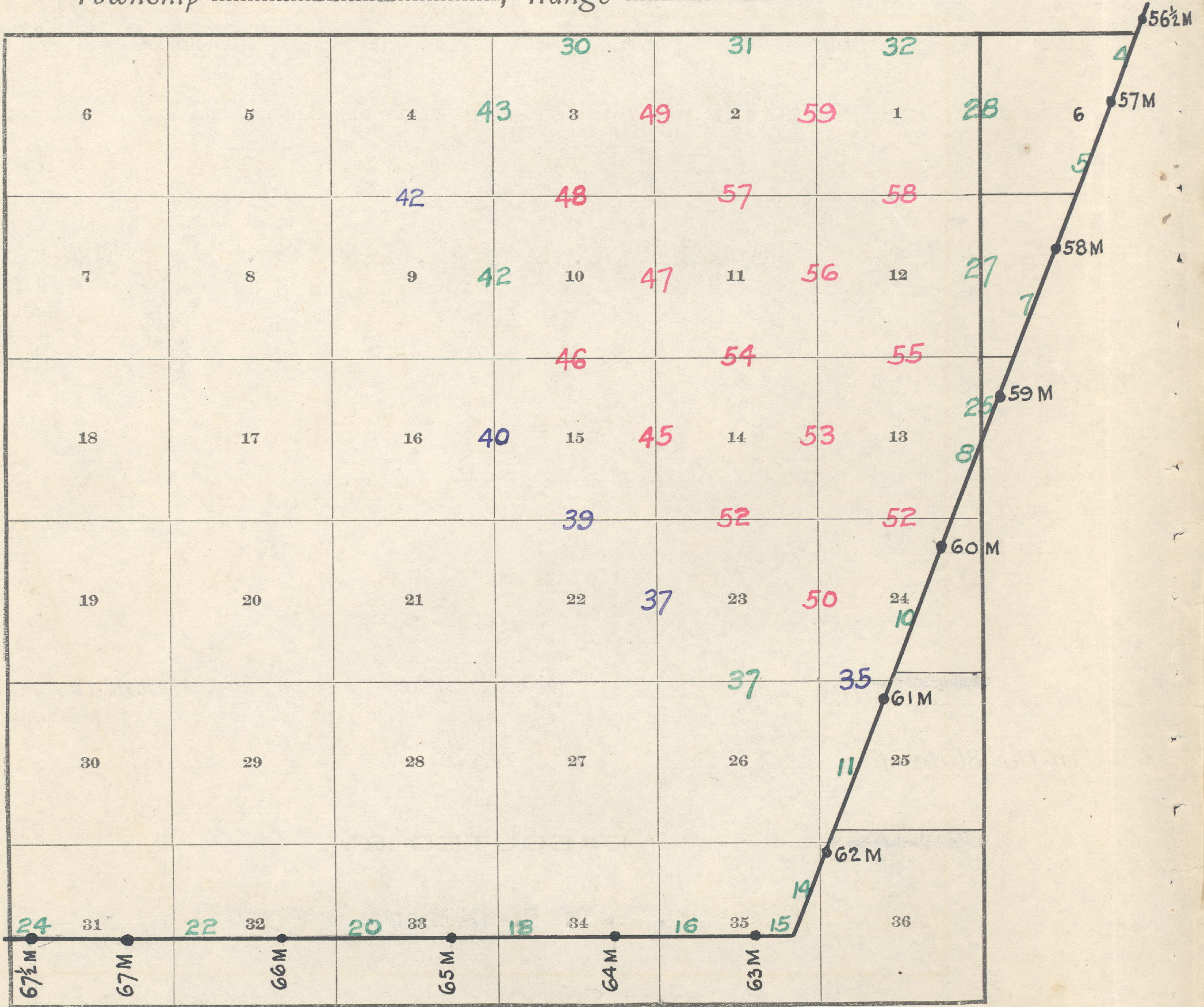

Red indicates original surveys.

Blue indicates retracements

Green indicates resurveys

Township No. 2 South, Range No. 34 East

DATE DIAGRAM

Retracements, Resurveys and Surveys for Year 1917

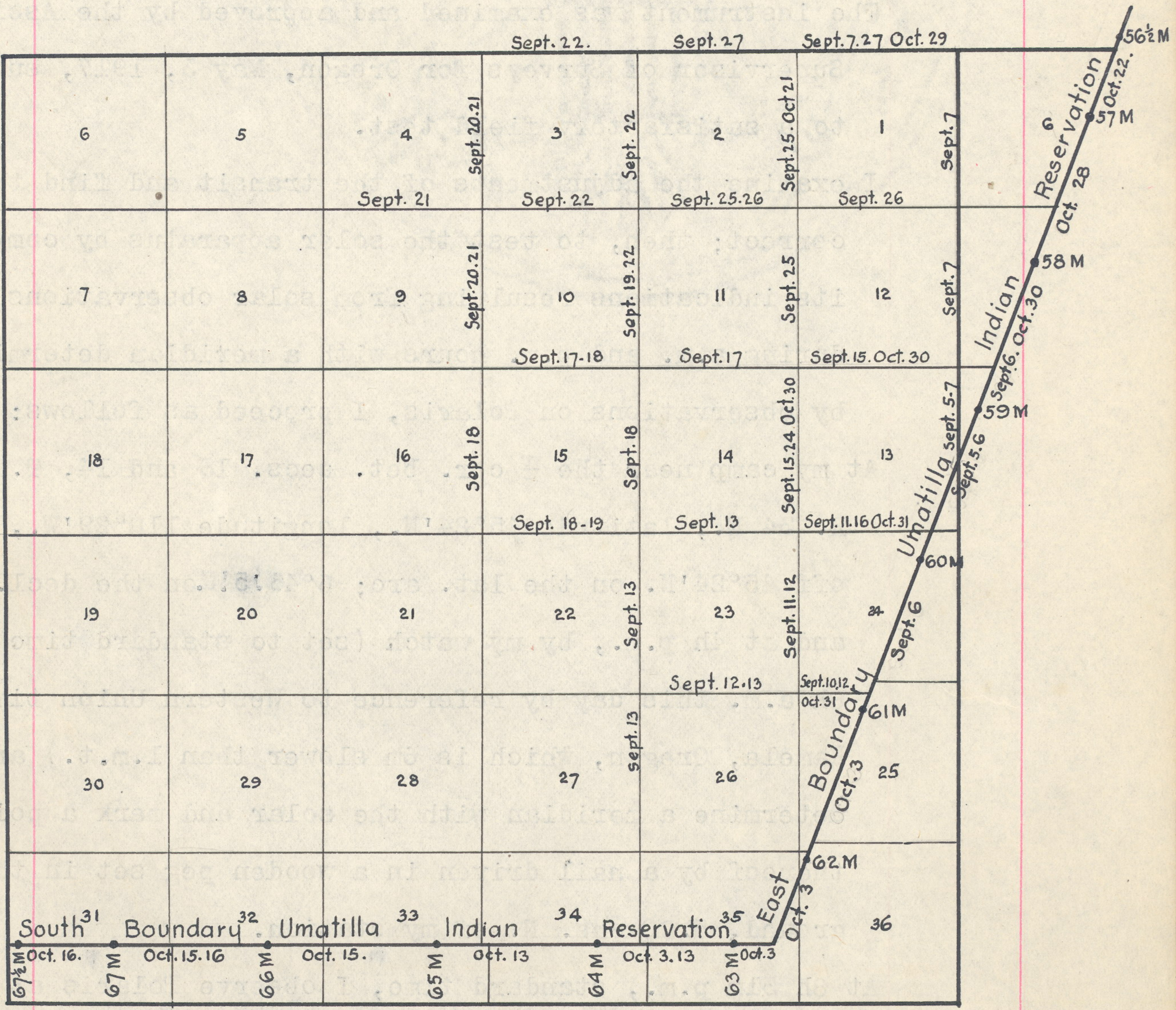

786

Retracement-Resurvey of the South Boundary

Original Umatilla Indian Reservation

Chains

(field notes)

Thence

N.89°25'E., on a true line, resurveying the 68th Mile.

Over rolling land, through scattering timber.

5.03 Intersect the 67½ Mile Cor., which is a basalt stone, 16x12x6 ins., marked but not legible, in a mound of stone.

Reset above stone, 12 ins. in the ground and mark it 67½ M on W. and U R on N. face; from which

A pine, 24 ins. diam., bears N.45°30'E., 175 lks. dist., marked U R ½ M B T (old B.T.)

A fir, 10 ins. diam., bears N.82°30'W., 330 lks. dist., marked U I R 67½ M B T (new B.T.)

Thence

N.89°47'E., continuing my measurements

45.40 The 67 Mile Cor., heretofore described.

Land, rolling.

Soil, light loam, scant, on basalt bedrock; 2nd rate.

Timber, scattering pine.

Undergrowth, none.

Resurvey Portion East Bdy., T. 2 S., R. 34 E.

Retracements

From the cor. of secs. 13, 18, 19 and 24, on the E. bdy. of the Tp., North retracing the line bet. secs. 13 and 18; at 40.23 chs. pass 13 lks. W. of the ¼ sec. cor., and at 80.40 chs. fall 13 lks. W. of the cor. of secs. 7, 12, 13 and 18.

North retracing the line bet. secs. 7 and 12; at 40.29 chs. fall 19 lks. W. of the ¼ sec. cor. This half mile being out of limits and the line subject to rectification, I continue my measurements, setting temp. cors., and at 2 miles, 82 lks. fall 19 lks. W. of the cor. of Tps. 1 and 2 S., Rs. 34 and 35 E.

I commence at the cor. of secs. 13, 18, 19 and 24, on the E. bdy. of the Tp., which is a volcanic stone, 5x3x1 ft. above ground, not marked. At the exact cor. point as determined by the original bearing trees, cut a cross (x) for cor. of secs. 13, 18, 19 and 24, marked with 3

Resurvey Portion East Bdy., T. 2 S., R. 34 E.

Chains

notches N. and S. of cross; from which

A tamarack, 12 ins. diam., bears N.85°E., 13 lks. dist., marked S 18 (lower blaze healed over, not opened) (Old B.T.) I additionally mark T 2 S R 35 E.

A tamarack stump, 10 ins. diam., bears S.41°E., 33 lks. dist., marked T 2 S R 35 E S 19 B T (Old B.T.)

A tamarack, 16 ins. diam., bears S.61°15'W., 16 lks. dist., marks not legible; remarked T 2 S R 34 E S 24 B T. (Old B.T.)

A fir, 10 ins. diam., bears N.37°45'W., 33 lks. dist., marks illegible (Old B.T.).

A tamarack, 15 ins. diam., bears N.15°W., 29 lks. dist., marked T 2 S R 34 E S 13 B T (New B.T.)

A pine, 14 ins. diam., bears S.62°45'E., 65 lks. dist., marked T 2 S R 35 E S 19 B T (New B.T.)

Thence N.0°11'E., resurveying line bet. secs. 13 and 18.

Descend 200 ft. to

- 8.04 Dry gulch, course W.; ascend steep S. slope, 200 ft. to
- 13.43 Top of ascent, bears E. and W.; thence over rolling land.
- 17.08 Intersect the E. bdy. of the Umatilla Indian Reservation, 3.12 chs. S.19°31'W. from the 59½ Mile Cor.

At the point of intersection

Set an iron post, 3 ft. long, 2 ins. diam., 24 ins. in the ground, for closing cor. of secs. 13 and 18, with brass cap marked

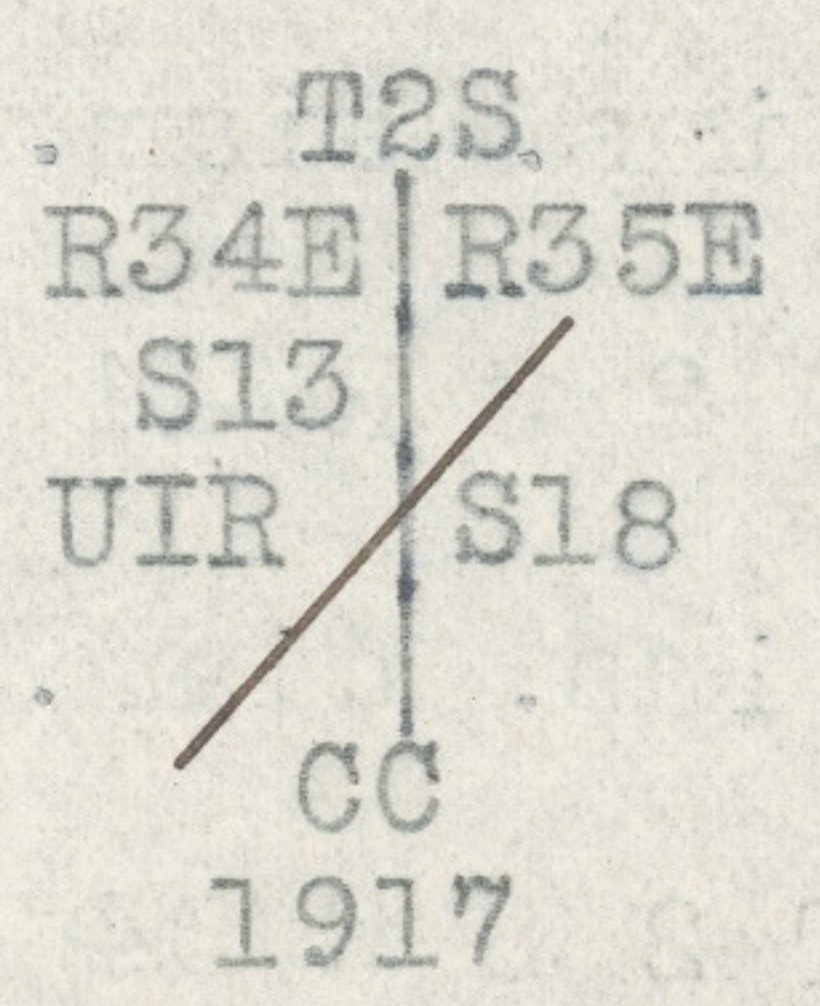

from which

A fir, 22 ins. diam., bears S.59°15'E., 77 lks. dist., marked C C T 2 S R 35 E S 18 B T.

A fir, 16 ins. diam., bears S.48°30'W., 64 lks. dist., marked C C T 2 S R 34 E S 13 B T.

788

Resurvey Portion East Bdy., T. 2 S., R. 34 E.

Chains

40.23

Intersect point for 1/4 sec. cor., located by reference to the old bearing trees. At the exact cor. point Set an iron post, 3 ft. long, 1 in. diam., 26 ins. in the ground, for 1/4 sec. cor., with brass cap marked

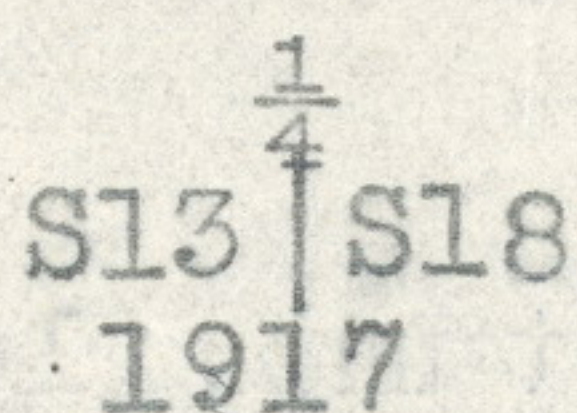

from which

A fir, 15 ins. diam., bears N.45°45'W., 18 lks. dist., marked 1/4 S (lower blaze healed over)

A pine, 48 ins. diam., bears N.44°20'E., 70 lks. dist., marked 1/4 S B T.

Thence North, continuing my measurements

80.40

Intersect the old cor. of secs. 7, 12, 13 and 18, which is a badly decayed post, 4x4x36 ins. above ground, witnessed as described by the surveyor general. At the exact cor. point Set an iron post, 3 ft. long, 2 ins. diam., 24 ins. in the ground, for cor. of secs. 7, 12, 13 and 18, with brass cap marked

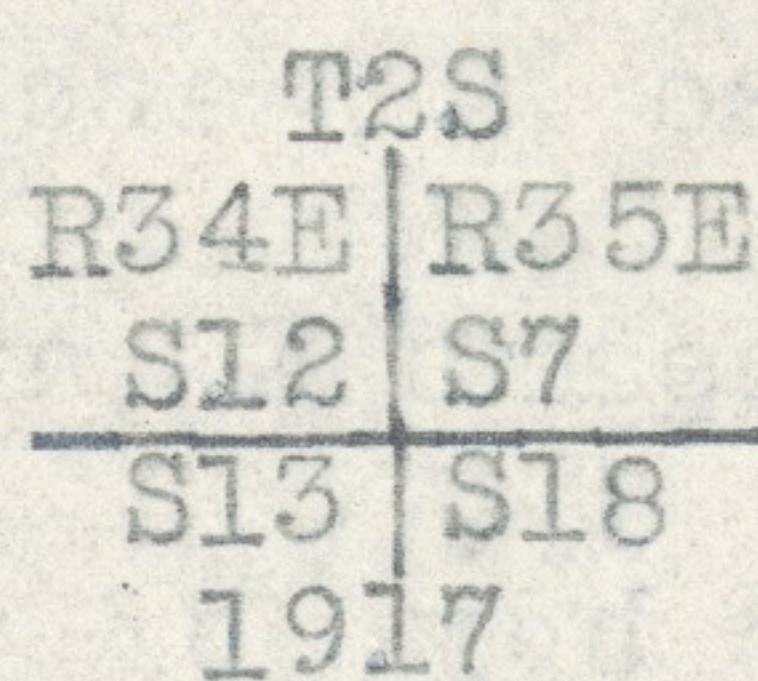

from which

A dead fir, 16 ins. diam., bears N.50°E., 40 lks. dist., marks illegible (Old B.T.)

A dead fir, 12 ins. diam., bears S.34°E., 31 lks. dist., marked T 2 S R 35 E S 18 B T (Old B.T.)

A fir, 12 ins. diam., bears S.12°W., 19 lks. dist., marked T 2 S R 34 E S 13 B T (Old B.T.)

A fir, 16 ins. diam., bears N.17°30'W., 72 lks. dist., marked T 2 S R 34 E S 12 B T (Old B.T.)

A fir, 10 ins. diam., bears N.34°E., 77 lks. dist., marked T 2 S R 35 E S 7 B T. (New B.T.)

A fir, 24 ins. diam., bears S.87°E., 52 lks. dist., marked T 2 S R 35 E S 18 B T. (New B.T.)

Resurvey. Portion East Bdy., T. 2 S., R. 34 E.

Chains

A fir, 5 ins. diam., bears N.32°W., 36 lks. dist.,
marked T 2 S R 34 E S 12 B T (New B.T.)

Land, rolling, bench and mountainous.

Soil, light loam on basalt rock, 2nd rate.

Timber, pine, fir and tamarack.

Undergrowth, lodgepole pine, balsam and willow.

North, resurveying the line bet. secs. 7 and 12.

Descend 230 ft., through scattering timber to

10.40 Dry gulch, course NW.; thence over low point.

17.09 Dry gulch, course S.80°W.; ascend S. slope 260 ft. to

35.00 Top of ascent, bears E. and W.; thence over rolling land.

40.00 Set an iron post, 3 ft. long, 1 in. diam., 26 ins. in the
ground, for $\frac{1}{4}$ sec. cor., with brass cap marked

$\frac{1}{4}$
S12 | S7
1917

from which

A pine, 36 ins. diam., bears S.82°30'E., 69 lks. dist.,
marked $\frac{1}{4}$ S 7 B T.

A pine, 16 ins. diam., bears N.18°15'W., 60 lks. dist.,
marked $\frac{1}{4}$ S 12 B T.

The old $\frac{1}{4}$ sec. cor. bears N.33°E., 35 lks. dist., which I
destroy.

80.00 Set an iron post, 3 ft. long, 2 ins. diam., 24 ins. in the
ground, for cor. of secs. 1, 6, 7 and 12, with brass cap
marked

T2S
R34E | R35E
S1 | S6
S12 | S7
1917

from which

A fir, 20 ins. diam., bears N.3°45'E., 240 lks. dist.,
marked T 2 S R 35 E S 6 B T.

A pine, 36 ins. diam., bears S.32°45'E., 163 lks.
dist., marked T 2 S R 35 E S 7 B T.

A pine, 18 ins. diam., bears S.62°W., 20 lks. dist.,
marked T 2 S R 34 E S 12 B T.

790

Resurvey Portion East Bdy., T. 2 S., R. 34 E.

Chains

A pine, 30 ins. diam., bears N.34°W., 69 lks. dist.,
marked T 2 S R 34 E S 1 B T.

The old cor. of secs. 1, 6, 7 and 12 bears North, 32 lks.
dist., which I destroy.

Land, rolling, bench and mountainous.

Soil, light loam on basalt bedrock, 2nd rate.

Timber, pine, tamarack and fir.

Undergrowth, pine, fir and willow.

North, resurveying the line bet. secs. 1 and 6.

Ascend gradually through scattering timber.

40.00 Set an iron post, 3 ft. long, 1 in. diam., 26 ins. in the
ground, for 1/4 sec. cor., with brass cap marked

1/4
S1 | S6
1917

from which

A fir, 16 ins. diam., bears N.80°E., 6 lks. dist.,
marked 1/4 S 6 B T.

A fir, 16 ins. diam., bears S.7°30'W., 43 lks. dist.,
marked 1/4 S 1 B T.

The old 1/4 sec. cor. bears N.39°45'E., 85 lks. dist., which
I destroy.

41.00 Leave timber; enter glade, bears NW. and SE.

50.00 Top of ascent, bears NW. and SE.; descend. 460 ft. through
scattering timber and dense undergrowth.

76.32 Ravine, course NE.; ascend SE. slope.

80.82 Intersect the point for cor. of Tps. 1 and 2 S., Rs. 34
and 35 E., as determined by reference to the NE. bearing
tree.

This point is on a steep E. slope, where it is impracticable
to set an iron post more than 6 ins. in the ground;
therefore, at a point 30 lks. W. of true cor. point

Set an iron post, 3 ft. long, 3 ins. diam., 24 ins. in
the ground, for witness cor. to the cor. of Tps. 1 and
2 S., Rs. 34 and 35 E., with brass cap marked

Resurvey Portion East Bdy., T. 2 S., R. 34 E.

Chains

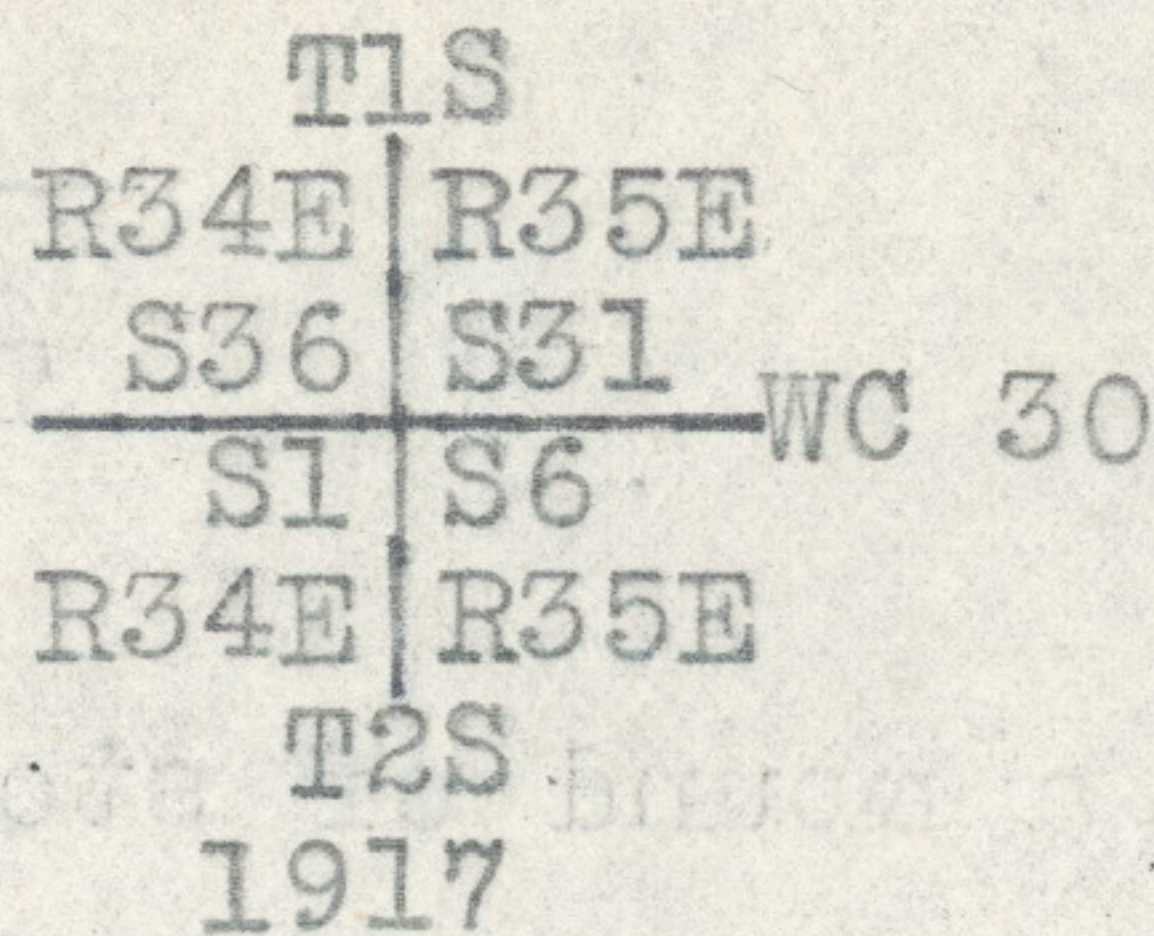

and raise a mound of stone, 2 ft. base, 1½ ft. high, S. of post.

From the true cor. point

A pine, 12 ins. diam., bears N.26°E., 112 lks. dist., marked T 1 S R 35 E S 31 B T (Old B.T.)

A fir, 12 ins. diam., bears S.17°45'W., 352 lks. dist., marked T 2 S R 34 E S 1 B T (New B.T.)

Land, mountainous, bench and rolling.

Soil, light shallow loam, on basalt bedrock, 2nd rate.

Timber, yellow pine, balsam, fir and tamarack.

Undergrowth, balsam, lodgepole pine and willow.

Resurvey Portion North Bdy., T. 2 S., R. 34 E.

Retracements

From the cor. of Tps. 1 and 2 S., Rs. 34 and 35 E., West retracing the line bet. secs. 1 and 36; at 42.28 chs. fall 495 lks. N. of the ¼ sec. cor., and at 80.27 chs. fall 112 lks. N. of the cor. of secs. 1, 2, 35 and 36.

West, retracing line bet. secs. 2 and 35; at 40.20 chs. fall 29 lks. N. of the ¼ sec. cor., and at 79.94 chs. fall 91 lks. N. of the cor. of secs. 2, 3, 34 and 35.

West, retracing the line bet. secs. 3 and 34; at 40.00 chs. find no trace of the ¼ sec. cor., and at 77.77 chs. fall 167 lks. N. of the cor. of secs. 3, 4, 33 and 34.

S.89°25'W., retracing the S. bdy. of sec. 33, T. 1 S., R. 34 E., and at 3.91 chs. fall 4 lks. S. of the closing cor. of secs. 3 and 4, T. 2 S., R. 34 E.

The closing cor. of secs. 3 and 4 is a basalt stone, 15x8x10 ins. above ground, firmly set, marked x on top, with 6 notches on S. face, witnessed as described by the surveyor general.

At a point 4 lks. S. of the old closing cor.

Set an iron post, 3 ft. long, 2 ins. diam., 24 ins. in the ground, for closing cor. of secs. 3 and 4, with brass cap marked

For Final Certificate of U. S. Surveyor, see Book "E"

Approval

Office of U. S. Surveyor General,
Portland, Oregon, August 26, 1918

The foregoing field notes of the Resurvey of the Original Umatilla Indian Reservation Boundary from the 56½ Mile Cor. to the SW. Cor. thereof; Resurvey Portion of N. and E. Bdrs. and Retracement, Resurvey and Survey of Subdivisional Lines in Township No. 2 South, Range No. 34 East of the Willamette Meridian, Oregon, executed by L. E. Wilkes, U. S. Surveyor, under his special instructions dated February 20, 1917, having been critically examined, and the necessary corrections and explanations made, the said field notes, and the surveys they describe, are hereby approved.

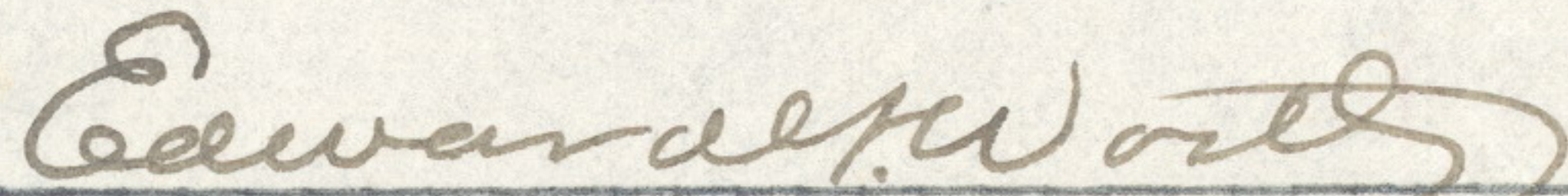
U. S. Surveyor General

