

FIELD NOTES

Of the survey of the *Exterior and Subdivisional*

Lines of *Township 2 South,*

Range 33 East, Willamette Meridian,

Oregon, as surveyed by *John C. Arnold*

U. S. Deputy Surveyor, under his Contract No. *551.*

dated *March 19th* 18*90*

Survey commenced, *September 17th* 18*90*

Survey completed, *September 28th* 18*91*

NAMES AND DUTIES OF ASSISTANTS,

....., Compassman.

Edgar R. Thomson, Chainman.

Jacob C. Hill, Chainman.

....., Chainman.

....., Chainman.

James P. Caffrey, Axeman.

Ellsworth B. Hall, Axeman.

Moses H. Thompson, Flagman.

PRELIMINARY OATHS OF ASSISTANTS.

We, Moses H. Thompson Edgar R. Thomson ^{and} Silas D. Morgan

do solemnly swear that we will faithfully execute the duties of Chain Carriers, that we will level the chain over even and uneven ground, and plumb the tally pins, either by sticking or dropping the same; that we will report the true distance to all notable objects, and the true length of all lines that we will assist in measuring, to the best of our skill and ability, and in accordance with the instructions given us in

the survey of the subdivisional and exterior
lines of T. 2 South

R 33 East, Willamette Meridian, Oregon.

Moses H. Thompson, Chainman.

Edgar R. Thomson, Chainman.

Silas D. Morgan, Chainman.

_____, Chainman.

Subscribed and sworn to before me, this Sixth

day of September 1890

W.M. Pierce, County Clerk

[SEAL.]

By J.E. Beaman Deputy

We, Jacob C. Hill, Ellsworth B. Hall and

James P. Caffrey, do solemnly swear that we will well and truly perform the duties of Axemen in the establishment of corners and other duties, according to instructions given us, and to the best of our skill and abil-

ity, in the survey of the subdivisional and exterior
lines of T. 2 South R 33 East. Willamette Meridian, Oregon.

Jacob C. Hill, Axeman.

James P. Caffrey, Axeman.

Axeman

Subscribed and sworn to before me, this Sixth

day of September 1890

W.M. Pierce County Clerk

[SEAL.]

By J.E. Beaman Deputy

INDEX A

Referring the Lines to the Pages of the Field Notes.

T. 2 South R. 33 East Will. Mer.

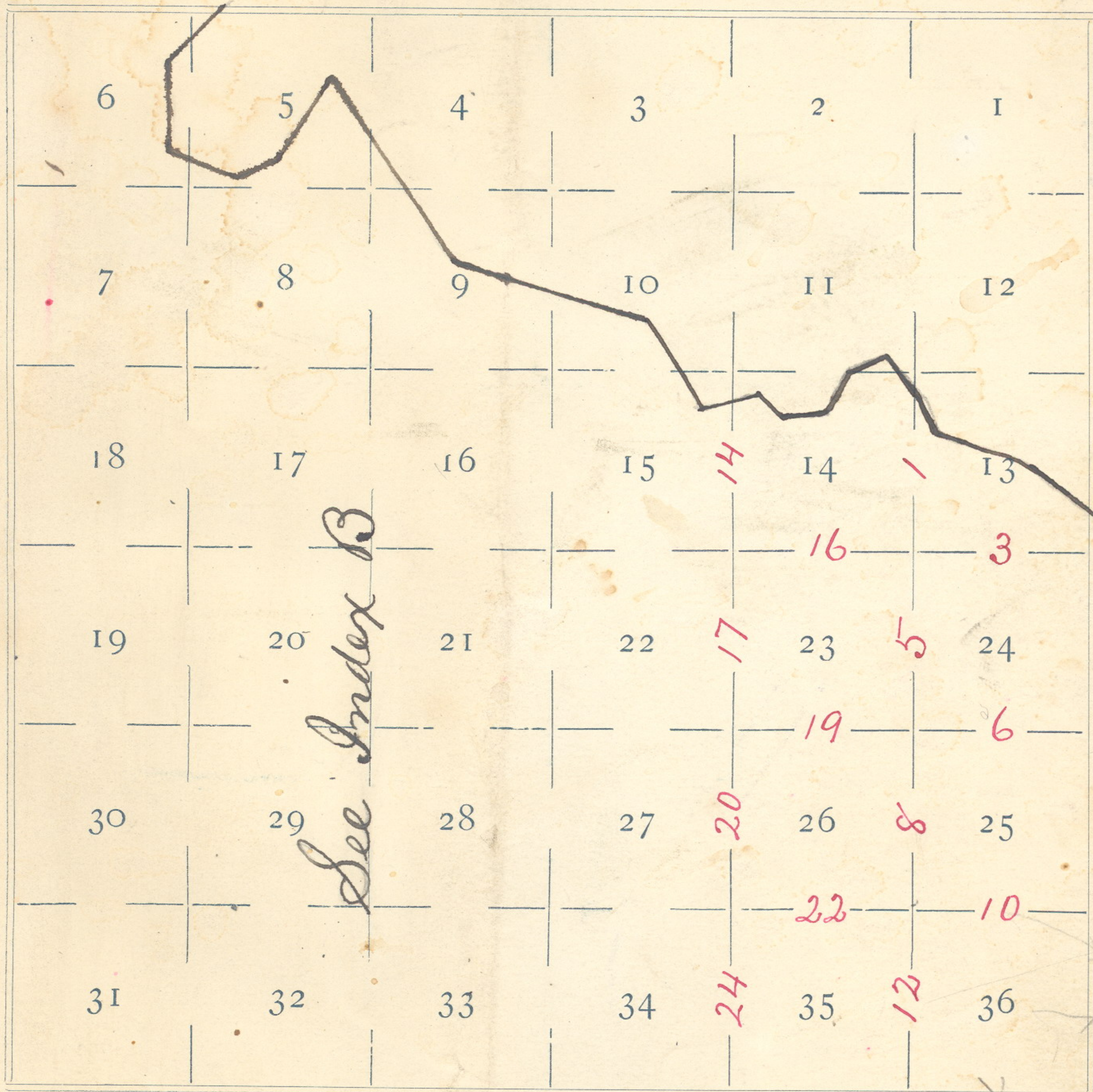

Meanders of _____ Pages _____ to _____

Meanders of _____ Pages _____ to _____

FIELD NOTES

Of the survey of the *Exterior and Subdivisional*
 Lines of *Township 2 South*
Range 33 East Willamette Meridian,
 Oregon, as surveyed by *Jno. C. Arnold*,
 U. S. Deputy Surveyor, under his Contract No. *551*,
 dated *March 19*" 1890

Survey commenced *September 17*" 1890
 Survey completed *September 28*" 1891

NAMES AND DUTIES OF ASSISTANTS.

- George E. Waggoner*, Compassman.
- Jacob C. Hill*, Chainman.
- [Faded Name]*, Chainman.
- Clarence A. Hall*, Chainman.
- [Faded Name]*, Chainman.
- [Faded Name]*, Axeman.
- Isaac W. Kimball*, Axeman.
- [Faded Name]*, Flagman.

149A

PRELIMINARY OATHS OF ASSISTANTS.

We, *Jacob C Hill and Clarence A Hall*

do solemnly swear that we will faithfully execute the duties of Chain Carriers; that we will level the chain over even and uneven ground, and plumb the tally pins, either by sticking or dropping the same; that we will report the true distance to all notable objects, and the true length of all lines that we will assist in measuring, to the best of our skill and ability, and in accordance with the instructions given us in the survey of the.....

Exterior and Subdivisional
.....lines of *Township 2 South*
Range 33 East.....Willamette Meridian, Oregon.

Clarence A Hall, Chainman.
Jacob C Hill, Chainman.
....., Chainman.
....., Chainman.

Subscribed and sworn to before me, this *fourteenth*
day of *September*.....189*1*.....

[SEAL.]

W M Pierce
County Clerk

We, *J Isaac W. Kimball*.....and

.....do solemnly swear that we will well and truly perform the duties of Axemen in the establishment of corners and other duties, according to instructions given ~~me~~ and to the best of ~~our~~ skill and

ability, in the survey of the *Exterior and Subdivisional lines*
of Township 2 South Range 33 East.....Willamette Meridian, Oregon.

J. W. Kimball, Axeman.
....., Axeman.

Subscribed and sworn to before me, this *fourteenth*
day of *September*.....189*1*.....

[SEAL.]

W M Pierce
County Clerk

INDEX B.

Referring the Lines to the Pages of the Field Notes.

T. *2 South* R. *33 East* Will. Mer.

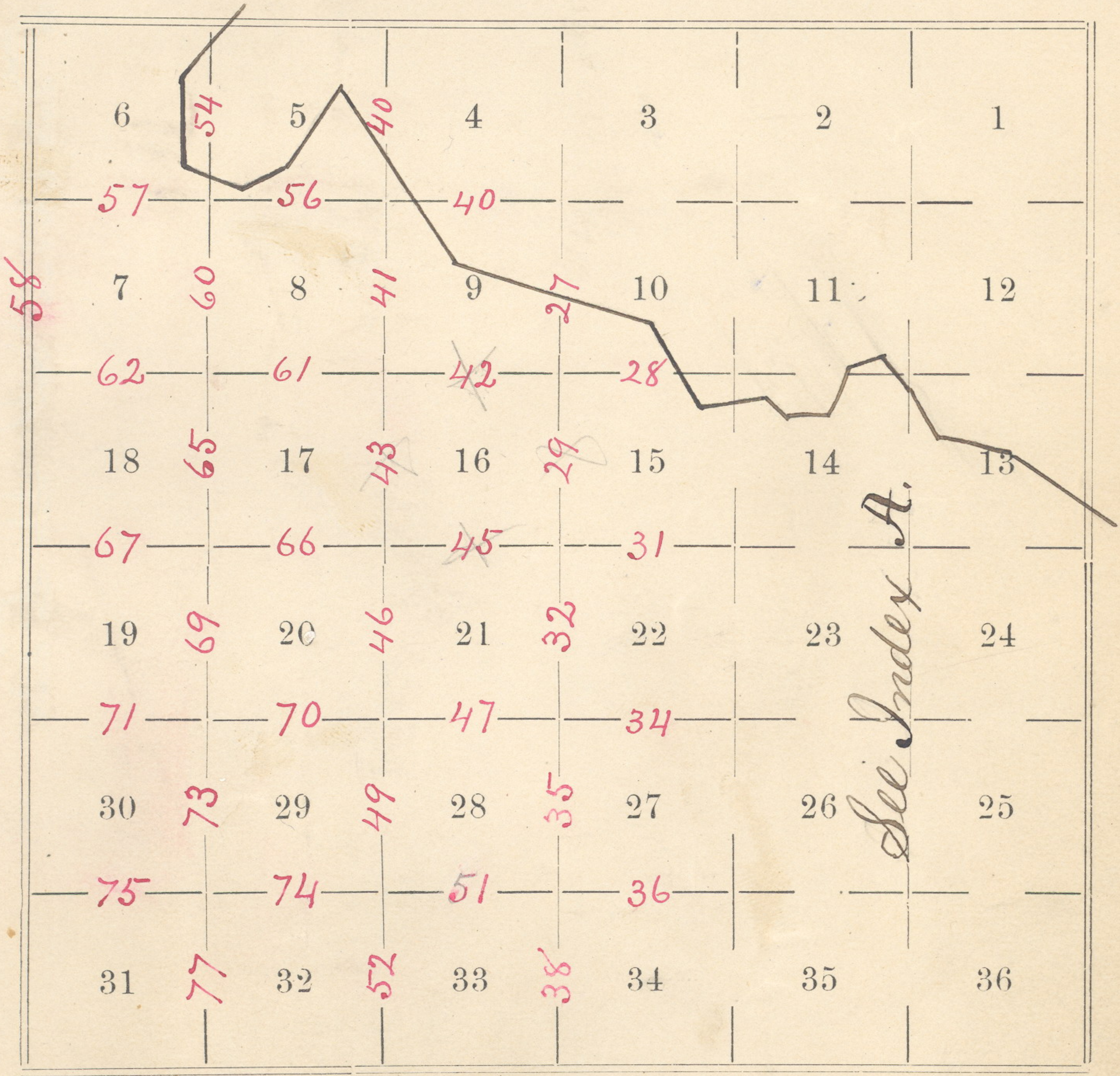

Meanders of Pages to

Meanders of Pages to

152

Subdivisions of T. 2 South R. 33 East

Willamette Meridian, Oregon.

(8093-10 M.)

Timber pine, fir and larch, with
dense undergrowth of same 55.05 cho.
Soil stony 4" rate - Good grass on N. slopes.
Sep. 23^d. 1890.

South, on a random line bet. secs. 35 & 36.
ra. 24° 15' E.

Ascend through brush & timber.

40.00 Set temp $\frac{1}{4}$ sec. cor.

80.00 Int. S. body. of Sp. at cor. for secs.
1-2-35-36, which is a basalt stone
12x10x8 ins. 2 ins. in ground, marked
1 notch on E, and 5 notches on W. from
which a pine 20 ins dia. bears N. 54° E.
49 lks. dist., marked T 2 S R 33 1/2 E S 36 B T.
a pine 10 ins. dia., bears S 29° E 75 lks.
dist., marked T 3 S R 33 1/2 E S 1 B T. - A pine
6 ins. dia. bears S 50° W. 36 lks. dist., mar-
ked T 3 S R 33 1/2 E S 2 B T. - A tamarack 22 ins.

Subdivisions of T. 2 South R. 33 East
Willamette Meridian, Oregon.

dia. bears N. 48° W. 37 lks. dist. marked

T2SR 33½ E S35BT.

Thence run,

North on true line bet. secs 35 & 36.

va. 20° 00' E.

Through thick timber on mtn.

26.00 Descend mtn.

40.00 Set a basalt stone 14 x 10 x 5 ins. 10

ins. in ground for ¼ sec. cor., marked ¼ on W. face, and raised a md.

of earth and stone 2 ft. h. x 3½ ft. b. over cor., on N. hill side, from which a

fir 6 ins. dia. bears S. 50° W. 25 lks.

dist., marked ¼ SBT. - A pine 8 ins.

dia. bears N. 52° E. 26 lks. dist., marked ¼ SBT.

51.50 Cañon course N.W. Ascend steep mtn. ridge, through dense brush & timber.

52.50 Sum. of ridge falls S. 85° W. Descend.

64.00 Birch creek, 20 lks. wide, runs N. 65° E. Ascend.

681164

Subdivisions of T. 2 South R. 33 East

Willamette Meridian, Oregon.

(8093-10 M.)

South on a random line bet. secs. 34 & 35.

Va. $13^{\circ}00' E$.

Ascend.

40.00 Set temp $\frac{1}{4}$ sec. cor.

79.83 Int. S. bndy. of Tr. at cor. to secs. 2-3-34 & 35., which is a pine post $4\frac{1}{2}$ ins. sq., and $4\frac{1}{2}$ ft. long, 2 ft. in ground, marked T2 S S 35, on N.E. — R 33 $\frac{1}{2}$ S 2, on S.E. — S 3, on S.W. — S 34, on N.W. faces, with 1 notch on W. and 2 notches on E. ^{edges} corners. from which a pine 6 ins. dia. bears N. $30^{\circ} E$. 32 lks. dist., marked T 2 S R 33 $\frac{1}{2}$ & S 35 B.T. A fir 40 ins. dia. bears S. $75^{\circ} E$. 11 lks. dist., marked T 3 S R 33 $\frac{1}{2}$ & S 2 B.T. A tamarack 30 ins. dia. bears S. $48^{\circ} W$. 6 lks. dist., marked T 3 S R 33 $\frac{1}{2}$ & S 3 B.T. A fir 4 ins. dia. bears N. $25^{\circ} W$. 21 lks. dist., marked T 2 S R 33 $\frac{1}{2}$ & S 34 B.T.

Thence I run,

North on true line bet. secs. 34 & 35.

Subdivisions of T. 2 South R. 33 East
Willamette Meridian, Oregon.

(8093-10 M.)

South bet. secs. 33 & 34.

va. $20^{\circ} 10' E$.

- 4.00 Enter dense forest of pine & fir.
- 31.00 Descend.
- 40.00 Set a basalt stone $16 \times 6 \times 6$ ins. 12 ins. in ground, for $\frac{1}{4}$ sec. cor., marked $\frac{1}{4}$ on W. face, and raised a md. of earth $1\frac{1}{2}$ ft. h. \times $2\frac{1}{2}$ b. over cor., from which a pine 3 ins. dia. bears west 12 lks. dist., marked $\frac{1}{4} S B S$. - A pine 20 ins. dia. bears $N. 80^{\circ} E$. 15 lks. dist. marked $\frac{1}{4} S B S$, on E. hill side.
- 41.75 Ravine course S.E. - $100'$
- 53.50 Int. E. & W. line, 740 lks., east of cor. to secs. 1-2-35-36 which is a pine post 4 ins. sq. \times 2 ft. above ground, marked $T 2 S R 33 E S 36$ on N.E. - $T 3 S R 33 E S 1$ on S.E. - $T 3 S R 33 E S 2$ on S.W. and $T 2 S R 33 E S 35$ on N.W. faces, from which a pine 20 ins. dia. bears $N. 40^{\circ} E$. 26 lks. dist., marked $T 2 S R 33 E S 36 B S$.

Subdivisions of T. 2 South R. 33 East
 Willamette Meridian, Oregon.

a pine 10 ins. dia. bears S. 35° E. 75 lks. dist.
 marked T3SR33E S1 BT. - A fir 36 ins dia.
 bears S. 25° W. 11 lks. dist., marked T3SR33E S2 BT.
 A fir 5 ins. dia. bears N. 40° W 33 lks. dist. marked
 T2SR33E S35 BT. I obliterate the marks
 referring to Tp. 2 S. and set, at point of inter-
 section, a basalt stone 14 x 10 x 8 ins. 10 ins. in
 ground for closing cor. to secs. 33 + 34, marked
 3 notches on E. & W. faces, ^{CC on N face,} and raised a md. of
 stone 1 1/2 ft. h. x 3 1/2 ft. b. over cor., from which a
 fir 5 ins. dia. bears S. 2° E. 105 lks. dist. marked
 T3SR33E BT. - A pine 20 ins. dia. bears N. 20° W.
 143 lks. dist., marked T2SR33E S33 BT. - A fir, 30 ins
 dia. bears N. 50° E. 214 lks. dist., marked T2S
 R33E S34 BT.

Sand mountains 5350 chs. - Heavily timbered,
 with pine, fir & tamarack, with dense under-
 growth of same, 47.50 chs. - Soil 4" rate.

va. 20° 00 E.

Sept. 17" 1891.

Subdivisions of T. 2 South R. 33 East

Willamette Meridian, Oregon.

(8093-10 M.)

80.54 The cor. to secs 28-29-32-33.
 Sand mtns. 80.54 chs. - Soil stony 4" rate.
 Timber pine, fir + tamarack 20.00 chs, dense
 No undergrowth - Good grass.
 Sep. 20" 1891.

South bet secs. 32 + 33.

Var. 20° 00' E.

2.50 Leave timber.
 14.50 Enter thick brush.
 23.50 Leave " " Timber, scattering.
 38.50 Sum. of Ridge falls W. Descend 10°.
 40.00 Set a basalt stone 18 x 8 x 4 ins. 12
 ins. in ground for 1/4 sec. cor., marked
 1/4 on W. face, and raised a md. of stone
 2 ft. h. x 3 1/2 ft. b over cor., on S. hill side.
 from which a pine 36 ins. dia. bears
 S. 45° W, 123 lks. dist., marked 1/4 S.B.T.
 No other tree in limits. Pits imprac.
 41.00 Ravine course W. - Ascend 10° - 75'

Subdivisions of T. 2 South R. 33 East

Willamette Meridian, Oregon.

53.40 Int. S. bndy. of Tp. 7 65 lks., east of cor. to secs. 2-3-34-35, which is a basalt stone 14x8x6 ins. 8 ins. in ground, in a md. of stone 1 ft. h. x 2 ft. b., marked 4 notches on E. and 2 notches on W. from which a fir 8 ins. dia. bears N. 13° E. 62 lks. dist., marked T 2 S R 33 E. S 35 B.T. A pine 14 ins. dia bears S. 50° W 110 lks. dist., marked T 3 S R 33 E S 3 B.T. A fir 8 ins. dia. bears N. 20° W. 59 links dist., marked T 2 S R 33 E S 34 B.T. I destroy all marks referring to this Tp., and, at point of intersection, set a basalt stone 18x10x3 ins. 12 ins. in ground for closing cor. to secs. 32+33, marked 4 notches on E. face, and 2 notches on W. face and CC on N., and raised a md. of stone 2 ft. h. x 4 ft. b. over cor., from which a fir 10 ins. dia. bears N. 65° W. about 100 lks. dist., marked T 2 S R 33 E S 32 B.T.

Subdivisions of T. 2 South R. 33 East.

Willamette Meridian, Oregon.

(8093-10 M.)

No. other tree in limits. Pits imprac.
var $18^{\circ}00'E$.

Sand mtrns. 53.40 chs. - Timber pine,
fir and tamarack, scattering along
the whole line, with dense undergrowth
of same 9.00 chs. Soil stony 4" rate.
Good grass.

I commence at cor. for secs 5-6-31-32
on N. body of Tp., which is a basalt
stone $14 \times 10 \times 8$ ins. 10 ins in ground,
marked 5 notches on E and 1 notch
on W, with md. of stone & earth 2 ft. h. x
 $4\frac{1}{2}$ ft. b., alongside, on N. hillside.
Thence I run,

South bet. secs. 5 & 6.

va. $25^{\circ}30'E$.

9.85 Int. Res. body, at closing cor. to
secs. 5 & 6, which is a basalt stone

Subdivisions of T. 2 South R. 33 East 217
 Willamette Meridian, Oregon.

South bet. secs 31+32. - Descend 35°
 Va. $19^{\circ}45'E$.

- 6.00 Gulch, course W. - Ascend 25° - 300'
 14.00 Sum. of Ridge, falls W. - Descend 28° + 200'
 21.00 Cañon, course W. - Ascend 35° - 210'
 31.50 Sum. of Ridge, falls W. - Descend 35° + 230'
 40.00 Set a basalt stone $16 \times 7 \times 5$ ins. 6 ins. in
 ground (digging imprac.) for $\frac{1}{4}$ sec. cor.,
 marked $\frac{1}{4}$ on W. face, and raised a
 md. of stone $1\frac{1}{2}$ ft. h. \times $3\frac{1}{2}$ ft. b. over cor.,
 on S. hill side. Pits impracticable.
 43.75 Cañon, course W. - Ascend 30° - 300'.
 Enter timber.
 53.25 Int. S. bndy. of Tp. 825 links E. of
 cor. to secs. 3-4-33-34, which is a
 basalt stone $12 \times 10 \times 6$ ins. 7 ins. in ground,
 marked 3 notches on E. and 3 notches on
 W., with md. of stone $1\frac{1}{2}$ ft. h. \times $2\frac{1}{2}$ ft. b.,
 alongside, from which a willow 6
 ins. dia. bears S.W. 16 lks. dist., mar-

Subdivisions of T. 2 South R. 33 East.

Willamette Meridian, Oregon.

(8093-10 M.)

ked T3S R33E S4 BT.

At point of intersection, I set a basalt stone 18x10x6 ins. 6 ins in ground (digging imprac.) for closing cor. to secs. 31+32, marked 5 notches on E. cor., 1 notch on W. face, and 1 on N. face; raised a md. of stone 1 1/2 ft. h. x 3 1/2 ft. b. over cor., which is 3 ft. S. of a loose rock of the weight of about 1000 lbs., from which corner a fir 24 ins. dia. bears N. 80° E. 74 lks. dist. marked T2S R33E S32 BT. - a fir 6 ins. dia. bears N. 72° W. 200 lks. dist. marked T2S R33E S31 BT.

va. 18° 45' E.

Land mountainous + stony 53.25 chs
 Timber pine, fir & tamarack 9.50 "
 Soil 4" rate.

Sept. 28" 1891.

Subdivisions of T. 2 South R. 33 East
 Willamette Meridian, Oregon.

I commence at S.E. cor. to Tp. 2 S. R. 32 E.
 which is a fir post 4 ft. long and $3\frac{1}{2}$
 ins. sq. at top, pretty well decomposed,
 lying loose upon the ground, by
 the side of an unmarked basalt
 stone $8 \times 6 \times 5$ ins., about $\frac{1}{2}$ its length in
 ground;

the post

is marked thus:

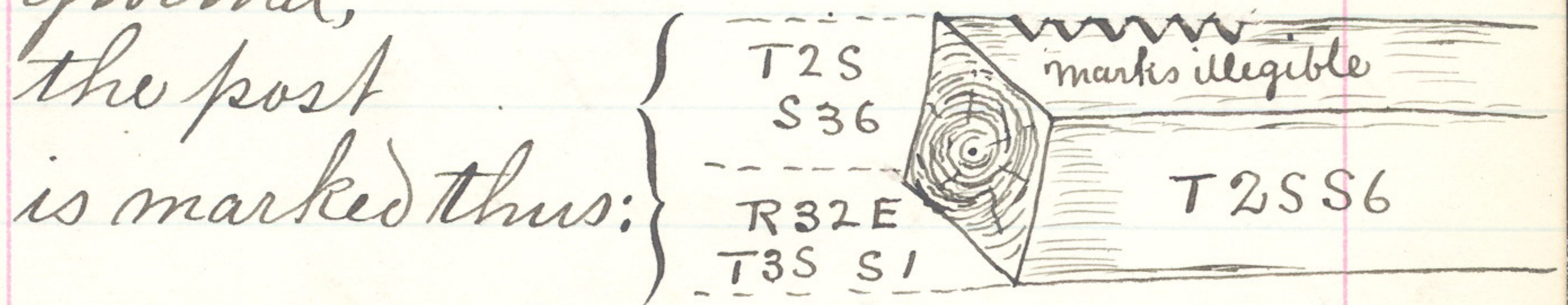

From position of stone & post,

A pine 30 ins. dia. bears $N 58^{\circ} 10' E$ 86 lks. dist.,
 marked T2 S. R 33 E S1 BT

A fir 16 ins. dia. bears $S 37^{\circ} 35' E$ 182 lks. dist.,
 marked, but blazes grown over, so the marks are
 (illegible).

A pine 30 ins. dia. bears $S 45^{\circ} 30' W$ 204 lks. dist.,
 marked T2 S R 32 E S. 1 BT.

A pine 20 ins. dia bears $N. 20^{\circ} 35' W$. 112 lks. dist.,
 marked T2 S. R 32 E S 36 BT.

On summit of high ridge at south

Subdivisions of T. 2 South R. 33 East

Willamette Meridian, Oregon.

(8093-10 M.)

edge of sage brush thicket

Thence I run

North on E. bndy. of sec. 36
va 18° 30

Following on this line are the original blazed trees:-

11.50

Descend steep hill

13.00

Enter thicket of tamarack;
find blazed trees on line.

15.03

Search diligently; but find no traces of closing Tr. cor. as reported, and the topography does not agree.

20.00

 $\frac{1.35}{21.35}$ The topography agrees with that reported; I set post mkd. 20 on south side, on line, mkd. by old blazes on trees, and go to $\frac{1}{4}$ sec. cor. on N. bndy. of sec. 5. T 3 S R 33 E, which is a pine post 4 ft. long and 4 ins. dia., marked '4 S, and lying on the

Subdivisions of T. 2 South R. 33 East

Willamette Meridian, Oregon.

ground by a mound of stone,
at upper edge of a grove of young
tamarack trees, on west slope of
hill, from which

a pine, 6 ins. dia., bears $S 64^{\circ} W$. 91 lks. dist.,
marked $\frac{1}{4}$ S. B.T.

a pine, 20 ins. dia., bears $N 42^{\circ} E$ 110 lks. dist.,
marked $\frac{1}{4}$ S. B.T.

From, thence,
west on north body of sec. 5
va. $18^{\circ} 30' E$.

Descend

8.00 Draw course $N 20^{\circ} W$

8.88 Intersect E body of Tp 2 SR 32 E 135
links north of line post marked
20 on south side, on old blazed line.

I find the topography, at this point
to agree with original notes, and,
again, diligently search for closing
Tp. cor. as reported in notes, but find
no traces of any such cor.

Subdivisions of T. 2 South R. 33 East

Willamette Meridian, Oregon.

(8093-10 M.)

In this vicinity, at certain seasons of the year, there are frequent and fearful water spouts, as they are called, hence, it is probable that the cor. stone reported, has been carried away by one of them.

At point of intersection, I set a basalt stone $18 \times 12 \times 10$ ins. 12 ins. in ground, for closing cor. to T. 2 S R. 33 E., marked C notches on N. & S. faces and CC on east face, in a draw, on west slope among clumps of Alder and willow brush, from which Atamarack 18 ins. dia. bears $N. 40^{\circ} 15' E.$ 19 lks. dist., marked T. 2 S R. 33 E. S. 31 CC B. T.
A fir 18 ins. dia. bears $N. 18^{\circ} 15' W.$ 29 links dist., marked T. 2 S R. 32 E. S. 36 B. T.

See Letter dated }
Aug 8th 1892 } July 25th 1892.

Bk. 227

230

FINAL OATHS FOR SURVEYS.

A list of the names of the individuals employed by Jno. C. Arnold, U. S. Deputy Surveyor, to assist in running, measuring and marking the lines and corners described in the foregoing field notes of the survey of the Exterior and subdivisinal lines of Township 2 South, Range 33 East Willamette Meridian, Oregon, showing the respective capacities in which they acted:

- George E. Waggoner, Compassman.
- Jacob C. Hill, Chainman.
- Clarence A. Hall, Chainman.
-, Chainman.
-, Chainman.
- Isaac W. Kimball, Axeman.
-, Axeman.
-, Flagman.

FINAL OATHS OF ASSISTANTS.

We hereby certify that we assisted Jno. C. Arnold, U. S. Deputy Surveyor, in surveying all those parts or portions of the Exterior and subdivisinal lines of Township 2 South, Range 33 East Willamette Meridian, Oregon,

as are represented in the foregoing field notes as having been surveyed by him and under his direction; and that said survey has been in all respects, to the best of our knowledge and belief, well and faithfully surveyed, and the corner monuments established, according to the instructions furnished by the U. S. Surveyor General of Oregon.

- G. E. Waggoner, Compassman.
- Jacob C. Hill, Chainman.
- Clarence A. Hall, Chainman.
-, Chainman.
-, Chainman.
- I. W. Kimball, Axeman.
-, Axeman.
-, Flagman.

Subscribed and sworn to before me, this sixth day of October 1897

[SEAL.]

W. M. Pierce
County Clerk

FINAL OATH OF DEPUTY SURVEYOR.

I, John C. Arnold
United States Deputy Surveyor, do solemnly swear that in pursuance of
instructions received from Douglas W. Taylor
U. S. Surveyor General for Oregon, bearing date of Nineteenth
day of March 1890, I have well, faith-
fully and truly, in my own proper person, and in strict conformity with
the instructions furnished by the U. S. Surveyor General for Oregon, the
Surveying Manual, and the laws of the United States, surveying all those
parts or portions of The Exterior and Subdivisional

lines of Township 2 South, Range 33 East,

Willamette Meridian, in the State of Oregon, as are represented in the
foregoing field notes as having been surveyed by me and under my direc-
tions; and I do further solemnly swear that all the corners of said survey
have been established and perpetuated in strict accordance with the Sur-
veying Manual, printed instructions, the special written instructions of
the U. S. Surveyor General for Oregon, and in the specific manner de-
scribed in the field notes, and that the foregoing are the *true* field notes of
such survey, and should any fraud be detected I will suffer the penalty of
perjury under the provisions of an Act of Congress approved August 8,
1846.

John C. Arnold
U. S. Deputy Surveyor.

Subscribed and sworn to before me, this sixth

day of October 1891

W M Pierce
County Clerk

234

FINAL OATHS FOR SURVEYS.

A list of the names of the individua's employed by John C. Arnold, U. S. Deputy Surveyor, to assist in running, measuring and marking the lines and corners described in the foregoing field notes of the survey of the subdivision and Exterior lines of Township No 2 South of Range No 33 East of Williamette Meridian, Oregon, showing the respective capacities in which they acted:

-, Compassman.
- Edgar R. Thomson....., Chainman.
- Jacob C. Still....., Chainman.
-, Chainman.
-, Chainman.
- James P. Caffrey....., Axeman.
- Ellsworth B. Hall....., Axeman.
- Moses H. Thompson....., Flagman.

FINAL OATHS OF ASSISTANTS.

We hereby certify that we assisted John C. Arnold, U. S. Deputy Surveyor, in surveying all those parts or portions of the Exterior and subdivisional lines of T 2 South R 33 East, Williamette Meridian, Oregon.

as are represented in the foregoing field notes as having been surveyed by him and under his direction; and that said survey has been in all respects, to the best of our knowledge and belief, well and faithfully surveyed, and the corner monuments established, according to the instructions furnished by the U. S. Surveyor General of Oregon.

-, Compassman.
- Jacob C. Still....., Chainman.
- Moses H. Thompson....., Chainman ~~Flagman~~
- Edgar R. Thomson....., Chainman.
-, Chainman
- James P. Caffrey....., Axeman.
- Ellsworth B. Hall....., Axeman.
-, Flagman.

Subscribed and sworn to before me, this third day of October 18 90

[SEAL.] Wm. Pierce County Clerk
By J. O. Beaman Deputy

Pages 232 & 233
are BLANK

235

FINAL OATH OF DEPUTY SURVEYOR.

I, _____
United States Deputy Surveyor, do solemnly swear that in pursuance of
instructions received from _____

U. S. Surveyor General for Oregon, bearing date of the _____

day of _____ 188___, I have well, faith-
fully and truly, in my own proper person, and in strict conformity with
the instructions furnished by the U. S. Surveyor General for Oregon, the
Surveying Manual, and the laws of the United States, surveying all those

parts or portions of _____

Willamette Meridian, in the State of Oregon, as are represented in the
foregoing field notes as having been surveyed by me and under my direc-
tions; and I do further solemnly swear that all the corners of said survey
have been established and perpetuated in strict accordance with the Sur-
veying Manual, printed instructions, the special written instructions of
the U. S. Surveyor General for Oregon, and in the specific manner de-
scribed in the field notes, and that the foregoing are the *true* field notes of
such survey, and should any fraud be detected I will suffer the penalty of
perjury under the provisions of an Act of Congress approved August 8,
1846.

U. S. Deputy Surveyor.

Subscribed and sworn to before me, this _____

day of _____ 188___

Office U. S. Surveyor General,Portland, Oregon, *September 20,* 1892The ^{foregoing} ~~following~~ Field Notes of the Survey of the*the subdivisinal lines of Township
No 2 South, Range No 33 East Willamette
Meridian Oregon*executed by *John C. Arnold U. S. Dept Sur.*under his Contract No. *551*, dated *March 19,**1890*, having been critically examined, the
necessary corrections and explanations made, the said Field Notes
and the survey they describe, are hereby approved.*W. Henry Byars*
Surveyor General.