

# FIELD NOTES

of

RETRACEMENT PORTION EAST BOUNDARY,

RETRACEMENT AND RESURVEY PORTION SOUTH BOUNDARY,

RETRACEMENT PORTION WEST BOUNDARY

and

RETRACEMENT AND SURVEY PORTION SUBDIVISIONAL LINES

in

TOWNSHIP NO. 2 SOUTH, RANGE NO. 34 EAST

Of the Willamette Meridian,

In the State of Oregon

EXECUTED BY

L. E. Wilkes

In the capacity of U. S. Surveyor..., under Special Instructions dated April 18, 191 7  
issued by the United States Surveyor General to govern surveys included in Group  
No. 38, which were approved by the Commissioner of the General Land  
Office, May 10, 191 7, and Assignment Instructions dated Sept. 13, 191 7

Survey commenced October 10, 191 7

Survey completed October 18, 191 7

ACCEPTED BY THE HON. COMMISSIONER G. L. O. May 2. 1919

FIELD NOTES

INDEX DIAGRAM.

Township 2 South, Range 34 East

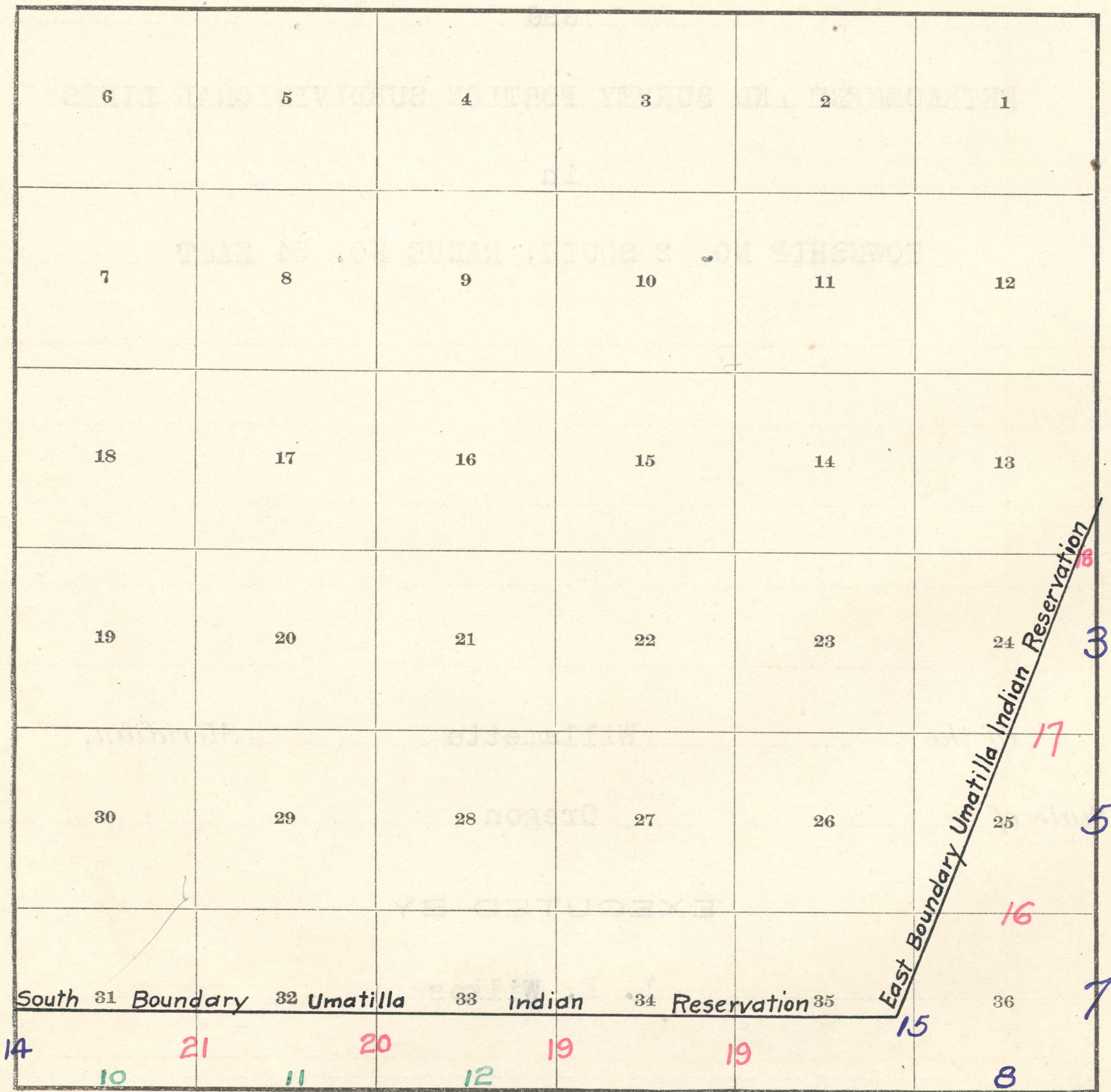

Red indicates original surveys.

Blue indicates retracements.

Green indicates resurveys.

Township No. 2 South, Range No. 34 East

DATE DIAGRAM

Retracements, Resurveys and Surveys for Year 1917

	6	5	4	3	2	1
	7	8	9	10	11	12
	18	17	16	15	14	13
	19	20	21	22	23	24
	30	29	28	27	26	25
	South <sup>31</sup> Boundary <sup>32</sup> Umatilla <sup>33</sup> Indian <sup>34</sup> Reservation <sup>35</sup>					36
Oct. 16	Oct. 16	Oct. 18	Oct. 11	Oct. 17	Oct. 12	Oct. 11

East Boundary Umatilla Indian Reservation

Sept. 6, 1917: At 4h 0m p.m., I set off the station of  
 Solaris 1° 27' to the west and mark the meridian thus de-  
 termined on a peg driven in the ground, 5.00 chs. N. of  
 my station.

Sept. 6, 1917.

Oct. 9, 1917: At 4h 0m p.m., I set off 48° 24' N. on  
 the lat. arc; 6° 17' E. on the decl. arc; and determine  
 with the solar meridian, which falls 0° 0' 30" west of  
 the meridian determined by Solaris observation, Sept. 6.

Chains

This survey was made simultaneously and in connection with the survey that portion of this township within the original boundaries of the Umatilla Indian Reservation. Survey commenced Oct. 10, 1917 and executed with a Young and Sons light mountain transit No. 8585, with Smith solar attachment. The horizontal limb is provided with two double verniers placed opposite to each other, reading to single minutes of arc, which is also the least count of the verniers of the latitude and declination arcs.

The instrument was examined and approved by the Assistant Supervisor of Surveys for Oregon, May 3, 1917, subject to a satisfactory field test.

I examine the adjustments of the transit and find them correct; then, to test the solar apparatus by comparing its indications resulting from solar observations made during a.m. and p.m. hours with a meridian determined by observations on Polaris, I proceed as follows:

Sept. 5, 1917: At my camp near the  $\frac{1}{4}$  cor. of secs. 13 and 14, lat.  $45^{\circ}24'N.$ , long.  $118^{\circ}29'W.$ , at 8h 37m p.m., l.m.t., I observe Polaris at eastern elongation in accordance with the Manual of Instructions and mark a point in the line thus determined on a peg driven in the ground, 5.00 chs. N. of my station.

Sept. 5, 1917.

Sept. 6, 1917: At 7h 0m a.m., I lay off the azimuth of Polaris  $1^{\circ}37'$  to the west and mark the meridian thus determined on a peg driven in the ground, 5.00 chs. N. of my station.

Sept. 6, 1917.

Oct. 9, 1917: At 4h 0m p.m., l.m.t, I set off  $45^{\circ}24'N.$  on the lat. arc;  $6^{\circ}17'S.$  on the decl. arc; and determine with the solar a meridian, which falls  $0^{\circ}0'30''$  west of the meridian determined by Polaris observation, Sept. 5,

Township No. 2 South, Range No. 34 East

Chains

1917.

Oct. 9, 1917.

Oct. 10, 1917: At 8h 0m a.m., l.m.t., I set off  $45^{\circ}24'N$ . on the lat. arc;  $6^{\circ}33'S$ . on the decl. arc; and determine with the solar a meridian, which falls  $0^{\circ}0'20''$  west of the meridian determined by Polaris observation, Sept. 5, 1917.

The solar apparatus by p.m. and a.m. observations defines positions for the meridian, which vary less than 1' of arc from the meridian determined by Polaris observation; therefore, I conclude that the adjustments of the instrument are satisfactory.

The instrument was maintained in good adjustment throughout the survey. Latitude and meridian observations were taken daily, weather permitting.

Measurements were made with a 5,00 ch. steel tape, compared with a Chesterman standard 66 ft. steel tape and found correct. All measurements were made on the slope; angles read with an Abney clinometer and all distances reduced to the horizontal, which alone appears in these notes.

Note: Several cors. herein are monumented by stones because more iron posts were required than had been anticipated, and to procure another shipment would have involved the loss of much time and materially increased the cost.

---

Retracement Portion East Bdy., T. 2 S., R. 34 E.

---

Commence at the cor. of secs. 13, 18, 19 and 24, on the E. bdy. of the Tp., which is a cross (X) on a volcanic stone in place, 5x3x1 ft. above ground, witnessed as described by the surveyor general.

From this cor. the closing cor. of secs. 13 and 18, on the E. bdy. of the original Umatilla Indian Reservation, bears  $N.0^{\circ}11'E.$ , 17.08 chs. dist.

Thence

South, retracing bet. secs. 19 and 24.

Over rolling land, through heavy timber and medium under-

Retracement and Resurvey Portion South Bdy., T.2 S., R.34 E.

Chains

from which

A pine, 28 ins. diam., bears N.31°E., 38 lks. dist., marked T 2 S R 34 E S 36 B T (Old B.T.)

A pine, 20 ins. diam., bears S.79°E., 38 lks. dist., marked T 3 S R 34 E S 1 B T (Old B.T.)

A pine, 16 ins. diam., bears S.78°30'W., 27 lks. dist., marked T 3 S R 34 E S 2 B T (Old B.T.)

A pine, 30 ins. diam., bears N.80°W., 190 lks. dist., marked T 2 S R 34 E S 35 B T (Old B.T.)

The true course and distance of this line from the 1/4 sec. cor. is S.89°17'W., 40.01 chs.

Land, high bench.

Soil, light shallow loam on basalt rock, 3rd rate.

Timber, pine and fir.

Undergrowth, balsam, willow and pine.

Retracements

From the cor. of secs. 3, 4, 33 and 34, West retracing bet. secs. 4 and 33; at 39.30 chs. pass 20 lks. N. of the 1/4 sec. cor., and at 79.24 chs. fall 129 lks. N. of the cor. of secs. 4, 5, 32 and 33.

From the cor. of secs. 4, 5, 32 and 33, West retracing bet. secs. 5 and 32; at 39.54 chs. pass 20 lks. N. of the 1/4 sec. cor., and at 79.04 chs. fall 98 lks. N. of the cor. of secs. 5, 6, 31 and 32.

From the cor. of secs. 5, 6, 31 and 32, West retracing bet. secs. 6 and 31; at 40.10 chs. pass 5 lks. N. of the 1/4 sec. cor., and at 83.16 chs. fall 2 lks. N. of the cor. of Tps. 2 and 3 S., Rs.33 1/2 and 34 E.

The point for cor. of Tps. 2 and 3 S., Rs.33 1/2 and 34 E. is located by reference to the bearing trees as described by the surveyor general. I perpetuate this cor., as follows: at the exact cor. point

Set a sandstone, 28x9x4 ins., 21 ins. in the ground, for cor. of Tps. 2 and 3 S., Rs.33 1/2 and 34 E., marked with 6 notches on each edge; from which

A fir, 8 ins. diam., bears N.60°E., 44 lks. dist., marked T 2 S R 34 E S 31 B T (Old B.T.)

A fir, 16 ins. diam., bears S.17°E., 40 lks. dist.,

444

Retracement and Resurvey Portion South Bdy., T. 2 S., R. 34 E.

Chains

marked T 3 S R 34 E S 6 B T (New B.T.)

A tamarack, 28 ins. diam., bears S.42°W., 11 lks. dist.,

marked T 3 S R 33½ E S 1 B T (Old B.T.)

A lodgepole pine, 10 ins. diam., bears N.25°W., 36 lks.

dist., marked T 2 S R 33½ E S 36 B T (Old B.T.)

Thence

S.89°57'E., resurveying S. bdy. of sec. 31.

Over heavily rolling bench land, through heavy timber and dense undergrowth.

Descend 100 ft. to

16.50 Brook, 2 lks. wide, course SE.; ascend 140 ft. on SW. slope to

30.00 Top of ascent, bears NW. and SE.; over rolling land.

41.46 Set a basalt stone, 14x10x10 ins., 11 ins. in the ground, for ¼ cor. of sec. 31 only, marked ¼ 31 on N. face; from which

A pine, 24 ins. diam., bears N.13°W., 27 lks. dist.,

marked ¼ S 31 B T.

43.06 Intersect the point for the old ¼ sec. cor., located by reference to the bearing trees as described by the surveyor general, except that the SE. bearing tree is now dead and fallen. I change this cor. to refer to sec. 6,

T. 3 S., R. 34 E. only and perpetuate it as follows: at the exact cor. point

Set a basalt stone, 24x10x4 ins., 18 ins. in the ground, for ¼ cor. of sec. 6, T. 3 S., R. 34 E. only, marked ¼ 6 on S. face; from which

A pine, 6 ins. diam., bears South, 31 lks. dist.,

marked ¼ S 6 B T (New B.T.)

Thence

N.89°56'E., continuing my measurements

81.46 Set a sandstone, 20x14x6 ins., 15 ins. in the ground, for cor. of secs. 31 and 32, marked 32 on NE. and 31 on NW. face, with 5 notches on E. and 1 notch on W. edge; from which

448

Retracement and Resurvey Portion South Bdy., T. 2 S., R. 34 E.

Chains

- 62.25 Top of spur, slopes N.; descend 75 ft. to
- 65.00 Dry gulch, course NE.; ascend 50 ft. to
- 70.00 Top of spur, slopes N.; descend 112 ft. to
- 80.00 Intersect the old cor. of secs. 3, 4, 33 and 34, which is a basalt stone, 8x8x7 ins. above ground, firmly set, marked and witnessed as described by the surveyor general, with the exception that the SW. bearing tree is now dead. I mark a new tree, as follows: from cor.  
  - A tamarack, 8 ins. diam., bears S.37°30'W., 29 lks. dist., marked T 3 S R 34 E S 4 B T.

Land, mountainous and rolling bench.

Soil, light shallow loam, 2nd rate.

Timber, pine and fir.

Undergrowth, balsam, pine and willow.

Retracement Portion West Bdy., T. 2 S., R. 34 E.

From the cor. of Tps. 2 and 3 S., Rs. 33½ and 34 E., previously described

North, retracing bet. secs. 31 and 36.

Over high rolling land, through heavy timber and medium undergrowth.

17.00 Road, bears NE. and SW.

32.50 Intersect the closing cor. on the S. bdy. of the original Umatilla Indian Reservation, which is an iron post, 2 ins. diam., 12 ins. above ground, marked and witnessed as described by the surveyor general.

The true course and distance of this line to the closing cor. is North, 32.50 chs.

Land, mountainous.

Soil, light shallow loam, 2nd rate.

Timber, pine, fir and tamarack.

Undergrowth, pine, fir and tamarack.



Retracement Portion Subdivisions, T. 2 S., R. 34 E.

Chains

Commence at the  $\frac{1}{4}$  cor. of secs. 35 and 36, which is an old post, marked and witnessed as described by the surveyor general. To further perpetuate this cor. I mark  
 A fir, 10 ins. diam., bears N.80°E., 2 lks. dist., marked  $\frac{1}{4}$  S 35 B T.

and raise a mound of stone, 3 ft. base, 1 ft. high, around post.

Thence

South, retracing bet. secs. 35 and 36.

3.92 Fall 15 lks. E. of the closing cor. of secs. 35 and 36, on the E. bdy. of the original Umatilla Indian Reservation, which is located by reference to the bearing trees as described by the surveyor general. I perpetuate this cor., as follows: at the exact cor. point, which is on the E. edge of the Umatilla Indian Reservation

Set an iron post, 3 ft. long, 2 ins. diam., 24 ins. in the ground, for closing cor. of secs. 35 and 36, with brass cap marked

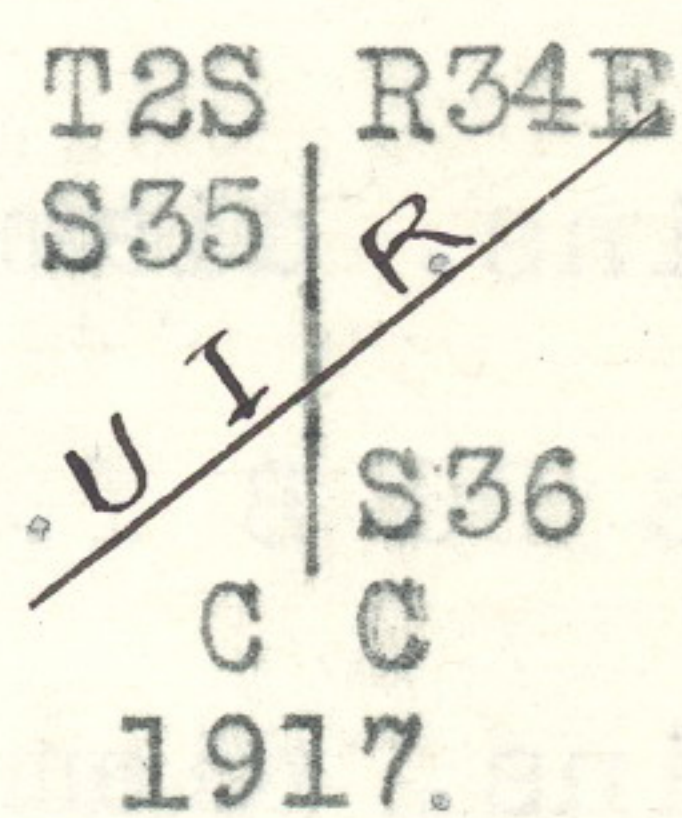

from which

A pine, 22 ins. diam., bears N.24°E., 101 lks. dist.,

marked C C S 36 B T.

A fir, 6 ins. diam., bears S.47°30'W., 23 lks. dist.,

marked C C S 35 B T.

The true course and distance of this line to the closing

cor. is S.2°10'W., 3.92 chs. This cor. is 1.20 chs. S.20°25'W. from the 62 $\frac{1}{2}$  Mile Cor. on the U.I.R. Bdy..

From the closing cor. South, continuing my measurements

39.90 Fall 15 lks. W. of the cor. of secs. 1, 2, 35 and 36, previously described.

The true course and distance of this line from the closing cor. is S.0°14'E., 35.98 chs.

450

Retracement Portion Subdivisions, T. 2 S., R. 34 E.

Chains

Land, high rolling bench.  
 Soil, shallow light loam on basalt rock, 2nd and 3rd rate.  
 Timber, pine and balsam.  
 Undergrowth, balsam, serviceberry, pine and willow.

Survey Portion Subdivisions, T. 2 S., R. 34 E.

From the cor. of secs. 25, 30, 31 and 36, on the E. bdy. of the Tp.

West, bet. secs. 25 and 36.

Over high rolling land, through heavy timber and medium undergrowth.

36.00 Enter open glade, bears N. and S.

40.00 Set an iron post, 3 ft. long, 1 in. diam., 12 ins. in the ground and 14 ins. in a mound of stone, for  $\frac{1}{4}$  sec. cor., with brass cap marked

$\frac{1}{4}$  S25  
 $\frac{1}{4}$  S36  
 1917

from which

A pine, 16 ins. diam., bears S.6°45'W., 400 lks. dist., marked  $\frac{1}{4}$  S 36 B T.

A pine, 12 ins. diam., bears N.88°45'E., 459 lks. dist., marked  $\frac{1}{4}$  S 25 B T.

49.00 Leave bench land, bears NW. and SE.; descend 320 ft. to

63.09 Intersect the E. bdy. of the original Umatilla Indian

Reservation, N.20°20'E. 7.46 chs. from the 62 Mile Cor.

At the point of intersection

Set an iron post, 3 ft. long, 2 ins. diam., 24 ins. in the ground, for closing cor. of secs. 25 and 36, with brass cap marked

T2S R34E  
 $\frac{1}{4}$  S25  
 $\frac{1}{4}$  S36 CC  
 1917

from which

A pine, 12 ins. diam., bears N.54°E., 246 lks. dist., marked C C T 2 S R 34 E S 25 B T.

This portion of the township lies on the summit of the Blue Mountains. The soil is light volcanic ash, very shallow over basalt and is good for grazing. It is nearly all timbered with scattering yellow pine, fir, tamarack and balsam, not of commercial value. The land is principally valuable for grazing. There are no settlers.

Oct. 18, 1917.

L. E. Wilkes.  
U. S. Surveyor

---

For Final Certificate of U. S. Surveyor, see Book "C"

---

APPROVAL

Office of U. S. Surveyor General,  
Portland, Oregon, August 26, 1918.

The foregoing field notes of the Retracement Portion East Bdy., Retracement and Resurvey Portion South Bdy., Retracement Portion West Bdy. and Retracement and Survey Portion Subdivisional Lines in Township No. 2 South, Range No. 34 East of the Willamette Meridian, Oregon, executed by L. E. Wilkes, U. S. Surveyor, under his special instructions dated April 18, 1917, having been critically examined, and the necessary corrections and explanations made, the said field notes, and the surveys they describe, are hereby approved.

Edward J. Wells  
U. S. Surveyor General