

FIELD NOTES

Of the survey of the *Exterior and Subdivisional*

Lines of *Township 2 South,*

Range 33 East, Willamette Meridian,

Oregon, as surveyed by *John C. Arnold*

U. S. Deputy Surveyor, under his Contract No. *551.*

dated *March 19th* 18*90*

Survey commenced, *September 17th* 18*90*

Survey completed, *September 28th* 18*91*

NAMES AND DUTIES OF ASSISTANTS,

....., Compassman.

Edgar R. Thomson, Chainman.

Jacob C. Hill, Chainman.

....., Chainman.

....., Chainman.

James P. Caffrey, Axeman.

Ellsworth B. Hall, Axeman.

Moses H. Thompson, Flagman.

PRELIMINARY OATHS OF ASSISTANTS.

We, Moses H. Thompson Edgar R. Thomson ^{and} Silas D. Morgan

do solemnly swear that we will faithfully execute the duties of Chain Carriers, that we will level the chain over even and uneven ground, and plumb the tally pins, either by sticking or dropping the same; that we will report the true distance to all notable objects, and the true length of all lines that we will assist in measuring, to the best of our skill and ability, and in accordance with the instructions given us in

the survey of the subdivisional and exterior
lines of T. 2 South

R 33 East, Willamette Meridian, Oregon.

Moses H. Thompson, Chainman.

Edgar R. Thomson, Chainman.

Silas D. Morgan, Chainman.

_____, Chainman.

Subscribed and sworn to before me, this Sixth

day of September 1890

W.M. Pierce, County Clerk

[SEAL.]

By J.E. Beam Deputy

We, Jacob C. Hill, Ellsworth B. Hall and

James P. Caffrey, do solemnly swear that we will well and truly perform the duties of Axemen in the establishment of corners and other duties, according to instructions given us, and to the best of our skill and abil-

ity, in the survey of the subdivisional and exterior
lines of T. 2 South R 33 East. Willamette Meridian, Oregon.

Jacob C. Hill, Axeman.

James P. Caffrey, Axeman.

Axeman

Subscribed and sworn to before me, this Sixth

day of September 1890

W.M. Pierce County Clerk

[SEAL.]

By J.E. Beam Deputy

INDEX A

Referring the Lines to the Pages of the Field Notes.

T. 2 South R. 33 East Will. Mer.

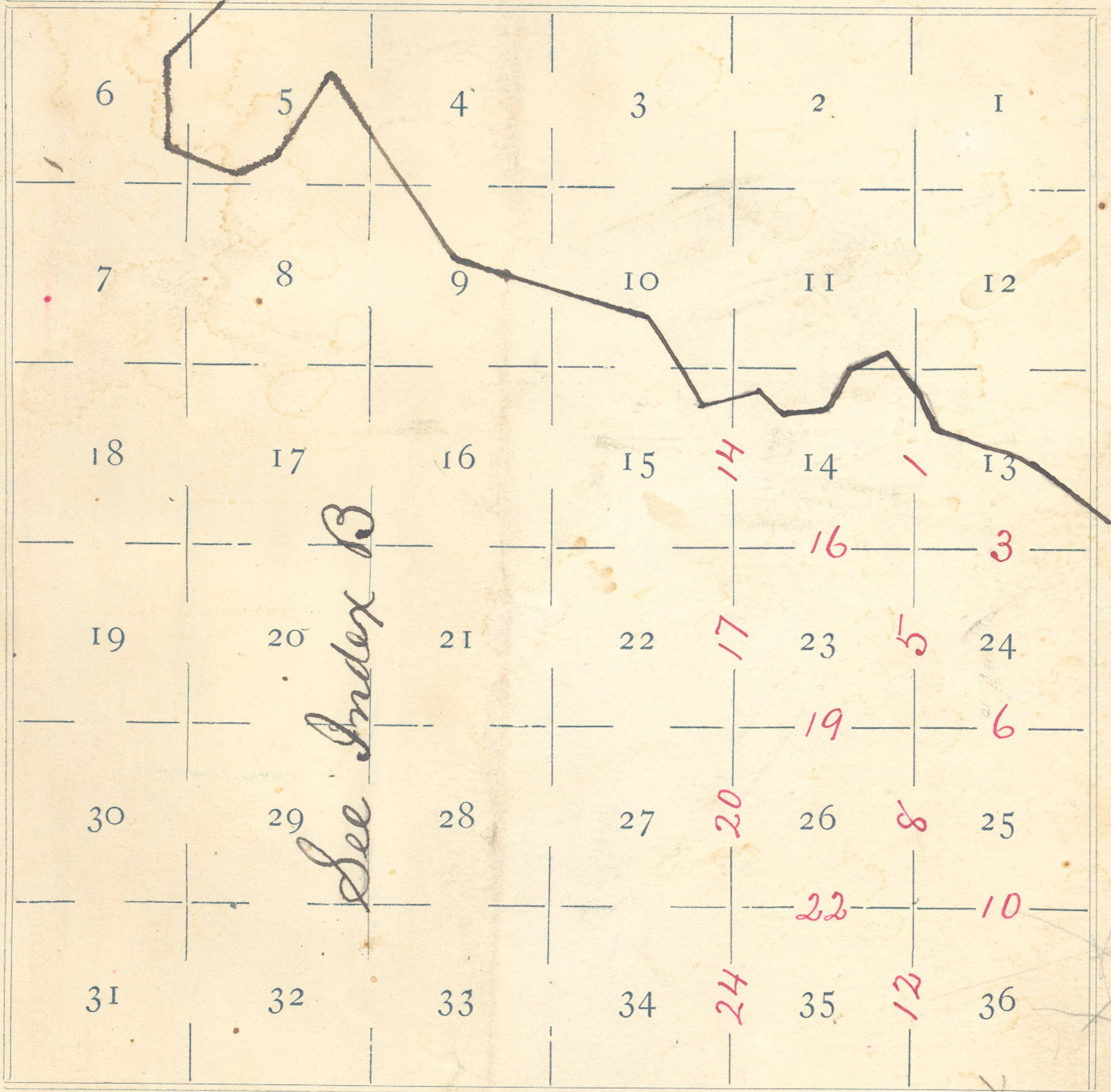

Meanders of _____ Pages _____ to _____

Meanders of _____ Pages _____ to _____

FIELD NOTES

Of the survey of the *Exterior and Subdivisional*
 Lines of *Township 2 South*
Range 33 East Willamette Meridian,
 Oregon, as surveyed by *Jno. C. Arnold*,
 U. S. Deputy Surveyor, under his Contract No. *551*,
 dated *March 19*" 1890

Survey commenced *September 17*" 1890
 Survey completed *September 28* 1891

NAMES AND DUTIES OF ASSISTANTS.

- George E. Waggoner*, Compassman.
- Jacob C. Hill*, Chainman.
-, Chainman.
- Clarence A. Hall*, Chainman.
-, Chainman.
-, Axeman.
- Isaac W. Kimball*, Axeman.
-, Flagman.

140A

PRELIMINARY OATHS OF ASSISTANTS.

We, *Jacob C Hill and Clarence A Hall*

do solemnly swear that we will faithfully execute the duties of Chain Carriers; that we will level the chain over even and uneven ground, and plumb the tally pins, either by sticking or dropping the same; that we will report the true distance to all notable objects, and the true length of all lines that we will assist in measuring, to the best of our skill and ability, and in accordance with the instructions given us in the survey of the.....

Exterior and Subdivisional
.....lines of *Township 2 South*
Range 33 East.....Willamette Meridian, Oregon.

Clarence A Hall, Chainman.
Jacob C Hill, Chainman.
....., Chainman.
....., Chainman.

Subscribed and sworn to before me, this *fourteenth*
day of *September*.....189*1*.....

[SEAL.]

W M Pierce
County Clerk

We, *J Isaac W. Kimball*.....and

.....do solemnly swear that we will well and truly perform the duties of Axemen in the establishment of corners and other duties, according to instructions given ~~me~~ and to the best of ~~our~~ skill and

ability, in the survey of the *Exterior and Subdivisional lines*
of Township 2 South Range 33 East.....Willamette Meridian, Oregon.

J. W. Kimball, Axeman.
....., Axeman.

Subscribed and sworn to before me, this *fourteenth*
day of *September*.....189*1*.....

[SEAL.]

W M Pierce
County Clerk

INDEX B.

Referring the Lines to the Pages of the Field Notes.

T. *2 South* R. *33 East* Will. Mer.

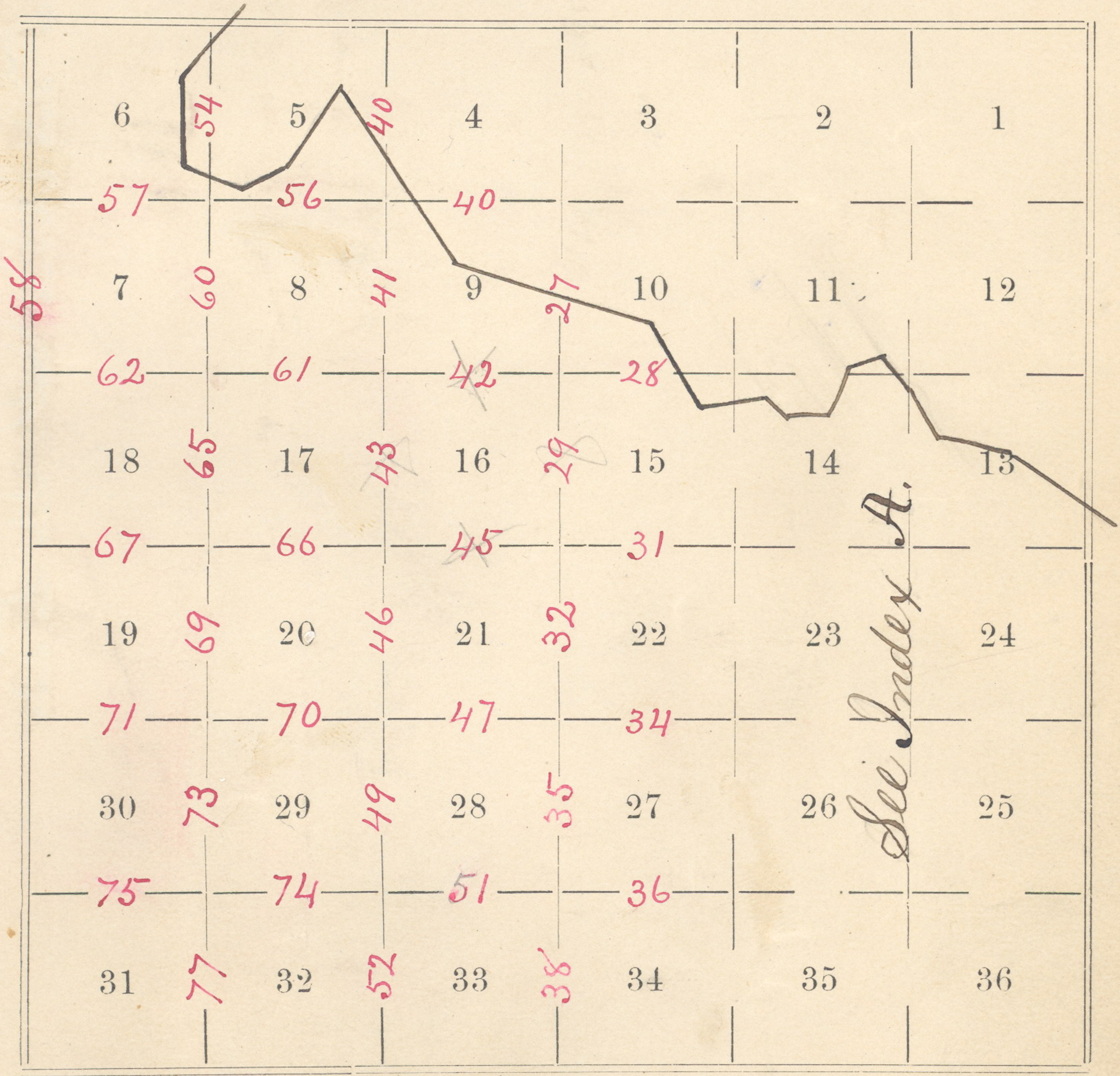

Meanders of Pages to

Meanders of Pages to

Subdivisions of T. 2 South R. 33 East

Willamette Meridian, Oregon.

a pine, 50 ins. in dia. bears, uphill,
 NE 197 lks. dist., marked T2SR33E
 S13 BT. A pine 40 ins. dia, bears
 S 70° W. in cañon 250 lks. dist., mar-
 ked T2SR33E S23 BT. - No other trees
 in limits. A basalt stone, in place,
 17x17x17 ^{ins} links above ground, bears
 SE, in cor. sec. 24, distant 33 lks.
 Sand mtns. + stony 76.17 chs.
 Scattering timber, pine + fir in the
 cañons. Good grass. Soil 4" rate.
 Sep. 17. 1890.

East on a random line bet. secs 13 + 24.

va. 20° 00' E.

40.00 Set temp. 1/4 sec. cor.

80.36 Int. E. bndy. of the Tp. 71 lks. south
 of cor. to secs. 13-18-19-24, which is a
 basalt stone 12x8x5 ins. in md. of
 stone 1 ft. h. x 2 ft. b., and marked 3
 notches on N. and 3 notches on S. face,

44

Subdivisions of T. 2 South R. 33 East

Willamette Meridian, Oregon.

(8093-10 M.)

on S. W. hill side.

Thence, I run,

S. $89^{\circ}30'W$ on true line bet. secs. 13 + 24.ra. $19^{\circ}30'E$.

Descend.

18.36 Deep cañon, course S. W. Ascend-500.

32.80 Sum. of ridge falls S. W. Descend.

40.18 Set a basalt stone $12 \times 8 \times 6$ ins. 8 ins. in ground for $\frac{1}{4}$ sec. cor., marked $\frac{1}{4}$ on N. face; dug pits $18 \times 18 \times 12$ ins. E. + W. of stone $5\frac{1}{2}$ ft. dist., and raised $\frac{1}{2}$ rd. of earth and stone 3 ft. h. \times 4 ft. b. around cor., on hill side facing west.

46.70 Cañon course S. W. Ascend.

72.36 Summit Descend + 750'

80.36 The cor. to secs. 13-14-23-24.

Land mountainous, 80.36 chs.

Some grass, mostly on west slopes.

Soil 4" rate.

Sep. 20, 1890.

Subdivisions of T. 2 South R. 33 East

Willamette Meridian, Oregon.

South bet. secs. 23 + 24.

va. $20^{\circ}00' E$.

Ascend.

3.83 Summit.

Descend.

17.00 Wagon Road, bears E. + W.

17.75 N. Fork of Birch Creek, 20 lks. wide runs west.

Enter timber. Ascend steep stony mtn - 800'

20.75 Leave "

25.75 Enter "

40.00 Set a basalt stone $18 \times 8 \times 6$ ins. 12 ins. in ground for $\frac{1}{4}$ sec. cor., marked $\frac{1}{4}$ on W. face, and raised mid. of stone 2 ft. h. \times 4 ft. b. over cor.; pits impracticable.

50.00 Leave timber.

52.00 Summit.

Descend.

61.00 Spring bears west 50 lks. dist.

80.00 A basalt stone, in place, $24 \times 12 \times 12$ ins. above ground, for cor. to secs. 23-24-25-26. marked 4 notches on N. and 2 notches on E. edges, + at exact cor. point, in a brushy ravine course west

Subdivisions of T. 2 South R. 33 East
Willamette Meridian, Oregon.

(8093-10 M.)

from which a willow 4 ins. dia. bears
S. 70° E. 17 lks. dist., marked T2SR33ES
25 BT. A willow 3 1/2 ins. dia. bears S. 15° W.
17 lks. dist., marked T2SR33ES 26 BT.
A willow 3 ins. dia. bears N. 15° W. 10 lks.
dist., marked T2SR33ES 23 BT.

No other tree in limits. *

Land mountainous & stony 80.00 chs

Timber pine, fir & larch 27.25 chs.,

Undergrowth same as timber. Soil 4" R.

* Indiv. Ind. of stone 1 1/2 ft. h x 3 1/2 ft. b. in sec. 24, 5 1/2 ft. dist.

East on a random line bet secs. 24 & 25

ba. 20° 15' E.

Ascend 22 chs.

40.00 Set temp. 1/4 sec. cor.

79.60 Int. E. body. of Sp. 30 lks. N. of cor. to
secs. 19-24-25-30, which is a basalt
stone 12 x 8 x 6 ins. 8 ins. in ground,
marked 4 notches on N., and 2 notches

Subdivisions of T. 2 South R. 33 East

Willamette Meridian, Oregon.

on S. in md. of stone 2 ft. h. x 2½ ft. b.
on S. hill side.

Thence Iron,

N 89° 47' W. on true line bet. secs 24 & 25.

va. 19° 30' E.

Ascend.

5.00 Summit - Descend steep & stony.

24.60 Enter timber.

28.60 Wagon Road bears N.W. & S.E.

29.30 Birch Creek 20 lks. wide runs N.W.

Ascend steep mountain, through
brush and timber.

39.80 Set a basalt stone 18 x 12 x 8 ins. 12
ins. in ground for ¼ sec. cor., mar-
ked ¼ on N. face; dug pits 18 x 18 x 12
ins. E. & W. of stone ½ ft. dist, and
raised md. of earth 2 ft. h. x 4 ft. b.
over cor., from which a fir, 8 ins. dia.
bears N. 15 lks. dist., marked ¼ S.B.S.
A fir 10 ins. dia. bears S. 26 lks. dist,

181 150

Subdivisions of T. 2 South R. 33 East

Willamette Meridian, Oregon.

(8093-10 M.)

Sand Matus. Soil stony, 4" rate.
 Timber, in canons, pine, fir & larch
 with undergrowth of same 35chs.
 The whole line runs over Matus. land.
 Good grass on N. slopes.

East on a random line bet. pces 25 & 36.

Pa. $24^{\circ} 15' E$.

Descend.

40.00 Set temp $\frac{1}{4}$ sec. cor.

80.05 Int E. body of Sp. 62 links north
 of cor. to pces. 25-30-31-36, which
 is a basalt stone $14 \times 12 \times 3$ ins., in
 md. of stone $1\frac{1}{2}$ ft. h. \times $2\frac{1}{2}$ ft. b., on gen-
 tle E. slope, and marked 5 notches
 on N. and 1 notch on S. face, from
 which a pine 18 ins dia bears $N. 20^{\circ} E$,
 132 lks. dist, marked T2SR34ES30B5.
 A fir 20 ins. dia. bears $S. 52^{\circ} E$. 35 lks.

Subdivisions of T. 2 South R. 33 East.

Willamette Meridian, Oregon.

dist., marked S 31 B.T. - A pine, 20 ins. dia.
 bears S. 42° W. 62 lks. dist., marked R 33 E
 S 36 B.T. - A pine 30 ins. dia. bears N. 85° W.
 86 lks. dist., marked S 25 B.T.
 Thence I run,

va. 23° 30' E.

Ascend through timber.

N. 89° 33' W. on true line bet. pces. 25 + 36.

5.05 Wagon road bears NE + SW.

20.05 Leave timber.

40.02 Set a basalt stone 16 x 13 x 3 ins., mar-
 ked 14 on n. face. As digging at this
 point is impracticable, I made a
 nd of stone 4 ft. h. x 5 ft. b. over the
 cor. stone, on summit of mtn.
 Descend.

45.05 Enter timber.

76.05 Birch creek, 15 lks. wide runs N.

80.05 The cor. to pces 25-26-35-36.

Sand mountainous throughout this
 line 80.05 chs

Bk. 227

230

FINAL OATHS FOR SURVEYS.

A list of the names of the individuals employed by Jno. C. Arnold, U. S. Deputy Surveyor, to assist in running, measuring and marking the lines and corners described in the foregoing field notes of the survey of the Exterior and subdivisinal lines of Township 2 South, Range 33 East Willamette Meridian, Oregon, showing the respective capacities in which they acted:

- George E. Waggoner, Compassman.
- Jacob C. Hill, Chainman.
- Clarence A. Hall, Chainman.
-, Chainman.
-, Chainman.
- Isaac W. Kimball, Axeman.
-, Axeman.
-, Flagman.

FINAL OATHS OF ASSISTANTS.

We hereby certify that we assisted Jno. C. Arnold, U. S. Deputy Surveyor, in surveying all those parts or portions of the Exterior and subdivisinal lines of Township 2 South, Range 33 East Willamette Meridian, Oregon,

as are represented in the foregoing field notes as having been surveyed by him and under his direction; and that said survey has been in all respects, to the best of our knowledge and belief, well and faithfully surveyed, and the corner monuments established, according to the instructions furnished by the U. S. Surveyor General of Oregon.

- G. E. Waggoner, Compassman.
- Jacob C. Hill, Chainman.
- Clarence A. Hall, Chainman.
-, Chainman.
-, Chainman.
- I. W. Kimball, Axeman.
-, Axeman.
-, Flagman.

Subscribed and sworn to before me, this sixth day of October 1897

[SEAL.]

W. M. Pierce
County Clerk

FINAL OATH OF DEPUTY SURVEYOR.

I, John C. Arnold
United States Deputy Surveyor, do solemnly swear that in pursuance of

instructions received from Douglas W. Taylor

U. S. Surveyor General for Oregon, bearing date of Nineteenth

day of March 29 1890...

I have well, faithfully and truly, in my own proper person, and in strict conformity with the instructions furnished by the U. S. Surveyor General for Oregon, the Surveying Manual, and the laws of the United States, surveying all those

parts or portions of The Exterior and Subdivisional

lines of Township 2 South, Range 33 East,

Willamette Meridian, in the State of Oregon, as are represented in the foregoing field notes as having been surveyed by me and under my directions; and I do further solemnly swear that all the corners of said survey have been established and perpetuated in strict accordance with the Surveying Manual, printed instructions, the special written instructions of the U. S. Surveyor General for Oregon, and in the specific manner described in the field notes, and that the foregoing are the *true* field notes of such survey, and should any fraud be detected I will suffer the penalty of perjury under the provisions of an Act of Congress approved August 8, 1846.

John C. Arnold
U. S. Deputy Surveyor.

Subscribed and sworn to before me, this sixth

day of October 1891...

W M Pierce
County Clerk

234

FINAL OATHS FOR SURVEYS.

A list of the names of the individua's employed by John C. Arnold, U. S. Deputy Surveyor, to assist in running, measuring and marking the lines and corners described in the foregoing field notes of the survey of the subdivision and Exterior lines of Township No 2 South of Range No 33 East of Williamette Meridian, Oregon, showing the respective capacities in which they acted:

-, Compassman.
- Edgar R. Thomson....., Chainman.
- Jacob C. Still....., Chainman.
-, Chainman.
-, Chainman.
- James P. Caffrey....., Axeman.
- Ellsworth B. Hall....., Axeman.
- Moses H. Thomson....., Flagman.

FINAL OATHS OF ASSISTANTS.

We hereby certify that we assisted John C. Arnold, U. S. Deputy Surveyor, in surveying all those parts or portions of the Exterior and subdivisional lines of T 2 South R 33 East, Williamette Meridian, Oregon.

as are represented in the foregoing field notes as having been surveyed by him and under his direction; and that said survey has been in all respects, to the best of our knowledge and belief, well and faithfully surveyed, and the corner monuments established, according to the instructions furnished by the U. S. Surveyor General of Oregon.

-, Compassman.
- Jacob C. Still....., Chainman.
- Moses H. Thomson....., Chainman ~~Flagman~~
- Edgar R. Thomson....., Chainman.
-, Chainman
- James P. Caffrey....., Axeman.
- Ellsworth B. Hall....., Axeman.
-, Flagman.

Subscribed and sworn to before me, this third day of October 18 90

[SEAL.] Wm. Pierce County Clerk
By J. O. Beaman Deputy

Pages 232 & 233
are BLANK

235

FINAL OATH OF DEPUTY SURVEYOR.

I, _____
United States Deputy Surveyor, do solemnly swear that in pursuance of
instructions received from _____

U. S. Surveyor General for Oregon, bearing date of the _____

day of _____ 188___, I have well, faith-
fully and truly, in my own proper person, and in strict conformity with
the instructions furnished by the U. S. Surveyor General for Oregon, the
Surveying Manual, and the laws of the United States, surveying all those

parts or portions of _____

Willamette Meridian, in the State of Oregon, as are represented in the
foregoing field notes as having been surveyed by me and under my direc-
tions; and I do further solemnly swear that all the corners of said survey
have been established and perpetuated in strict accordance with the Sur-
veying Manual, printed instructions, the special written instructions of
the U. S. Surveyor General for Oregon, and in the specific manner de-
scribed in the field notes, and that the foregoing are the *true* field notes of
such survey, and should any fraud be detected I will suffer the penalty of
perjury under the provisions of an Act of Congress approved August 8,
1846.

U. S. Deputy Surveyor.

Subscribed and sworn to before me, this _____

day of _____ 188___

Office U. S. Surveyor General,Portland, Oregon, *September 20,* 1892The ^{foregoing} ~~following~~ Field Notes of the Survey of the*the subdivisinal lines of Township
No 2 South, Range No 33 East Willamette
Meridian Oregon*executed by *John C. Arnold U. S. Dept Sur.*under his Contract No. *551*, dated *March 19,**1890*, having been critically examined, the
necessary corrections and explanations made, the said Field Notes
and the survey they describe, are hereby approved.*W. Henry Byars*
Surveyor General.