

3948

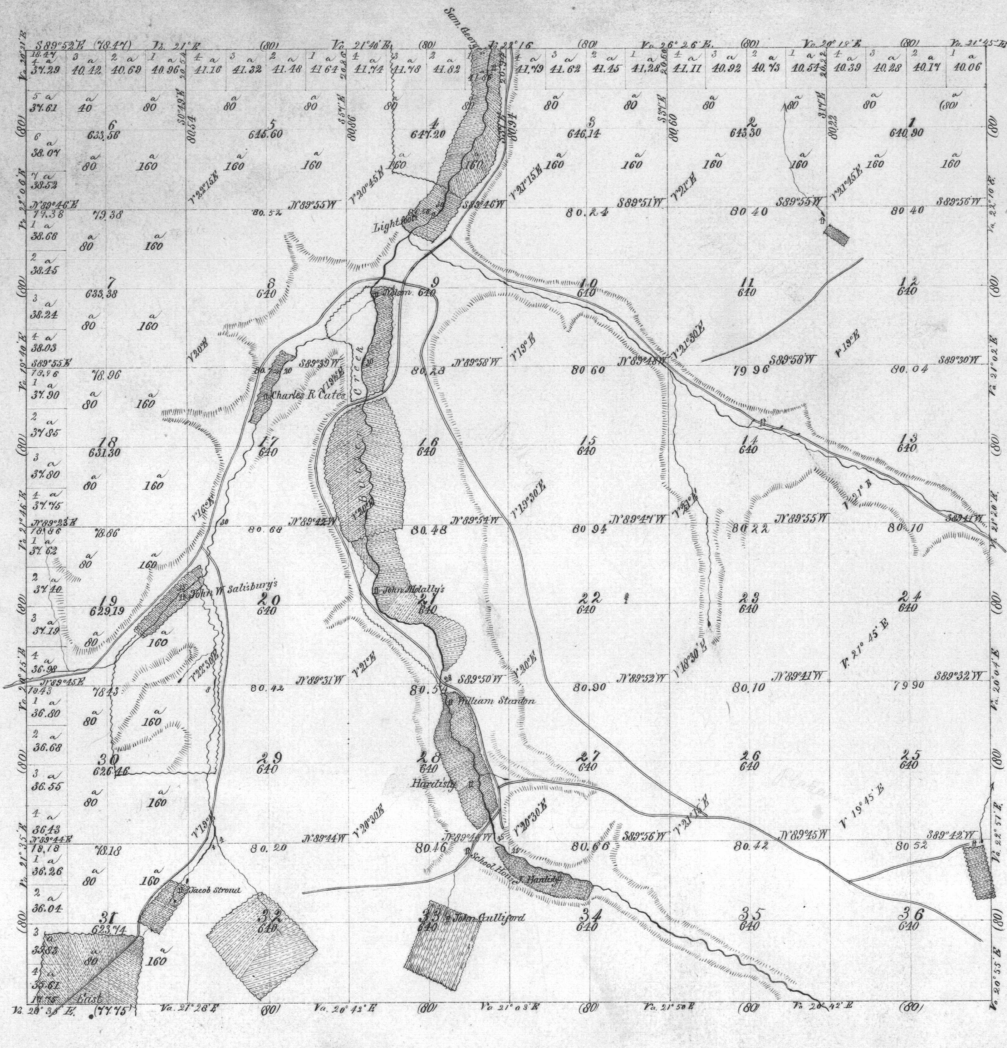

General Description
 This Township is prairie and has heretofore been classed as grazing lands but from recent trials, the larger part may be classed as agricultural. South hillsides are generally very clayey with hillsides and plateaus are free from stones and are deep rich soil and produce wheat and other grains. The surface is considerably broken by springs and brooks, and is well watered by springs and brooks.
 Grains and vegetables are raised in abundance for local use, for export and stock are only profitable at present.

Total Acres 23000.77

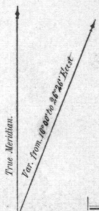

Scale 40 Chains to an inch.

Lines.	Contractor.	Contract.		Amount Surveyed.			Commenced.	Completed.
		No.	Date.	Miles.	Chains.	Links.		
Subdivisions	George S. Perkins	235	Aug. 12 th 1878	60	07	25	Sept 2 nd 1878	Sept 11 th 1878
Escheators		152	June 6 th 1878					

The above Map of the subdivisional lines of Township No. 2 South Range No. 30 East Willamette Meridian, Oregon, is strictly conformable to the original field notes of the survey thereof on file in this office, which have been examined and approved.
 U. S. Surveyor General's Office,
 Portland, Oregon,
 September 25, 1878
James C. Selman
 Surveyor General of Oregon.