

FIELD NOTES

165

Of the survey of the

Exterior

Lines of

*the diminished Umatilla
Reservation*

Willamette Meridian,

Oregon, as surveyed by

*Jas. G. Carrin &
Geo. E. Poland*

U. S. Deputy Surveyor, under his Contract No.

dated

May 4th 188*8* *1887* ✓

Survey commenced,

Oct 24th

188*7*

Survey completed,

November 4th

188*7*

NAMES AND DUTIES OF ASSISTANTS,

<i>L. J. Woolley</i>	, Compassman.
<i>E. L. Perry</i>	, Chainman.
<i>Guy Davis</i>	, Chainman.
<i>J. R. Hadley</i>	, Chainman.
<i>C. L. Raper</i>	, Chainman.
<i>C. Moore</i>	, Axeman.
<i>J. W. Gordon</i>	, Axeman.
	, Flagman.

PRELIMINARY OATHS OF ASSISTANTS.

We, _____

G. S. Perry, Guy Davis, J. R. Madley, C. Kaper

do solemnly swear that we will faithfully execute the duties of Chain Carriers, that we will level the chain over even and uneven ground, and plumb the tally pins, either by sticking or dropping the same; that we will report the true distance to all notable objects, and the true length of all lines that we will assist in measuring, to the best of our skill and ability, and in accordance with the instructions given us in

the survey of the _____

Exterior

lines of _____

Diminished

Reservation

Willamette Meridian, Oregon.

_____, Chainman.

G. S. Perry

_____, Chainman.

Guy Davis

_____, Chainman.

J. R. Madley

_____, Chainman.

C. Kaper

Subscribed and sworn to before me, this _____

Twenty fourth

day of _____

October

188____



[SEAL.]

James E. Holand

U.S. Dept. Surveyor

We, _____

C. Moses, J. H. Stenison

and _____

do solemnly swear that we will well and truly perform the duties of Axemen in the establishment of corners and other duties, according to instructions given us, and to the best of our skill and ability,

in the survey of the _____

Exterior lines of

the Diminished Reservation Willamette Meridian, Oregon.

_____, Axeman.

C. Moses

_____, Axeman.

J. H. Stenison

Subscribed and sworn to before me, this _____

Twenty fourth

day of _____

October

188____

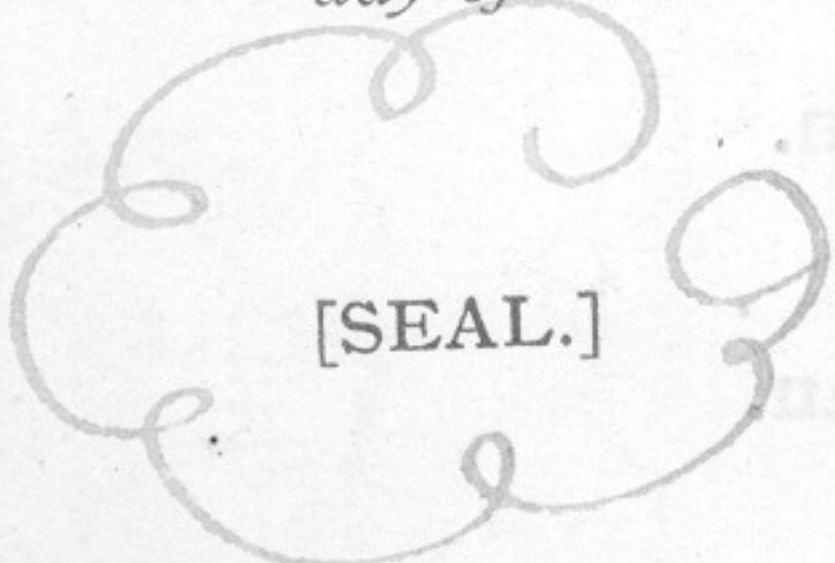

[SEAL.]

James E. Holand

U.S. Dept. Surveyor

R33E

R34E *Index*

R35E

R36E

168

T4N

169

T4N

T3N

T3N

T2N

T2N

T1N

T1N

R33E

R34E

R35E

R36E

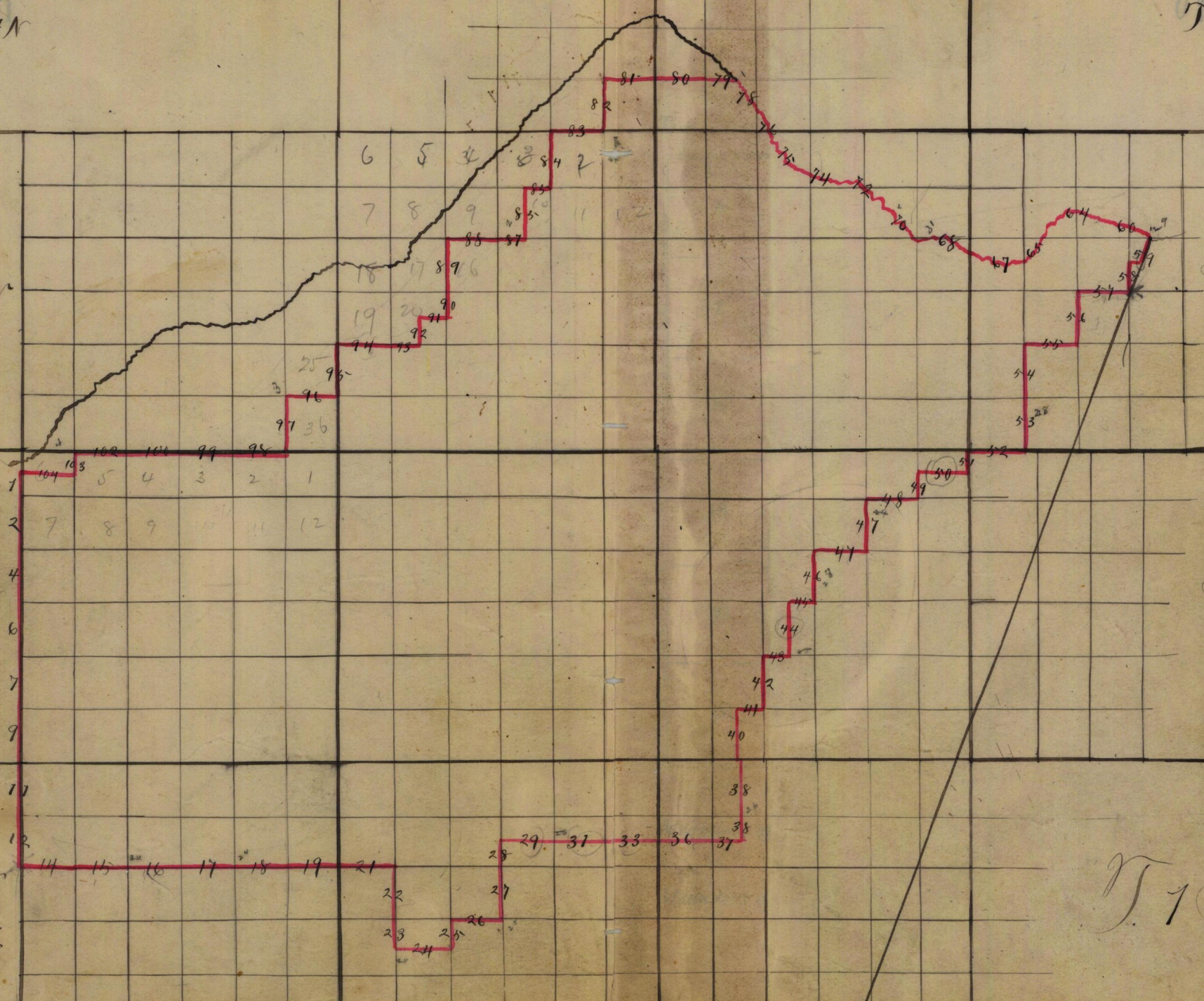

Exterior of T. Diminished R. Reservation
Willamette Meridian, Oregon.

(M 01-200)

around it
Land very rough & mountainous
79.40 chs Soil 3rd rate, good grass.

Thence North retracing Township
line bet sees 1nd & 6

Wa Wa 2 1/2 East

400 1/4 sec. cor. on E bdy sec 6, which
is a basalt stone in a mound of
stone and which I mark D.R. on
W. face.

1500 Gulch course W. 50

3320 Closing cor to Townships 2 North
Rgs 35th & 36th, which is a stone
in mound of stone and which I mark
D.R. on W. face

Land rough and mountainous
3320 chs. Soil 2nd rate and rocky.
Good grass

222
Exteriors of T. Quinnishod R. Reservation
Willamette Meridian, Oregon.

(8093-10 M.)

Thence East retracing
Township line bet sec 31^{and} 32
Tps 2^{and} 3 North R 36 East
to 18°45' E

110 Cor to Townships 3 North
Ranges 35^{and} 36 East which
is a basalt stone in mound of
stone and which I mark Q. R.
on N. face

1660 Top of ridge N 7600
Descend steep mountain side

4140 1/4 sec. cor. on S bdy sec 31
T. 3 N. R. 36 E which is a stone
in a mound of stone and marked
Q. R. on N. face

6090 Meacham creek 60 ft wide course

7090 Q. R. and Rail road course N. and S.

8140 Cor to sec 31^{and} 32 T. 3 N. R. 36 E
which is a stone in mound of
stone which I mark Q. R. on N. face
mountainous 8140 chs
land very rough, soil 2nd rate

Exterior of ~~T.~~ ^{Unfinished} R. Reservation
Willamette Meridian, Oregon.

Thence North retracing line
bet. sec. 31rd & 32

Wa 18° East

- 1000 Meacham creek 50th ^{wide} course N.E.
- 1900 Same " " " N.W.
- 2950 Same " " " N.E.

4000 1/4 Sec. cor. which is a post
set firmly in the ground which
I mark Q.R. on N.W. face, from which
A Fir 36 ins in diam. to S 85°
E dist. 20th which I mark Q.R. B.T.
A pine 30 ins in diam. to S 85°
dist 15th which I mark Q.R. B.T.

- 4450 Meacham creek 30th ^{wide} course N.W.
- 5750 Same " " " N.E.
- 6150 Same " " " N.W.

8000 Go to sec. 29, 30, 31rd & 32 which is
a post in mound of stone which I
mark Q.R. on N.W. face,
from which
A pine 16 ins diam. bears S 25° W

FINAL OATHS FOR SURVEYS.

A list of the names of the individuals employed by James P. Carrin
and James C. Roland, U. S. Deputy Surveyor, to assist in
 running, measuring and marking the lines and corners described in the foregoing field
 notes of the survey of the Exterior
Umatilla Reservation lines of the Diminished
Willamette Meridian, Oregon,
 showing the respective capacities in which they acted:

- L. J. Woolley, Compassman.
- E. G. Perry, Chainman.
- Guy Davis, Chainman.
- J. R. Hadley, Chainman.
- C. Kaper, Chainman.
- H. Moore, Axeman.
- J. H. Henderson, Axeman.
- _____, Flagman.

FINAL OATHS OF ASSISTANTS.

We hereby certify that we assisted James P. Carrin and
James C. Roland, U. S. Deputy Surveyor, in surveying all
 those parts or portions of the Exterior
lines of the Diminished
Umatilla Reservation Willamette Meridian, Oregon,
 as are represented in the foregoing field notes as having been surveyed by him and under
 his direction; and that said survey has been in all respects, to the best of our knowledge
 and belief, well and faithfully surveyed, and the corner monuments established, according
 to the instructions furnished by the U. S. Surveyor General of Oregon.

- L. J. Woolley, Compassman.
- E. G. Perry, Chainman.
- Guy Davis, Chainman.
- J. R. Hadley, Chainman.
- C. Kaper, Chainman.
- H. Moore, Axeman.
- J. H. Henderson, Axeman.
- _____, Flagman.

Subscribed and sworn to before me, this fourth day of

November 1887
 [SEAL.] James C. Roland
U. S. Deputy Surveyor

FINAL OATH OF DEPUTY SURVEYORS

We James P. Currier and James E. Holand
United States Deputy Surveyors, do solemnly swear that in pursuance of

instructions received from Douglas H. Taylor

U. S. Surveyor General for Oregon, bearing date of the 20th

day of August 1888, I have well, faith-

fully and truly, in my own proper person, and in strict conformity with the instructions furnished by the U. S. Surveyor General for Oregon, the Surveying Manual, and the laws of the United States, surveying all those

parts or portions of the Exterior bdy. of the Diminished Reservation

Willamette Meridian, in the State of Oregon, as are represented in the foregoing field notes as having been surveyed by me and under my directions; and I do further solemnly swear that all the corners of said survey have been established and perpetuated in strict accordance with the Surveying Manual, printed instructions, the special written instructions of the U. S. Surveyor General for Oregon, and in the specific manner described in the field notes, and that the foregoing are the true field notes of such survey, and should any fraud be detected I will suffer the penalty of perjury under the provisions of an Act of Congress approved August 8, 1846.

James P. Currier, James E. Holand
U. S. Deputy Surveyors

Subscribed and sworn to before me, this 23rd

day of February 1888

Allen Woodcock
Notary Public
for Oregon



Office U. S. Surveyor General,

Portland, Oregon, October 6th - 1888

foregoing
The ~~following~~ Field Notes of the Survey of the _____

*of the Boundary Lines
of the Diminished _____*

*Unatilla Indian
Reservation Oregon*
executed by *James P. Curran and James O. Nolan*
Special U. S. Dept. Surveyors.
under ~~his~~ ^{joint} Contract No. _____, dated *May 4*

_____ 188 ~~7~~, having been critically examined, the
necessary corrections and explanations made, the said Field Notes
and the survey they describe, are hereby approved.

Douglas W. Taylor -
Surveyor General.