

FIELD NOTES

165

Of the survey of the

Exterior

Lines of

*the diminished Umatilla
Reservation*

Willamette Meridian,

Oregon, as surveyed by

*Jas. G. Carrin &
Geo. E. Poland*

U. S. Deputy Surveyor, under his Contract No.

dated

May 4th 188*8* *1887* ✓

Survey commenced,

Oct 24th

188*7*

Survey completed,

November 4th

188*7*

NAMES AND DUTIES OF ASSISTANTS,

| | |
|----------------------|---------------|
| <i>L. J. Woolley</i> | , Compassman. |
| <i>E. L. Perry</i> | , Chainman. |
| <i>Guy Davis</i> | , Chainman. |
| <i>J. R. Hadley</i> | , Chainman. |
| <i>C. L. Raper</i> | , Chainman. |
| <i>C. Moore</i> | , Axeman. |
| <i>J. W. Gordon</i> | , Axeman. |
| | , Flagman. |

PRELIMINARY OATHS OF ASSISTANTS.

We, _____

G. S. Perry, Guy Davis, J. R. Madley, C. Kaper

do solemnly swear that we will faithfully execute the duties of Chain Carriers, that we will level the chain over even and uneven ground, and plumb the tally pins, either by sticking or dropping the same; that we will report the true distance to all notable objects, and the true length of all lines that we will assist in measuring, to the best of our skill and ability, and in accordance with the instructions given us in

the survey of the _____

Exterior

lines of _____

Diminished

Reservation

Willamette Meridian, Oregon.

_____, Chainman.

G. S. Perry

_____, Chainman.

Guy Davis

_____, Chainman.

J. R. Madley

_____, Chainman.

C. Kaper

Subscribed and sworn to before me, this _____

Twenty fourth

day of _____

October

188____



[SEAL.]

James E. Holand

U.S. Dept. Surveyor

We, _____

C. Moses, J. H. Stenson

and _____

do solemnly swear that we will well and truly perform the duties of Axemen in the establishment of corners and other duties, according to instructions given us, and to the best of our skill and ability,

in the survey of the _____

Exterior lines of

the Diminished Reservation

Willamette Meridian, Oregon.

_____, Axeman.

C. Moses

_____, Axeman.

J. H. Stenson

Subscribed and sworn to before me, this _____

Twenty fourth

day of _____

October

188____

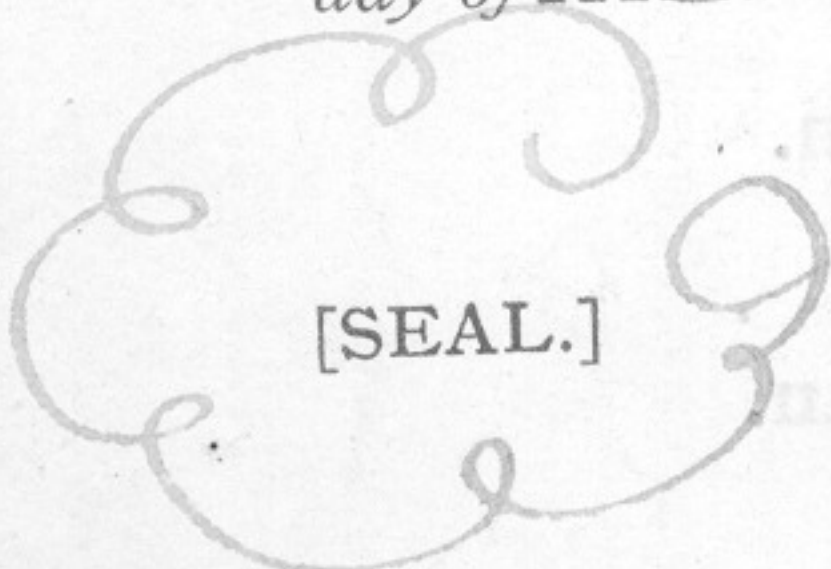

[SEAL.]

James E. Holand

U.S. Dept. Surveyor

R33E

R34E *Index*

R35E

R36E

168

T4N

169

T4N

T3N

T3N

T2N

T2N

T1N

T1N

R33E

R34E

R35E

R36E

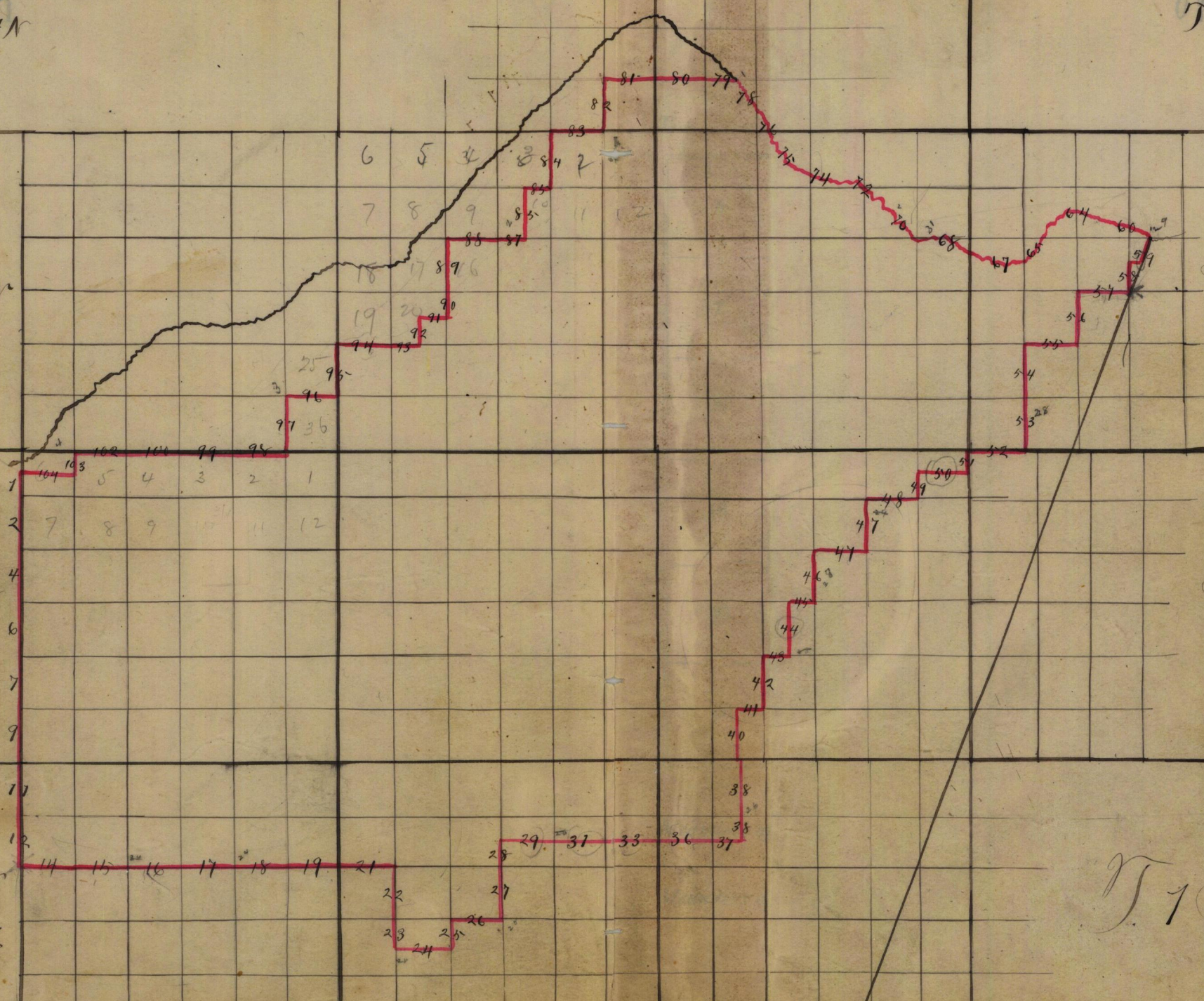

Exterior of T. Diminished R. Reservation
Willamette Meridian, Oregon.

- 100 lbs dist which I mark Q. R. B.T.
- 1315 T. Ruddleton Red Sag Grande wagon road, course N. W.
- 3485 Old Stage road bears N. W.
- 4000 Set post 3 ft long 3 ins square 24 ins in the ground, for $\frac{1}{4}$ sec. cor. marked $\frac{1}{4}$ S. Q. R. on W. face from which a pine 6 ins. diam. bears S 5° E 5 lbs. dist. marked $\frac{1}{4}$ S. Q. R. B.T.
- A pine 10 ins. diam. bears N 55° E 24 lbs. dist. marked $\frac{1}{4}$ S. Q. R. B.T.
- 8020 Intersect N. bdy Township 380 lbs E of $\frac{1}{4}$ sec. cor. on S bdy sec 32. T. 2 N. R. 35 E. and set post 3 ft. long, 3 ins. square, 24 ins in the ground, for $\frac{1}{4}$ sec. closing cor. marked C. on S. Red Q. R. $\frac{1}{4}$ S. on W. face from which a pine 20 ins. diam. bears S 40° E 39 lbs. dist.

Exterior of T. Diminished R. Reservation
Willamette Meridian, Oregon.

(8093-10 M.)

marked C. C. $\frac{1}{4}$ S. E. R. B. T.

A pine 16 ins. diam bears $S. 65^{\circ} W.$

99 lbs. dist marked Q. R. C. C. $\frac{1}{4}$ S. B. T.

Land level Soil 1st rate

Scattering pine timber

Oct-26-1887

Thence West on Sp. line

380 to $\frac{1}{4}$ sec. cor. S. bdy, sec. 32.

which is a post set firmly
in the ground which I mark

Q. R. on W face from which

A pine 10 ins. diam. bears $S. 90^{\circ} W.$

142 lbs. dist which I mark Q. R. B. T.

A pine 16 ins. diam bears $N. 47^{\circ} W.$

197 lbs. dist. which I mark Q. R. B. T.

Land level. Soil 1st rate. scattering pine timber -

Thence North on random

through center of sec 32

T. 2 N. R. 3 E. Q.

Bear $20\frac{1}{4}^{\circ}$ East

4000 Set temporary $\frac{1}{4}$ sec. cor. and at

Interior of T. Diminished R. Reservation
Willamette Meridian, Oregon.

(M O)

8000 Intersect N. bdy at 1/4 sec. cor.
 Thence S on true line
 4000 Set basalt stone 14 x 12 x 8 ins
 9 ins in the ground for 1/4 sec cor
 marked 1/4 S. Q. R. on N. face
 and raised mound of stone over it
 5150 canyon course. N. -100
 8000 To point of beginning
 land rolling
 Soil 1st rate
 Good grass
 Scattering Pine timber
 Commencing at 1/4 sec. cor.
 on N. bdy sec 32 which is
 a basalt stone in mound
 of stone which I mark on
 N. face Q. R. Thence
 N 89° 51' East retracing line
 bet secs 29 and 32
 700 Summit of Ridge bears N. +100

212

Extremities of T. Diminished R. Reservation
 Willamette Meridian, Oregon.

(8093-10 M.)

| | | |
|------|-----------------------|------|
| 1500 | Ravin course N | -100 |
| 2400 | Lagon. course N. | -50 |
| 2700 | Top of ridge course N | +100 |
| 2900 | Gulch course N. | -100 |

4006 Cor to sec 28, 29, 32 and 33
 which is a basalt stone
 in mound of stone and which
 I mark D. R. on N.W. face.
 Land extremely rough and
 mountainous 4006 Soil good rate
 No timber except
 in canons.

Three North retracing line
 bet sec 28 and 29

Pa. 19° East

| | | |
|------|-----------------------------------------------------------------------------------------|------|
| 2700 | Summit of ridge course N. E. | +600 |
| 3700 | Branch in canon course N. | -350 |
| | Ascend | |
| 4000 | A stone in mound of stone for $\frac{1}{4}$ sec. cor. which I mark D. R. on W. face. | |

Exterior of T. Quinnish R. Reservation
Willamette Meridian, Oregon.

Ascend

5000 Top of mountain + 800

Descend

7550 Gulch, dry - 100

8000 Cor. to sec 20, 21, 28 and 29 which is a basalt stone in mound of stone, and which I marked

D.R. on N.W. face, 8000 chs. Sand ~~mountain~~ Soil 4th rate Scattering pine timber

Thence S. 89 48' East retracing line bet sec 21 and 28

to 21 East

3200 Old Wagon road course N.W.

4000 1/4 sec. cor. which is a stone in mound of stone and mark it D.R. on N. face from which

A pine 12 ins. diam. bears N. 54° W. 584 lbs dist which I mark D.R. 13 D Sand ~~mountain~~ 40 chs. Soil 2nd rate T. rocky

214

Exterior of T. Quinnick R. Reservoir

Willamette Meridian, Oregon.

(8093-10 M.)

| | | |
|------|------------------------------------------------------------------|-------------------------------------|
| | Thence North on ran. through center of sec 21 | |
| | | Pa 21° East. |
| 4000 | Set temporary 1/4 sec. cor. | and at |
| 8000 | 1/4 sec. cor. on N. bdy. sec 21. | |
| | Thence South on true line. | |
| 1000 | Top of ridge | + 300 |
| 2900 | Gulch | - 50 |
| 4000 | Set basalt stone 14x12x8 ins | |
| | 8 ins in the ground for 1/4 sec. cor. marked Q.R. 1/4 on N. face | |
| | and raised mound of stone 1 1/2 ft. high 3 1/2 ft base over it | |
| 4400 | Enter timber | Q. and N. |
| 4800 | Leave same | |
| 7200 | Enter timber in head of canon N.E | |
| 7600 | Leave same | |
| 8000 | To point of beginning | |
| | Land rough and mountainous | |
| | 80000 chs | Soil 4 th rate and rocky |
| | | Good grass, |

Exterior of T. ²¹⁵ ~~Diminished~~ Reservation
Willamette Meridian, Oregon.

Thence
S. 89° 39' Q. retracing line bet.
secs 16th & 21

to a 21° East

Commencing at 4 sec. cor. bet. secs.
16th & 21 which is a post set
firmly in the ground and which
I mark Q.R. on N. face
from which

A tamarack 18 ins. diam. bears N 70° E.
14 fms. dist. which I mark Q.R. B.F.

A tamarack 16 ins. diam. bears S 26° E
43 fms. dist. which I mark Q.R. B.F.

275 Gulch ^{to} lagoon N.H. - 250
Ascend

1300 Top of ridge + 250

2700 Lagoon course N. - 250
Descend

3800 Top of ridge bears N

4025 Cor. to secs. 15, 16, 21 & 22 which
is a basalt stone in mound
of stone which I mark Q.R. on N.H. face

216

Exterior of T. Diminished R. Reservation
Willamette Meridian, Oregon.

(8093-10 M.)

Land extremely rough ^{mountainous}
Soil poor rocky
Good grass

Thence North retracing
line bet sees 15th and 16th
Va 21° East

Descend mountain

2500 Canon course N. It. - 800

2600 Old Traded wagon road N. It.
Ascend

4000 1/4 Sec. cor, which is a post
set firmly in the ground
with mound of stone and
which I mark Q. R. on N. face

6000 Top of ridge course N. It.

6600 Gulch " N. It.

7000 Cor to sees 9, 10, 15th and 16th which
is a stone in mound of stone
which I mark Q. R. on N. It. face
^{mountainous 8000 chs,}
Land very rough Soil 4th rate

Exterior of ~~X~~ Quinnick R. Reservation
Willamette Meridian, Oregon.

Thence North $89^{\circ}48'$ East
retracing line bet sees. 10^{and} 15
Va $21'$ East

2775 Summit of ridge bears N. + 500

3987 A stone in mound of stone
for $\frac{1}{4}$ sec cor. which I mark
C. R. on N. face
Ascend

4680 Canon course N. - 600

7000 Summit of ridge bears N. + 800

7975 Cor to sees 10, 11, 14^{and} 15 which
is a basalt stone in mound of
stone and mark same C. R. on N. face

Land rough and mountainous
7975 chs Soil poor

Oct-27-1887

Thence North retracing line
bet sees 10^{and} 11

Va $21^{\circ}45'$ East

Ascend gradual sloping ridge

Exterior of ~~N.~~ *Diminished* R. Reservation
 Willamette Meridian, Oregon.

(8093-10 M.)

| | |
|------|------------------------------------------------------------------------------------------------------------------|
| 4000 | 1/4 Sec. cor, which is a stone in mound of stone which I mark S. R. on N. face |
| 8000 | Cor. to Secs. 2, 3 10 ^{and} 11 which is a stone in mound of stone and which I mark S. R. on N. N. face. |
| | Land gently sloping toward North Soil fair grassy |
| | Thence East on true line retracing line bet Secs 2 ^{and} 11 |
| | ba 21°45' East |
| 825 | Top of mountain + 250 |
| 3975 | 1/4 Sec. cor, which is a basalt stone in mound of stone and which I mark S. R. on N. face |
| 5625 | Enter creek bottom. |
| 5950 | Creek course N. E. + 450 |
| 6525 | Gulch course N. W. - 300 |
| 7950 | Cor. to Secs 1, 2, 11 ^{and} 12 which |

Extension of T. Fininiak's R. Reservation
Willamette Meridian, Oregon.

is a basalt stone in mound
of stone which I mark Q.R. on
N.W. face.

Land rough and mountainous
79.00 chs. Timber pine & fir in bottom
Soil good rate
Good grass

Thence North retracing line
bet lines 1st & 2

by $20\frac{3}{4}^{\circ}$ East

1270 Gulch course ~~N.E.W.~~ — 50
Ascend

4000 $\frac{1}{4}$ sec. cor which is a post set
firmly in the ground and which
I mark Q.R. on N.W. face, from which
a pine 6 ins diam bears $N 45^{\circ} E$
23 lks dist which I mark Q.R. B.S.
A pine 18 ins diam bears $N 75^{\circ} W$
106 lks dist, which I mark Q.R. B.S.
Land mountainous ^{40.00 chs} Soil good rate

Exterior of T. Quimish R. Reservation
Willamette Meridian, Oregon.

(8093-10 M.)

| | | |
|------|----------------------------------------------------------------------------------------------------------------------------------------------------------------------------------------------------------------------------------------------------|-----------------|
| | Thence East on true line through center of sec 1 | |
| | | Wa 20 1/2° East |
| 550 | Gulch course N. W. | - 50 |
| 3500 | Top of ridge bears N. W. | + 250 |
| 4000 | Set basalt stone 10 x 10 x 10 ins 6 ins in the ground for 1/4 sec. cor. marked S. R. 1/4 on N. face raised mound of stone over it | |
| 5600 | Canon course N. W. | - 100 |
| 6600 | Top of ridge bears N. W. | + 200 |
| 7300 | Gulch bears N. W. | - 100 |
| | Ascend | |
| 7940 | Intersect E. bdy of Township 4.00 chains S of 1/4 sec. cor. on N. bdy of sec 6 T. 2 N. R. 36 E. and set basalt stone 14 x 12 x 10 ins 10 ins in the ground for 1/4 sec. closing cor. marked C. C. 1/4 on N. and S. faces and raised mound of stone | |

Exterior of T. Diminished R. Reservation
Willamette Meridian, Oregon.

(M 01-100)

around it
Land very rough & mountainous
79.40 chs Soil 3rd rate, good grass.

Thence North retracing Township
line bet sees 1nd & 6

Wa Wa 2 1/2 East

400 1/4 sec. cor. on E bdy see 6, which
is a basalt stone in a mound of
stone and which I mark D.R. on
W. face.

1500 Gulch course W. - 50

3320 Closing cor to Townships 2 North
Rgs 35th & 36th, which is a stone
in mound of stone and which I mark
D.R. on W. face

Land rough and mountainous
3320 chs. Soil 2nd rate and rocky.
Good grass

FINAL OATHS FOR SURVEYS.

A list of the names of the individuals employed by James P. Carrin
and James C. Roland, U. S. Deputy Surveyor, to assist in
 running, measuring and marking the lines and corners described in the foregoing field
 notes of the survey of the Exterior
Umatilla Reservation lines of the Diminished
Willamette Meridian, Oregon,
 showing the respective capacities in which they acted:

- L. J. Woolley, Compassman.
- E. G. Perry, Chainman.
- Guy Davis, Chainman.
- J. R. Hadley, Chainman.
- C. Kaper, Chainman.
- H. Moore, Axeman.
- J. H. Henderson, Axeman.
- _____, Flagman.

FINAL OATHS OF ASSISTANTS.

We hereby certify that we assisted James P. Carrin and
James C. Roland, U. S. Deputy Surveyor, in surveying all
 those parts or portions of the Exterior
lines of the Diminished
Umatilla Reservation Willamette Meridian, Oregon,
 as are represented in the foregoing field notes as having been surveyed by him and under
 his direction; and that said survey has been in all respects, to the best of our knowledge
 and belief, well and faithfully surveyed, and the corner monuments established, according
 to the instructions furnished by the U. S. Surveyor General of Oregon.

- L. J. Woolley, Compassman.
- E. G. Perry, Chainman.
- Guy Davis, Chainman.
- J. R. Hadley, Chainman.
- C. Kaper, Chainman.
- H. Moore, Axeman.
- J. H. Henderson, Axeman.
- _____, Flagman.

Subscribed and sworn to before me, this fourth day of

November 1887
 [SEAL.] James C. Roland
U. S. Deputy Surveyor

FINAL OATH OF DEPUTY SURVEYORS

We James P. Currier and James E. Holand
United States Deputy Surveyors, do solemnly swear that in pursuance of

instructions received from Douglas H. Taylor

U. S. Surveyor General for Oregon, bearing date of the 20th

day of August 1888, I have well, faith-

fully and truly, in my own proper person, and in strict conformity with the instructions furnished by the U. S. Surveyor General for Oregon, the Surveying Manual, and the laws of the United States, surveying all those

parts or portions of the Exterior bdy. of the Diminished Reservation

Willamette Meridian, in the State of Oregon, as are represented in the foregoing field notes as having been surveyed by me and under my directions; and I do further solemnly swear that all the corners of said survey have been established and perpetuated in strict accordance with the Surveying Manual, printed instructions, the special written instructions of the U. S. Surveyor General for Oregon, and in the specific manner described in the field notes, and that the foregoing are the true field notes of such survey, and should any fraud be detected I will suffer the penalty of perjury under the provisions of an Act of Congress approved August 8, 1846.

James P. Currier, James E. Holand
U. S. Deputy Surveyors

Subscribed and sworn to before me, this 23rd

day of February 1888

Allen Woodcock
Notary Public
for Oregon



Office U. S. Surveyor General,

Portland, Oregon, October 6th - 1888The ~~following~~ ^{foregoing} Field Notes of the Survey of the _____of the Boundary Lines
of the Diminished __________ Unatilla Indian
Reservation Oregon
executed by James P. Currier and James O. Nolan
Special U. S. Dept. Surveyors.
under his Contract No. _____, dated May 4_____ 1887, having been critically examined, the
necessary corrections and explanations made, the said Field Notes
and the survey they describe, are hereby approved.Douglas W. Taylor
Surveyor General.