

# Index

Referring the lines to the pages in the field notes

## Town 3 N. Range 35 E. Will-Mer-

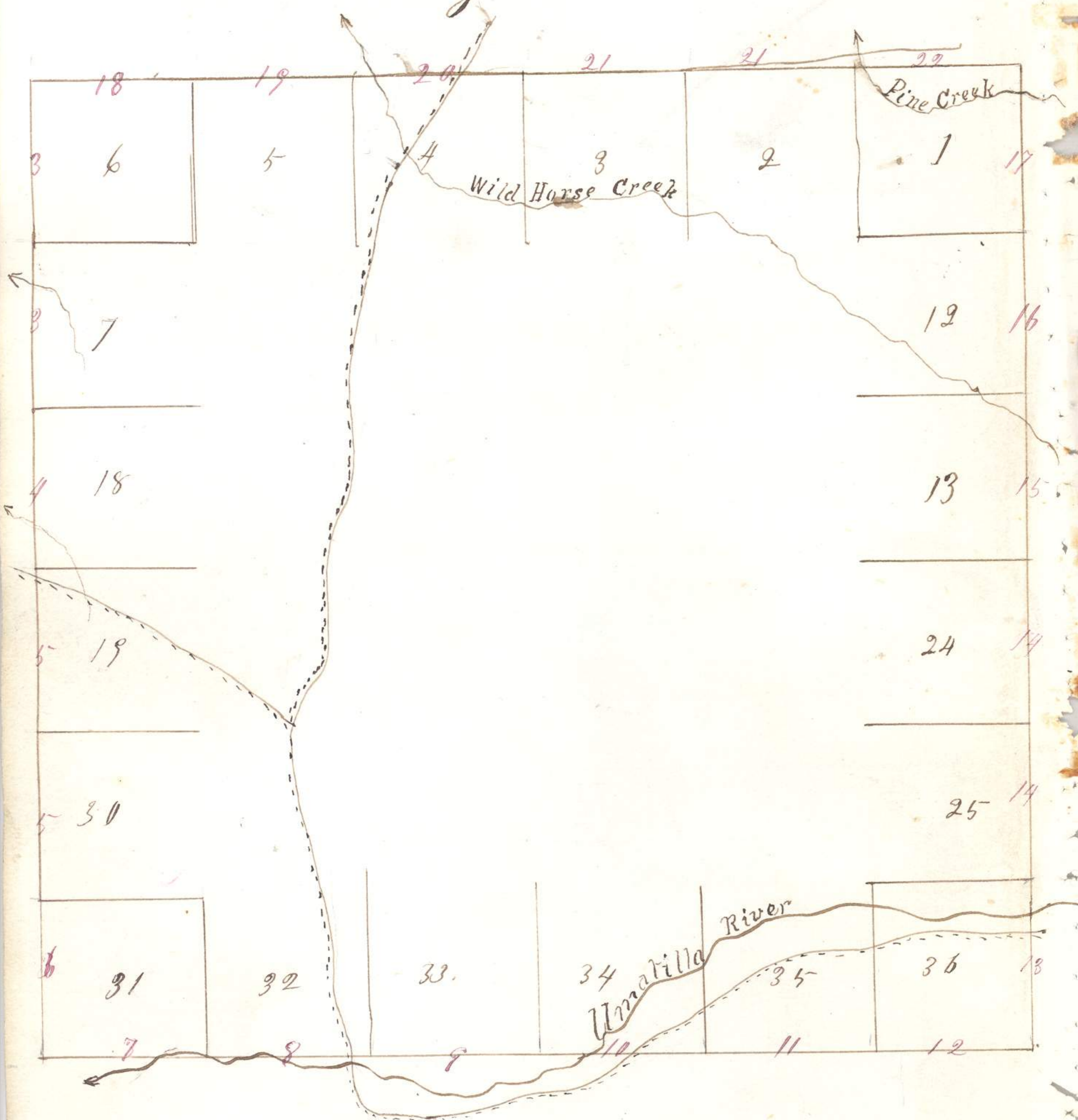



Field notes of the survey  
of the exterior lines of Township  
number 3 North of Range 35  
East of Willamette Meridian  
in the State of Oregon, by  
William H. Odell Deputy  
Surveyor, under his contract  
No. 114 bearing date July 2<sup>d</sup>  
1866.

Commenced July 26<sup>th</sup>  
and completed  
July 31<sup>st</sup> 1866.



## Township 3 North Range 35 East

and raised mound as per instructions.

80.00 Set post corner for sections 10  
30, 31, 25 & 26, drove charred  
stake, dug pits, and raised  
mound as per instructions.  
Land rolling prairie,  
good grass, Soil 2<sup>nd</sup> Kale,

North on West boundary  
of section 31.

20.00 Bar 22° East,

20.00 Begin to descend toward  
the Armatilla River.

40.00 Set 1/4 section post corner,  
drove charred stake, dug  
pits and raised mound  
as per instructions, 30

80.00 Set post corner for sections 150  
31, 6, 1 & 36 Is 2 & 3 N, W 34 & 35  
East, on steep hillside 4



217

Township 3 North Range 35 East,

facing the south, drove  
churned Stake, and raised  
Stone mound as per  
instructions

Level broken,

Good grass soil  
2<sup>d</sup> Kate,

\*

East on south boundary  
of section 31.

Bear 21°30' East.

40.00 Set 1/4 section post corner,  
on hill side facing West  
drove churned Stake, and  
made Stone Mound as  
per instructions

30

45.00 Right bank of Amatilla  
River 150 wide course S, W,

150

67.00 Enter timber

80.00 To corner for sections 31, 32,

5 & 6, in edge of Amatilla

River course N, W, from which



Township 3 North Range 35 East.

At Pine 20 in. dia, bears East  
 1.15 Chs. on right bank  
 of River, also Pine 8 in  
 diameter bears N 45° E, 75 lbs  
 Land broken on this  
 line hill sides stony,  
 Timber along the banks  
 of the river consist of  
 Balsam Alder & a few  
 Pines, Undergrowth the  
 same, the land along  
 Rivers bottoma rich but  
 gravelly.

East on south boundary  
 of section 32

Bear 20° East,

23.50

Edge of Amatilla River  
 Hence along the Channel  
 of the river,

30.00

Leave River to the right

40.00

Made corner for 1/4 section



Township 3 North Range 35 East,

on Pine 3 in-dia- from which  
 a Pine 30 in-dia bears  $S78^{\circ}W$  150 ft  
 do, do, 6 do-do- do-  $N56^{\circ}W$ , 50 do-

15.00 Leave timber, and pass  
 over point of hill,

13.00 Stage Road from Boise  
 City to Amatilla River

Course  $N4S$ ,

Stage Station bears  
 South about 3.00

20.00 Set post corner for sections  
 32, 33, 4 & 5, drove charred  
 stake, dug pits as per  
 instructions.

Land broken & rocky  
 Timber Balm Pine and  
 Alder, remainder growth  
 the same.

East on South boundary  
 of section 33.

Bar  $20^{\circ}$  East,



3

220/0

2 Township 3 North Range 35 East.

38.00 Bar 18° 30' East 150

40.00 Set 1/4 section post corner, 70

40.00 set Stone 6 x 10 x 14 Basalt  
on hill side facing the  
South -

80.00 Set Basalt Stone 6 x 12 x 15.  
Corner for sections 33.

34. 3 x 4.

Land broken & Stony

East on south boundary  
of section 34.

Bar 19° East,

25.00 Enter timber in River bottom 130

31.50 Amatilla River 3,000 ft. wide  
course south west,

40.00 Set post corner for 1/4 section  
from which

A Balin bin-dia-bars N. 15° E, 75 ft.

do, do - 24. do - do - do - S. 87° E, 37 "

63.50 Stage Road course N. E. & S. W.

70.00 Leave timber & River bottom



Township 3 North Range 35 East.

80.00 Set post corner for sections, + 80 80

34, 35, 243, from which  
 a Pine 5 in-dia-bears N46°E, 156 lbs  
 do-do-6 do-do-do N87°E 100"  
 no other tree near, dug pits  
 and raised mound as per  
 instructions

Land broken except in  
 river bottom, all stony,  
 Timber Balm Pine &  
 Alder, Undergrowth the  
 same,

July 27<sup>th</sup>

East on south boundary  
 of section 35,

Bar 21° East -

40.00 Set post corner for 1/4 section + 30

above charred stake, dug  
 pits and raised mound  
 as per instructions,

62.00 A Pine tree 18 in-dia + 120



Township 3 North Range 35 East <sup>72</sup> ~~22~~

Bar 20°30' East

80.00 Set Bassalt Stone 6x10x16 for 100  
80.00 corner to sections 35.36  
172.

Land broken, good grass,  
Soil 2<sup>nd</sup> Rate

East on south boundary  
of section 36,

Bar 21° East

15.00 Small Creek, 15 lbs wide course 75  
North, narrow belt of Balsam  
and Pine timber along  
banks &

40.00 Set post corner for 1/4 section, 150  
deposited marked stone,  
clay pit, and raised mound  
as per instructions.

80.00 Set post corner for sections  
Townships 2 & 3 North Ranges  
35 & 36, East sections 1, 6, 31,  
& 36. Drove charred stake.



1873

Township 3 North Range 35 East

dug pits, and raised mound  
 as per instructions.

Corner on hillside facing the  
 North West,

Land broken and  
 rocky, good grass.

North on East boundary  
 of section 36, ^

Bar 21° East,

40.00 Set post corner for 1/4 section 125, 125  
 from which

A Pine 10 in-dia - bears S 12° E 250 chs

do - do - 10 do - do - do - N 2° W 175 do -

57.15 Boise City Stage Road course 50  
 East and West,

69.50 Armatilla River 100 chs wide 15  
 course West -

80.00 Set a Bassalt Stone 7 X 9 X 15 80

Corner for sections 25, 36, 30 & 31  
 on hillside facing the South,



A list of the names of the individuals employed to assist in running, measuring or marking the lines and corners described in the foregoing field notes of Township number 3 North of the base line of Range 35 East of Willamette Meridian, - showing the respective capacities in which they acted:

J. J. Henderson  
 John A. Bigg } Chairman  
 P. M. Denney Axeman

Room for affidavit -



I William H. Orell Deputy  
 Surveyor, do solemnly swear  
 that in pursuance of a contract  
 with E. L. Applegate surveyor  
 of the public lands of the  
 United States in the State of  
 Oregon; bearing date July 2<sup>d</sup> 1866., and in  
 strict conformity to the laws of the United  
 States and the instructions furnished by the  
 said Surveyor General, I have faithfully  
 surveyed the exterior boundaries of  
 Township number 3 North of the Base Line  
 of Range 35 East of Willamette Meridian  
 in the State aforesaid, and do further  
 solemnly swear that the foregoing are  
 the true and original field notes of  
 such survey.

William H. Orell

State of Oregon }  
 County of Lane } ss. Subscribed and  
 sworn to before me this 23<sup>d</sup> day  
 of December 1866.

Joel Marey  
 Notary Public



237

Surveyor General's Office

Eugene City January 17, 1867

The foregoing field notes of the survey of the exterior boundaries of Township N° 3 North Range 35 East Will. Mer Oregon. Executed by William H. Odell Deputy Surveyor under his contract N° 114 bearing date July 2nd. 1866 having been critically examined the necessary corrections and explanations made the field notes and the surveys they describe are hereby accepted and approved.

E. L. Applegate

Surveyor General of Oregon