

TOWNSHIP 2 NORTH, RANGE 33 EAST, OF THE WILLAMETTE MERIDIAN, OREGON

DEPENDENT RESURVEY AND SUBDIVISION OF SECTIONS

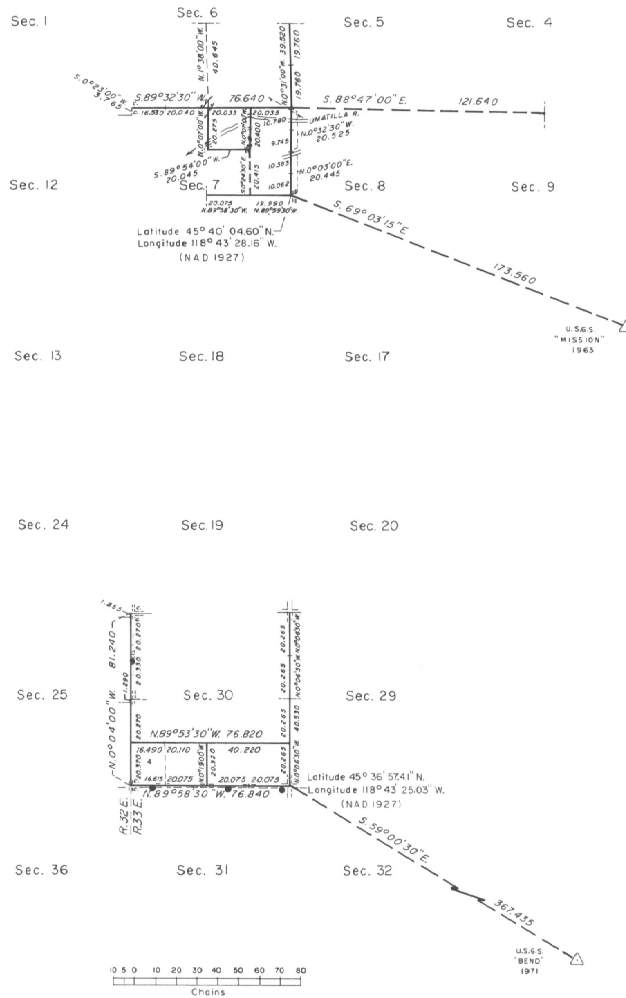

A history of surveys is contained in the field notes.

This plat represents a dependent resurvey of a portion of the west boundary, subdivisional lines and subdivision of section lines, T. 2 N., R. 33 E., Willamette Meridian, Oregon, designed to restore the corners in their true original locations according to the best available evidence, and the subdivision of sections 7 and 30.

The lottings and areas are as shown on the plat approved June 14, 1890.

The survey was executed by Richard L. Johnson, Cadastral Surveyor, beginning September 23, 1988, and completed June 28, 1989, pursuant to Special Instructions dated September 21, 1988, under Group Number 1467, Oregon.

Timber in this area consists of pine, cottonwood and fir.

UNITED STATES DEPARTMENT OF THE INTERIOR
BUREAU OF LAND MANAGEMENT

Portland, Oregon December 8, 1989

This plat is strictly conformable to the approved field notes, and the survey, having been correctly executed in accordance with the requirements of law and the regulations of this Bureau, is hereby accepted.

For the Director

Wayne M. Gardner
Chief Cadastral Surveyor of Oregon



Mean magnetic declination
20 1/2° EAST