

Township No 2 North, Range No 31 East, Willamette Meridian.

4003

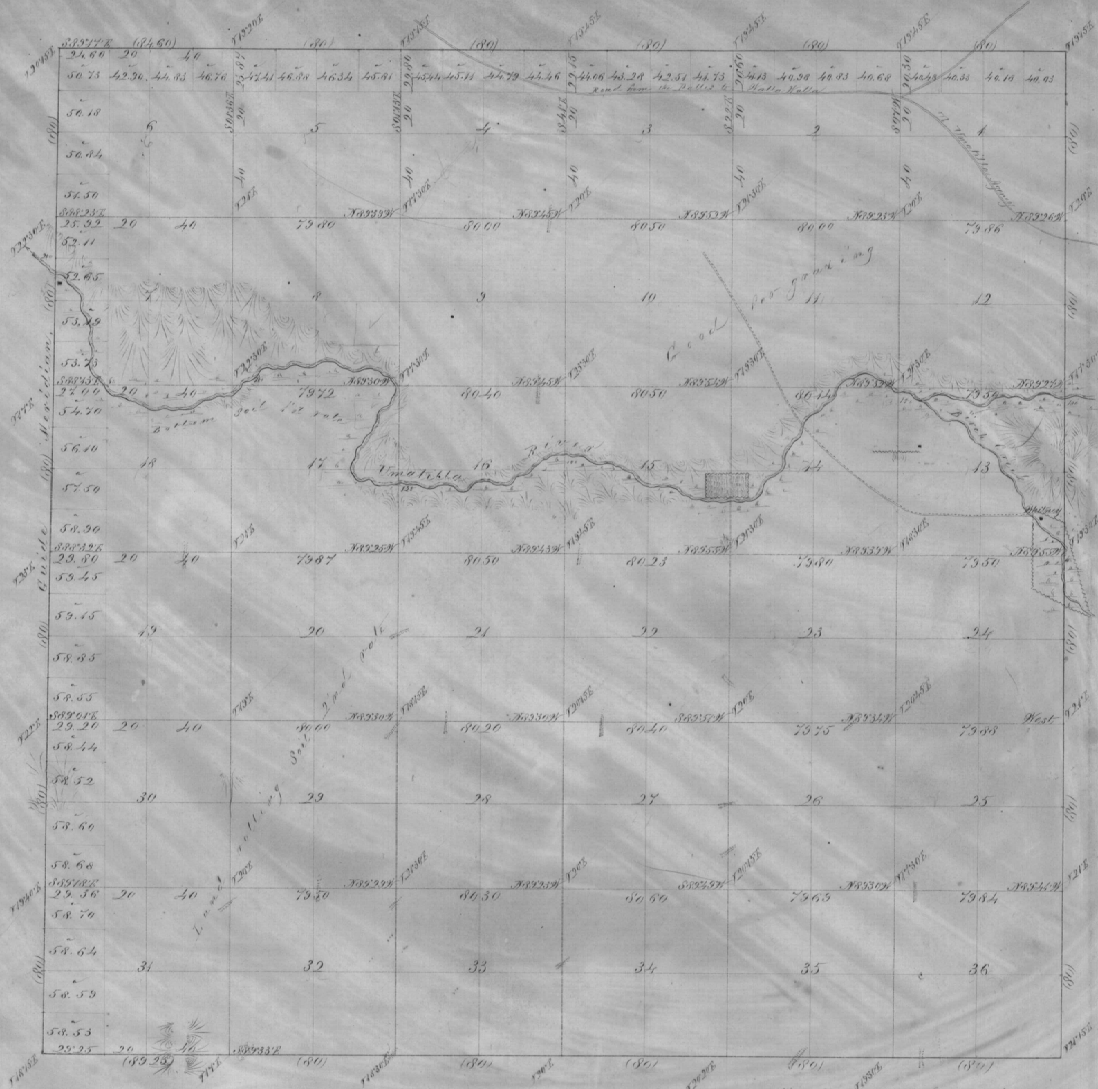

John A. Burnett, Sr.
John A. Burnett, Jr.
John A. Burnett, Esq.
John A. Burnett, Esq.
John A. Burnett, Esq.
John A. Burnett, Esq.

Scale to chains, 2 in = 1 mile
 True Meridian
 True Meridian 1794 30 00 00 West

Survey designated	By whom surveyed	Contract		Part of survey		When commenced	When completed
		No	Date	Acres	Chains links		
Boundaries North & East	John A. Burnett	52	September 12th 1850	12	64	October 15th 1850	October 20th 1850
Subdivisions	John A. Burnett	22	September 12th 1850	60	54	October 20th 1850	October 28th 1850
Total number of acres				25503.78			

The above map of Township No 2 North, of Range No 31 East of the Willamette Meridian, Oregon, is shown to conform to the field notes of the survey thereof on file in this office, which have been examined and approved.
 Surveyor General's Office, Oregon City, December 5th 1850.
W. W. Chapman
Genl. Com. Oregon