

UNITED STATES  
DEPARTMENT OF THE INTERIOR  
BUREAU OF LAND MANAGEMENT

FIELD NOTES

OF THE

DEPENDENT RESURVEY OF A PORTION OF THE WEST BOUNDARY

AND SUBDIVISIONAL LINES, AND

SUBDIVISION OF SECTIONS 3, 4, 5, 6, 7, 8, 17, 18, 19, AND 20,

TOWNSHIP 1 SOUTH, RANGE 36 EAST,

INDEX DIAGRAM

Township 1 South Range 36 East

Of the WILLAMETTE Meridian,

In the State of OREGON

EXECUTED BY

Lawrence D. Holmes, Cadastral Surveyor

Under special instructions dated September 22, 1983, approved September 23, 1983

\_\_\_\_\_, which provided for the surveys included under U.S. Survey/Group  
Number 1184, and assignment instructions dated September 29, 1983,  
and April 13, 1984

Survey commenced October 17, 1983

Survey completed May 23, 1985



# FIELD NOTES

OF THE

DEPENDENT RESURVEY OF A PORTION OF THE WEST BOUNDARY

AND SUBDIVISIONAL LINES, AND

SUBDIVISION OF SECTIONS 3, 4, 5, 6, 7, 8, 17, 18, 19, AND 20,

TOWNSHIP 1 SOUTH, RANGE 36 EAST,

## INDEX DIAGRAM

Township 1 South, Range 36 East,

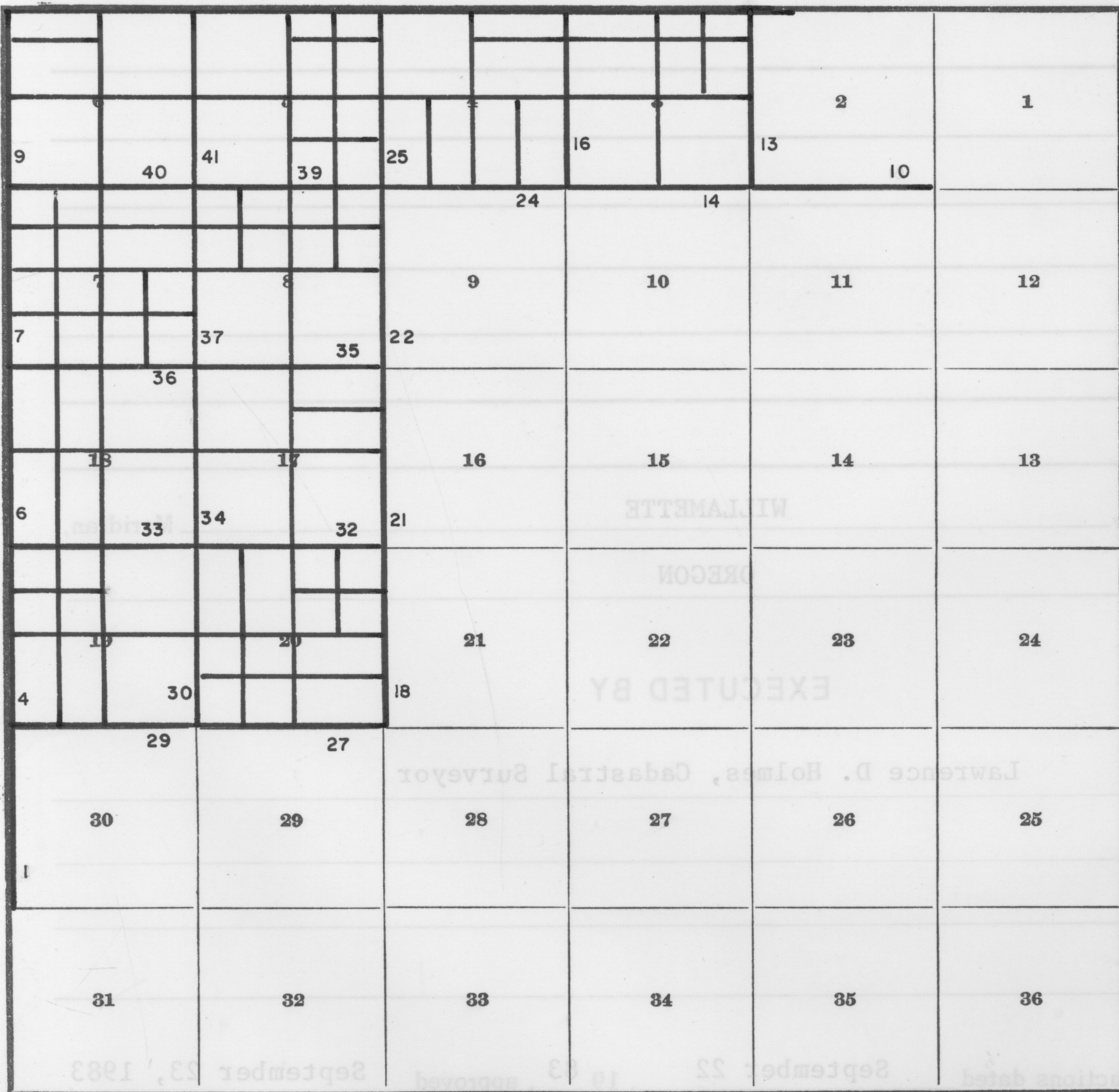

★ U.S. Government Printing Office: 1885-483-737

Subdivision of Section 3 pp. 44-46

- " " 4 " 46-49
- " " 5 " 49-52
- " " 6 " 52-54
- " " 7 " 54-59
- " " 8 " 59-62
- " " 17 " 62-64
- " " 18 " 64-65
- " " 19 " 65-68
- " " 20 " 68-72



## T. 1 S., R. 36 E., Willamette Meridian, Oregon

## CHAINS

The following field notes are those of the dependent resurvey of a portion of the west boundary and subdivisional lines, and subdivision of sections 3, 4, 5, 6, 7, 8, 17, 18, 19, and 20, township 1 south, range 36 east, Willamette Meridian, Oregon.

The history of surveys pertaining to this resurvey, is as follows:

The north boundary (Willamette Base Line) was surveyed by Timothy W. Davenport, U.S. Deputy Surveyor, in 1863.

The west boundary of the township was surveyed by Jacob C. Cooper, U.S. Deputy Surveyor, in 1881.

The north boundary (Willamette Base Line) was resurveyed and the subdivisional lines were surveyed by Herman D. Gradon, U.S. Deputy Surveyor, in 1882.

The survey was executed in accordance with the specifications as set forth in The Manual of Surveying Instructions, 1973, and the Special Instructions dated September 22, 1983, under Group Number 1184, Oregon.

Preliminary to the resurvey, the lines of the original surveys were retraced and a search was made for all corners and other calls of the record. Identified corners were remonumented in their original positions. Lost corners were restored at proportionate positions based on the official record. The retracement data were thoroughly verified and only the true line field notes are given herein. All lines not forming a closure were measured twice.

The directions of the lines were determined by deflections from azimuths obtained by direct solar observations and refer to the true meridian.

Detectable Electronically Energized Particles (DEEP-1 TM) were buried as memorials at certain corner monuments. The DEEP-1 is composed of strontium encased in a color coded plastic container. The units are 1 inch in diameter,  $2\frac{1}{2}$  inches long, weigh  $2\frac{1}{2}$  ounces, and are magnetically detectable to an average depth of 8 feet.

The geographic position of the corner of sections 20, 21, 28, and 29, as scaled from the quadrangle map, "HURON OREG.",  $7\frac{1}{2}$  minute series, prepared by the United States Geological Survey, in 1964, is as follows:

Latitude  $45^{\circ} 27.5' N.$  Longitude  $118^{\circ} 19.4' W.$

The mean magnetic declination is  $19\frac{1}{2}^{\circ} E.$

Dependent Resurvey of a Portion of the West Boundary,  
T. 1 S., R. 36 E., Willamette Meridian, Oregon

(Restoring the survey by Jacob C. Cooper, in 1881)



Dependent Resurvey of a Portion of the West Boundary,  
T. 1 S., R. 36 E., Willamette Meridian, Oregon

CHAINS	
	<p>N. 0° 31' E., on the W. bdy. of sec. 6.</p>
	<p>Over nearly level land, through heavy timber and light undergrowth</p>
1.80	<p>Dirt road, 20 lks. wide, bears N. 60° W. and S. 20° E.</p>
14.60	<p>Begin descent over NW. slope.</p>
22.70	<p>Ravine, drains N. 80° E.; asc. over steep SE. slope.</p>
30.20	<p>Spur, slopes E.; desc. over NE. slope.</p>
40.10	<p>Point for the ¼ sec. cor. of sec. 6 only, at proportionate distance; there is no remaining evidence of the original corner.</p>
	<p>Set an iron post, 30 ins. long, 2½ ins. diam., 15 ins. in the ground, to solid rock, in a mound of stone, 3 ft. base, to top, with brass cap mkd.</p>
	<p style="text-align: center;">           T 1 S            R 35 E   R 36 E                    ¼ S 6            1983         </p>
	<p>from which</p>
	<p style="padding-left: 40px;">A ponderosa pine, 10 ins. diam., bears N. 70° E., 82 lks. dist., mkd. ¼ S6 BT.</p>
	<p style="padding-left: 40px;">A grand fir, 26 ins. diam., bears S. 31° E., 116 lks. dist., mkd. ¼ S6 BT.</p>
	<p>Corner is located in bottom of small ravine, drains S. 30° E.</p>
	<p>Ascend over SE. slope, through heavy timber and light undergrowth.</p>
50.50	<p>Top of ascent; thence over nearly level land.</p>
60.15	<p>Point for the N 1/16 sec. cor. of sec. 6 only.</p>
	<p>Set an iron post, 28 ins. long, 2½ ins. diam., 22 ins. in the ground, with brass cap mkd.</p>
	<p style="text-align: center;">             N 1/16                S 6            1983         </p>
	<p>from which</p>
	<p style="padding-left: 40px;">A Douglas fir, 14 ins. diam., bears N. 67½° E., 69½ lks. dist., mkd. N 1/16 S6 BT.</p>
	<p style="padding-left: 40px;">A grand fir, 11 ins. diam., bears S. 27½° E., 51 lks. dist., mkd. N 1/16 S6 BT.</p>
73.62	<p>Intersect the Willamette Base Line.</p>
	<p>True point for the closing cor. of T. 1 S., Rs. 35 and 36 E.</p>
	<p>Set an iron post, 30 ins. long, 2½ ins. diam., with magnetic, plastic breakaway base, 25 ins. in the ground, with brass cap mkd.</p>



Dependent Resurvey of a Portion of the West Boundary,  
T. 1 S., R. 36 E., Willamette Meridian, Oregon

CHAINS

T 1 N R 36 E  
S 31  
-----  
S 1 | S 6  
R 35 E | R 36 E  
T 1 S  
CC  
1984

from which

A Douglas fir, 10 ins. diam., bears S.  $15\frac{1}{2}^{\circ}$  E.,  
30 lks. dist., mkd. T1S R36E S6 CC BT.

A Douglas fir, 19 ins. diam., bears S.  $52^{\circ}$  W.,  
44 lks. dist., mkd. T1S R35E S1 CC BT.

From this point, the original closing cor. of T. 1 S.,  
Rs. 35 and 36 E., perpetuated and recorded by Douglas M.  
Ferguson, Registered Land Surveyor, No. 848, in 1972,  
bears N.  $0^{\circ} 31'$  E., 0.06 chs. dist., monumented with an  
iron post,  $2\frac{1}{2}$  ins. diam., firmly set, projecting 6 ins.  
above ground, with brass cap mkd.

T 1 N 36 E S 31  
-----  
S 1 | S 6  
R 35 E | R 36 E  
C C  
T 1 S  
PLS 848  
1972

from which the remains of the original bearing trees

A larch snag, 18 ins. diam., bears S.  $77^{\circ}$  E.,  
26 lks. dist., with scribe marks T1S R36E S6 BT  
visible on open double blaze. (Record, S.  $74^{\circ}$  E.,  
24 lks.)

A decayed fir stump, size indeterminate, bears  
S.  $24^{\circ}$  W., 41 lks. dist., no marks visible.

and bearing trees mkd. by Ferguson

A fir, 14 ins. diam., bears N.  $35^{\circ}$  E., 65 lks.  
dist., with healed blaze.

A fir, 10 ins. diam., bears S.  $33^{\circ}$  E., 25 lks.  
dist., with healed blaze.

A spruce, 15 ins. diam., bears S.  $23^{\circ}$  W., 75 lks.  
dist., with partially healed blaze.

Add marks AM to brass cap.

From this same point, the standard  $\frac{1}{4}$  sec. cor. of sec.  
31, T. 1 N., R. 36 E., bears N.  $89^{\circ} 51'$  E., 24.44 chs.  
dist., described in the field notes of the dependent  
resurvey of a portion of the S. bdy. (Willamette Base  
Line), T. 1 N., R. 36 E., executed concurrently under  
this same group.

Dependent Resurvey of a Portion of the Subdivisional  
Lines, T. 1 S., R. 36 E., Willamette Meridian, Oregon



Subdivision of Section 20,  
T. 1 S., R. 36 E., Willamette Meridian, Oregon

CHAINS	
21.65	Butcher Creek, 15 lks. wide, course N. 80° E.; asc. over SE. slope.
22.65	Dirt road, 20 lks. wide, bears N. 50° E. and S. 80° W.
38.72	The center W 1/16 sec. cor. of sec. 20.
From the center S 1/16 sec. cor. of sec. 20.	
S. 89° 29' W., on the E. and W. center line of the SW¼ of sec. 20.	
Descend over broken SW. slope.	
20.28	The SW 1/16 sec. cor. of sec. 20.
Descend over SW. slope.	
25.50	Butcher Creek, 20 lks. wide, course NE.; asc. over SE. slope.
26.25	Dirt road, 15 lks. wide, bears N. 60° E. and S. 65° W.
40.55	The true point for the S 1/16 sec. cor. of secs. 19 and 20.
From the center W 1/16 sec. cor. of sec. 20.	
N. 0° 46' E., on the N. and S. center line of the NW¼ of sec. 20.	
Descend along broken E. slope.	
39.45	The W 1/16 sec. cor. of secs. 17 and 20.
GENERAL DESCRIPTION	
<p>The lands encompassed in this survey are located approximately 40 miles southeast of Pendleton, Oregon. Access is by private and Forest Service dirt roads and the Union Pacific Railroad which runs through the bottom of Meacham Canyon.</p>	
<p>The area is drained by numerous small streams that feed into Meacham Creek which drains north out of Meacham Canyon.</p>	
<p>The land is steep and broken, with Meacham Canyon forming a large horseshoe in the north half of the township. The north slopes are heavily timbered and the south slopes are open, with scattering timber in the draws and on the ridge tops.</p>	
<p>The timber is mixed conifer, predominately ponderosa pine, Douglas fir, and stands of western larch.</p>	
<p>The principal uses of the area are livestock grazing and logging.</p>	
<p>The average of several readings taken throughout the area gives a value of 19½° E. for the mean magnetic declination.</p>	



Form 9600-11  
(September 1983)

UNITED STATES  
DEPARTMENT OF THE INTERIOR  
BUREAU OF LAND MANAGEMENT

FIELD ASSISTANTS

NAMES	CAPACITY
Scott R. McIntyre	Surveying Technician
Leslie C. Phillips	Surveying Technician
Gregory P. Fleming	Surveying Aid

of the Willamette Meridian, in the State of Oregon, which are represented in the foregoing field notes as having been executed by (me, (us) and under (my) (our) direction, and that said survey has been made in strict conformity with said special instructions, the Manual of Instructions for the Survey of the Public Lands of the United States, and in specific manner described in the foregoing field notes.

*Lawrence D. Holmes*  
(Cadastral Surveyor)

*Sept 1, 1987*  
(Date)

CERTIFICATE OF APPROVAL

BUREAU OF LAND MANAGEMENT  
Portland, Oregon

The foregoing field notes of the dependent resurvey of a portion of the west boundary and subdivisional lines, and subdivision of sections 3, 4, 5, 6, 7, 8, 17, 18, 19, and 20, Township 1 south, range 36 east, Willamette Meridian, Oregon,

having been critically examined and found correct, are hereby approved.

executed by Lawrence D. Holmes, Cadastral Surveyor,

*William W. Blum*  
XXXXXXXXXXXXXXXXXXXX  
(Chief Cadastral Surveyor of Oregon)

*Sept 2, 1987*  
(Date)

CERTIFICATE OF TRANSCRIPT

I Certify that the foregoing transcript of the field notes of the above-described surveys in \_\_\_\_\_, is a true copy of the original field notes.

XXXXXXXXXXXXXXXXXXXX  
(Chief Cadastral Surveyor of Oregon)

(Date)



CERTIFICATE OF SURVEY

(I) ~~(XX)~~, Lawrence D. Holmes, Cadastral Surveyor, HEREBY

CERTIFY upon honor that, in pursuance of special instructions bearing date of the 22nd day of September, 1983, (I) ~~(XX)~~ have dependently resurveyed a portion of the west boundary and subdivisional lines, and subdivided sections 3, 4, 5, 6, 7, 8, 17, 18, 19, and 20, township 1 south, range 36 east,

of the Willamette Meridian, in the State of Oregon, which are represented in the foregoing field notes as having been executed by (me), ~~(us)~~ and under (my) ~~(our)~~ direction; and that said survey has been made in strict conformity with said special instructions, the Manual of Instructions for the Survey of the Public Lands of the United States, and in specific manner described in the foregoing field notes.

June 1, 1987  
(Date)

Lawrence D. Holmes  
(Cadastral Surveyor)

(Date)

(Cadastral Surveyor)

CERTIFICATE OF APPROVAL

BUREAU OF LAND MANAGEMENT  
Portland, Oregon

The foregoing field notes of the dependent resurvey of a portion of the west boundary and subdivisional lines, and subdivision of sections 3, 4, 5, 6, 7, 8, 17, 18, 19, and 20, township 1 south, range 36 east, Willamette Meridian, Oregon,

executed by Lawrence D. Holmes, Cadastral Surveyor, having been critically examined and found correct, are hereby approved.

July 2, 1987  
(Date)

William W. Glenn  
~~(Signature of Authorized Officer)~~  
(Chief Cadastral Surveyor of Oregon)

CERTIFICATE OF TRANSCRIPT

I CERTIFY That the foregoing transcript of the field notes of the above-described surveys in \_\_\_\_\_, is a true copy of the original field notes.

(Date)

~~(Signature of Authorized Officer)~~  
(Chief Cadastral Surveyor of Oregon)