

R-636

UNITED STATES
DEPARTMENT OF THE INTERIOR
BUREAU OF LAND MANAGEMENT

FIELD NOTES

OF THE

DEPENDENT RESURVEY OF A PORTION OF THE WEST BOUNDARY

AND SUBDIVISIONAL LINES, AND

SUBDIVISION OF SECTIONS 3, 4, 5, 6, 7, 8, 17, 18, 19, AND 20,

TOWNSHIP 1 SOUTH, RANGE 36 EAST,

INDEX DIAGRAM

Township 1 South Range 36 East

Of the WILLAMETTE Meridian,

In the State of OREGON

EXECUTED BY

Lawrence D. Holmes, Cadastral Surveyor

Under special instructions dated September 22, 19 83, approved September 23, 1983

_____, which provided for the surveys included under U.S. Survey/Group
Number 1184, and assignment instructions dated September 29, 19 83.
and April 13, 1984

Survey commenced October 17, 19 83

Survey completed May 23, 19 85

FIELD NOTES

OF THE

DEPENDENT RESURVEY OF A PORTION OF THE WEST BOUNDARY

AND SUBDIVISIONAL LINES, AND

SUBDIVISION OF SECTIONS 3, 4, 5, 6, 7, 8, 17, 18, 19, AND 20,

TOWNSHIP 1 SOUTH, RANGE 36 EAST,

INDEX DIAGRAM

Township 1 South, Range 36 East

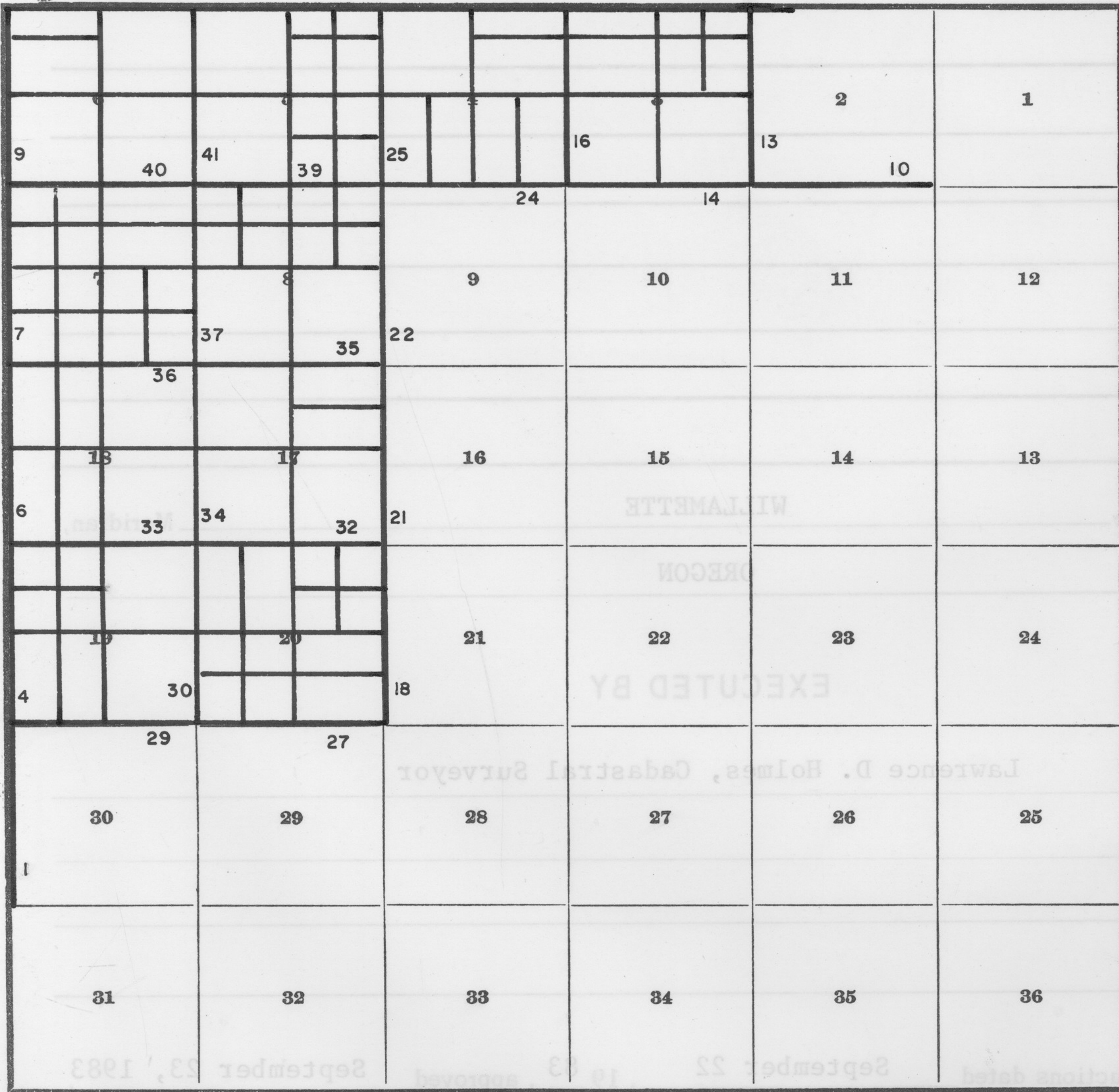

U.S. Government Printing Office: 1985-483-737

Subdivision of Section 3	pp. 44-46
"	" 4 " 46-49
"	" 5 " 49-52
"	" 6 " 52-54
"	" 7 " 54-59
"	" 8 " 59-62
"	" 17 " 62-64
"	" 18 " 64-65
"	" 19 " 65-68
"	" 20 " 68-72

T. 1 S., R. 36 E., Willamette Meridian, Oregon

CHAINS

The following field notes are those of the dependent resurvey of a portion of the west boundary and subdivisional lines, and subdivision of sections 3, 4, 5, 6, 7, 8, 17, 18, 19, and 20, township 1 south, range 36 east, Willamette Meridian, Oregon.

The history of surveys pertaining to this resurvey, is as follows:

The north boundary (Willamette Base Line) was surveyed by Timothy W. Davenport, U.S. Deputy Surveyor, in 1863.

The west boundary of the township was surveyed by Jacob C. Cooper, U.S. Deputy Surveyor, in 1881.

The north boundary (Willamette Base Line) was resurveyed and the subdivisional lines were surveyed by Herman D. Gradon, U.S. Deputy Surveyor, in 1882.

The survey was executed in accordance with the specifications as set forth in The Manual of Surveying Instructions, 1973, and the Special Instructions dated September 22, 1983, under Group Number 1184, Oregon.

Preliminary to the resurvey, the lines of the original surveys were retraced and a search was made for all corners and other calls of the record. Identified corners were remonumented in their original positions. Lost corners were restored at proportionate positions based on the official record. The retracement data were thoroughly verified and only the true line field notes are given herein. All lines not forming a closure were measured twice.

The directions of the lines were determined by deflections from azimuths obtained by direct solar observations and refer to the true meridian.

Detectable Electronically Energized Particles (DEEP-1 TM) were buried as memorials at certain corner monuments. The DEEP-1 is composed of strontium encased in a color coded plastic container. The units are 1 inch in diameter, $2\frac{1}{2}$ inches long, weigh $2\frac{1}{2}$ ounces, and are magnetically detectable to an average depth of 8 feet.

The geographic position of the corner of sections 20, 21, 28, and 29, as scaled from the quadrangle map, "HURON OREG.", $7\frac{1}{2}$ minute series, prepared by the United States Geological Survey, in 1964, is as follows:

Latitude $45^{\circ} 27.5' N.$ Longitude $118^{\circ} 19.4' W.$

The mean magnetic declination is $19\frac{1}{2}^{\circ} E.$

Dependent Resurvey of a Portion of the West Boundary,
T. 1 S., R. 36 E., Willamette Meridian, Oregon

(Restoring the survey by Jacob C. Cooper, in 1881)

Dependent Resurvey of a Portion of the West Boundary,
T. 1 S., R. 36 E., Willamette Meridian, Oregon

CHAINS

Beginning at the cor. of secs. 30 and 31 only, perpetuated by person(s) unknown, monumented with an iron rod, 3/8 ins. diam., firmly set, projecting 2 ins. above ground, from which the remains of an original bearing tree:

A fir stump, 28 ins. diam., bears N. 84° W., 22 lks. dist., with illegible scribe marks visible on decayed blaze. (Record, and to face, 20 lks.)

and bearing trees of no known record

A Douglas fir, 32 ins. diam., bears N. 80 $\frac{3}{4}$ ° E., 37 lks. dist., with healed blaze.

A Douglas fir, 14 ins. diam., bears S. 27° E., 27 lks. dist., with scribe marks BT visible on partially healed blaze.

A Douglas fir, 40 ins. diam., bears S. 76 $\frac{1}{2}$ ° W., 65 $\frac{1}{2}$ lks. dist., no marks visible on partially healed blaze.

A Douglas fir, 27 ins. diam., bears N. 22 $\frac{1}{4}$ ° W., 65 lks. dist., with scribe marks R S35 9 visible on partially healed blaze.

At the corner point

Set an iron post, 30 ins. long, 2 $\frac{1}{2}$ ins. diam., with magnetic, plastic breakaway base, 25 ins. in the ground, with brass cap mkd.

T 1 S	T 1 S
S 25	S 30
R 35 E	S 31
	R 36 E

1984

Deposit iron rod alongside iron post.

N. 0° 27' E., on the W. bdy. of sec. 30.

Over rolling land, through heavy timber and moderate undergrowth.

35.50 Begin descent over NE. slope.

40.19 Point for the $\frac{1}{4}$ sec. cor. of sec. 30 only, at proportionate distance; there is no remaining evidence of the original corner.

Set an iron post, 30 ins. long, 2 $\frac{1}{2}$ ins. diam., with magnetic, plastic breakaway base, 24 ins. in the ground, with brass cap mkd.

T 1 S	R 36 E
R 35 E	$\frac{1}{4}$ S 30

1984

from which

A larch, 10 ins. diam., bears N. 72 $\frac{1}{2}$ ° E., 45 lks. dist., mkd. $\frac{1}{4}$ S30 BT.

Dependent Resurvey of a Portion of the West Boundary,
T. 1 S., R. 36 E., Willamette Meridian, Oregon

CHAINS																			
	<p>A larch, 12 ins. diam., bears S. 28° E., 16 lks. dist., mkd. ¼ S30 BT.</p> <p>Continue descent over NE. slope.</p>																		
45.40	Creek, 10 lks. wide, course N. 34° W.; asc. over SW. slope.																		
47.10	Abandoned dirt road, 15 lks. wide, bears N. 10° W. and S. 25° E.																		
54.80	Enter clearing, edge bears N. 60° W. and S. 60° E.																		
60.285	<p>Point for the N 1/16 sec. cor. of sec. 30 only.</p> <p>Set an iron post, 30 ins. long, 2½ ins. diam., with magnetic, plastic breakaway base, 10 ins. in the ground, to solid rock, in a mound of stone, 4 ft. base, to top, with brass cap mkd.</p> <div style="text-align: center;"> <table border="0"> <tr><td> </td><td>N 1/16</td></tr> <tr><td> </td><td>S 30</td></tr> <tr><td></td><td>1984</td></tr> </table> </div> <p>from which</p> <p>A Douglas fir, 13 ins. diam., bears N. 46½° E., 203½ lks. dist., mkd. N 1/16 S30 BT.</p> <p>A ponderosa pine, 15 ins. diam., bears S. 52° E., 108½ lks. dist., mkd. N 1/16 S30 BT.</p> <p>Continue ascent over open SW. slope.</p>		N 1/16		S 30		1984												
	N 1/16																		
	S 30																		
	1984																		
63.15	Enter scattering timber, edge bears N. 70° W. and S. 70° E.																		
66.05	Ridge, bears N. 45° W. and S. 45° E.; desc. over NE. slope.																		
67.80	Dirt road, 15 lks. wide, bears N. 15° W. and S. 20° E.																		
75.325	True point for the closing cor. of secs. 24 and 25, T. 1 S., R. 35 E., described in the field notes of the dependent resurvey of a portion of the subdivisional lines of T. 1 S., R. 35 E., executed concurrently under this same group.																		
80.38	<p>The cor. of secs. 19 and 30 only, perpetuated and recorded by Douglas M. Ferguson, Registered Land Surveyor, No. 848, in 1972, monumented with an iron post, 2½ ins. diam., firmly set, projecting 2 ins. above ground, with brass cap mkd.</p> <div style="text-align: center;"> <table border="0"> <tr><td>T 1 S</td><td> </td><td>T 1 S</td></tr> <tr><td>R 35 E</td><td> </td><td>S 19</td></tr> <tr><td>S 24</td><td> </td><td>S 30</td></tr> <tr><td></td><td> </td><td>R 36 E</td></tr> <tr><td></td><td></td><td>1972</td></tr> <tr><td></td><td></td><td>PLS 848</td></tr> </table> </div> <p>from which the remains of the original bearing trees</p> <p>A decayed fir stump, 20 ins. diam., bears S. 81° W., 23 lks. dist., no marks visible.</p>	T 1 S		T 1 S	R 35 E		S 19	S 24		S 30			R 36 E			1972			PLS 848
T 1 S		T 1 S																	
R 35 E		S 19																	
S 24		S 30																	
		R 36 E																	
		1972																	
		PLS 848																	

Dependent Resurvey of a Portion of the West Boundary,
T. 1 S., R. 36 E., Willamette Meridian, Oregon

CHAINS

A decayed fir stump, size indeterminate, bears
N. 58° W., 15 lks. dist., no marks visible.

and bearing trees mkd. by Ferguson

A larch, 11 ins. diam., bears N. $10\frac{1}{2}^{\circ}$ E., 20 lks.
dist., with partially healed blaze.

A lodgepole pine snag, 11 ins. diam., bears
S. $51\frac{1}{2}^{\circ}$ E., 20 lks. dist. with scribe marks
T1S R36E S30 BT visible on open blaze.

A ponderosa pine snag, 11 ins. diam., bears
S. 4° W., 22 lks. dist., with pitched over
blaze.

and a new bearing tree

A larch, 9 ins. diam., bears S. $36\frac{1}{2}^{\circ}$ E., 33 lks.
dist., mkd. T1S R36E S30 BT.

N. $0^{\circ} 25'$ W., on the W. bdy. of sec. 19.

Descend over NE. slope, through heavy timber and
moderate undergrowth.

34.70 Point for the $\frac{1}{4}$ sec. cor. of sec. 24 only, T. 1 S.,
R. 35 E., described in the field notes of the dependent
resurvey of a portion of the subdivisional lines of
T. 1 S., R. 35 E., executed concurrently under this same
group.

40.14 The $\frac{1}{4}$ sec. cor. of sec. 19 only, monumented with a 2 in.
squared wood stake, 3 ft. long, firmly set, projecting 2
ft. above ground, from which the remains of the original
bearing trees:

A decayed fir stump, size indeterminate, bears
N. 58° E., 9 lks. dist., no marks visible.

A decayed larch stump, size indeterminate, bears
N. 85° W., 22 lks. dist., alongside of which
is a piece of decayed log with axe marks
visible.

At the corner point

Set an iron post, 28 ins. long, $2\frac{1}{2}$ ins. diam., 22 ins.
in the ground, with brass cap mkd.

T 1 S
R 35 E | R 36 E
 | $\frac{1}{4}$ S 19
 1983

from which

A grand fir, 16 ins. diam., bears N. $34\frac{3}{4}^{\circ}$ E., 38
lks. dist., mkd. $\frac{1}{4}$ S19 BT.

A lodgepole pine, 15 ins. diam., bears S. $48\frac{1}{2}^{\circ}$ E.,
67 lks. dist., mkd. $\frac{1}{4}$ S19 BT.

Dependent Resurvey of a Portion of the West Boundary,
T. 1 S., R. 36 E., Willamette Meridian, Oregon

CHAINS											
	N. 1° 58' W., beginning new measurement.										
	Descend over NE. slope, through heavy timber and moderate undergrowth.										
7.35	Begin steep descent over broken NE. slope.										
14.45	Point for the N 1/16 sec. cor. of sec. 24 only, T. 1 S., R. 35 E., described in the field notes of the dependent resurvey of a portion of the subdivisional lines of T. 1 S., R. 35 E., executed concurrently under this same group.										
20.03	Point for the N 1/16 sec. cor. of sec. 19 only. Set an iron post, 28 ins. long, 2½ ins. diam., 22 ins. in the ground, with brass cap mkd.										
	<table style="margin-left: auto; margin-right: auto;"> <tr><td style="border-right: 1px solid black; padding-right: 5px;">N 1/16</td></tr> <tr><td style="border-right: 1px solid black; padding-right: 5px;">S 19</td></tr> <tr><td style="padding: 0 5px;">1983</td></tr> </table>	N 1/16	S 19	1983							
N 1/16											
S 19											
1983											
	from which										
	A Douglas fir, 13 ins. diam., bears N. 36¼° E., 36 lks. dist., mkd. N 1/16 S19 BT.										
	A Douglas fir, 12 ins. diam., bears S. 7¾° E., 125 lks. dist., mkd. X BT.										
	Corner is located on steep NE. slope, in heavy timber.										
	Descend over NE. slope.										
27.75	Butcher Creek, 10 lks. wide, course S. 45° E.; asc. over steep SW. slope.										
34.34	True point for the closing cor. of secs. 13 and 24, T. 1 S., R. 35 E., described in the field notes of the dependent resurvey of a portion of the subdivisional lines of T. 1 S., R. 35 E., executed concurrently under this same group.										
40.06	The cor. of secs. 18 and 19 only, established at record bearing and distance from the remaining original bearing tree:										
	A ponderosa pine, 24 ins. diam., bears S. 89° W., 162 lks. dist., with fragmentary scribe marks visible on opened blaze.										
	At the corner point										
	Set an iron post, 28 ins. long, 2½ ins. diam., 10 ins. in the ground, to solid rock, in a mound of stone, 4 ft. base, to top, with brass cap mkd.										
	<table style="margin-left: auto; margin-right: auto;"> <tr><td style="border-right: 1px solid black; padding-right: 5px;">T 1 S</td><td style="padding: 0 5px;">T 1 S</td></tr> <tr><td style="border-right: 1px solid black; padding-right: 5px;">R 35 E</td><td style="padding: 0 5px;">S 18</td></tr> <tr><td style="border-right: 1px solid black; padding-right: 5px;">S 13</td><td style="padding: 0 5px;">S 19</td></tr> <tr><td style="border-right: 1px solid black; padding-right: 5px;"></td><td style="padding: 0 5px;">R 36 E</td></tr> <tr><td style="padding: 0 5px;"></td><td style="padding: 0 5px;">1983</td></tr> </table>	T 1 S	T 1 S	R 35 E	S 18	S 13	S 19		R 36 E		1983
T 1 S	T 1 S										
R 35 E	S 18										
S 13	S 19										
	R 36 E										
	1983										
	from which new bearing trees										
	A ponderosa pine, 30 ins. diam., bears N. 58° E. 339 lks. dist., mkd. T1S R36E S18 BT.										

179

Dependent Resurvey of a Portion of the West Boundary,
T. 1 S., R. 36 E., Willamette Meridian, Oregon

CHAINS	
	<p>A ponderosa pine, 9 ins. diam., bears S. $19\frac{1}{2}^{\circ}$ E. 251 lks. dist., mkd. T1S R36E S19 BT.</p> <p>Corner is located on steep, open SW. slope.</p>
	<p>N. $0^{\circ} 19'$ W., on the W. bdy. of sec. 18.</p> <p>Ascend over steep SW. slope.</p>
15.75	Ridge, bears N. 30° W. and S. 30° E.; thence across broad ridge top.
16.75	Dirt road, 20 lks. wide, bears N. 30° W. and S. 30° E.
26.90	Begin descent over broken NE. slope.
40.13	<p>The $\frac{1}{4}$ sec. cor. of sec. 18 only, determined at record bearing and distance from the remains of an original bearing tree:</p> <p>A hollow spruce stump, 36 ins. diam., bears S. 66° E., 8 lks. dist., portion of healed scar visible on inside.</p> <p>At the corner point</p> <p>Set an iron post, 28 ins. long, $2\frac{1}{2}$ ins. diam., 24 ins. in the ground, with brass cap mkd.</p> <div style="text-align: center;"> <p>T 1 S R 35 E R 36 E $\frac{1}{4}$ S 18 1983</p> </div> <p>from which new bearing trees</p> <p>A spruce, 14 ins. diam., bears N. 42° E., 101 lks. dist., mkd. $\frac{1}{4}$ S18 BT.</p> <p>A spruce, 7 ins. diam., bears S. $78\frac{1}{2}^{\circ}$ E., 63 lks. dist., mkd. X BT.</p> <hr/> <p>N. $0^{\circ} 49'$ E., beginning new measurement.</p> <p>Continue over gently rolling land, through scattering timber.</p>
33.78	Point for the closing cor. of secs. 12 and 13, T. 1 S., R. 35 E., at proportionate distance; there is no remaining evidence of the original corner. No permanent monument established.
40.24	<p>Point for the cor. of secs. 7 and 18 only, at proportionate distance; there is no remaining evidence of the original corner.</p> <p>Set an iron post, 28 ins. long, $2\frac{1}{2}$ ins. diam., 22 ins. in the ground, with brass cap mkd.</p> <div style="text-align: center;"> <p>T 1 S T 1 S R 35 E S 7 S 18 R 36 E 1983</p> </div> <p>from which</p>

Dependent Resurvey of a Portion of the West Boundary,
T. 1 S., R. 36 E., Willamette Meridian, Oregon

CHAINS	
	<p>A Douglas fir, 11 ins. diam., bears N. $47\frac{3}{4}^{\circ}$ E., 92 lks. dist., mkd. T1S R36E S7 BT.</p> <p>A grand fir, 10 ins. diam., bears S. $19\frac{1}{2}^{\circ}$ E., 36 lks. dist., mkd. T1S R36E S18 BT.</p>
	<p>N. $0^{\circ} 49'$ E., on the W. bdy. of sec. 7.</p> <p>Over nearly level land, through heavy timber and under- growth.</p> <p>0.25 Dirt road, 25 lks. wide, bears N. 45° E. and S. 45° W.</p> <p>11.25 Begin descent over broken NW. slope.</p> <p>20.12 Point for the S 1/16 sec. cor. of sec. 7 only.</p> <p>Set an iron post, 28 ins. long, $2\frac{1}{2}$ ins. diam., 16 ins. in the ground, to solid rock, in a mound of stone, 3 ft. base, to top, with brass cap mkd.</p> <p style="text-align: center;"> S 1/16 S 7 1983</p>
	<p>from which</p> <p>A Douglas fir, 19 ins. diam., bears N. $68\frac{1}{2}^{\circ}$ E., 33 lks. dist., mkd. S 1/16 S7 BT.</p> <p>A Douglas fir, 19 ins. diam., bears S. $50\frac{3}{4}^{\circ}$ E., 76 lks. dist., mkd. S 1/16 S7 BT.</p> <p>Continue descent over broken NW. slope.</p>
40.24	<p>The $\frac{1}{4}$ sec. cor. of sec. 7 only, determined at record bearing and distance from the remains of an original bearing tree:</p> <p>A fir snag, 15 ins. diam., bears S. 81° W., 20 lks. dist., with scribe marks $\frac{1}{4}$ S BT visible on partially healed blaze.</p> <p>At the corner point</p> <p>Set an iron post, 28 ins. long, $2\frac{1}{2}$ ins. diam., 24 ins. in the ground, with brass cap mkd.</p> <p style="text-align: center;">T 1 S R 35 E R 36 E $\frac{1}{4}$ S 7 1983</p>
	<p>from which new bearing trees</p> <p>A ponderosa pine, 20 ins. diam., bears N. $87\frac{3}{4}^{\circ}$ E., 32 lks. dist., mkd. $\frac{1}{4}$ S7 BT.</p> <p>A fir, 9 ins. diam., bears S. $26\frac{1}{2}^{\circ}$ E., 17 lks. dist., mkd. $\frac{1}{4}$ S7 BT.</p> <hr/> <p>N. $2^{\circ} 25'$ E., beginning new measurement.</p>

Dependent Resurvey of a Portion of the West Boundary,
T. 1 S., R. 36 E., Willamette Meridian, Oregon

CHAINS													
	Descend over steep NW. slope, through heavy timber and moderate undergrowth.												
10.05	Creek, 10 lks. wide, course N. 40° E.; asc. over steep SE. slope.												
20.025	Point for the N 1/16 sec. cor. of sec. 7 only.												
	Set an iron post, 30 ins. long, 2½ ins. diam., with magnetic, plastic breakaway base, 26 ins. in the ground, with brass cap mkd.												
	<table style="margin-left: auto; margin-right: auto;"> <tr><td style="border-right: 1px solid black; padding-right: 5px;">N 1/16</td></tr> <tr><td style="border-right: 1px solid black; padding-right: 5px;">S 7</td></tr> <tr><td style="padding-left: 10px;">1984</td></tr> </table>	N 1/16	S 7	1984									
N 1/16													
S 7													
1984													
	from which												
	<p style="margin-left: 40px;">A Douglas fir, 14 ins. diam., bears N. 73¾° E., 53½ lks. dist., mkd. N 1/16 S7 BT.</p>												
	<p style="margin-left: 40px;">A Douglas fir, 11 ins. diam., bears S. 73° E., 55½ lks. dist., mkd. N 1/16 S7 BT.</p>												
34.20	From this point, the original closing cor. of secs. 1 and 12, T. 1 S., R. 35 E., bears East, 0.165 chs. dist., monumented with a basalt stone, 24 x 10 x 3 ins., loosely set in a mound of stone, 3 ft. base, 8 ins. high, mkd. CC and 5 grooves on W. face.												
35.15	Top of ascent; thence over nearly level land.												
40.05	The cor. of secs. 6 and 7 only, perpetuated and recorded by Douglas M. Ferguson, Registered Land Surveyor, No. 848, in 1972, monumented with an iron post, 2½ ins. diam., firmly set, projecting 3 ins. above ground, with brass cap mkd.												
	<table style="margin-left: auto; margin-right: auto;"> <tr><td style="border-right: 1px solid black; padding-right: 5px;">T 1 S</td><td style="padding-left: 5px;">T 1 S</td></tr> <tr><td style="border-right: 1px solid black; padding-right: 5px;">R 35 E</td><td style="padding-left: 5px;">S 6</td></tr> <tr><td style="border-right: 1px solid black; padding-right: 5px;">S 1</td><td style="padding-left: 5px;">S 7</td></tr> <tr><td style="border-right: 1px solid black; padding-right: 5px;"></td><td style="padding-left: 5px;">R 36 E</td></tr> <tr><td style="padding-left: 10px;">1972</td><td></td></tr> <tr><td style="padding-left: 10px;">PLS 848</td><td></td></tr> </table>	T 1 S	T 1 S	R 35 E	S 6	S 1	S 7		R 36 E	1972		PLS 848	
T 1 S	T 1 S												
R 35 E	S 6												
S 1	S 7												
	R 36 E												
1972													
PLS 848													
	from which the remains of the original bearing trees												
	<p style="margin-left: 40px;">A ponderosa pine, 38 ins. diam., bears N. 4° E., 76 lks. dist., with scribe marks T1S R36E S6 visible on opened blaze.</p>												
	<p style="margin-left: 40px;">A root hole, bears N. 62° W., 72 lks. dist., with a down and decayed pine alongside, size indeter- minate, with scribe marks T1S R35E S1 visible on weathered blaze.</p>												
	and bearing trees mkd. by Ferguson												
	<p style="margin-left: 40px;">A Douglas fir, 20 ins. diam., bears S. 42¼° E., 24 lks. dist., with healed blaze.</p>												
	<p style="margin-left: 40px;">A Douglas fir, 17 ins. diam., bears N. 46½° W., 39½ lks. dist., with pitched over blaze.</p>												

Dependent Resurvey of a Portion of the West Boundary,
T. 1 S., R. 36 E., Willamette Meridian, Oregon

CHAINS	
	<p>N. 0° 31' E., on the W. bdy. of sec. 6.</p>
	<p>Over nearly level land, through heavy timber and light undergrowth</p>
1.80	<p>Dirt road, 20 lks. wide, bears N. 60° W. and S. 20° E.</p>
14.60	<p>Begin descent over NW. slope.</p>
22.70	<p>Ravine, drains N. 80° E.; asc. over steep SE. slope.</p>
30.20	<p>Spur, slopes E.; desc. over NE. slope.</p>
40.10	<p>Point for the ¼ sec. cor. of sec. 6 only, at proportionate distance; there is no remaining evidence of the original corner.</p>
	<p>Set an iron post, 30 ins. long, 2½ ins. diam., 15 ins. in the ground, to solid rock, in a mound of stone, 3 ft. base, to top, with brass cap mkd.</p>
	<p style="text-align: center;"> T 1 S R 35 E R 36 E ¼ S 6 1983 </p>
	<p>from which</p>
	<p style="padding-left: 40px;">A ponderosa pine, 10 ins. diam., bears N. 70° E., 82 lks. dist., mkd. ¼ S6 BT.</p>
	<p style="padding-left: 40px;">A grand fir, 26 ins. diam., bears S. 31° E., 116 lks. dist., mkd. ¼ S6 BT.</p>
	<p>Corner is located in bottom of small ravine, drains S. 30° E.</p>
	<p>Ascend over SE. slope, through heavy timber and light undergrowth.</p>
50.50	<p>Top of ascent; thence over nearly level land.</p>
60.15	<p>Point for the N 1/16 sec. cor. of sec. 6 only.</p>
	<p>Set an iron post, 28 ins. long, 2½ ins. diam., 22 ins. in the ground, with brass cap mkd.</p>
	<p style="text-align: center;"> N 1/16 S 6 1983 </p>
	<p>from which</p>
	<p style="padding-left: 40px;">A Douglas fir, 14 ins. diam., bears N. 67½° E., 69½ lks. dist., mkd. N 1/16 S6 BT.</p>
	<p style="padding-left: 40px;">A grand fir, 11 ins. diam., bears S. 27½° E., 51 lks. dist., mkd. N 1/16 S6 BT.</p>
73.62	<p>Intersect the Willamette Base Line.</p>
	<p>True point for the closing cor. of T. 1 S., Rs. 35 and 36 E.</p>
	<p>Set an iron post, 30 ins. long, 2½ ins. diam., with magnetic, plastic breakaway base, 25 ins. in the ground, with brass cap mkd.</p>

Dependent Resurvey of a Portion of the West Boundary,
T. 1 S., R. 36 E., Willamette Meridian, Oregon

CHAINS

T 1 N R 36 E
S 31

S 1 | S 6
R 35 E | R 36 E
T 1 S
CC
1984

from which

A Douglas fir, 10 ins. diam., bears S. $15\frac{1}{2}^{\circ}$ E.,
30 lks. dist., mkd. T1S R36E S6 CC BT.

A Douglas fir, 19 ins. diam., bears S. 52° W.,
44 lks. dist., mkd. T1S R35E S1 CC BT.

From this point, the original closing cor. of T. 1 S.,
Rs. 35 and 36 E., perpetuated and recorded by Douglas M.
Ferguson, Registered Land Surveyor, No. 848, in 1972,
bears N. $0^{\circ} 31'$ E., 0.06 chs. dist., monumented with an
iron post, $2\frac{1}{2}$ ins. diam., firmly set, projecting 6 ins.
above ground, with brass cap mkd.

T 1 N 36 E S 31

S 1 | S 6
R 35 E | R 36 E
C C
T 1 S
PLS 848
1972

from which the remains of the original bearing trees

A larch snag, 18 ins. diam., bears S. 77° E.,
26 lks. dist., with scribe marks T1S R36E S6 BT
visible on open double blaze. (Record, S. 74° E.,
24 lks.)

A decayed fir stump, size indeterminate, bears
S. 24° W., 41 lks. dist., no marks visible.

and bearing trees mkd. by Ferguson

A fir, 14 ins. diam., bears N. 35° E., 65 lks.
dist., with healed blaze.

A fir, 10 ins. diam., bears S. 33° E., 25 lks.
dist., with healed blaze.

A spruce, 15 ins. diam., bears S. 23° W., 75 lks.
dist., with partially healed blaze.

Add marks AM to brass cap.

From this same point, the standard $\frac{1}{4}$ sec. cor. of sec.
31, T. 1 N., R. 36 E., bears N. $89^{\circ} 51'$ E., 24.44 chs.
dist., described in the field notes of the dependent
resurvey of a portion of the S. bdy. (Willamette Base
Line), T. 1 N., R. 36 E., executed concurrently under
this same group.

Dependent Resurvey of a Portion of the Subdivisional
Lines, T. 1 S., R. 36 E., Willamette Meridian, Oregon

Subdivision of Section 20,
T. 1 S., R. 36 E., Willamette Meridian, Oregon

CHAINS	
21.65	Butcher Creek, 15 lks. wide, course N. 80° E.; asc. over SE. slope.
22.65	Dirt road, 20 lks. wide, bears N. 50° E. and S. 80° W.
38.72	The center W 1/16 sec. cor. of sec. 20.
From the center S 1/16 sec. cor. of sec. 20.	
S. 89° 29' W., on the E. and W. center line of the SW¼ of sec. 20.	
Descend over broken SW. slope.	
20.28	The SW 1/16 sec. cor. of sec. 20.
Descend over SW. slope.	
25.50	Butcher Creek, 20 lks. wide, course NE.; asc. over SE. slope.
26.25	Dirt road, 15 lks. wide, bears N. 60° E. and S. 65° W.
40.55	The true point for the S 1/16 sec. cor. of secs. 19 and 20.
From the center W 1/16 sec. cor. of sec. 20.	
N. 0° 46' E., on the N. and S. center line of the NW¼ of sec. 20.	
Descend along broken E. slope.	
39.45	The W 1/16 sec. cor. of secs. 17 and 20.
GENERAL DESCRIPTION	
<p>The lands encompassed in this survey are located approximately 40 miles southeast of Pendleton, Oregon. Access is by private and Forest Service dirt roads and the Union Pacific Railroad which runs through the bottom of Meacham Canyon.</p>	
<p>The area is drained by numerous small streams that feed into Meacham Creek which drains north out of Meacham Canyon.</p>	
<p>The land is steep and broken, with Meacham Canyon forming a large horseshoe in the north half of the township. The north slopes are heavily timbered and the south slopes are open, with scattering timber in the draws and on the ridge tops.</p>	
<p>The timber is mixed conifer, predominately ponderosa pine, Douglas fir, and stands of western larch.</p>	
<p>The principal uses of the area are livestock grazing and logging.</p>	
<p>The average of several readings taken throughout the area gives a value of 19½° E. for the mean magnetic declination.</p>	

Form 9600-11
(September 1983)

UNITED STATES
DEPARTMENT OF THE INTERIOR
BUREAU OF LAND MANAGEMENT

FIELD ASSISTANTS

NAMES	CAPACITY
Scott R. McIntyre	Surveying Technician
Leslie C. Phillips	Surveying Technician
Gregory P. Fleming	Surveying Aid

of the Willamette Meridian, in the State of Oregon, which are represented in the foregoing field notes as having been executed by (me, us) and under (my, our) direction, and that said survey has been made in strict conformity with said special instructions, the Manual of Instructions for the Survey of the Public Lands of the United States, and in specific manner described in the foregoing field notes.

Lawrence D. Holmes
(Cadastral Surveyor)

September 1, 1987
(Date)

CERTIFICATE OF APPROVAL

BUREAU OF LAND MANAGEMENT
Portland, Oregon

The foregoing field notes of the dependent resurvey of a portion of the west boundary and subdivisional lines, and subdivision of sections 3, 4, 5, 6, 7, 8, 17, 18, 19, and 20, Township 1 south, range 36 east, Willamette Meridian, Oregon,

executed by Lawrence D. Holmes, Cadastral Surveyor, having been critically examined and found correct, are hereby approved.

William W. Blum
XXXXXXXXXXXXXXXXXXXX
(Chief Cadastral Surveyor of Oregon)

July 2, 1987
(Date)

CERTIFICATE OF TRANSCRIPT

I certify that the foregoing transcript of the field notes of the above-described surveys in _____, is a true copy of the original field notes.

XXXXXXXXXXXXXXXXXXXX
(Chief Cadastral Surveyor of Oregon)

(Date)

CERTIFICATE OF SURVEY

(I) ~~(XX)~~, Lawrence D. Holmes, Cadastral Surveyor, HEREBY

CERTIFY upon honor that, in pursuance of special instructions bearing date of the 22nd day of September, 1983, (I) ~~(XX)~~ have dependently resurveyed a portion of the west boundary and subdivisional lines, and subdivided sections 3, 4, 5, 6, 7, 8, 17, 18, 19, and 20, township 1 south, range 36 east,

of the Willamette Meridian, in the State of Oregon, which are represented in the foregoing field notes as having been executed by (me), ~~(us)~~ and under (my) ~~(our)~~ direction; and that said survey has been made in strict conformity with said special instructions, the Manual of Instructions for the Survey of the Public Lands of the United States, and in specific manner described in the foregoing field notes.

June 1, 1987
(Date)

Lawrence D. Holmes
(Cadastral Surveyor)

(Date)

(Cadastral Surveyor)

CERTIFICATE OF APPROVAL

BUREAU OF LAND MANAGEMENT
Portland, Oregon

The foregoing field notes of the dependent resurvey of a portion of the west boundary and subdivisional lines, and subdivision of sections 3, 4, 5, 6, 7, 8, 17, 18, 19, and 20, township 1 south, range 36 east, Willamette Meridian, Oregon,

executed by Lawrence D. Holmes, Cadastral Surveyor, having been critically examined and found correct, are hereby approved.

July 2, 1987
(Date)

William W. Glenn
~~(Signature of Authorized Officer)~~
(Chief Cadastral Surveyor of Oregon)

CERTIFICATE OF TRANSCRIPT

I CERTIFY That the foregoing transcript of the field notes of the above-described surveys in _____, is a true copy of the original field notes.

(Date)

~~(Signature of Authorized Officer)~~
(Chief Cadastral Surveyor of Oregon)