

FIELD NOTES

Of the survey of the Subdivisional

Lines of Townships 1<sup>st</sup> and 2<sup>nd</sup> North

Range 32 East Willamette Meridian, Oregon,

as surveyed by Jas. P. Merrin and Jas. C. Holland

U. S. Deputy Surveyor, under his Contract No. \_\_\_\_\_

dated May 4<sup>th</sup>, 1887

Survey commenced, 27<sup>th</sup> of July, 1887

Survey completed, 29<sup>th</sup> of July, 1887

NAMES AND DUTIES OF ASSISTANTS.

L. S. Woolley, Compassman.

J. M. Henry, Chainman.

J. S. Medley, Chainman.

W. H. Medley, Chainman.

Frank Beecham, Chainman.

R. Rush, Axman.

W. Neatch, Axman.

\_\_\_\_\_, Flagman.

2 PRELIMINARY OATHS OF ASSISTANTS.

We, J. M. Murray J. S. Muddy  
W. H. Muddy and Frank Belshaw.

do solemnly swear that we will faithfully execute the duties of Chain Carriers; that we will level the chain over even and uneven ground, and plumb the tally pins, either by sticking or dropping the same; that we will report the true distance to all notable objects, and the true length of all lines that we will assist in measuring, to the best of our skill and ability, and in accordance with the instructions given us in the survey

of the Subdivisional

lines of Township's 1 & 2

North Range 32 East. Willamette Meridian, Oregon.

J. H. Henry, Chainman.  
J. S. Muddy, Chainman.  
J. H. Muddy, Chainman.  
Frank Belshaw, Chainman.

Subscribed and sworn to before me this 27th

day of July, 1887

[SEAL.]

James P. Kerrin  
U. S. Deputy Surveyor.

We, R. Rush and  
H. Neatch

do solemnly swear that we will well and truly perform the duties of Axmen in the establishment of corners and other duties, according to instructions given us, and to the best of our skill and ability, in the survey of the

Subdivisional Lines of Township's  
1 & 2 North Range 32 East Willamette Meridian, Oregon.

R. Rush, Axman.  
H. Neatch, Axman.

Subscribed and sworn to before me this 27th

day of July, 1887

[SEAL.]

James P. Kerrin  
U. S. Deputy Surveyor

# INDEX

Referring the Lines to the Pages of the Field Notes.

T. 1 North R. 32 East Will. Mer.

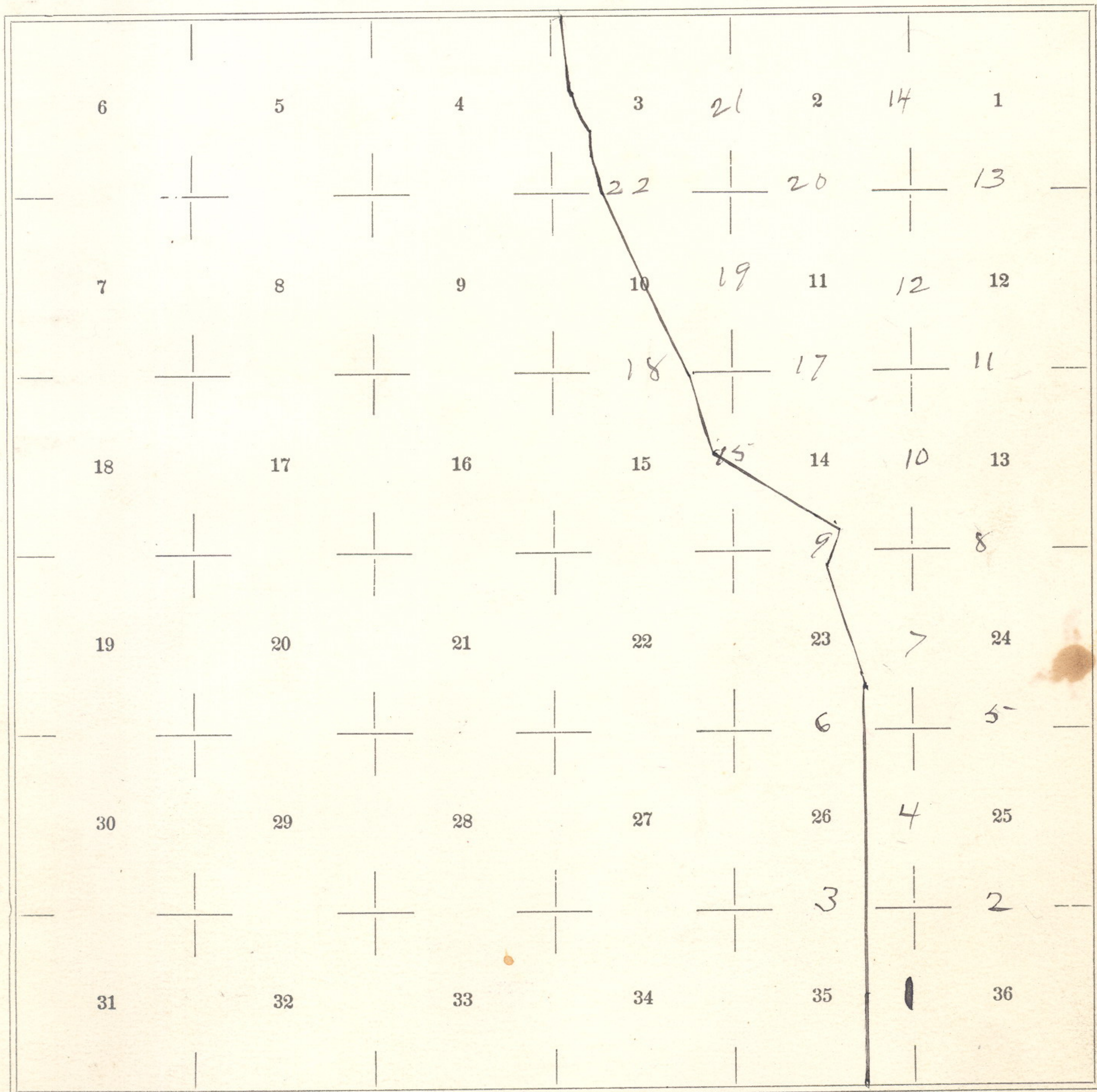

Meanders of \_\_\_\_\_, Pages \_\_\_\_\_ to \_\_\_\_\_

Meanders of \_\_\_\_\_, Pages \_\_\_\_\_ to \_\_\_\_\_

Subdivisions of T. 7 North R. 32 East  
 Willamette Meridian, Oregon.

@ North on true line bet. Secs. 35 & 36  
 Va. 20° 15' East.

- 5.00 Leave creek bottom and ascend ridge
- 6.50 Rimrock + .15-
- 30.50 Summit of ridge
- 40.00 Set Basalt-Stone 10x10x14 ins.

10 ins. in the ground for 1/4 Sec.  
 lev. marked 1/4 on N. face  
 and dug pits 18x18x12 ins. E. & S.  
 of stone 5 1/2 ft. dist and raised  
 a mound of earth 1 1/2 ft. high  
 3 1/2 ft. base Alongside.

- 80.00 Set Stone 12x10x9 ins. 8 ins. in  
 the ground for lev. to Secs.  
 25-26 33 & 36 marked with 1 notch  
 on E. & S. faces. Dug pits 18x18x  
 12 ins in each sec. 5 1/2 ft. dist.  
 and raised a mound of earth  
 2 ft high with 4 1/2 ft. base over pit  
 and rolling. Soil S. 1/2 Rocky  
 N. 1/2 Good. No timber. Poor bunch grass

Subdivisions of T. 1 North R. 32 East  
Willamette Meridian, Oregon.

(8093-10 M.)

East On Random bet. Secs. 25 & 36

Va. 21° East.

40.00 Set imp.  $\frac{1}{4}$  Sec. lev.

79.75 Intersect Township line. 25 Mts.

S. of lev. to <sup>Secs</sup> 25 & 36.

Thence S. 89° 49' W. on true line

Va. 20° East.

39.87 Set Basalt Stone 18x10x8 ins.

12 ins. in the ground, for  $\frac{1}{4}$  Sec.

lev. marked  $\frac{1}{4}$  on N. face

dug pits 18x18x12 ins. E & W. of

Stone 5 $\frac{1}{2}$  ft. dist. And raised a

mound of Earth 1 $\frac{1}{2}$  ft. high with

3 $\frac{1}{2}$  ft. base along side

49.75 Dry gull course N.W. - 50

71.75 " " " " N. - 25

79.75 To lev. to Secs. 25-26-35-8 36

Land rolling. Soil 1<sup>st</sup> rate

No timber.

Poor bunch Grass & Sage brush.

Subdivisions of T. 1 North R. 32 East  
Willamette Meridian, Oregon.

West on Random br. sec. 26735

Co. 21° East

- 4000 Old  $\frac{1}{4}$  sec. cor. found mound & pits  
Re-established old cor. with a  
Stone 7x8x9 ins. 6 ins. in the  
ground, redug pits & raised a  
mound of earth <sup>( $1\frac{1}{2}$  ft high  $3\frac{1}{2}$  ft base)</sup> alongside
- Chance East on true line
- 500 Brow of hill course N. & S. — 200
- 700 Enter creek bottom
- 1200 Intersect U. R. bdy. Set a stone  
14x14x14 ins. 10 ins. in the ground  
for U. R. showing cor. marked  
U. R. c. c. on E. face, dug pits  
18x18x12 ins. E. N. & S.  $5\frac{1}{2}$  ft. dist  
I raised a mound of  
Earth 2 ft. high with  $4\frac{1}{2}$  ft. base *over it*
- 1500 West of creek 75 Mcs. wide course N.
- 2000 Enter field
- 2500 Leave field

Subdivisions of T. 1 North R. 32 East  
Willamette Meridian, Oregon.

(8093-10 M.)

40.00 To loc. to Secs. 25-26-35+36  
Land rolling. Soil good.  
Cattawood timber & underbrush  
Sage brush & poor grass on  
North On true line bet. Secs. 25+26  
Va. 21° East.

39.75 To old "4" Sec. loc. found mound & pits  
Set stone 8x10x16 ins. 12 ins. in the  
ground for "4" Sec. loc. marked "4" on  
W. face. Rect. pits 18x18x12 ins.  
N. + S. 5 1/2 ft. dist. from stone and  
raised a mound of earth 18 ins.  
high with 3 1/2 ft. base alongside

57.00 Dry gulch course N.W. - 50  
62.50 Creek bottom

79.50 Found Old loc. Stone to Secs.  
23-24-25+26 8x10x18 ins. marked  
with 1 notch on E. and 2 on S. Edges  
I raised a mound of  
Stone 2 ft. high with 4 1/2 ft. base over  
Pits impracticable. Land gently rolling & level  
Poor brush grass & cattawood. Sage. No timber

Subdivisions of T. 1 North R. 32 East  
Willamette Meridian, Oregon.

East On Random Bet. Secs. 24 & 25

Va. 21° East.

40.00 Set temp.  $\frac{1}{4}$  Sec. lev.

79.60 Intersect Township line 50 Mts. South  
of lev. to Secs. 24 & 25.

Thence S.  $89^{\circ} 39'$  W. on true line

Va. 20° East.

4.50 Level below hollow and record

38.80 Old  $\frac{1}{4}$  lev. found pits and mound.

Set stone  $8 \times 12 \times 14$  ins. 10 ins. in the ground  
for  $\frac{1}{4}$  sec. lev. marked  $\frac{1}{4}$  on N. face

Red dug pits  $18 \times 18 \times 12$  ins. E. & W.  $5\frac{1}{2}$  ft.

dist from stone and raised a mound of

each  $18$  ins. high

$3\frac{1}{2}$  ft. base over it

54.00 Gulch, house N.W.

75.50 Enter Creek bottom.

79.60 To lev. to Secs. 23-24-25 & 26

Land rolling Soil  $\frac{1}{2}$  rate.  
Scattering cotton wood in bottom  
over grass + Sage brush



Subdivisions of T. 7 North R. 32 East  
Willamette Meridian, Oregon.

(8093-10 M.)

- West On Random bet. Secs. 23 & 26  
Va. 21° East.
- 40.00 Set stump  $\frac{1}{4}$  Sec. cor.
- 80.00 To a point 80 lks. North of old cor.  
Thence N. 89° 26' East. On true line
- 5.50 Pendleton and Pilot Rock Wagon Road
- 15.00 Summit of ridge course N. & S.
- 40.00 Set a stone 6x8x10 ins. 7 ins. in  
the ground for  $\frac{1}{4}$  Sec. cor. marked  
 $\frac{1}{4}$  on N. face, dug pits 18x18x12 ins  
E x W. 5 $\frac{1}{2}$  ft. dist from stone and  
raised a mound of earth 1 $\frac{1}{2}$  ft.  
high 3 $\frac{1}{2}$  ft. base over it
- 51.00 McKay Creek runs N. W.
- 52.00 Intersect U. R. body in center  
at point 65 lks north of true corner  
of creek. Set stone 6x12x14 ins.  
10 ins. in the ground  
on N. bank of creek for witness cor.  
marked U. R. C. C. W. C. from which  
a cottonwood 12 ins. diam. bears S. 50° W.  
37 lks. dist marked U. R. C. C. W. C. B. J.

7  
17

Subdivisions of T. 1 North R. 32 East.  
Willamette Meridian, Oregon.

and a Cottonwood 8 ins. diam.  
beams. N. 35° W. 15 Mts. dist marked  
U. R. C. C. W. C. B. D.

80.00 Do. Cor. to Secs. 23-24-25 & 26.

Land polling. Soil 1<sup>st</sup> rate.  
Cottonwood along creek - bunch grow

North on True Line Bet. Secs. 23 & 24  
Va. 21° East.

21.25 Spring Branch 2 Mts. wide

31.50 Leave creek bottom

39.80 To old  $\frac{1}{4}$  Sec. cor. Reestablished cor.

Set Stone 16X10X8 ins. 12 ins in the  
ground for  $\frac{1}{4}$  Sec. Cor. marked  $\frac{1}{4}$  on  
W. face, dug pits 18X18X12 ins. N. Y. S.

from stone 5 $\frac{1}{2}$  ft. dist and

raised a mound of Earth 1 $\frac{1}{2}$  ft.

high 3 $\frac{1}{2}$  ft. base along side

71.50 Dry ditch on side of hill course W.

79.60 Found and reestablished old cor. to

Secs. 13-14-23 & 24. Set Stone 10X8X8 ins.

Subdivisions of T. 1 North R. 32 East  
Willamette Meridian, Oregon.

(8093-10 M.)

6 ins. in the ground marked with  
3 notches on S. and 1 on E. edges.  
Dug pits 18x18x12 ins. in each  
Sec. 5½ ft. dist. and raised a  
mound of earth 2 ft. high with  
4½ ft. base alongside. In edge  
of bottom.

Land rolling. Soil 1<sup>st</sup> rate.  
Scattering Cotton wood along with  
poor grass

East on Random Bet. Secs. 13 & 24

Va. 20° 15' East.

40.00 Set temp. ¼ sec. cor.

79.71 Intersect Township line 24 lbs. N. of cor.  
to Secs. 13 & 24. Thence N. 89° 50' W.

on true line

Va. 19° East.

39.85 Set Stone 6x7x10 ins. 7 ins. in the  
ground for ¼ sec. cor. marked ¼ on  
N. face, Dug pits 18x18x12 ins.  
E. & W. of stone 5½ ft. dist. and

Subdivisions of T. 1 North R. 32 East  
 Willamette Meridian, Oregon.

60.00 raised a mound of earth 18 ins. high with 3 1/2 ft. base alongside Summit of ridge course N. + S. Descend.

79.77 Do Cor. to Secs. 13-14-23 + 24 Land polling. Soil 1st rate. Poor grass + Sage brush

West On Random bet. Secs. 14 + 23

Va. 20° 30' East.

40.00 Found old 1/4 sec. lev. { which is a post-formly set in the ground in mound of earth with Thence East on true line pits East N. of post

3.00 Intersect U.R. bay. Set stone 10x10x10 ins. 7 ins. in the ground for U.R. closing lev. marked U.R. C.C. on E face dug pits

18x18x12 ins. E. N. + S. from

lev. 5 1/2 ft. dist raised

a mound of earth 2 ft. high

4 1/2 ft. base. over it

10.00 Mc Kay bank 5 dikes wide runs N.

## Subdivisions of T. 1 North R. 32 East.

Willamette Meridian, Oregon.

(8093-10 M.)

2300 Spring branch 2 lks. wide runs N.W.

4000 Do loc. to secs. 13-14-23 &amp; 24

Land mostly level bottom.

Some gravel. Soil 2<sup>nd</sup> rate.

Cuttimud + Thorn along creek for grass

@ North on true line bet. secs. 13 &amp; 14

Va. 20° 30' East.

3925 Set Stone 18x10x8 ins. 12 ins. in  
the ground for  $\frac{1}{4}$  Sec. loc. marked  
 $\frac{1}{4}$  on W. face, Aug. pits 18x18x12  
ins. N. & S. from stone 5 $\frac{1}{2}$  ft. distI raised a mound of  
Earth  $1\frac{1}{2}$  ft. high <sup>over it</sup>  $3\frac{1}{2}$  ft. base

4950 Bottom of hollow course W. -50

5650 Summit of hill course W. +80

7310 Wagon Road course N.E.

7850 Do old loc. Set stone 7x8x9 ins.

6 ins. in the ground for loc. to

secs. 11-12-13 &amp; 14 marked with 4

notches on S. and 1 on E. edges, Aug.

Subdivisions of T. 1 North R. 32 East.  
Willamette Meridian, Oregon.

(M 01-1000)

Pits 18x18x12 ins. in each sec.  
5 1/2 ft. dist. and raised a mound  
of earth 2 ft. high with 4 1/2 ft. base  
over it.  
Land rolling. Soil flat.  
No timber nor much grass

East On Random Bct. Secs. 12 & 13  
Va. 20° East.

40.00 Set temp. 1/4 Sec. cor.  
79.73 Intersect Township line 1.33 chs.  
S. of cor. to sec. 12 & 13  
Thence S. 89° 03' W. on true line  
Va. 21° East.

20.00 Summit of Hill + 15.0  
35.00 Hollow course N.W.  
39.87 To old 1/4 Sec. cor. Set a post 3 ft.  
long & 3 ins. square 24 ins. in the  
ground for 1/4 Sec. cor. marked 1/4 S. on  
N. face and reding pits. E & W.  
from post 5 1/2 ft. dist.

Subdivisions of T. 1 North R. 32 East

Willamette Meridian, Oregon.

(8093-10 M.)

50.00 I raised a mound of earth  
 18 ins. high with 3 1/2 ft. base  
 over it. ~~over it.~~  
 Hollow course N.W.

72.00 Wagon Road course N.E.

79.75 Do. Sec. to Secs. 11-12-13+14

Land rolling. Some grass  
 Soil 1<sup>st</sup> class  
 No timber poor bunch grass

North on true line bet. Secs. 11+12  
 Va. 20" East.

3996 Old 1/4 sec. cor. Best stone 7x8x10 ins.  
 6 ins. in the ground for 1/4 sec. cor.  
 marked 1/4 on W. face. Riding pits  
 18x18x12 ins. N. & S. from stone  
 5 1/2 ft. dist And raised a mound  
 of earth 1 1/2 ft. high with 3 1/2 ft. base  
 Alongside

45.50 Trail bears N.W.

57.30 Summit of hill + 100

63.00 Gulch or hollow. - 100

Subdivisions of T. 1 North R. 32 East

Willamette Meridian, Oregon.

(18 01-500)

79.50 To old lev. Set Stone 12x8x8 ins.  
 8 ins in the ground for lev. to  
 Secs. 1-2-11+12 marked with 5  
 notches on S. and 1 on E. edges  
 Dug pits. 18x18x12 ins. in each sec.  
 5 1/2 ft. dist. And raised a  
 mound of earth 2 ft. high  
 4 1/2 ft. base alongside  
 Land polling. 1st 1/2 good  
 last 1/2 poor soil.  
 No timber - poor bunch grass

East On Random Bct. <sup>Secs</sup> 1+12  
 Va. 20° East.

40.00 Set temp. 1/4 Sec. lev.

80.00 Intersect Township line 1.31 chs. S.  
 of lev. to Secs. 1+12.  
 Thence S. 89° 04' W. on true line  
 Va. 20° 45' East.

4.25 Road course S. W.

40.00 Old lev. deposited a charred stake



Subdivisions of T. 1 North R. 32 East.

Willamette Meridian, Oregon.

(8093-10 M.)

12 ins. in the ground for  $\frac{1}{4}$  sec. lev.  
 Aug pits. 18x18x12 ins. E. & W. of  
 stake  $5\frac{1}{2}$  ft. dist. and raised a  
 mound of earth  $1\frac{1}{2}$  ft. high <sup>in the E. pit</sup>  
 $3\frac{1}{2}$  ft. base over it. And drove  
 a stake 2 ft. long  $2\frac{1}{2}$  ins square  
 12 ins. in the ground marked  
 $\frac{1}{4}$  S. on N. face.

- 5600 Hollow course S. - 20
- 6500 " " S. W. - 20
- 8000 To cor. to Secs. 1-2-11 & 12

Land rolling. Soil good.  
 No timber but bunch grass

North on Randow bet. Secs. 1 & 2  
 Va 20° East.

- 4000 Set temp.  $\frac{1}{4}$  Sec. lev.
- 7980 Intersect Township line 15 lbs.  
 W. of cor. to Secs. 1-2-35 & 36  
 Thence S. 56' W. on true line  
 Va. 21° 30' East.

Subdivisions of T. 1 North R. 32 East  
Willamette Meridian, Oregon.

- 400 Flat corner W. — 100
- 39.80 Set a stone 7x8x9 ins. 6 ins. in  
the ground for  $\frac{1}{4}$  sec. cor. marked  
in on W. face. Dig pits 18x18x12 ins.  
N.E.S. of stone  $5\frac{1}{2}$  ft. dist. and  
raised a mound of earth  $1\frac{1}{2}$  ft.  
high  $3\frac{1}{2}$  ft. base over it.
- 79.80 Do cor. to Secs. 1-2-11 & 12.  
Land polling. Soil good.  
Stomper Scattering Bunch Grass

North bet Secs. 14 & 15

Beginning at the old  $\frac{1}{4}$  sec. cor.  
bet. Secs. 14 & 15. which is a  
stone 12x9x8 ins. 8 ins. in the  
ground marked  $\frac{1}{4}$  on W. face  
with pits 18x18x12 ins. N.E.S.  
from stone  $5\frac{1}{2}$  ft. dist. with  
mound of earth — Thence N.  
on true line.

Subdivisions of T. 1 North R. 32 East.

Willamette Meridian, Oregon.

(8093-10 M.)

Va. 21° East.

300 Intersect U R bdy. and  
 Set a stone 10x10x12 ins. 8 ins.  
 in the ground for U. R. closing cor.  
 marked U. R. c. c. on N. face  
 Dug pits 18x18x12 ins. N. E. & W.  
 of stone 5½ ft. dist. and  
 raised a mound of earth  
 2 ft. high 4½ ft. base over it

2900 Wagon Road course S. W.

4000 To old cor. to Secs 10-11-14 & 15  
 which I reestablished by setting  
 a stone 5x8x12 ins. 8 ins.  
 in the ground with 4 notches  
 on the S. and 2 on E. edges  
 Dug pits 18x18x12 ins. in each  
 sec. 5½ ft. dist. and raised  
 a mound of earth 2 ft.  
 high 4½ ft. base over it  
 Land rolling. Soil 1<sup>st</sup> rate  
 No timber poor Grass

Subdivisions of T. 1 North R. 32 East. Willamette Meridian, Oregon.

(18 01-600)

East On Random Bet. Secs. 11 & 14

Va. 20° 15' East.

40.00 Set temp. 1/4 Sec. cor.

79.60 Intersect East. bdy. 45 Mts. S. of Cor. to Secs. 11-12-13 & 14.

Thence S. 89° 41' W. on true line

Va. 20° East.

15.00 Creek Bottom course N & S. - 100

36.90 Mc Kay Creek 50 Mts. wide N.

39.80 Found old 1/4 Sec. cor. post was rotten. Set stone

7x8x12 ins. 8 ins. in the

ground for 1/4 Sec. cor.

Marked 1/4 on N. face

from which A. B. also 12 ins.

diam. bears S. 57° W. 33 Mts.

dist. marked 1/4 S. B. D.

(No other trees within limits)

And raised a mound of

stone 18 ins. high 3 1/2 ft base

48.00 Wagon Road and leave creek bottom

1828

Subdivisions of T. 1 North R. 32 East

Willamette Meridian, Oregon.

(8093-10 M.)

60.25 Pendleton and Pilot Rock Wagon Road  
79.60 Do cor. Secs. 10-11-14+15

Land rolling. Soil 1<sup>st</sup> rate  
No timber good grass

West On Random Bet. Secs. 10 & 15  
Va. 20" 30' East.

39.75 Do a point 15 lks. S. of old "4 sec.  
cor. Thence S. 89" 47' East on  
true line

Va. 20" 30' East.

22.00 Intersect U.R. bdy. and set  
a stone 10x10x10 ins. 7 ins. in the  
ground for U.R. closing cor.  
marked U.R. c.c. on E. face  
and raised a mound of  
stone 2 ft. high 4 1/2 ft. base  
over it

22.50 Leave field course N. and S.

39.75 Do cor. to Secs. 10-11-14+15 Land  
rolling. Soil 1<sup>st</sup> rate.  
No timber Poor bunch grass

Subdivisions of T. 1 North R. 32 East  
Willamette Meridian, Oregon.

(R. 01-500)

North On True Line Bel. Sec. 10 & 11  
Va. 20° 30' East,

28.00 Summit of Hill + 50

39.50 Gulch - Course N.E. - 50

39.70 Set Stone 7x8x9 ins. 6 ins.  
in the ground for 1/4 sec. line  
marked 1/4 on W. face, dug  
Pits 18x18x12 ins. N. & S. from  
Stone 5 1/2 ft. dist and  
raised a mound of earth  
1 1/2 ft. high 3 1/2 ft. base  
over it

28.00 Summit of Hill + 50

76.25 Fork of Mc Kay Creek  
15 lbs. wide - Course N.W. - 50

79.40 To Old Sec line to Secs 2-3-10 & 11  
Set Stone 8x10x12 ins. 8 ins.  
in the ground marked with  
5 notches on S. and 2 on E. edges  
I raised a mound  
over it  
Stone 2 ft. high 4 1/2 ft. base Soil 1<sup>st</sup> rate  
Land rolling - Scaevola cottonwood on creek - Poor grass

20 30

Subdivisions of T. 1 North R. 32 East  
Willamette Meridian, Oregon.

(8093-10 M.)

East On R. random 3rd. Secs. 2 & 11  
Va. 20° 30' East.

40.00 Set trip. "4 Sec. Cor.

79.25 Entered E. bdy. 50 lks. S. of  
Cor. to Secs. 1-2-11 & 12 Thence  
S 89° 39' W. on true line

35.00 Summit of Bluff + 175

39.62 Set stone 10x9x8 ins. 7 ins. in  
the ground for 1/4 sec. cor.  
marked "4 on N. face, Aug  
pits 18x18x12 ins. E and W of  
stone 5 1/2 ft. dist. and raised  
a mound of earth 1 1/2 ft. high  
3 1/2 ft. base alongside

50.00 Gulch - 50

51.00 Bluff of rock + 20

61.00 Enter field of Indian

70.25 Mc Kay Creek 50 lks. course W.

79.25 To cor. to Secs. 2-3-10 & 11

Land broken. Soil good.  
Cattunwood Thorn & willow along creek  
Pine grass

Subdivisions of T. 1 North R. 32 East.  
Willamette Meridian, Oregon.

random  
North on ~~true~~ line bet. Secs 2 + 3  
Va. 20° 30' East.

40.00 Set temp.  $\frac{1}{4}$  Sec. Cor.  
80.50 Intersect Township line 40 Mos.  
E. of Cor. to Secs. 2-3-34 + 35  
Thence S. 17' East on true line  
Va. 20° East.

13.00 McRay Creek 50 Mos. wide, NW. <sup>runs</sup>

40.50 Set Basalt Stone 8x10x14 ins. 10 ins.  
in the ground for  $\frac{1}{4}$  Sec. Cor.  
marked  $\frac{1}{4}$  on W. face from which  
A Balu 24 ins. diam. bears N.  
20° W. 1.20 chs. dist marked  
 $\frac{1}{4}$  S. B. @. No other trees within  
limits. Raised a mound of  
stone 1 1/2 ft. high 3 1/2 ft.  
base along side.

80.50 Do Cor. to Secs. 2-3-10 + 11  
Land rolling. Considerable  
mud-brown in bottom consisting  
of thorn ~~and~~ willow. Soil 1st rate.



22  
32

Subdivisions of T. 1 North R. 32 East  
Willamette Meridian, Oregon.

(8093-10 M.)

West On Random Bet. Secs. 3+10.  
Va. 20" 30' East.

4000 Set temp. 4 sec. lev.

8000 Intersect U. R. bdy. 7 lbs. S. of  
lev. to Secs. 3-4-9+10.

Thence S. 89" 57' East on  
tripline

Va. Same

800 Leave Birch Creek bottom and  
Ascend

2200 Enter field + 200

3500 Intersect U. R. bdy. and  
Set a stone 10x10x12 ins. 8 ins.  
in the ground for U. R. marking  
lev. Marked U. R. l. l. on  
E. face. Dug pits 18x18x12 ins  
E. N. and S. 1 from stone  
6 1/2 ft. dist. And raised a  
mound of earth over it

3700 Wire fence of leave field

Subdivisions of T. 1 North R. 32 East  
Willamette Meridian, Oregon.

- 38.00 Wagon Road beams. N.S.
- 40.00 Set post 3 ft. long 3 ins. square, 24 ins. in the ground for 1/4 sec. line marked 1/4 S. on N. face. Dug pits 18x18x12 ins. E. & W. from post. 5 1/2 ft. dist.
- 62.00 Carion house S.W.-150
- 75.00 Mc Kay creek bottom.
- 79.00 Branch of Mc Kay creek 25 ft. wide
- 80.00 Do line to sec. 2-3-10 & 11

July 27th 1887

Land rolling  
Soil 1st rate.

Scattering cottonwood along Mc Kay  
poor bunch grass. This Township is  
rolling + bottom land. The bottom is  
barren + very poor with some cottonwood  
thorn + willow rolling land good

Subdivisions of T. 2 North R. 32 East  
 Willamette Meridian, Oregon.

Survey commenced July 27<sup>th</sup> 1887

(8093-10 M.)

with a Burt's Improved Solar Com.

Commenced at the corner to Secs. 1-2-35+36 on E. side of Township Iron.

North on Random bet. Secs. 35 & 36

Na. 21° East.

45.00 Set trip. 1/4 Sec. lev.

79.70 Entered line 30 lks. East of old lev. to Secs. 25-26 35 & 36

which I reestablished by setting stone 20x12x8 ins. 14 ins. in the

ground marked with 1 notch on E. and S. edges redug pits 18x18x12 ins. in each Sec. 5 ft.

dist. from stone and raised a mound of earth 2 ft. high 4 1/2 ft. base over it

Thence S. 13' East on true line

Na. 21° East

1.70 Summit of hill + 90

11.70 Gulch - 30

14.70 Summit of point + 40

22.20 Spring Branch 2 lks. wide course W. line passes about 2.50 chs. W. of Spring.

FINAL OATHS FOR SURVEYS.

A list of the names of the individuals employed by *Jas. P. Currier* and *Jas. E. Noland*, U. S. Deputy Surveyor, to assist in running, measuring, and marking the lines and corners described in the foregoing field notes of the survey of the *Subdivisional* lines of *Townships 1 & 2* North Range 32 East Willamette Meridian, Oregon, showing the respective capacities in which they acted:

- ....., Compassman.
- J. H. Henry*....., Chainman.
- J. S. Medley*....., Chainman.
- W. H. Medley*....., Chainman.
- Frank Belshaw*....., Chainman.
- R. Rush*....., Axman.
- H. Neatch*....., Axman.
- ....., Flagman.

FINAL OATHS OF ASSISTANTS.

We hereby certify that we assisted *Jas. P. Currier* and *Jas. E. Noland*, U. S. Deputy Surveyor, in surveying all those parts or portions of the *Subdivisional* lines of *Townships 1 & 2* North Range 32 East Willamette Meridian, Oregon, as represented in the foregoing field notes as having been surveyed by him and under his direction; and that said survey has been in all respects, to the best of our knowledge and belief, well and faithfully surveyed, and the corner monuments established, according to the instructions furnished by the U. S. Surveyor General of Oregon.

- ....., Compassman.
- J. H. Henry*....., Chainman.
- J. S. Medley*....., Chainman.
- W. H. Medley*....., Chainman.
- Frank Belshaw*....., Chainman.
- R. Rush*....., Axman.
- H. Neatch*....., Axman.
- ....., Flagman.

Subscribed and sworn to before me this *29th* day of

*July*, 1887.

[SEAL.] *James P. Currier*  
U. S. Deputy Surveyor.

## FINAL OATH OF DEPUTY SURVEYOR.

I, W. Jas. P. Currier & James E. Toland, United States  
 Deputy Surveyor, do solemnly swear that in pursuance of instructions  
 received from Douglas N. Taylor, U. S.  
 Surveyor General for Oregon, bearing date of the 13<sup>th</sup>  
 day of May, 1887, I have well, faithfully,  
 and truly, in my own proper person, and in strict conformity with the  
 instructions furnished by the U. S. Surveyor General for Oregon, the  
 Surveying Manual, and the laws of the United States, surveying all  
 those parts or portions of T 1 & 2 N. R. 32 E.

Willamette Meridian, in the State of Oregon, as are represented in the  
 foregoing field notes as having been surveyed by me and under my  
 directions; and I do further solemnly swear that all the corners of said  
 survey have been established and perpetuated in strict accordance with  
 the Surveying Manual, printed instructions, the special written instruc-  
 tions of the U. S. Surveyor General for Oregon, and in the specific man-  
 ner described in the field notes, and that the foregoing are the *true* field  
 notes of such survey, and should any fraud be detected I will suffer the  
 penalty of perjury under the provisions of an act of Congress approved  
 August 8, 1846.

James P. Currier & James E. Toland  
 U. S. Deputy Surveyor.

Subscribed and sworn to before me this Fifteenth  
 day of February, 1888

A. Woodcock  
 Notary Public  
 for Oregon

Office of U. S. Surveyor General,

Portland, Oregon, July 20<sup>th</sup>, 1888.

The following Field Notes of the Survey of the  
 Subdivisional Lines of  
 Townships 1<sup>st</sup> and 2 North  
 Range 32 East Will Mer Or  
 executed by James P. Currier<sup>rd</sup> and James E. Roland  
 Special Joint  
 under his Contract No. \_\_\_\_\_, dated May 4<sup>th</sup>  
 \_\_\_\_\_, 1887, having been critically examined,  
 the necessary corrections and explanations made, the  
 said Field Notes and the survey they describe, are  
 hereby approved.

Douglas W. Taylor  
 Surveyor General.