

USDA-FOREST SERVICE

Index

File No. Z-25

CORNER RECORD (SEARCH)

(Ref. FSM 7151.4)

Tract or

Survey No. \_\_\_\_\_

Cor.

No. SE

T 6 S. R. 34 E.

R.D. NORTH FORK JOHN DAY County UMATILLA

Merid. WILLAMETTE

N.F. UMATILLA State OREGON

CORNER DIAGRAM

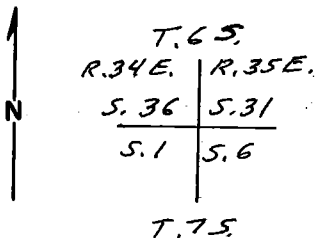

DESCRIBE CORNER MONUMENT FOUND

STONE 18" X 9" X 7" (20" X 20" X 8") W/6 NOTCHES ON EACH EDGE, SET FIRMLY IN PLACE.

DESCRIBE BEARING TREES OR OTHER OFFICIAL ACCESSORIES FOUND <sup>2</sup>

- ① (10") LODGEPOLE PINE, N. 36° E., 34 LKS, BT SCRIBES & CHAINING NOTCHED, DEP.
- ② 13" D.B.H. (11") LODGEPOLE PINE, DEAD & DOWN, S. 38° E., 34 LKS., SCRIBED T75R35E56 BT.
- ③ STUMP HOLE, S. 60° W., 23 LKS.
- ④ ROTTEN WOOD IN STUMP HOLE, N. 70° W., 29 LKS.

PHOTO IDENTIFICATION DATA

Photo No. 580-57

Filed At. PENDLETON

Object Ident. PRECISE

Ident. By \_\_\_\_\_

Signature \_\_\_\_\_

PLANE COORDINATE POSITION DATA

State \_\_\_\_\_ Zone \_\_\_\_\_

X \_\_\_\_\_

Y \_\_\_\_\_

Estab. By \_\_\_\_\_

Agency \_\_\_\_\_

Signature \_\_\_\_\_

Title \_\_\_\_\_

Division \_\_\_\_\_

Headquarters \_\_\_\_\_

Date \_\_\_\_\_

FS-7100-52 (9/68)

*Clayton J. [Signature]*

LAND SURVEYOR

10/25/86

### CORNER RECORD (PERPETUATION)

MONUMENT: DESCRIBE NEW MONUMENT SET, OR WORK DONE TO PRESERVE EXISTING MONUMENT

SET A 2 1/2" DIAM. ALUM. CAP ON A 2 1/2" X 30" ALUM. PIPE W/FLARE  
 AT BOTTOM AT CORNER AND BURIED CORNERSTONE ALONGSIDE PIPE.  
 CAP MKD. PER SKETCH.  
 SET STEEL POSTS 4' E W. & N. W/PROP. BNDRY., ATTN. AND  
 MON. SIGNS ATTACHED.

T 65  
 R34E R35E  
 536 | 531  
 51 | 56  
 T 75  
 RPLS 1910  
 1986

ACCESSORIES : DESCRIBE NEW BT'S WITNESS OBJECTS ETC. ESTABLISHED, OR WORK DONE TO PRESERVE EXISTING EVIDENCE

- ① 9" D.B.H. LODGEPOLE PINE, S. 11 1/2' W., 116.3', SCRIBED T 75 R34E S1 BT.
- ② 11" D.B.H. LODGEPOLE PINE, N. 89 1/2' W., 19.0', SCRIBED T 65 R34E S36 BT.
- ③ 7" D.B.H. LODGEPOLE PINE, N. 43° E, 76.9', SCRIBED T 65 R35E S31 BT.
- ④ 21" D.B.H. SPRUCE, S. 20 1/2' E., 99.8', SCRIBED T 75 R35E S6 BT.

Work Done By G. J. MARTIN Title LAND SURVEYOR Date 10/25/86 State Registration No. LS 1910  
 or Agency

Certified Cor. Record Prepared? Yes  (No) Filed At: \_\_\_\_\_ Date \_\_\_\_\_

REMARKS

Index File No. Z-25 T. 65 R. 34 E. M. WILLAMETTE Tract or Surv. No. Cor 36/31  
176

USDA-FOREST SERVICE

Index  
File No. E-25

CORNER RECORD (SEARCH)

(Ref. FSM 7151.4)

Tract or Survey No. \_\_\_\_\_ Cor. No. \_\_\_\_\_

T 65 R. 34E

R.D. Utah Dale County Umatilla # GRANT

Merid. Will

N.F. Umatilla State Oregon

CORNER DIAGRAM

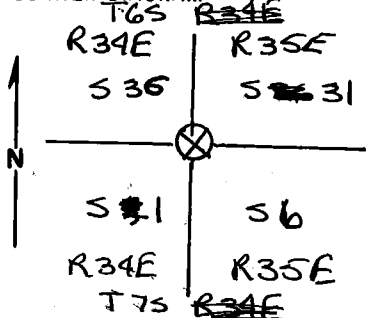

DESCRIBE CORNER MONUMENT FOUND

None found.

DESCRIBE BEARING TREES OR OTHER OFFICIAL ACCESSORIES FOUND

10" Lodgepole pine with scribing "56" on NW face is now down at top of highway embankment and has 2 k-tags on it.

PHOTO IDENTIFICATION DATA

Photo No. \_\_\_\_\_  
Filed At. \_\_\_\_\_  
Object Ident. \_\_\_\_\_  
Ident. By \_\_\_\_\_  
*Signature*

DESCRIBE CORNER LOCATION RELATIVE TO NEAR-BY FEATURES, ALSO HOW TO REACH CORNER

Located about 50ft east of enter and leave signs on highway. (Rd. 52)

PLANE COORDINATE POSITION DATA

State \_\_\_\_\_ Zone \_\_\_\_\_  
X \_\_\_\_\_  
Y \_\_\_\_\_  
Estab. By \_\_\_\_\_  
*Agency*

*Signature*  
Cathy M. McGuire

*Title*  
Volunteer

*Division*

*Headquarters*

SO

*Date*

8/7/87

7100-52-(3,68)

**CORNER RECORD (PERPETUATION)**

**MONUMENT : DESCRIBE NEW MONUMENT SET, OR WORK DONE TO PRESERVE EXISTING MONUMENT**

**ACCESSORIES : DESCRIBE NEW BT'S WITNESS OBJECTS ETC. ESTABLISHED, OR WORK DONE TO PRESERVE EXISTING EVIDENCE**

Work Done By \_\_\_\_\_ Title \_\_\_\_\_ Date \_\_\_\_\_ State Registration No. \_\_\_\_\_  
or Agency \_\_\_\_\_

Certified Cor. Record Prepared ? Yes No Filed At: \_\_\_\_\_ Date \_\_\_\_\_

**REMARKS**

Index File No. T. R. M. Tract or Surv. No. Cor.

LAND CORNER RECORD

1. T 6S R 34E No. 225 Cor. Sec Mer. Will State Oregon (Rectangular) N. F. Umatilla Dist. Dale 4

2. Corner Status

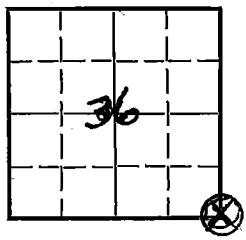

3. Original Description \_\_\_\_\_ Vol. \_\_\_\_\_ Page \_\_\_\_\_ Where Recorded \_\_\_\_\_

4. Description of Corners:  
Corner searched for but could only find BTs  
No information available

5. Investigation Notes:

Found BT--Lodge pole 10" DBH with scribing on North West face ( S6)

Found BT--Dead log with scribing (T7S R34E S31)

7. Photo Identification  
Photo No. EBH 8-7 Line 17  
Ident. By: \_\_\_\_\_

8. Plane Coordinate Position Data  
State \_\_\_\_\_ Zone \_\_\_\_\_  
X \_\_\_\_\_  
Y \_\_\_\_\_  
Estab. By \_\_\_\_\_  
Field Book No. \_\_\_\_\_  
Where Filed \_\_\_\_\_

9. Evaluation  
Authentic \_\_\_\_\_  
Needs Verif. \_\_\_\_\_ Monument No  
Re-estab. X Survey \_\_\_\_\_  
Land Status \_\_\_\_\_

6. Signed A. Heilmeyer Title Survey Aid Date 12-20-65

PERPETUATION RECORD

10. Monument:

11. Accessories

Field Book \_\_\_\_\_ Page \_\_\_\_\_

12. Set By \_\_\_\_\_ Title \_\_\_\_\_

13. Recorded By \_\_\_\_\_ Volume \_\_\_\_\_ Page \_\_\_\_\_  
(Agency)

License \_\_\_\_\_ Agency \_\_\_\_\_ Date \_\_\_\_\_

(Date) (City) (County) (State)

14. Remarks:

Z-25