

CORNER RECORD (SEARCH)

(Ref. FSM 5151.4)

Tract or
Survey No.

**North Fork
John Dav Unit**

Cor.
No. **AP-432**

T. 7 S. R. 33 E.
Merid. Willamette

R.D. North Fork John Day County Grant
N.F. Umatilla State Oregon

CORNER DIAGRAM

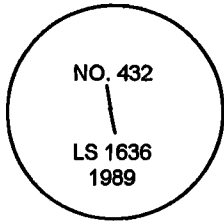

DESCRIBE CORNER MONUMENT FOUND

Found a 2 1/2" aluminum capped aluminum pipe in good condition, protruding 8" above the ground.

DESCRIBE BEARING TREES OR OTHER OFFICIAL ACCESSORIES FOUND

9" Western Larch Snag with badly burnt face, no scribes remain, N. 52 1/2 W., 65.0 feet.
3' high burnt Fir stump, S. 3 W., 24.7 feet.

PHOTO IDENTIFICATION DATA

Photo No.
Filed At.
Object Ident.
Ident. By

Signature

DESCRIBE CORNER LOCATION RELATIVE TO NEAR-BY FEATURES, ALSO HOW TO REACH CORNER

PLANE COORDINATE POSITION DATA

State: Zone:
X:
Y:
Datum:

Signature

D. Gaylord

Title

Land Surveyor

Division

Headquarters

S.O.

Date

05/25/1997

FS-7100-62 (3/97)

CORNER RECORD (PERPETUATION)

MONUMENT: DESCRIBE NEW MONUMENT SET, OR WORK DONE TO PRESERVE EXISTING MONUMENT

Built a mound of stones around the pipe to the cap.

ACCESSORIES: DESCRIBE NEW BT'S WITNESS OBJECTS ETC. ESTABLISHED, OR WORK DONE TO PRESERVE EXISTING EVIDENCE

5/8" X 36" iron rod, set 35" into the ground with 3/4" brass washer "PLS 1636 432 S" attached at ground level, bears S. 5 1/2 E., 79.7 feet.

5/8" X 36" iron rod, set 35" into the ground with 3/4" brass washer "PLS 1636 432 E" attached at ground level, bears S. 76 E., 113.7 feet.

Granite rock outcrop, 50' X 30" X 10' high, on the ridge top, bears S. 35 W., 100 feet.

Work Done By D. Gaylord Title Land Surveyor Date 05/25/1997 State Registration No. or Agency _____

Certified Corner Record Prepared? Yes No Filed At: _____ Date _____

REMARKS

USDA-FOREST SERVICE

Index
File No. _____

CORNER RECORD (SEARCH)

(Ref. FSM 7151.4)

NFJD WILD

Tract or Survey No. NFJD UNIT Cor. No. 432

T 7S R. 33E

R.D. NORTH FORK JOHN DAY County GRANT

Merid. WILLAMETTE

N.F. UMATILLA State OREGON

CORNER DIAGRAM

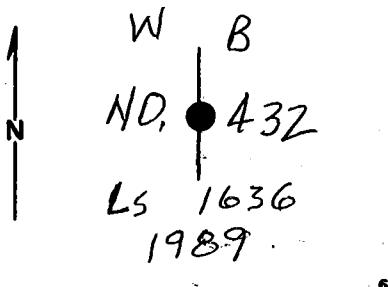

DESCRIBE CORNER MONUMENT FOUND

N/A

DESCRIBE BEARING TREES OR OTHER OFFICIAL ACCESSORIES FOUND

N/A

PHOTO IDENTIFICATION DATA

Photo No. _____
 Filed At. _____
 Object Ident. _____
 Ident. By _____
Signature

DESCRIBE CORNER LOCATION RELATIVE TO NEAR-BY FEATURES, ALSO HOW TO REACH CORNER

PLANE COORDINATE POSITION DATA

State _____ Zone _____
 X _____
 Y _____
 Estab. By _____
Agency

Signature

Title

Division

Headquarters

Date

FS-7100-52 (3/68)

CORNER RECORD (PERPETUATION)

MONUMENT: DESCRIBE NEW MONUMENT SET, OR WORK DONE TO PRESERVE EXISTING MONUMENT

2 1/2" x 30" ALUM. PIPE w/ 3" ALUM. CAP ATTACHED. CAP IS MARKED AS SHOWN IN CORNER DIAGRAM.

ACCESSORIES : DESCRIBE NEW BT'S WITNESS OBJECTS ETC. ESTABLISHED, OR WORK DONE TO PRESERVE EXISTING EVIDENCE

11" W. LARCH N 54° W, 65.5 ft.
 8" W. FIR S 2° W, 24.7 ft. BOTH BLAZED & SCRIBED
 "WB/432 BT" WITH A 3/4" BRASS WASHER, MARKED PLS 1636",
 NAILED TO ~~BLAZE~~ BLAZE & 54-3 & 54-9 SIGNS ATTACHED.

Work Done By D. GAYLORD Title FOREST L.S. Date 7-6-89 State Registration No. 1636
 or Agency

Certified Cor. Record Prepared Yes No Filed At: GRANT CO. SURVEYOR Date 1989

REMARKS

Index File No. T. R. M. Tract or Surv. No. Cor. 432